

**DETAIL A**  
CATCH BASINS A & B

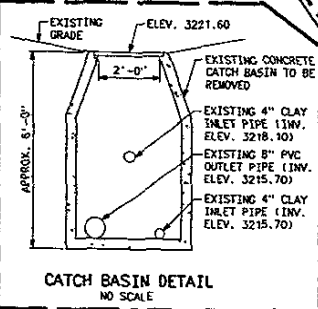

**CATCH BASIN DETAIL**  
NO SCALE

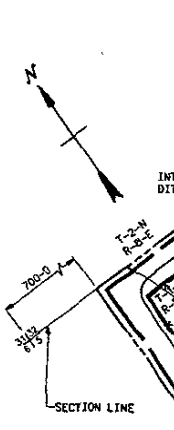
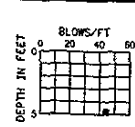
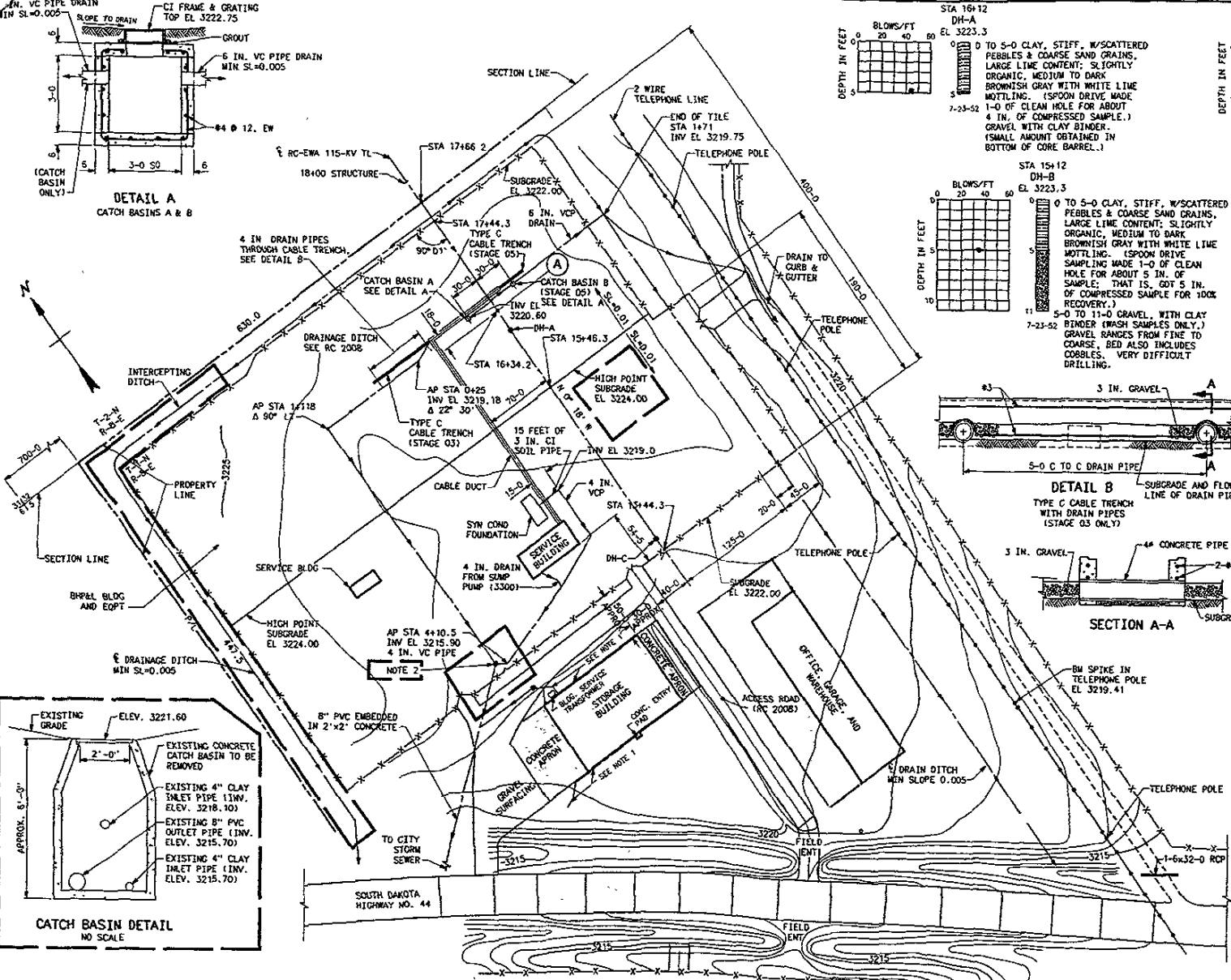

STA 16+12  
DH-A  
EL. 3223.3  
0 TO 5-0 CLAY, STIFF, W/SCATTERED PEBBLES & COARSE SAND GRAINS, LARGE LIME CONTENT; SLIGHTLY ORGANIC, MEDIUM TO DARK BROWNISH GRAY WITH WHITE LIME MOTTLING. (SPOON DRIVE MADE 1-0 OF CLEAN HOLE FOR ABOUT 4 IN. OF COMPRESSED SAMPLE.) GRAVEL WITH CLAY BINDER. (SMALL AMOUNT OBTAINED IN BOTTOM OF CORE BARREL.)

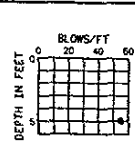

STA 13+62  
DH-C  
EL. 3222.2  
0 TO 5-0 CLAY, STIFF, W/SCATTERED PEBBLES & COARSE SAND GRAINS, LARGE LIME CONTENT; SLIGHTLY ORGANIC, MEDIUM TO DARK BROWNISH GRAY WITH WHITE LIME MOTTLING. (SPOON DRIVE MADE 11 IN. OF CLEAN HOLE FOR ABOUT 5 IN. OF COMPRESSED SAMPLE. IN 50 BLOWS.) GRAVEL WITH CLAY BINDER. (SMALL AMOUNT OBTAINED IN BOTTOM OF CORE BARREL.)

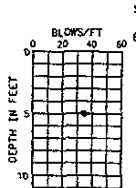

STA 15+12  
DH-B  
EL. 3223.3  
0 TO 5-0 CLAY, STIFF, W/SCATTERED PEBBLES & COARSE SAND GRAINS, LARGE LIME CONTENT; SLIGHTLY ORGANIC, MEDIUM TO DARK BROWNISH GRAY WITH WHITE LIME MOTTLING. (SPOON DRIVE SAMPLING MADE 1-0 OF CLEAN HOLE FOR ABOUT 5 IN. OF SAMPLE; THAT IS, GOT 5 IN. OF COMPRESSED SAMPLE FOR 100% RECOVERY.)  
7-23-52 5-0 TO 11-0 GRAVEL, WITH CLAY BINDER (WASH SAMPLES ONLY.) GRAVEL RANGES FROM FINE TO COARSE, BED ALSO INCLUDES COBBLES. VERY DIFFICULT DRILLING.

- EXPLANATION**
- DH- --- DRILL HOLE (1/2 IN. SIZE, STANDARD SPOON) NO WATER ENCOUNTERED IN HOLES AT TIME OF EXPLORATION
  - 7-23-52 --- DATE HOLE COMPLETED
  - --- ACTUAL NUMBER OF BLOWS
  - RESULTS OF STANDARD PENETRATION RESISTANCE TEST EXPRESSED AS A NUMBER OF BLOWS REQUIRED TO DRIVE A 2 IN. OD PENETRATION SPOON 12 IN. WITH A 140-LB HAMMER DROPPING 30 IN.
  - CATCH BASINS
  - INDICATES LOCATION OF 04WC6516-492 WORK

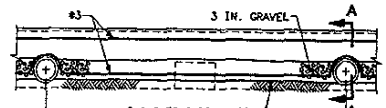

**DETAIL B**  
TYPE C CABLE TRENCH WITH DRAIN PIPES (STAGE 03 ONLY)

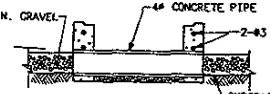

**SECTION A-A**

INDICATES AVAILABLE PARKING AREAS OUTSIDE THE SUBSTATION.

- NOTES**
1. SEE DRAWING RCM 3018 FOR BUILDING DOWNSPOUT DRAIN AND DRAINILE LOCATION.
  2. CONTRACTOR SHALL REMOVE EXISTING CONCRETE CATCH BASIN. (THE EXISTING INLET AND OUTLET PIPING SHALL REMAIN AND BE MODIFIED AND REUSED.) FIELD VERIFY CATCH BASIN SIZE, & SIZES & TYPES OF PIPES. SEE CATCH BASIN DETAIL.

- REFERENCE DRAWINGS**
- FOUNDATIONS-GENERAL PLAN --- RC 2003
  - GRADING PLAN --- RC 2008
  - ARCHITECTURAL FLOOR PLAN --- RCM 3018

**EXISTING INSTALLATION**

A	1-19-01	REVISED TO INDICATE AS-BUILT DRAINAGE PER SPECIFICATION 89WC6069-388
B	2-20-00	ADDED STORAGE BUILDING PER SPECIFICATION 89WC6069-388
C	8-3-98	REDRAWN
D	10-3-98	REDRAWN

SUPERSEDES DWG NO. 466-0-1414

UNITED STATES DEPARTMENT OF ENERGY  
WESTERN AREA ADMINISTRATION  
CORPORATE SERVICES OFFICE - GOLDEN, COLORADO

**RAPID CITY SUBSTATION**  
SOUTH DAKOTA

**DRAINAGE PLAN**

