

WILLOWBEND ROAD
52' R.O.W.
EASEMENT

PREVIOUSLY DEDICATED

BLOCK

FUTURE
PLATTING
AREA DEDICATED
TO THE PUBLIC THIS SU

JOLLY LANE
HAZELTINE COURT
CROSSWATER DRIVE

RECEIVED

MAY 14 2004

Rapid City Growth
Management Department

P

S.S.

EMENT
JK 24

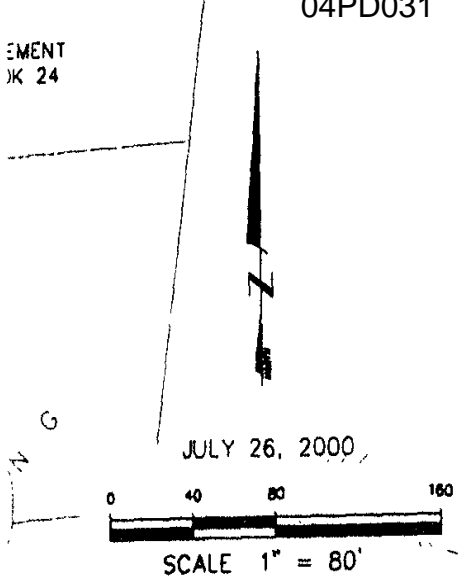

JULY 26, 2000

TRACT 2

LINE	BEARING	LENGTH
L1	S71°11'00"W	25.73
L2	N71°11'00"E	16.42
L3	N08°07'35"W	69.35
L4	N77°03'15"E	48.39
L5	S43°44'20"E	52.97
L6	S60°53'50"W	1.82
L7	N70°08'07"E	58.61
L8	S18°55'18"E	23.77
L9	N42°44'01"W	26.12
L10	S20°14'15"E	62.86
L11	S18°55'18"E	48.20
L12	S74°50'57"W	52.00
L13	N42°44'01"E	26.12
L14	N71°50'51"E	70.39
L15	S43°44'20"E	52.97
L16	S20°14'15"E	86.39
L17	S88°20'24"W	73.85
L18	S43°44'20"E	52.97
L19	S20°14'15"E	74.63
L20	S60°53'50"W	117.67
L21	N29°06'10"W	30.50
L22	S42°44'01"E	24.63

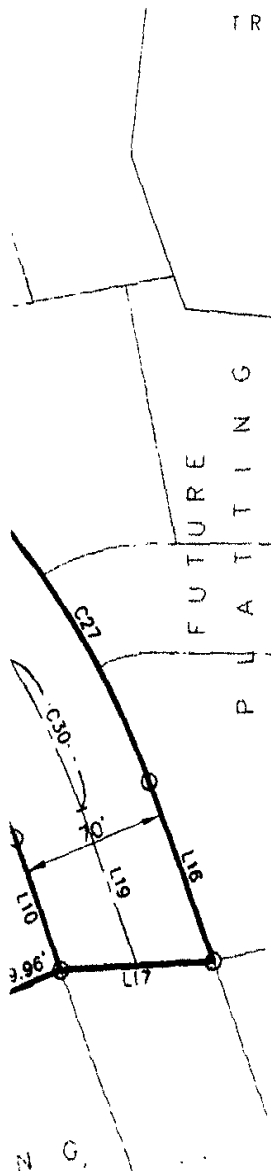

CURVE	LENGTH	RADIUS	DELTA	CHORD BEARING	CHORD DISTANCE
C1	5.18	371.53	0°47'55"	S04°11'12"E	5.18
C2	137.04	394.97	19°52'49"	N81°07'24"E	136.36
C3	115.26	285.99	23°05'32"	N19°40'21"W	114.48
C4	24.86	285.99	4°58'53"	N33°42'33"W	24.86
C5	52.03	707.43	4°12'51"	S34°05'35"E	52.02
C6	146.89	446.97	18°48'12"	N80°35'06"E	146.03
C7	77.15	371.53	11°53'51"	S18°41'18"E	77.01
C8	75.22	371.53	11°36'02"	S30°26'14"E	75.09
C9	48.64	371.53	7°30'05"	S39°59'18"E	48.61
C10	27.24	299.78	5°12'22"	S41°08'09"E	27.23
C11	33.36	25.00	76°27'14"	N80°52'34"W	30.94
C12	94.15	55.00	98°04'52"	S88°01'55"W	83.07
C13	56.50	55.00	58°51'23"	S09°33'48"W	54.05
C14	40.60	226.79	10°15'27"	N03°20'34"E	40.55
C15	25.11	226.79	6°20'34"	N04°57'05"W	25.09
C16	42.15	55.00	43°54'38"	S41°49'12"E	41.13
C17	8.08	226.00	2°02'54"	N41°42'34"W	8.08
C18	127.49	226.79	32°12'34"	N24°34'43"E	125.82
C19	39.31	55.00	40°57'14"	S84°15'08"E	38.48
C20	13.80	55.00	14°22'26"	N68°05'33"E	13.76
C21	46.50	299.78	8°53'16"	S24°40'53"E	46.46
C22	80.00	226.00	20°16'54"	N30°32'40"W	79.58
C23	20.72	226.00	5°15'10"	N17°46'38"W	20.71
C24	83.77	174.00	27°34'38"	N28°56'32"E	82.96
C25	52.11	226.79	13°09'59"	N47°16'05"E	52.00
C26	169.78	301.53	32°15'40"	S27°38'30"E	167.55
C27	151.68	369.78	23°30'05"	S31°59'18"E	150.62
C28	185.40	336.53	31°33'52"	S27°57'25"E	183.06
C29	60.88	334.78	10°25'10"	N38°31'46"W	60.80
C30	76.44	334.78	13°04'56"	N26°48'43"W	76.27
C31	96.28	200.00	27°34'58"	N28°56'32"W	95.36

NOTES:

- ⊙ Denotes set 5/8" rebar with survey cap marked "Renner - 2652 and Sperlich"
- Denotes Found Survey Monument marked LS 2652 unless otherwise noted
- Denotes set 5/8" rebar with no cap for R.O.W. PC's & PT's
- (R) Denotes Recorded in previous plat or description.
- (M) Denotes Measured in this survey.
- ++++ Denotes Restricted Access onto adjacent street R.O.W.

INDICATED TO
THIS SURVEY

0.724 Ac.

Basis of Bearings: The Inverse Bearing between the Southeast Section corner and the East 1/4 corner of Section 16, T1N, R8E, B1M. Soid Bearing being North (R&M)

Utility and Minor Drainage Easements: 8' on the interior sides of all lot lines.