

# RECEIVED

APR - 8 2006

Rapid City Growth  
Management Department

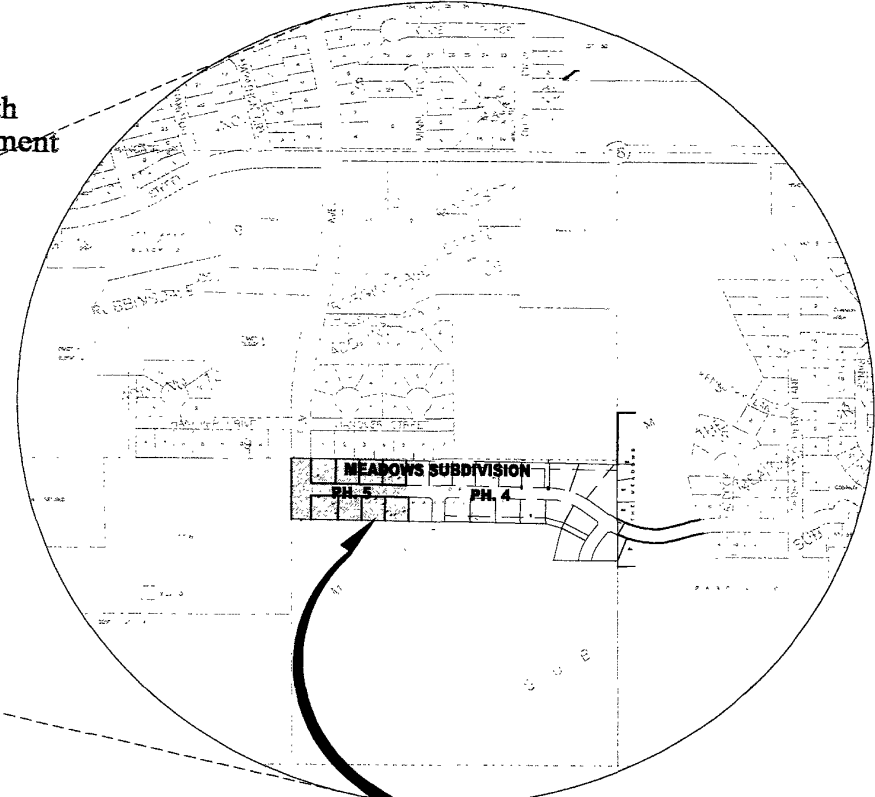
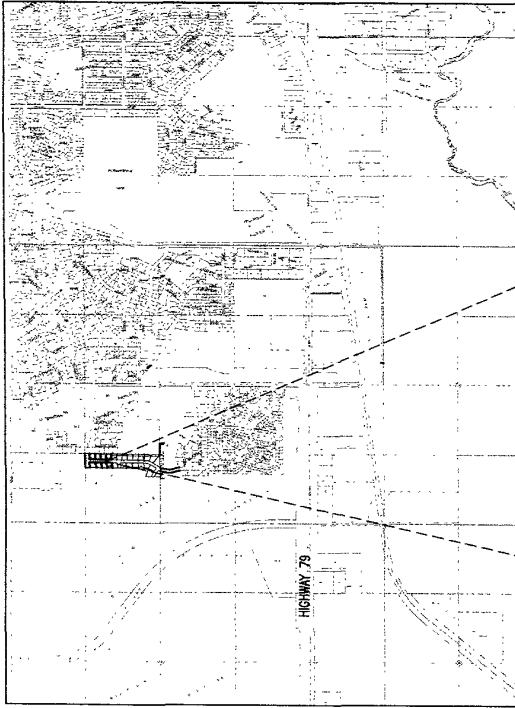

**PROJECT LOCATION**

***VICINITY MAP***

**N.T.S.**



# THE MEADOWS SUBDIVISION PHASE-V

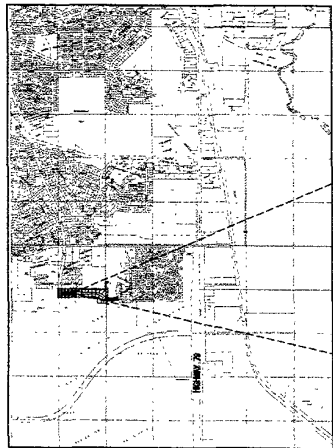

**VICINITY MAP**

N.T.S.

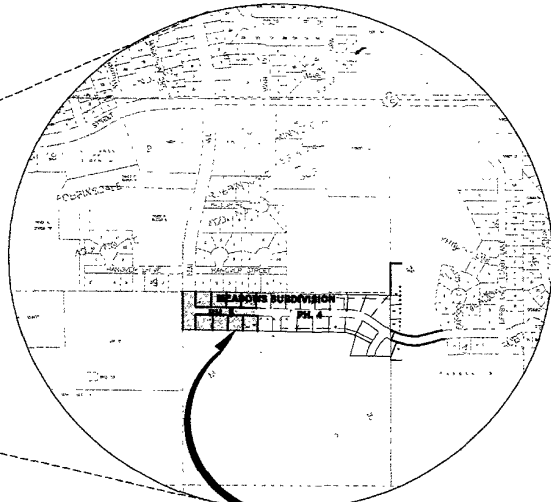

**PROJECT LOCATION**

**SHEET INDEX:**

- SHEET 1 = COVER
- SHEET 2 = PLAT
- SHEET 3 = GENERAL NOTES & CROSS SECTIONS
- SHEET 4&5 = STANDARD DETAILS
- SHEET 6 = MASTER GRADING & EROSION CONTROL
- SHEET 7 = MASTER UTILITY
- SHEET 8 = SURVEY SHEET
- SHEET 9 = CURB AND GUTTER SHEET
- SHEET 10 = ELM AVENUE P&P
- SHEET 11 = FIELD VIEW DRIVE P & P

**THE MEADOWS SUBDIVISION**

AREA PLATTED - 2.79 ac.

LOT AREAS - 1.87 ac.

R-O-W AREA - 0.92 ac.

SUBDIVISION ELEVATION RANGE = 3272 TO 3284

WATER SOURCE: CITY OF RAPID CITY

# RECEIVED

APR - 8 2006

Rapid City Growth  
Management Department



**D.D.I.**  
**DREAM DESIGN INTERNATIONAL, INC.**  
 PROFESSIONAL STRUCTURAL & CIVIL ENGINEERING CONSULTANTS  
 3302 MAIN ST., SUITE 11, RAPID CITY, SD 57702  
 TEL. 605-346-0538 FAX. 605-346-0540 EMAIL: engineers@dreamdesigninc.com