

# RAPID CITY REGIONAL AIRPORT TSA OFFICE BUILDING PROJECT

PROJECT # 04-1048  
RAPID CITY, SOUTH DAKOTA

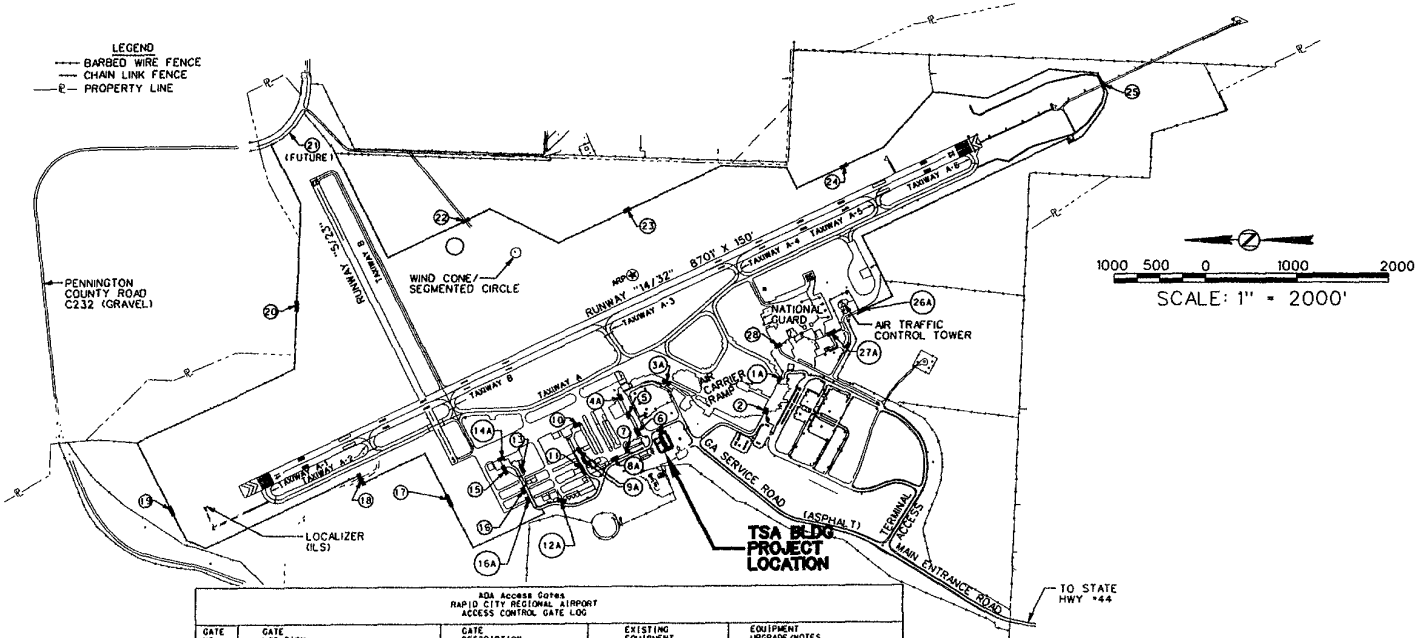

| RDM Access Gates<br>RAPID CITY REGIONAL AIRPORT<br>ACCESS CONTROL GATE LOG |                                     |                       |                          |                               |
|--|-------------------------------------|-----------------------|--------------------------|-------------------------------|
| GATE NO.   | GATE LOCATION                       | GATE DESCRIPTION      | EXISTING EQUIPMENT       | EQUIPMENT UPGRADE/NOTES       |
| 1A   | East end of Terminal                | Automatic Chain Link  | Programmable Card Reader |                               |
| 2  | West end of Terminal                | North-Thru Chain Link | Key Padlock              |                               |
| 3A   | South end old Terminal/FedEx Ramp   | Automatic Chain Link  | Programmable Card Reader |                               |
| 4A   | East and West Jet                   | Automatic Chain Link  | Intercom                 |                               |
| 5  | West and West Jet                   | Drive-Thru Chain Link | Chairs & Key Padlock     |                               |
| 6  | East side Federal Building          | Automatic Chain Link  | Chairs & Key Padlock     |                               |
| 7  | North and Federal Building          | North-Thru Chain Link | Chairs & Key Padlock     |                               |
| 8A   | General Aviation                    | Automatic Chain Link  | Programmable Card Reader |                               |
| 9A   | North Side Shop Area                | Automatic Chain Link  | Programmable Card Reader |                               |
| 9B   | South Side Shop Area                | Automatic Chain Link  | Programmable Card Reader |                               |
| 10   | Medical Air Rescue                  | Drive-Thru Chain Link | Chairs & Key Padlock     |                               |
| 11   | Blue Hangar Area/North of MX Shop   | Drive-Thru Chain Link | Chairs & Key Padlock     |                               |
| 12A  | Horizon Area                        | Automatic Chain Link  | Programmable Card Reader |                               |
| 13   | South Side Air Support Services     | Drive-Thru Chain Link | Chairs & Key Padlock     |                               |
| 14A  | Air Support Services (Fuel Farm)    | Automatic Chain Link  | Intercom                 |                               |
| 15   | Air Support Services (Fuel Farm)    | Drive-Thru Chain Link | Chairs & Key Padlock     |                               |
| 16   | North Hangar Area                   | Drive-Thru Chain Link | Chairs & Key Padlock     | Reader installed/Not Operable |
| 16A  | North Hangar Area                   | Automatic Chain Link  | Programmable Card Reader |                               |
| 17   | End of Runway 5                     | Drive-Thru Chain Link | Chairs & Key Padlock     |                               |
| 18   | North Runway 14                     | Drive-Thru Chain Link | Chairs & Key Padlock     |                               |
| 19   | West Side Runway 14                 | Drive-Thru Chain Link | Chairs & Key Padlock     |                               |
| 20   | Northeast Side Runway 05/23         | Drive-Thru Chain Link | Chairs & Key Padlock     |                               |
| 21   | Northeast End of Runway 23          | Drive-Thru Chain Link | Chairs & Key Padlock     |                               |
| 22   | East Side Runway 32                 | Drive-Thru Chain Link | Chairs & Key Padlock     | Future Installation           |
| 23   | East Side Runway 32                 | Drive-Thru Chain Link | Chairs & Key Padlock     |                               |
| 24   | East Side Runway 32                 | Drive-Thru Chain Link | Chairs & Key Padlock     |                               |
| 25   | South and Runway 32                 | Drive-Thru Chain Link | Chairs & Key Padlock     |                               |
| 26A  | Slurry Base Main Gate               | Automatic Chain Link  | Programmable Card Reader |                               |
| 27A  | Army Air National Guard Gate        | Automatic Chain Link  | Intercom and Code/keypad |                               |
| 28   | Army Air National Guard Hangar Area | Drive-Thru Chain Link | Key Padlock              |                               |



## SITE PLAN

SCALE: 1" = 2000'

RCRA

EXISTING LEGAL DESCRIPTION: SW1/4 OF SECTION 17, T1N, R9E, BHM, RAPID CITY, PENNINGTON COUNTY, SOUTH DAKOTA

**SUBMITTAL FOR 11-6-19 REVIEW**



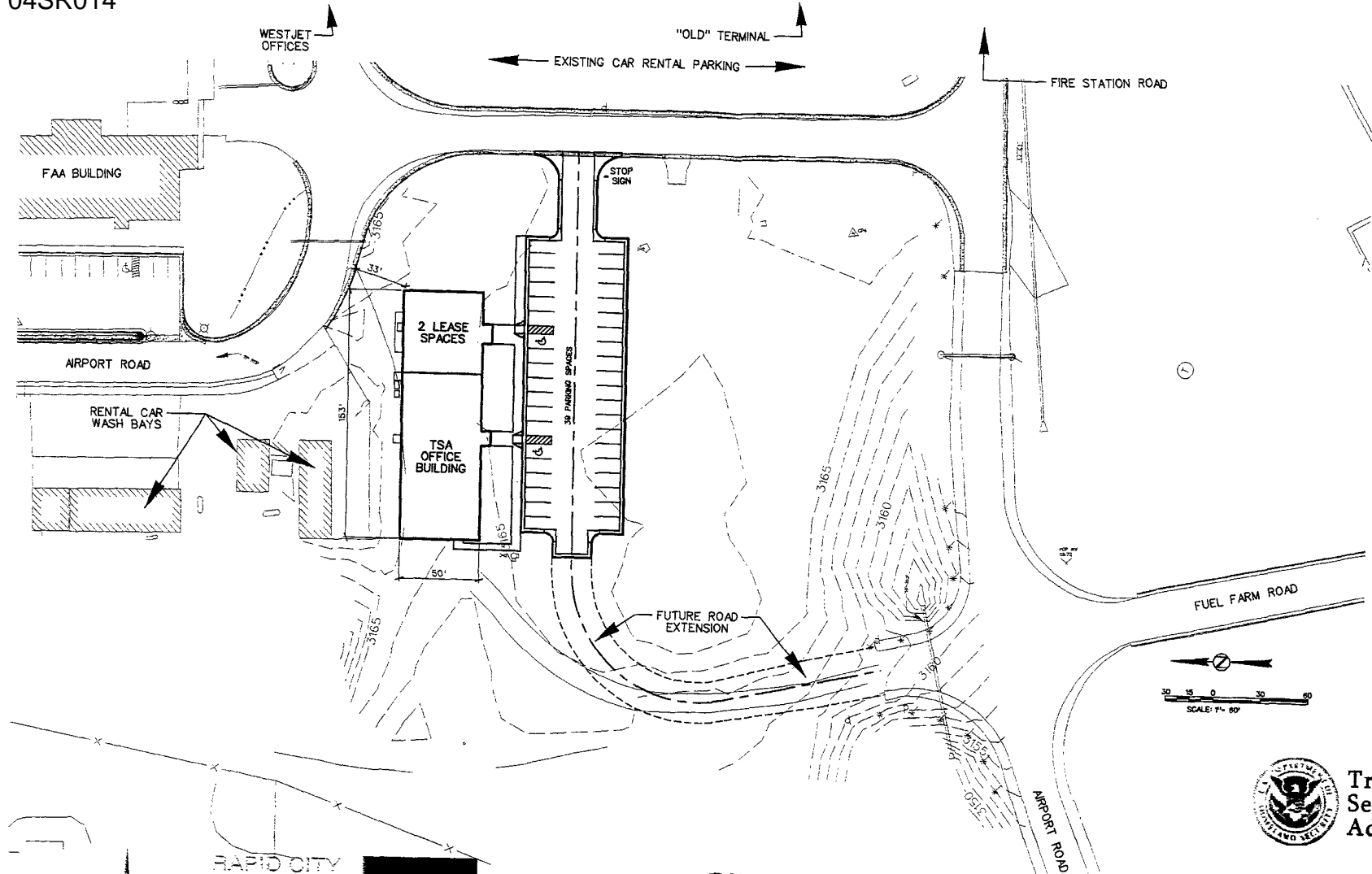

Transportation Security Administration

**SITE PLAN  
RAPID CITY REGIONAL AIRPORT  
TSA OFFICE BUILDING**

03/12/2004



04SR014

LEGEND

- BARBED WIRE FENCE
- CHAIN LINK FENCE
- P- PROPERTY LINE

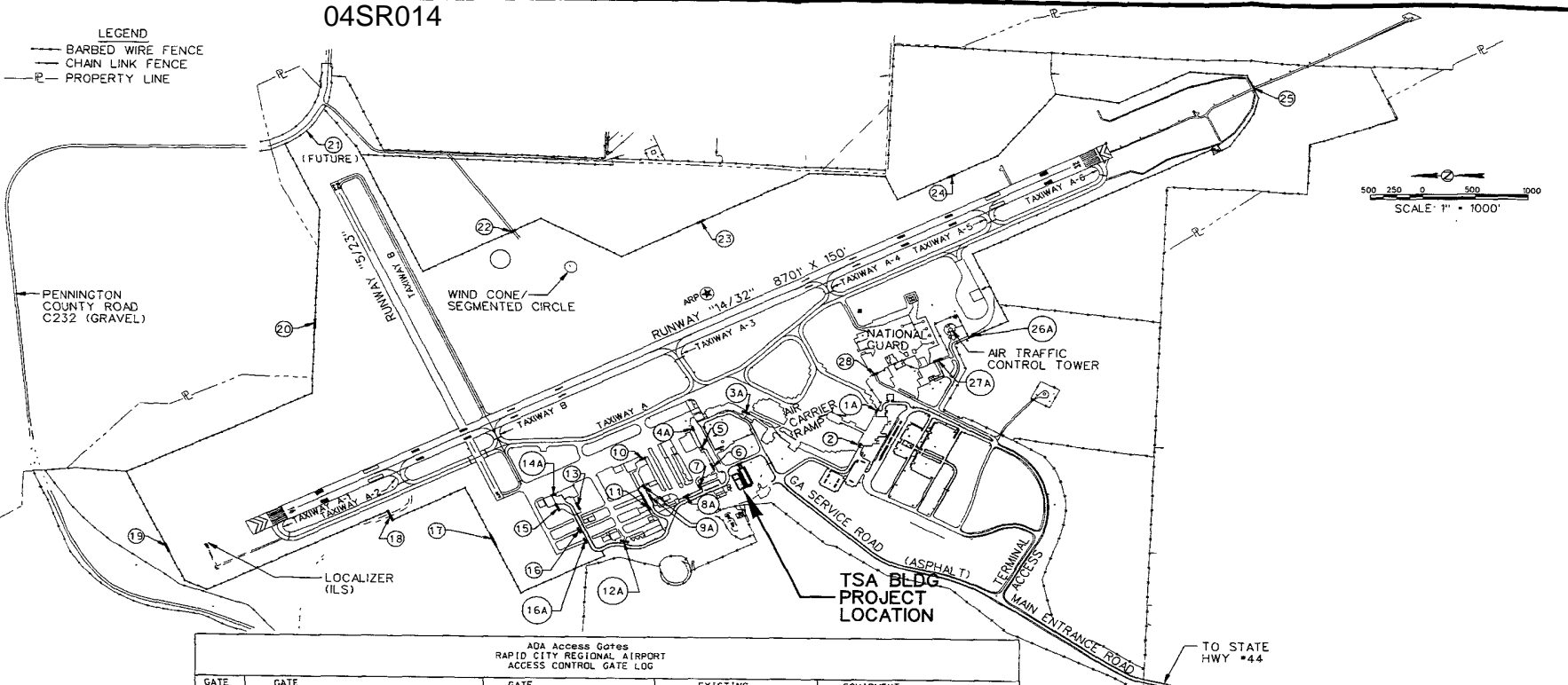

ADA Access Gates  
RAPID CITY REGIONAL AIRPORT  
ACCESS CONTROL GATE LOG

| GATE NO. | GATE LOCATION                       | GATE DESCRIPTION      | EXISTING EQUIPMENT       | EQUIPMENT UPGRADE/NOTES       |
|----------|-------------------------------------|-----------------------|--------------------------|-------------------------------|
| 1A       | East end of Terminal                | Automatic Chain Link  | Programmable Card Reader |                               |
| 2        | West end of Terminal                | Walk-Thru Chain Link  | Key Padlock              |                               |
| 3A       | South end old Terminal/FedEx Ramp   | Automatic Chain Link  | Programmable Card Reader |                               |
| 4A       | East end West Jet                   | Automatic Chain Link  | Intercom                 |                               |
| 5        | West end West Jet                   | Drive-Thru Chain Link | Chains & Key Padlock     |                               |
| 6        | East side Federal Building          | Drive-Thru chain Link | Chains & Key Padlock     |                               |
| 7        | North end Federal Building          | Automatic Chain Link  | Chains & Key Padlock     |                               |
| 8A       | General Aviation                    | Automatic Chain Link  | Programmable Card Reader |                               |
| 9A       | North Side Shop Area                | Automatic Chain Link  | Programmable Card Reader |                               |
| 9A       | South Side Shop Area                | Automatic Chain Link  | Programmable Card Reader |                               |
| 10       | Medical Air Rescue                  | Walk-Thru Chain Link  | Chains & Key Padlock     |                               |
| 11       | Blue Hangar Area/North of MX Shop   | Drive-Thru Chain Link | Chains & Key Padlock     |                               |
| 12A      | Horizon Area                        | Automatic Chain Link  | Programmable Card Reader |                               |
| 13       | South Side Air Support Services     | Drive-Thru Chain Link | Chains & Key Padlock     |                               |
| 14A      | Air Support Services                | Automatic Chain Link  | Intercom                 |                               |
| 15       | Air Support Services (Fuel Farm)    | Drive-Thru Chain Link | Chains & Key Padlock     |                               |
| 16       | North Hangar Area                   | Automatic Chain Link  | Intercom                 |                               |
| 16A      | North Hangar Area                   | Automatic Chain Link  | Programmable Card Reader | Reader installed/Not Operable |
| 17       | End of Runway 5                     | Drive-Thru Chain Link | Chains & Key Padlock     |                               |
| 18       | West Side Runway 14                 | Drive-Thru Chain Link | Chains & Key Padlock     |                               |
| 19       | North End Runway 14                 | Drive-Thru Chain Link | Chains & Key Padlock     |                               |
| 20       | Northwest Side Runway 05/23         | Drive-Thru Chain Link | Chains & Key Padlock     |                               |
| 21       | Northeast End of Runway 23          | Drive-Thru Chain Link | Chains & Key Padlock     |                               |
| 22       | East Side Runway 32                 | Drive-Thru Chain Link | Chains & Key Padlock     | Future installation           |
| 23       | East Side Runway 32                 | Drive-Thru Chain Link | Chains & Key Padlock     |                               |
| 24       | East Side Runway 32                 | Drive-Thru Chain Link | Chains & Key Padlock     |                               |
| 24       | East Side Runway 32                 | Drive-Thru Chain Link | Chains & Key Padlock     |                               |
| 25       | South end Runway 32                 | Drive-Thru Chain Link | Chains & Key Padlock     |                               |
| 25A      | Slurry Base Main Gate               | Automatic Chain Link  | Programmable Card Reader |                               |
| 27A      | Army Air National Guard Gate        | Automatic Chain Link  | Intercom and Code/Keypad |                               |
| 28       | Army Air National Guard Hangar Area | Drive-Thru Chain Link | Key Padlock              |                               |

EXISTING LEGAL DESCRIPTION:  
SW1/4 OF SECTION 17, T1N, R9E, BHM, RAPID CITY,  
PENNINGTON COUNTY, SOUTH DAKOTA

**SUBMITTAL FOR 11-6-19 REVIEW**

DRAWN BY: JED  
CHECKED BY: JED  
DATE: 03-22-2014  
JOB NO: 04-018  
FILE: SHEET 001  
REVISIONS:

TSA OFFICE BUILDING PROJECT  
RAPID CITY REGIONAL AIRPORT  
RAPID CITY, SOUTH DAKOTA

SITE PLAN  
INFORMATION



SHEET  
OF