

RECEIVED
 JAN 23 2004
 Rapid City
 Planning Department

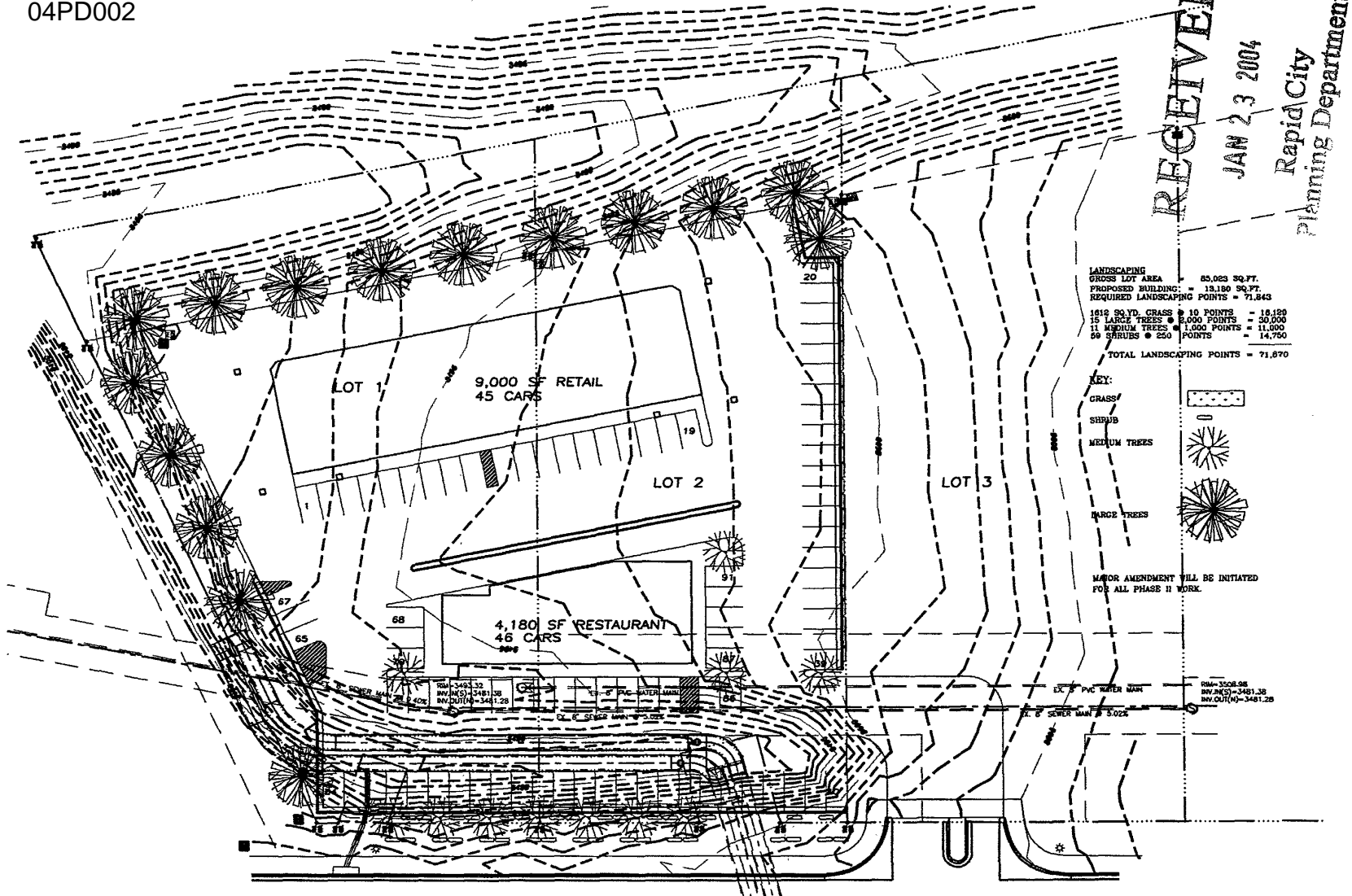

LANDSCAPING

GROSS LOT AREA	=	65,026 SQ. FT.
PROPOSED BUILDING	=	19,159 SQ. FT.
REQUIRED LANDSCAPING POINTS	=	71,843
1612 SQ. YD. GRASS @ 10 POINTS	=	16,120
15 LARGE TREES @ 2,000 POINTS	=	30,000
1 MEDIUM TREES @ 1,000 POINTS	=	11,000
59 SHRUBS @ 250 POINTS	=	14,750
TOTAL LANDSCAPING POINTS	=	71,870

- KEY:**
- GRASS
 - SHRUB
 - MEDIUM TREES
 - LARGE TREES

MAJOR AMENDMENT WILL BE INITIATED FOR ALL PHASE II WORK.

RM-3483.32
 RW-IN(3)-3481.28
 RW-OUT(4)-3481.28

RM-3508.08
 RW-IN(3)-3481.28
 RW-OUT(4)-3481.28