

FIFTH STREET EXTENSION CITY OF RAPID CITY PROJECT NO. ST00-914

RAPID CITY, SOUTH DAKOTA

UTILITIES, GRADING, SURFACING, CURB & GUTTER,
LIGTING, SIGNALIZATION, PAVEMENT MARKING,
AND RIGHT OF WAY

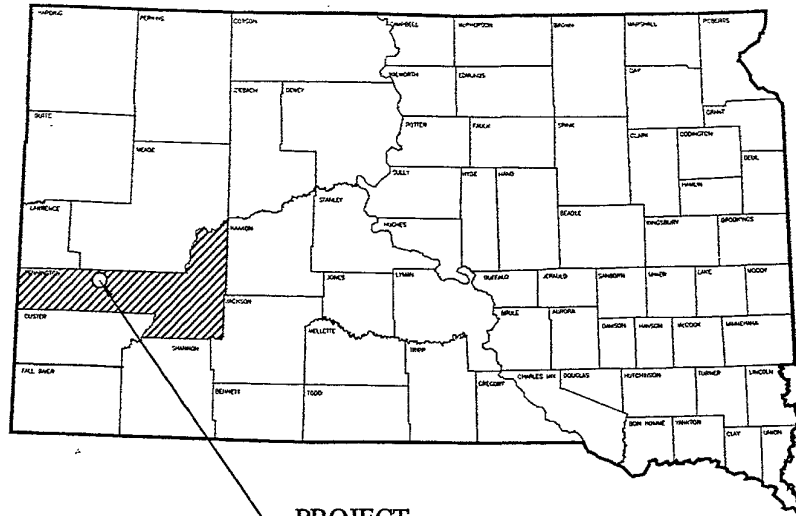

PROJECT

LEGEND

SECTION LINE	---
SIXTEENTH LINE	- - - - -
THIRTY SECOND LINE	- . - . - .
PROPERTY LINE	=====
CENTERLINE	=====
R.O.W. LINE	=====
CUTSLOPES
FILLSLOPES

DESIGN DESIGNATION

	FIFTH ST
ADT	17100 (1996)
ADT	18127 (2016)
DHV	2048
D	50%
T (DHV)	1.3%
T (ADT)	2.9%
V (URBAN)	50 MPH

ACRES DISTURBED

	FIFTH ST
	122.9

PLAN,	STREET	1"=40'	PLAN,	DETENTION CELLS	1"=100'
PROFILE,	{ HORIZONTAL:	1"=40'	PROFILE,	{ HORIZONTAL:	1"=100'
	{ VERTICAL:	1"=5'		{ VERTICAL:	1"=10'
CROSS SECTION	{ HORIZONTAL:	1"=40'			
	{ VERTICAL:	1"=5'			

	FIFTH STREET
GROSS LENGTH:	1.020 MILES
LENGTH OF EXCEPTIONS:	0.000 MILES
NET LENGTH:	1.020 MILES

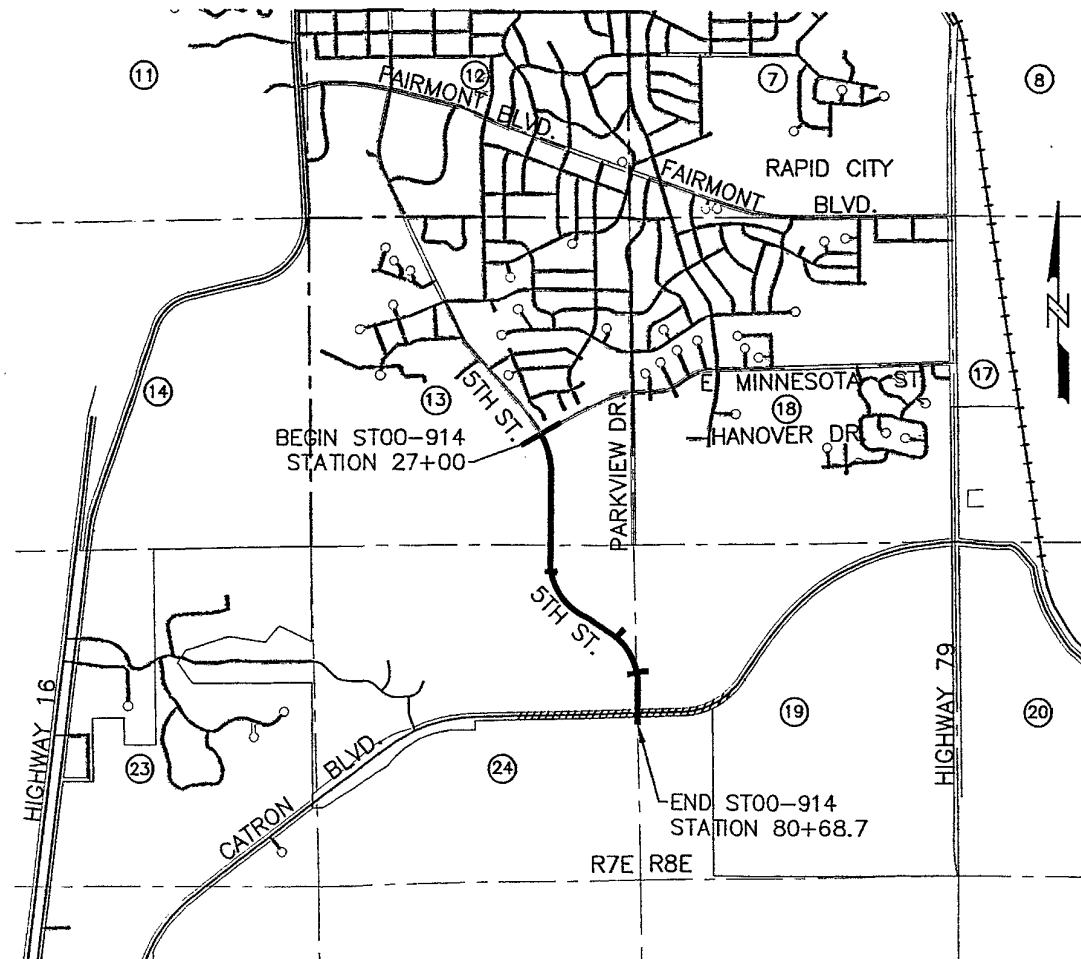

VICINITY MAP
SCALE: N.T.S.



CIVIL PLANS PREPARED BY

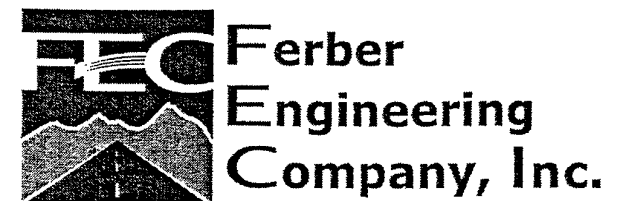

Ferber Engineering Company, Inc.
Civil Engineering • Water Resources • Transportation • Land Surveying
729 East Watertown St, Rapid City, SD 57701 ~ Phone: (605) 343-3311

ELECTRICAL PLANS PREPARED BY



WEST PLAINS ENGINEERING
MECHANICAL - ELECTRICAL CONSULTANTS
1750 RAND ROAD
RAPID CITY, SD (605) 348-7455