

NOTE:
MATCH EXISTING CONCRETE SLAB AND CURB & GUTTER GRADES

03SR051

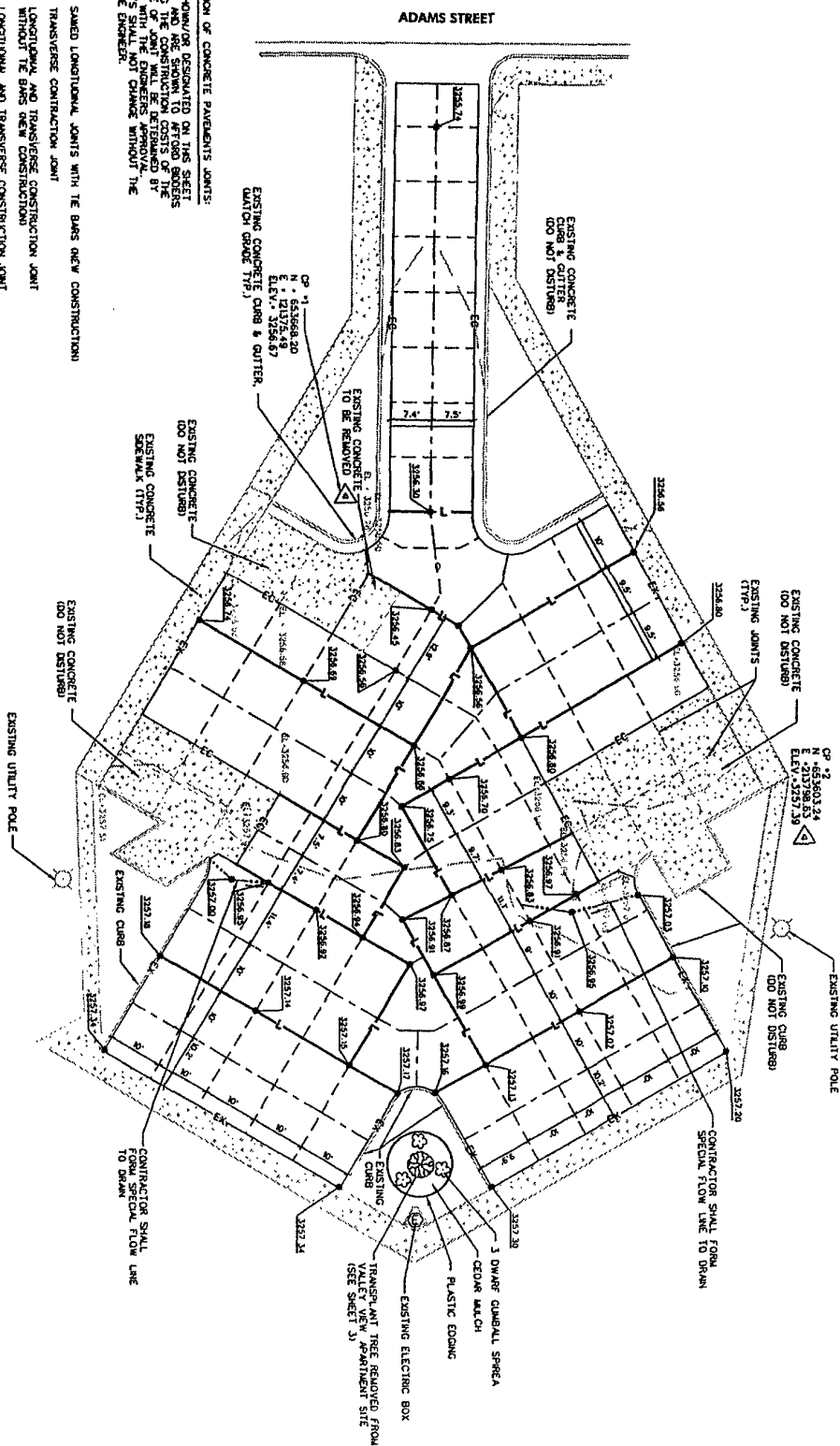

NOTE REGARDING LOCATION OF CONCRETE PAVEMENT JOINTS:
THE TYPE OF JOINTS SHOWING DESIGNATED ON THIS SHEET ARE ONLY APPROXIMATE AND ARE SHOWN TO AFFORD SURETIES A BASIS FOR ESTIMATING THE CONSTRUCTION COSTS OF THE JOINTS. THE FINAL TYPE OF JOINTS WILL BE DETERMINED BY THE CONTRACTOR AND SHALL BE APPROVED BY THE ENGINEER. THE LOCATION OF JOINTS SHALL NOT CHANGE WITHOUT THE PRIOR APPROVAL OF THE ENGINEER.

LEGEND

- SAVED LONGITUDINAL JOINTS WITH THE BARS NEW CONSTRUCTION
- TRANSVERSE CONTRACTION JOINT
- LONGITUDINAL AND TRANSVERSE CONTRACTION JOINT WITHOUT THE BARS NEW CONSTRUCTION
- LONGITUDINAL AND TRANSVERSE CONTRACTION JOINT ADJACENT TO EXISTING CONCRETE PAVEMENT OR CURB & GUTTER
- EXPANSION JOINT
- ADJACENT TO EXISTING SIDEWALK OR CURB
- SPECIAL FLOW LINE
- EXISTING SPOT ELEVATION
- PROPOSED FINISH SPOT ELEVATION

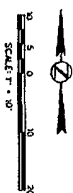

ADAM STREET APARTMENTS
PARKING LOT IMPROVEMENTS

PENNINGTON COUNTY HOUSING
AND REDEVELOPMENT COMMISSION
RAPID CITY, SOUTH DAKOTA

DRN. BY: RJO, ALR
SCALE: AS SHOWN
DATE: 05-21-2003
JOB NO: 03 SR
FILE: 094PLOT.DWG
REVISIONS:

SHEET
7
OF
11