

TBC CONTROL DATA

NO.	NORTHING	EASTING	ELEVATION	TBC
A			3377.27	
B			3377.32	
C			3378.29	
D			3381.92	
E			3385.83	
F			3386.44	
G	10011.42	9791.77	3386.88	
H	10006.33	9797.36	3387.33	
I	9993.58	9797.04	3387.84	
J			3387.88	
K			3387.62	
L	9990.10	9929.30	3387.34	
M	10003.10	9928.63	3387.26	
N	10007.97	9934.75	3387.03	
O	10032.96	9935.38	3386.61	
P			3387.14	
Q			3387.46	
R	10036.60	9796.79	3386.67	
S			3385.83	
T			3381.92	
U			3378.29	
V			3377.22	
W			3376.34	

TBC - TOP BACK OF CURB

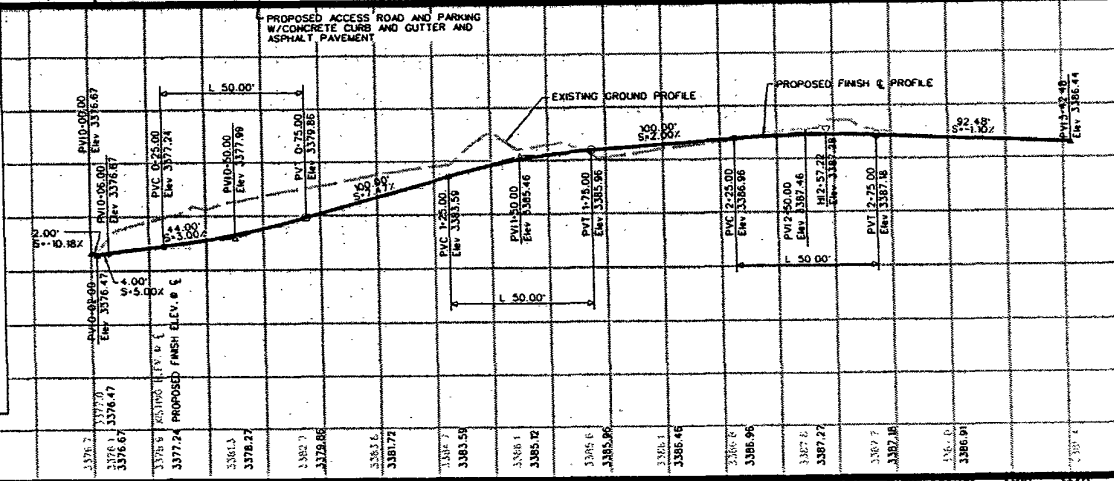

NOTE - WORK SHALL INCLUDE:  
 PAVING SHALL BE 4" ASPHALTIC CONCRETE W/4" AGGREGATE BASE COURSE.  
 REMOVE, SALVAGE AND REPLANT TREES/SHRUB ON SITE AT THE DIRECTION OF THE OWNER.  
 DISTURBED AREAS ADJACENT TO THE NEW ACCESS AND PARKING AREA SHALL BE GRADED PER PLAN, TOPSOILED 4" MINIMUM, AND SOODED.  
 EXISTING IRRIGATION SYSTEM SHALL BE REVISED PER CHANGES ON PLAN SHEET 3.  
 4" WHITE PARKING STRIPES, NON-PARKING AREA AND HANDICAP PAINTED LOGO.  
 DISPOSE OFF SITE ALL EXCESS VEGETATION, TOPSOIL AND EXCAVATED MATERIAL.  
 CONTRACTOR SHALL VERIFY LOCATION AND DEPTHS OF ALL EXISTING UNDERGROUND UTILITIES PRIOR TO START OF WORK. THE SITE MAY INCLUDE ABANDONED IRRIGATION LINES NOT SHOWN ON THE SPRINKLER SYSTEM LAYOUT DRAWING. VERIFY WITH OWNER AND REMOVE AS NECESSARY.  
 STORM SEWER SHALL BE INSTALLED PER CITY OF RAPID CITY STANDARD DETAILS 11-3 (TRENCH DETAIL) AND 4-11 UTILITY TRENCH (PATCH DETAIL). TYPE 1 BEDDING MATERIAL SHALL NOT BE PAID FOR SEPARATELY BUT SHALL BE INCIDENTAL TO THE INSTALLATION OF THE STORM SEWER.