

03SR035

Scale 1"=20'
NW 1/4 NW 1/4 NW 1/4 CL. 1
Section 10 T1N R6E
10 Acres +/-
LARRY P-S LAND COMPANY, INC.
808 E. CAYROB BLVD.
RAPID CITY, SD 57701
605.351.3227



Legend

Proposed	---
Existing	---
Proposed 10' R.O.W.	---
Proposed 20' R.O.W.	---
Proposed 30' R.O.W.	---
Proposed 40' R.O.W.	---
Proposed 50' R.O.W.	---
Proposed 60' R.O.W.	---
Proposed 75' R.O.W.	---
Proposed 100' R.O.W.	---
Proposed 150' R.O.W.	---
Proposed 200' R.O.W.	---
Proposed 250' R.O.W.	---
Proposed 300' R.O.W.	---
Proposed 350' R.O.W.	---
Proposed 400' R.O.W.	---
Proposed 450' R.O.W.	---
Proposed 500' R.O.W.	---
Proposed 550' R.O.W.	---
Proposed 600' R.O.W.	---
Proposed 650' R.O.W.	---
Proposed 700' R.O.W.	---
Proposed 750' R.O.W.	---
Proposed 800' R.O.W.	---
Proposed 850' R.O.W.	---
Proposed 900' R.O.W.	---
Proposed 950' R.O.W.	---
Proposed 1000' R.O.W.	---

NOTES REGARDING 8TH STREET
Build proposed concrete road
and utilities per City plans.
END at intersection with
Revere Road, this project.

NOTES REGARDING ROW
Local, Sub Collector and
Collector designations shown.
Others per City Major Street Plan.

WRP requested for future E-W
Collector, north boundary.

NOTES REGARDING UTILITIES
Water and sewer mains shown
utilize City connection to
existing main if utility to
be extended with Parkway Dr and Hwy
78 sewer extension projects.

Internal water and sewer 6" minimum.
(6" min. water in cul de sac with approved design)

REFERENCE SOUTH TRUCK ROUTE DRAINAGE BASIN PLAN

PRELIMINARY: NOT FOR CONSTRUCTION

REVIEWED BY CITY ENGINEERING DIVISION

Name	____
Signature	____
Date	____
Comments	LAYOUT ONLY

Drawings shall be responsible for obtaining of
necessary permits from the City Engineering Division
before starting any of the proposed public improvements.

Contours from City GIS may differ
to be supplemented with field survey of
critical location, areas of final design.

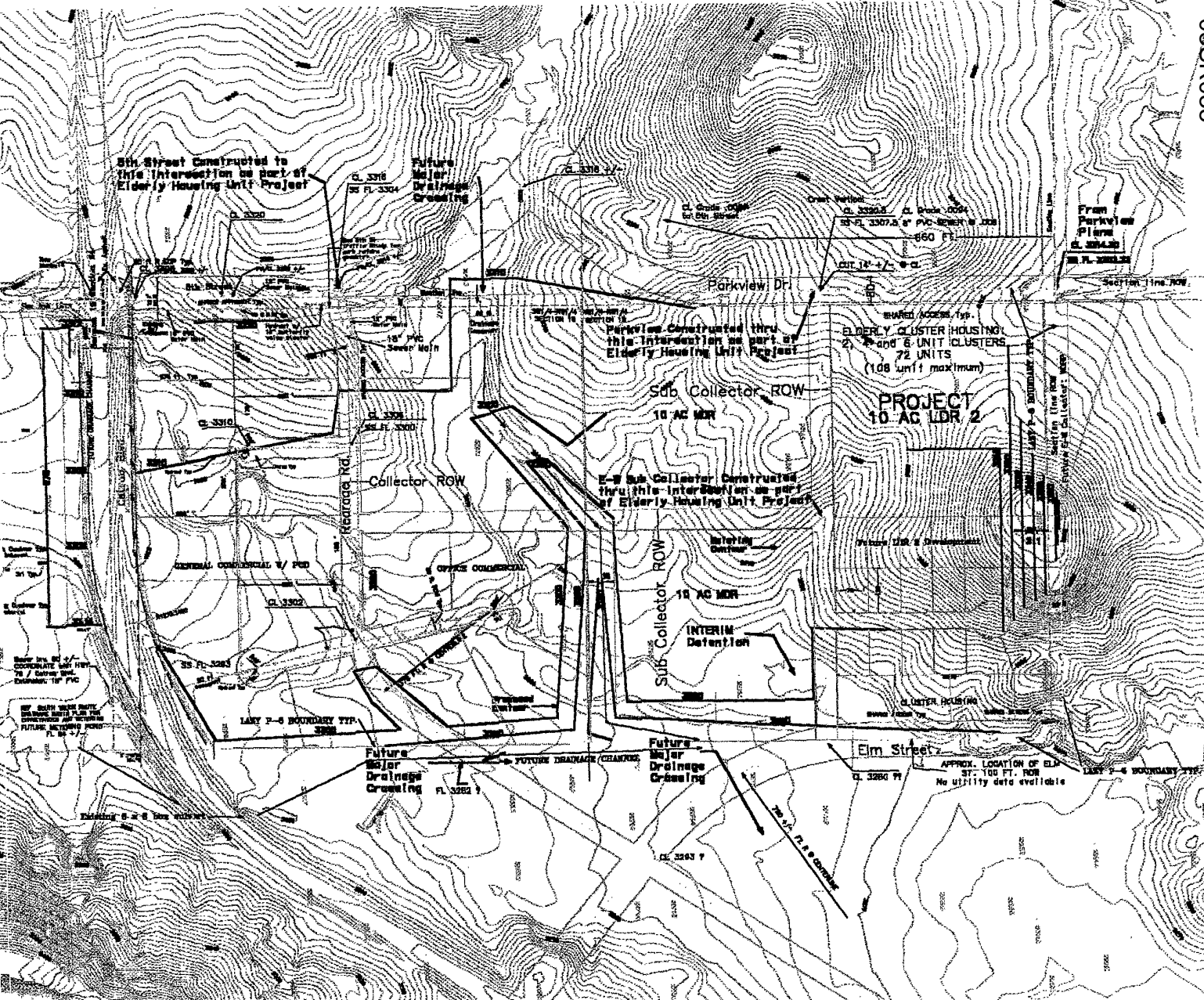

5th Street Constructed to
this intersection as part of
Elderly Housing Unit Project

Future
Major
Drainage
Crossing

Parkview Constructed thru
this intersection as part of
Elderly Housing Unit Project

Sdb Collector ROW
10 AC MGR

E-W Sub Collector Constructed
thru this intersection as part
of Elderly Housing Unit Project

Sub Collector ROW
10 AC MGR

INTERIM
Detention

PROJECT
10 AC LDR 2

ELDERLY CLUSTER HOUSING
2, 4 and 8-UNIT CLUSTERS
72 UNITS
(1.08 unit/maximum)

Future
Major
Drainage
Crossing

Elm Street

APPROX. LOCATION OF ELW
ST. 100 FT. ROW
No utility data available