

RECEIVED

AUG 09 2002

Rapid City
Planning Department

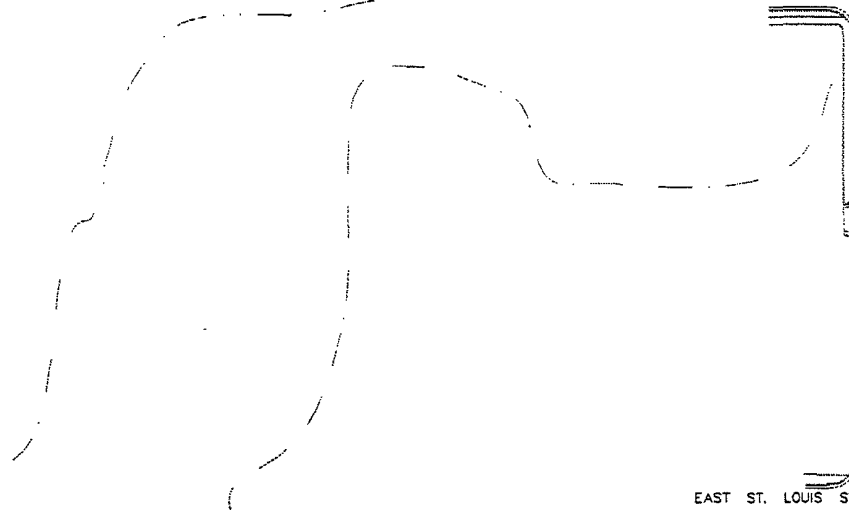

HERMAN STREET
EAST ST. LOUIS ST.

LANDSCAPE LEGEND:

- EXISTING DECIDUOUS TREE
- EXISTING EVERGREEN TREE
- EXISTING SHRUB
- NEW LARGE DECIDUOUS TREE
- NEW SMALL ORNAMENTAL TREE
- NEW EVERGREEN TREE
- NEW SHRUB PLANTINGS
- NEW SEEDDED AREA
- NEW SEEDDED AREA
- EROSION CONTROL FABRIC

LANDSCAPE MATERIAL TABLE

DEVELOPED AREA:	684,382 SF		
ICE RINK AREA:	34,825 SF		
RECREATION CENTER AREA:	53,400 SF		
TOTAL LANDSCAPE POINTS REQUIRED:	579,337		
LANDSCAPE POINTS			
PLANT TYPE	QUANTITY	POINTS	TOTAL
EXISTING TREES:	31	2,000	62,000
EXISTING SHRUBS:	10	250	2,500
PROPOSED LARGE TREE:	99	2,000	198,000
PROPOSED SMALL TREE:	23	500	11,500
PROPOSED SHRUBS:	85	250	21,250
TURF AREA:	33,103 SY	10	331,030
TOTAL ON-SITE LANDSCAPE POINTS:			648,280

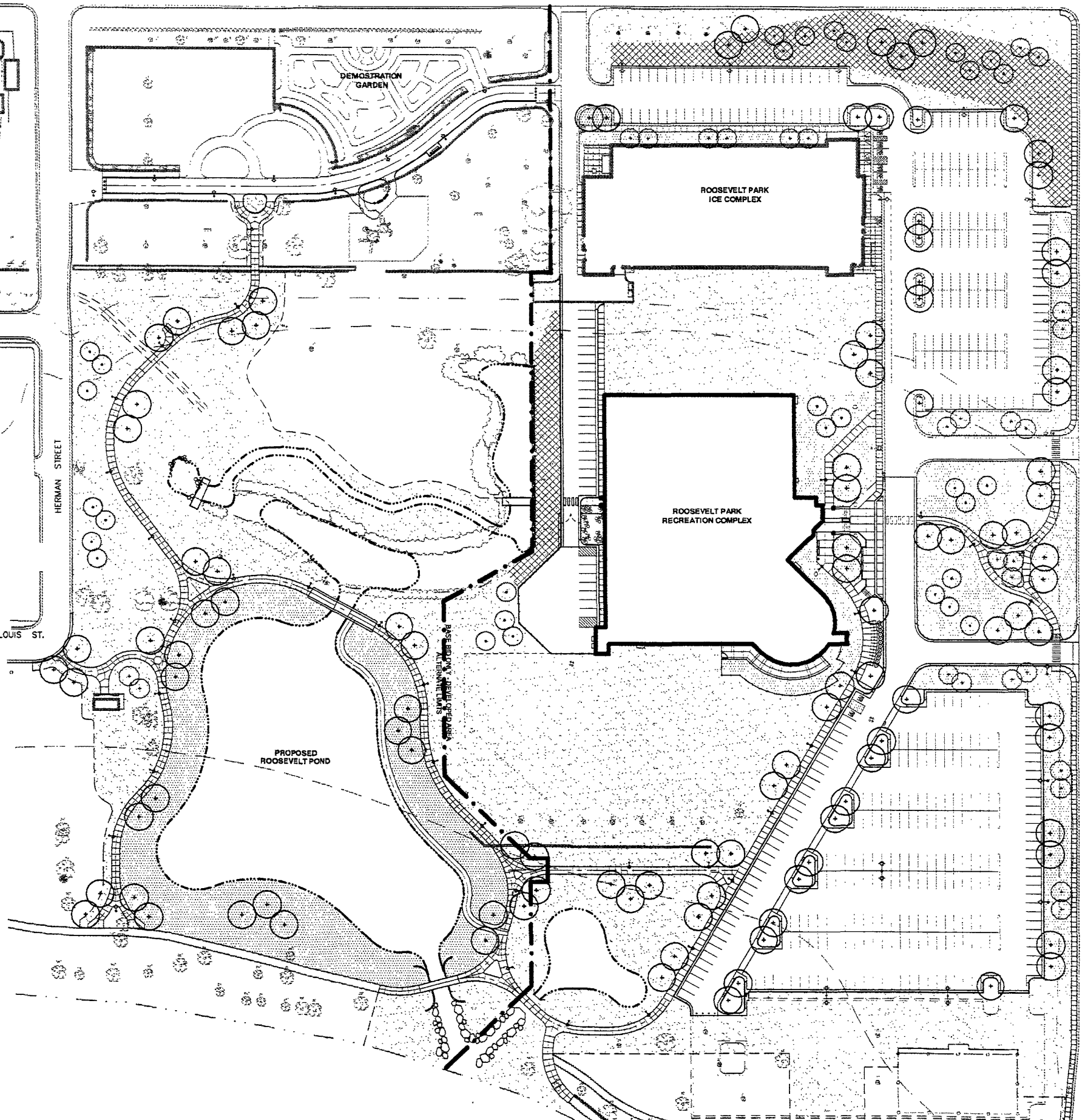

Park Landscape Plan
Roosevelt Park
Site Improvements - Phase 2
Rapid City, South Dakota

PROJECT NO: R0144
FILE NAME: RP-CITY-LSCAPE.DWG
DATE: AUG. 9, 2002

