

Notes:
 Specifications to be used: CITY OF HOUSTON CITY STANDARD SPECIFICATIONS FOR PUBLIC WORKS, where applicable.

Maintain access through existing roadway.

Place and maintain all forms above base of concrete curb and sidewalk. Remove forms as necessary. Reconcile City standard details 14 7a to 7c. See location on plans, adjust as needed or as directed by City.

Prevent runoff from existing construction area. Repair runoff as needed.

Provide 4 inch x 4 inch x 1/2 inch x 1/2 inch clean rock transition between existing pavement and work area across points until final paving complete.

Grass, dirt, sand, fertilizer, and mulch distributed across immediately upon completion of work, to prevent erosion. Use City "Noat" catch pits and pit.

Match existing grade to Street surface after sidewalk construction. See Finish Grade (FG) schedule.

REVISIONS BY CITY ENGINEERS DRAWING NO. 02PD015
 1. Addendum to the City Standard Specifications for Public Works, 1997 Edition, 11/1/97.

NO.	DATE	DESCRIPTION

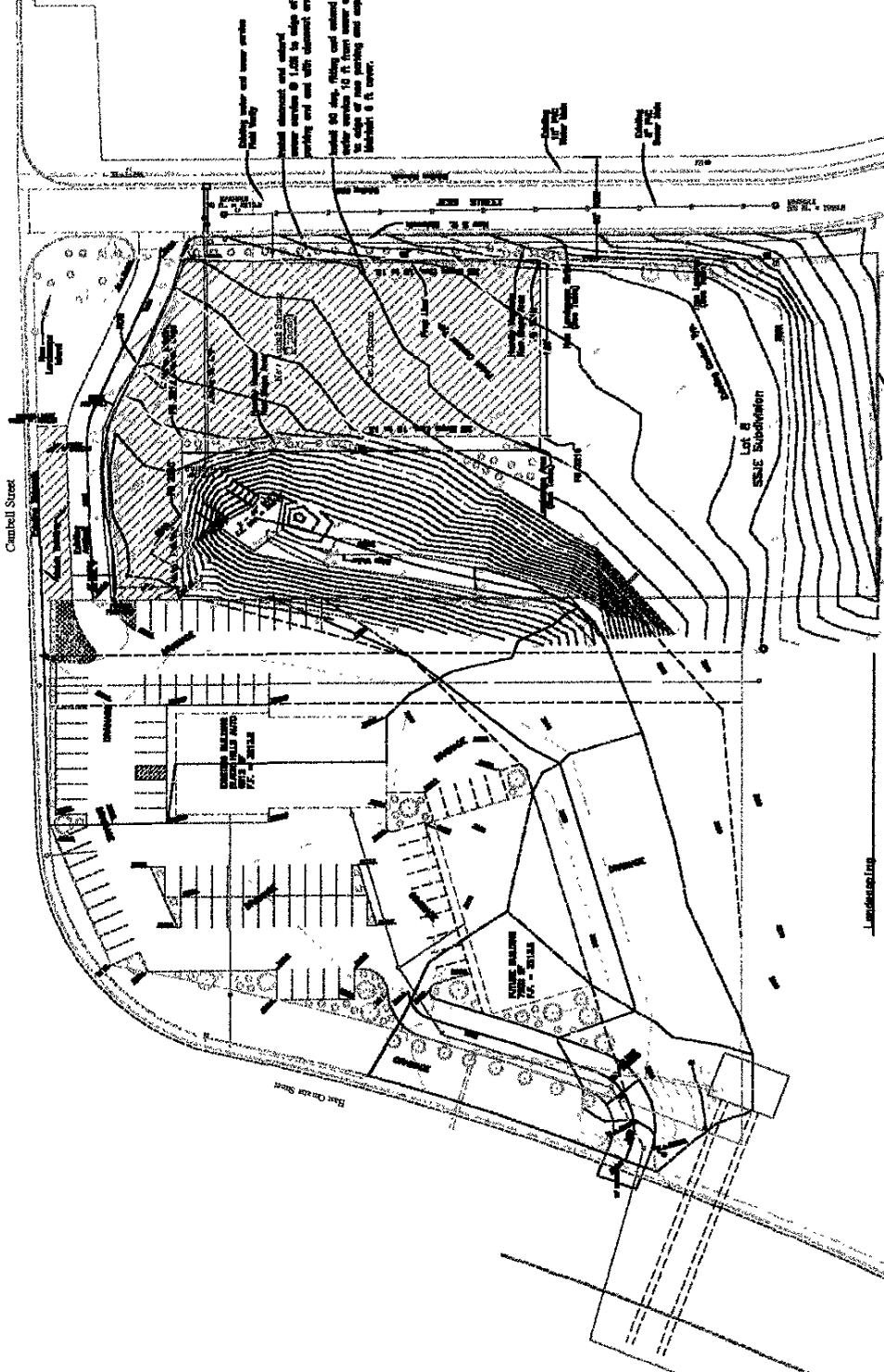

Landscaping

Total Developed Area	58,000 S.F.
Points Required	58,000

30 Shrubs	7,400 Points
2 Large Trees	4,100 Points
6 Medium Trees	6,000 Points
Grass (400 S.F.)	6,000 Points

Points Provided	27,500 Points
-----------------	---------------

Supply materials compatible with local growing conditions. Plant in accordance with supplier's recommendations.

