

SITE PLAN - LOT 2 OF LOT K2-C OF MARSHALL HEIGHTS TRACT

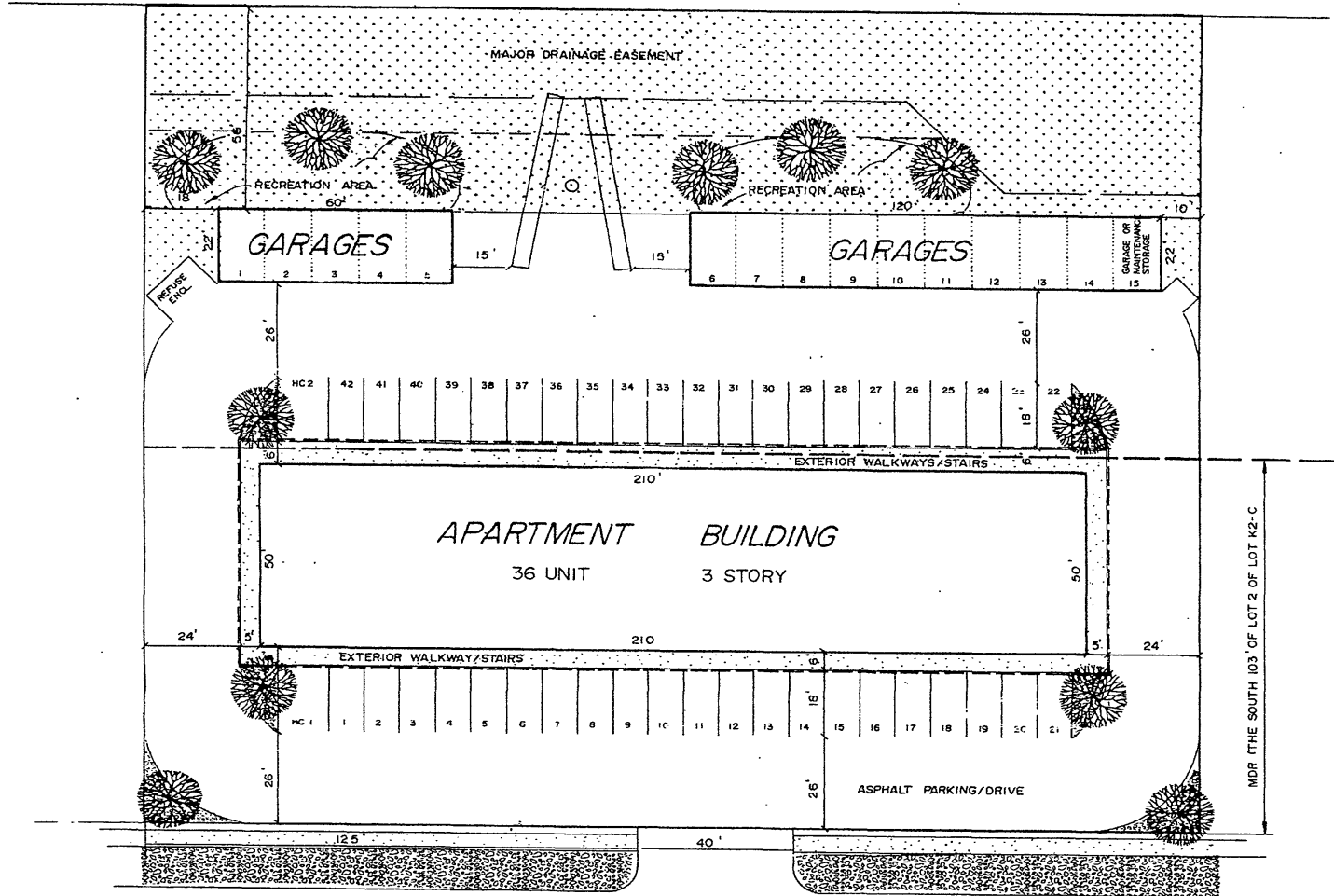

LANDSCAPE REQUIREMENTS

Total Lot Area	60,418
Less Building Area	-10,500
Less Garage Area	- 1,960
Total Required Points	49,958
Points Demonstrated	
Grass - 1,665 sy	16,650
Ground Cover - 300 sy	30,000
Small Trees - 12	6,000
Total Points Demonstrated	52,650

NOTE: Landscaping shown hereon demonstrates the sites ability to support the required points. Specific planting materials and locations, which comply with the total point requirements shall be determined by the developer at the time of application for a building permit.

PARKING REQUIREMENTS

Total Required Parking	
36 units @ 1.5/unit	54
Parking Demonstrated	
Standard parking spaces	42
Handicap parking spaces	2
Garage units	15
Total Parking Demonstrated	59

01PD031

KNOLLWOOD DRIVE