

01CA018

"A"

225

1.00  
24.60

700

700

700

18.2-004

3.03

18-1-005

3.04

25.00

"F"

1.00

1009

54.00

GOLDEN EAGLE DR.

DEN EAGLE

"O"

40.00

2000

1316.0

16

37-23A

37-23B

37-23E

37-23F

ALADDIN DR.

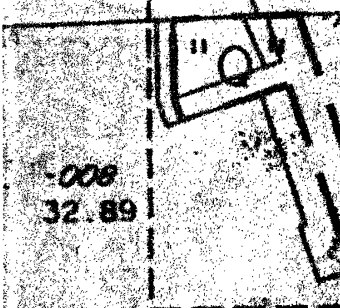
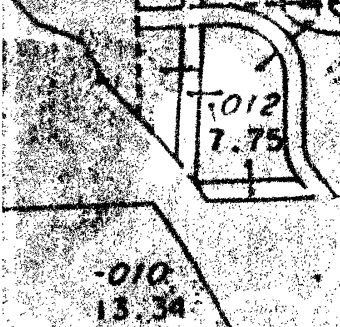
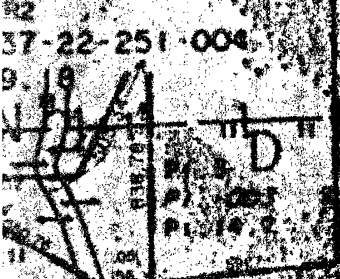
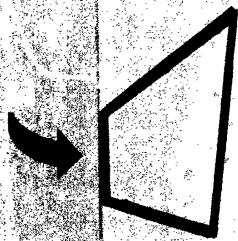

Detail L, 37-11

CORP.

CITY

CORP.

26A RAPID

26B

LINE