

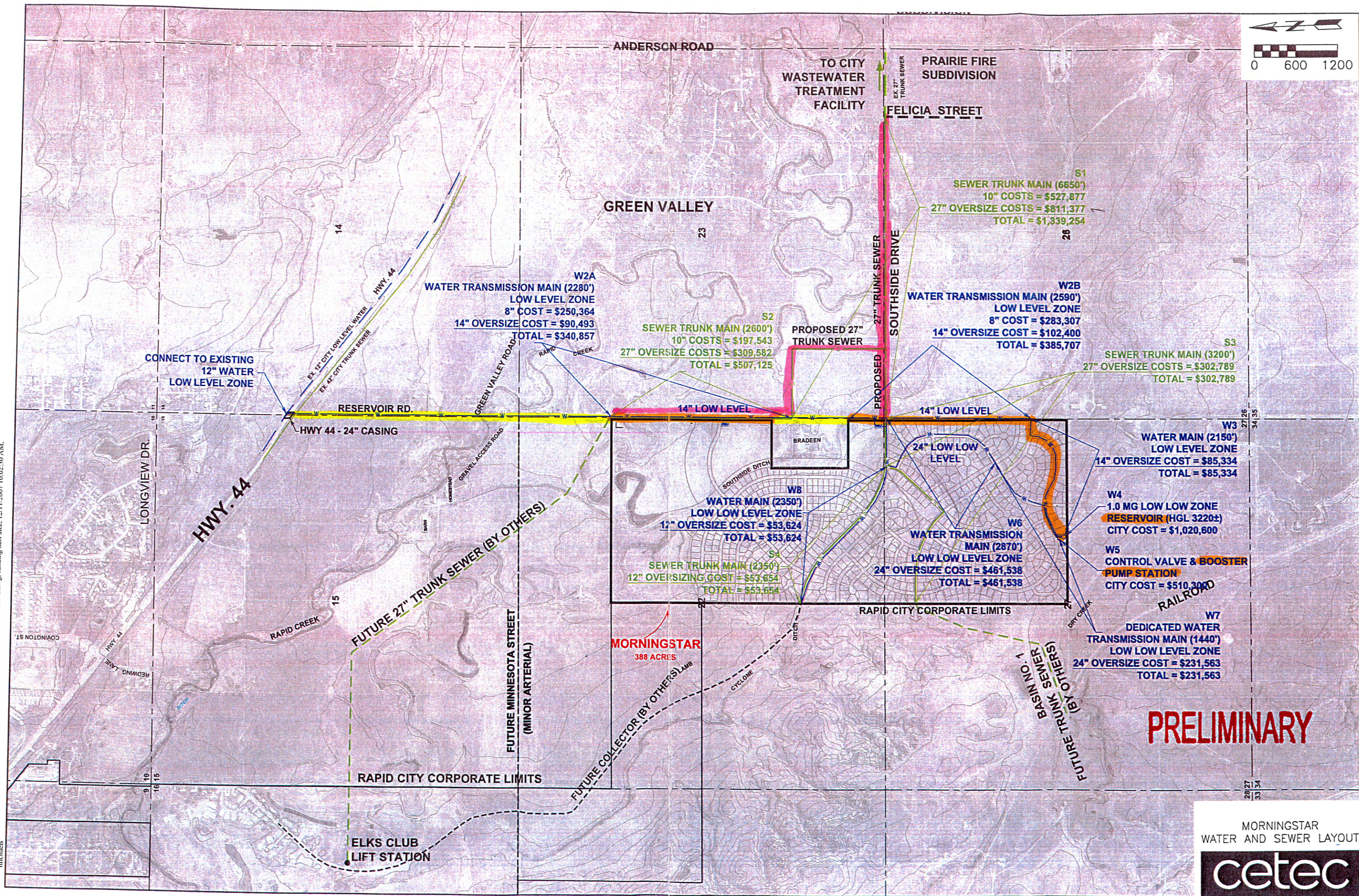

C:\CETEC\06164.00 Morningstar\Presentations\exhibits\WATER SEWER 10-17-07.archive.dwg, funding_half_size, 12/11/2007 10:02:30 AM, michaels



CONNECT TO EXISTING 12" WATER LOW LEVEL ZONE

HWY. 44

RESERVOIR RD.

HWY 44 - 24" CASING

FUTURE 27" TRUNK SEWER (BY OTHERS)

RAPID CITY CORPORATE LIMITS

ELKS CLUB LIFT STATION

ANDERSON ROAD

GREEN VALLEY

W2A
WATER TRANSMISSION MAIN (2280')
LOW LEVEL ZONE
8" COST = \$250,364
14" OVERSIZE COST = \$90,493
TOTAL = \$340,857

S2
SEWER TRUNK MAIN (2600')
10" COSTS = \$197,543
27" OVERSIZE COSTS = \$309,582
TOTAL = \$507,125

PROPOSED 27" TRUNK SEWER

14" LOW LEVEL

MORNINGSTAR
388 ACRES

FUTURE COLLECTOR (BY OTHERS)

FUTURE MINNESOTA STREET (MINOR ARTERIAL)

BRADEN

W8
WATER MAIN (2350')
LOW LOW LEVEL ZONE
12" OVERSIZE COST = \$53,624
TOTAL = \$53,624

S4
SEWER TRUNK MAIN (2350')
12" OVERSIZING COST = \$53,654
TOTAL = \$53,654

RAPID CITY CORPORATE LIMITS

W6
WATER TRANSMISSION MAIN (2870')
LOW LOW LEVEL ZONE
24" OVERSIZE COST = \$461,538
TOTAL = \$461,538

W4
1.0 MG LOW LOW ZONE RESERVOIR (HGL 3220±)
CITY COST = \$1,020,600

W5
CONTROL VALVE & BOOSTER PUMP STATION
CITY COST = \$510,300

FUTURE TRUNK SEWER (BY OTHERS)
BASIN NO. 1

W7
DEDICATED WATER TRANSMISSION MAIN (1440')
LOW LOW LEVEL ZONE
24" OVERSIZE COST = \$231,563
TOTAL = \$231,563

TO CITY WASTEWATER TREATMENT FACILITY

EX. 27" TRUNK SEWER

FELICIA STREET

PROPOSED 27" TRUNK SEWER

SOUTHSIDE DRIVE

W2B
WATER TRANSMISSION MAIN (2590')
LOW LEVEL ZONE
8" COST = \$283,307
14" OVERSIZE COST = \$102,400
TOTAL = \$385,707

14" LOW LEVEL

S1
SEWER TRUNK MAIN (6650')
10" COSTS = \$527,877
27" OVERSIZE COSTS = \$811,377
TOTAL = \$1,339,254

S3
SEWER TRUNK MAIN (3200')
27" OVERSIZE COSTS = \$302,789
TOTAL = \$302,789

W3
WATER MAIN (2150')
LOW LEVEL ZONE
14" OVERSIZE COST = \$85,334
TOTAL = \$85,334

PRELIMINARY

MORNINGSTAR WATER AND SEWER LAYOUT

