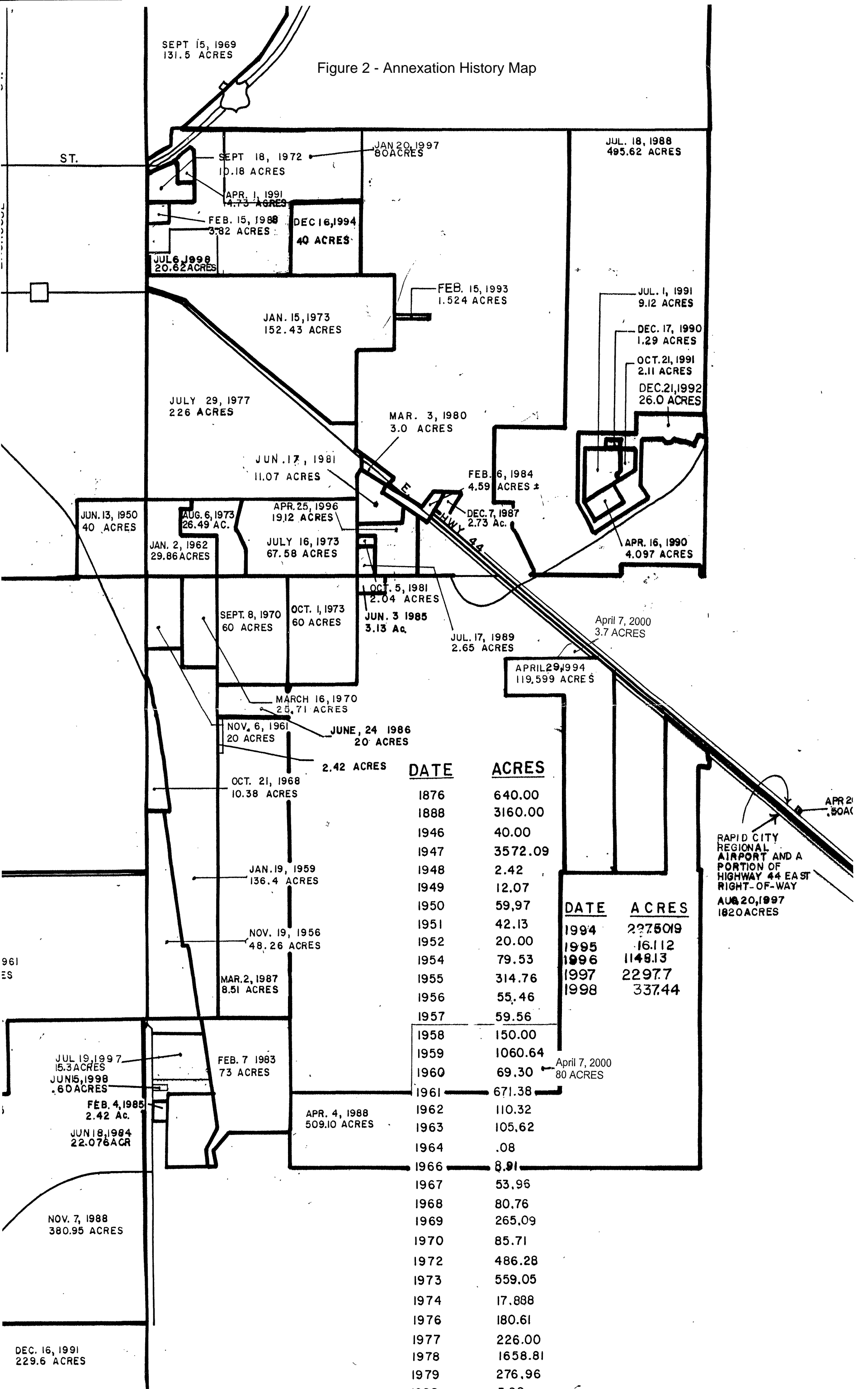

Figure 2 - Annexation History Map



SEPT 15, 1969
131.5 ACRES

ST.

SEPT 18, 1972
10.18 ACRES

JAN 20, 1997
80 ACRES

JUL. 18, 1988
495.62 ACRES

APR. 1, 1991
4.73 ACRES

FEB. 15, 1988
3.82 ACRES

DEC 16, 1994
40 ACRES

JUL 6, 1998
20.62 ACRES

FEB. 15, 1993
1.524 ACRES

JUL. 1, 1991
9.12 ACRES

JAN. 15, 1973
152.43 ACRES

DEC. 17, 1990
1.29 ACRES

JULY 29, 1977
226 ACRES

OCT. 21, 1991
2.11 ACRES

DEC. 21, 1992
26.0 ACRES

MAR. 3, 1980
3.0 ACRES

JUN. 17, 1981
11.07 ACRES

FEB. 6, 1984
4.59 ACRES ±

JUN. 13, 1950
40 ACRES

AUG. 6, 1973
26.49 AC.

APR. 25, 1996
19.12 ACRES

DEC. 7, 1987
2.73 AC.

APR. 16, 1990
4.097 ACRES

JAN. 2, 1962
29.86 ACRES

JULY 16, 1973
67.58 ACRES

OCT. 5, 1981
2.04 ACRES

April 7, 2000
3.7 ACRES

SEPT. 8, 1970
60 ACRES

OCT. 1, 1973
60 ACRES

JUN. 3 1985
3.13 Ac.

JUL. 17, 1989
2.65 ACRES

APRIL 29, 1994
119,599 ACRES

MARCH 16, 1970
25.71 ACRES

NOV. 6, 1961
20 ACRES

JUNE, 24 1986
20 ACRES

2.42 ACRES

OCT. 21, 1968
10.38 ACRES

DATE

ACRES

1876	640.00
1888	3160.00
1946	40.00
1947	3572.09
1948	2.42
1949	12.07
1950	59.97
1951	42.13
1952	20.00
1954	79.53
1955	314.76
1956	55.46
1957	59.56

JAN. 19, 1959
136.4 ACRES

NOV. 19, 1956
48.26 ACRES

MAR. 2, 1987
8.51 ACRES

DATE

ACRES

1994	22750.9
1995	16.112
1996	1148.13
1997	2297.7
1998	337.44

RAPID CITY REGIONAL AIRPORT AND A PORTION OF HIGHWAY 44 EAST RIGHT-OF-WAY

AUG 20, 1997
1820 ACRES

APR 21, 2000
50 ACRES

JUL 19, 1997
15.3 ACRES
JUN 15, 1998
1.60 ACRES

FEB. 7 1983
73 ACRES

FEB. 4, 1985
2.42 Ac.

JUN 18, 1984
22.076 ACR

APR. 4, 1988
509.10 ACRES

1958	150.00
1959	1060.64
1960	69.30
1961	671.38
1962	110.32
1963	105.62
1964	.08
1966	8.91

April 7, 2000
80 ACRES

NOV. 7, 1988
380.95 ACRES

1967	53.96
1968	80.76
1969	265.09
1970	85.71
1972	486.28
1973	559.05
1974	17.888
1976	180.61
1977	226.00
1978	1658.81
1979	276.96

DEC. 16, 1991
229.6 ACRES