

SOUTH DAKOTA HISTORIC SITES INVENTORY

Historic Name _____

Address/Location 1317 MT. RUSHMORE

Common Name _____

Historic Function _____

Historic Context(s) _____

Owner's Name _____

Owner's Address _____

Owner's Phone # _____

Date(s) of Construction _____

Photographer _____

Roll # _____ Frame #'s _____
(Attach Photographs Below)

Site Number

PN RC RC WB 369

CTY TWP CIT NBH NUM

DBASE _____

U.S.G.S. Quad Map Name _____

Legal Description

Q1 Q2 SEC TWP RNG

Urban LOT _____ BLK _____
Only ADD _____

Surveyors _____

Date _____

NR Eligible Yes _____ No _____
Future NR Yes _____ No _____

Significance

HIST ARCH ARCE
 NATL STAT LOCL

PLANNING

Site No. _____

Preservation Strengths of the Site

- _____ In Use and Not Threatened
- _____ In Good Structural Condition
- _____ Owners Protecting Site
- _____ Appreciated by Public
- _____ Valuable to Research

Preservation Threats

- _____ Abandonment
- _____ Deterioration Through Lack of Resources
- _____ Vandalism or Looting
- _____ Inappropriate Alterations
- _____ Inappropriate or Poor Maintenance
- _____ Fragile or Deteriorating Construction Materials
- _____ Unsound Condition
- _____ Lack of Support (Specify by Whom)

- _____ Environmental Situations Effecting Site (Specify What: May Include Mining, Flooding, Erosion, Pollution, Acid Rain, Weather, Isolation, Development, Ect.)

Site Plan: Indicate all door and window openings, roof shapes, and landscape features.



Indicate North

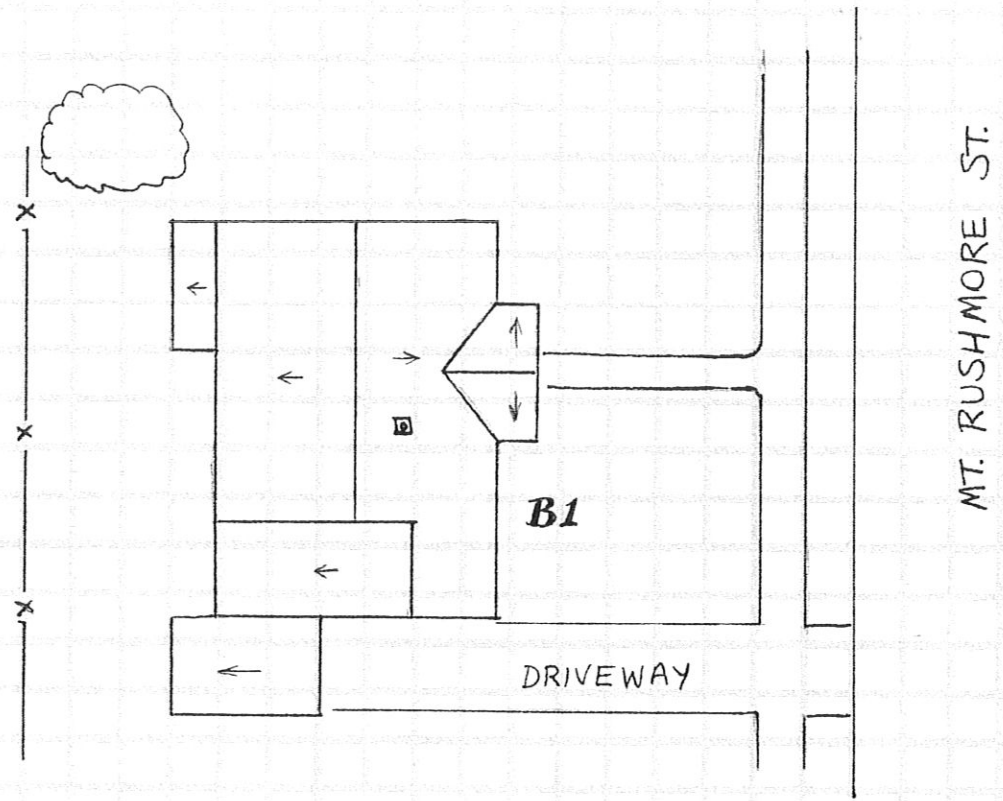

SOUTH DAKOTA HISTORIC SITES INVENTORY

Historic

Name Bert & Daisy Collier House

Address/

Location 1317 Mount Rushmore Road

Common

Name Jan L. Thompson-Counseling

Historic

Function House

Historic

Context(s) V. Depression & Rebuilding: D.
Changing Urban Patterns: 3.
Residential Changes

Owner's Name Jan Thompson

Owner's Address 1317 Mount Rushmore Road
Rapid City, SD 57701

Owner's Phone # (605) 341-3112

Date(s) of Construction circa 1924

Photographer M. McCormick

Roll # 6 Frame #'s 33-35

(Attach Photographs Below)

Site Number

PN -RC -RC -WB -00369
CTY TWP CIT NBH NUM

DBASE 0000000000

U.S.G.S. Quad Map Name

Legal Description

0
Q1 Q2 SEC TWP RNG
Urban Only BLK 38
LOT E107' L22-23
ADD Boulevard

Surveyors

M. McCormick/RTI

Date 07/02/1992

NR Eligible Y

Future NR Y

Significance HIST, ARCH
LOCL

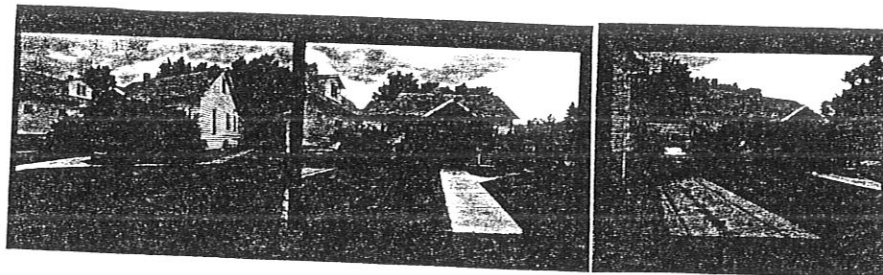

Preservation Strengths of the Site

- In Use and Not Threatened
- In Good Structural Condition
- Owners Protecting Site
- Appreciated by Public
- Valuable to Research

Preservation Threats

- Abandonment
- Deterioration Through Lack of Resources
- Vandalism or Looting
- Inappropriate Alterations
- Inappropriate or Poor Maintenance
- Fragile or Deteriorating Construction Materials
- Unsound Condition
- Lack of Support (Specify by Whom)

Environmental Situations Effecting Site (Specify What: May Include Mining, Flooding, Erosion, Pollution, Acid Rain, Weather, Isolation, Development, Etc.)

Extensive commerical development along Mount Rushmore Road

Dates:

Founding of Institution or Settlement 1876
Town and Addition Plated 1877 1886 Initial Construction of Structure 1924

Original Owners:

Name (Include Spouse if Known) Bert & Daisy Collier
Place of Origin
Date Arrived in S.D. 0000 In USA 0000

Occupation(s) Bert: plumber

Religious Affiliation
Social/Fraternal Affiliation

Other Previous Owners:

Names and Dates of Occupation

Structural History:

Architect's Name and
Date of Commission

Builder's Name
Pattern, Book and Number/Name

Historic Uses of the Site House

Changes in Use House & Office

Statement of Historical Significance: (Including Relation to Historic Context Topics and Study Units)

The Bert & Daisy Collier House has the potential to contribute to the West Boulevard Historic District. It is significant for its association with the growth and development of the West Boulevard neighborhood in Rapid City from 1878-1942. Built circa 1924, the house corresponds to the rebuilding phase of residential development in Rapid City (1897-1929), a period in which the West Boulevard neighborhood rapidly grew in response to tremendous population growth in the city. The house helps to illustrate the varied economic status of the neighborhood's inhabitants during this era and serves as a representative example of residential architecture common at the time.

Miscellaneous Historical Information:

Research indicates that the house was built in about 1924, replacing an early and smaller dwelling on the property.

Bibliography:

Oral Interview (Name, Date & Relationship to Site)

Atlas (Date & Publisher)

County History (Title & Pages)

Deed Abstract

Tax Records Assessors' Card: 1907

Sanborn-Ferris Maps (Dates)

1923-early & smaller house; 1930-present house

Census Records

Historical Photos (Description & Date)

Manuscripts (Name & Date)

Directories (Type & Date)

R.L. Polk: 1928

Other Sources Rapid City Public Works, Sewer Permit #596: Bert Collier, April 1924

General Information:

Building # 1

Site No. PN-RC -RC-WB-00369 Date of Construction c.1924 Photos 33-35

Function House & garage Plan Form Rectangular + garage Height (Stories) 1
 Style Vernacular Method of Construction Wood-frame Overall Condition

Additions & Alterations (Types & Dates)

Shed wing on rear (west) appears to be an historic alteration. The fixed windows on the front (east) are modern replacements

Evaluation of Specific Elements:

Foundation: Materials Concrete Condition E

Walls: Cladding Clapboard Condition

Windows: General/ Unique	Type	Glazing Pattern	Condition	Location
G	Double-hung, wood-sash	1/1	E	
U	Modern fixed	Single	E	East

Doors: Type	Glazing Pattern	Condition	Location
Wood-paneled	1/2 light; 3x3	E	East

Roof: Form Side gable Materials Asphalt shingles Condition E

Dormer: Type Condition
 Location(s)

Chimneys/Ventilators: Materials Brick chimney Condition E
 Location(s) Interior: east slope

Porches: Materials	Condition	Height (Stories)	Roof Configuration	Location
Open: clapboard rails	E	1	Front gable	East

Bays/Towers: Form	Condition	Height (Stories)	Location(s)

Significant Exterior Details:

Attached garage: on south wall of house is original to the house or an early addition (pre-1930); it is a shed-roofed building with clapboard siding and outswinging wood-paneled doors with 3x3 glazing.

Significant Interior Details:

Not accessed