

Map Service: -Select from the following-

About Layers Legend Search Selection Set Keymap Bookmarks Print Map Settings Help PDF Maps Exit

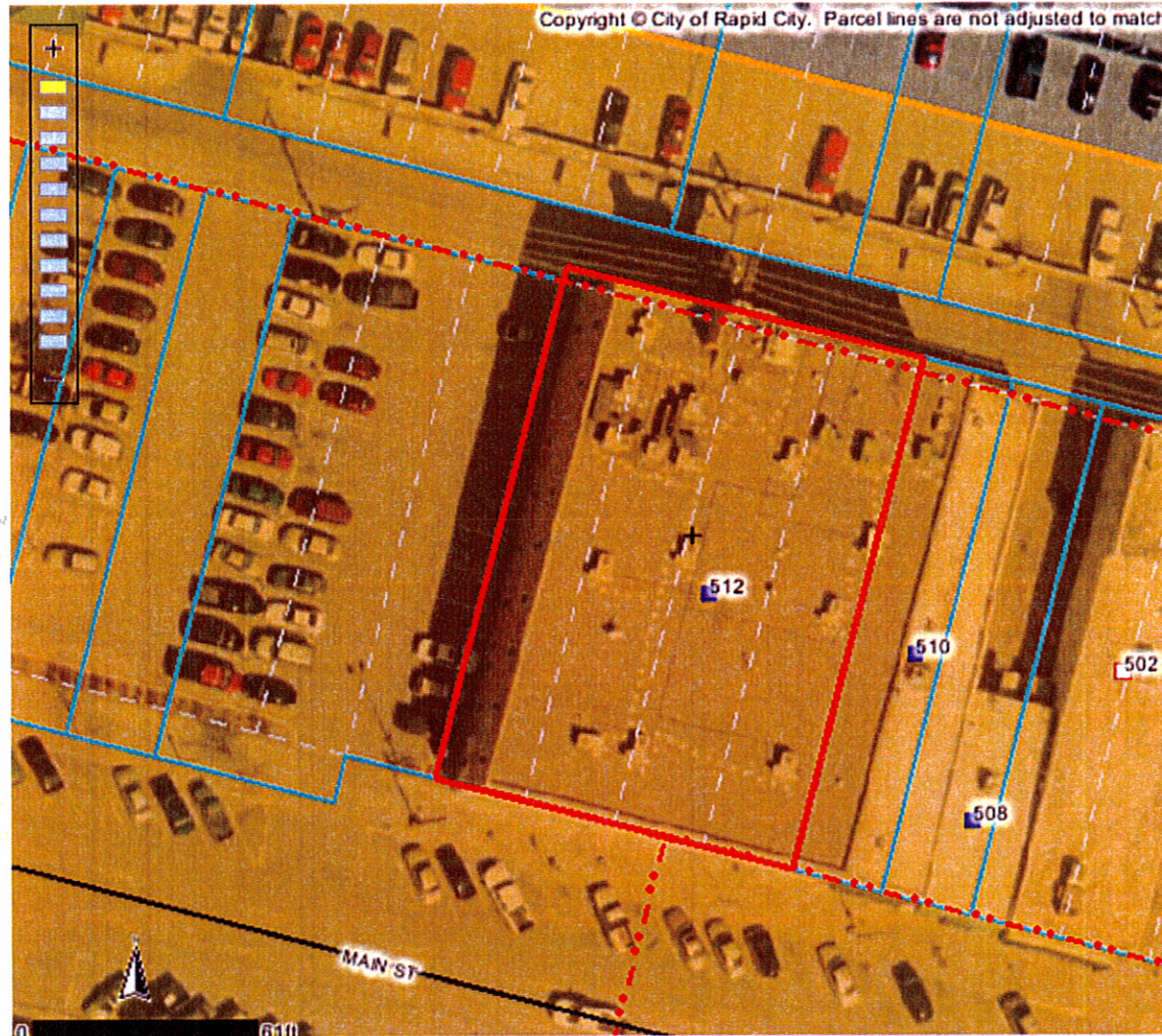

Identify Results

Coordinate Position

NAD 1983 SP SD South FT: 1208577, 650327
 Geographic: 44° 4' 52.63" N, 103° 13' 33"

Tax Parcels

Parcel ID number: 3701128011
 Tax ID: 37327
 Property address: 512 MAIN ST
 Legal description: LOT 24-27 & VACATED ALLEY ADJ TO SAID LOTS

Block: 75
 Subdivision: ORIGINAL TOWN OF RAPID CIT
 Section: 1
 Township: 1
 Township direction: N
 Range: 7
 Range direction: E
 Acres: 0.33
 Property owner: MHL LLC
 Owner address: PO BOX 8303
 Owner city: RAPID CITY
 Owner state: SD
 Owner zip: 57709
 Land assessment: 210000
 Non-ag struct. assess.: 1882600
 Ag structure assess.: 0
 Total assessment: 2092600
 Land use code: N
 Land type code: D
 Improvements code: 2
 Commercial use code: C
 Tax districts code: 4D RC
 Subdivision code: 7480
 Deed type: WD
 Deed recording month: 12
 Deed recording day: 02
 Deed recording year: 10
 Book number: 204

Scale: 1: 612

Quick View: Select a location

Map Tool: **Identify** Active Layer: Tax Parcels

powered by Geocortex