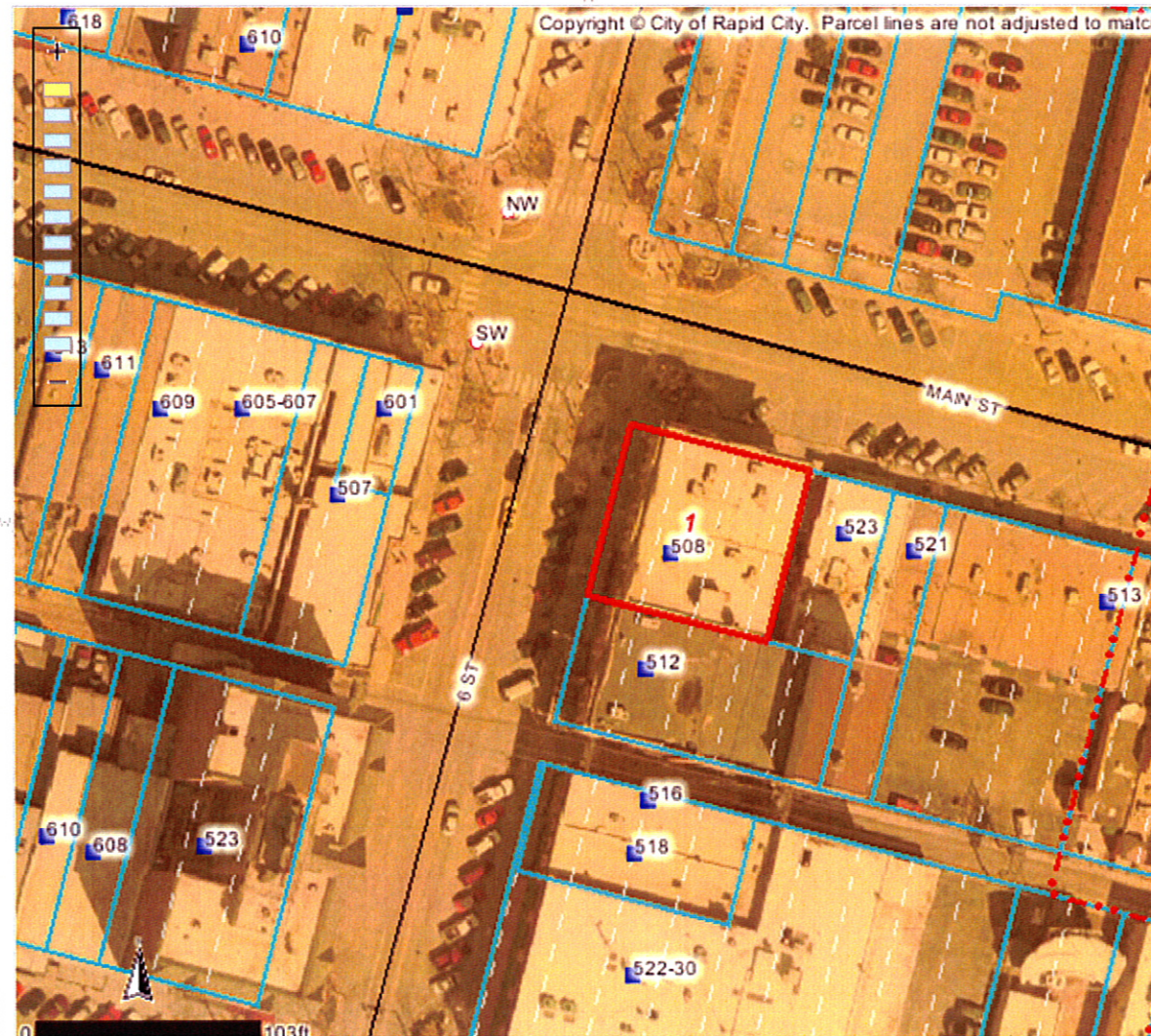

Map Service: -Select from the following-

[About](#) [Layers](#) [Legend](#) [Search](#) [Selection Set](#) [Keymap](#) [Bookmarks](#) [Print Map](#) [Settings](#) [Help](#) [PDF Maps](#) [Exit](#)
**Identify Results****Coordinate Position**

NAD 1983 SP SD South FT: 1208364, 650150

Geographic: 44° 4' 50.81" N, 103° 13' 36"

**Tax Parcels**

Parcel ID number: 3701131001  
 Tax ID: 37446  
 Property address: 508 6TH ST  
 Legal description: W10' OF LOT 13, ALL OF LOT 14  
 16 EXCEPTS59.5' OF LOT 13-16

Block: 85  
 Subdivision: ORIGINAL TOWN OF RAPID CIT  
 Section: 1  
 Township: 1  
 Township direction: N  
 Range: 7  
 Range direction: E  
 Acres: 0.16  
 Property owner: DOWNTOWN ELKS BUILDING  
 LLC

Owner address: 2834 JACKSON BLVD STE 202  
 Owner city: RAPID CITY  
 Owner state: SD  
 Owner zip: 57702  
 Land assessment: 102600  
 Non-ag struct. assess.: 1130200  
 Ag structure assess.: 0  
 Total assessment: 1232800  
 Land use code: N  
 Land type code: D  
 Improvements code: 2  
 Commercial use code: C  
 Tax districts code: 4D RC  
 Subdivision code: 7480  
 Deed type: WD  
 Deed recording month: 09  
 Deed recording day: 28  
 Deed recording year: 10

Scale: 1: 1,028

Quick View: [Select a location](#)Map Tool: **Identify** Active Layer: **Tax Parcels**powered by **Geocortex**