

Map Service: -Select from the following-

About Layers Legend Search Selection Set Keymap Bookmarks Print Map Settings Help PDF Maps Exit

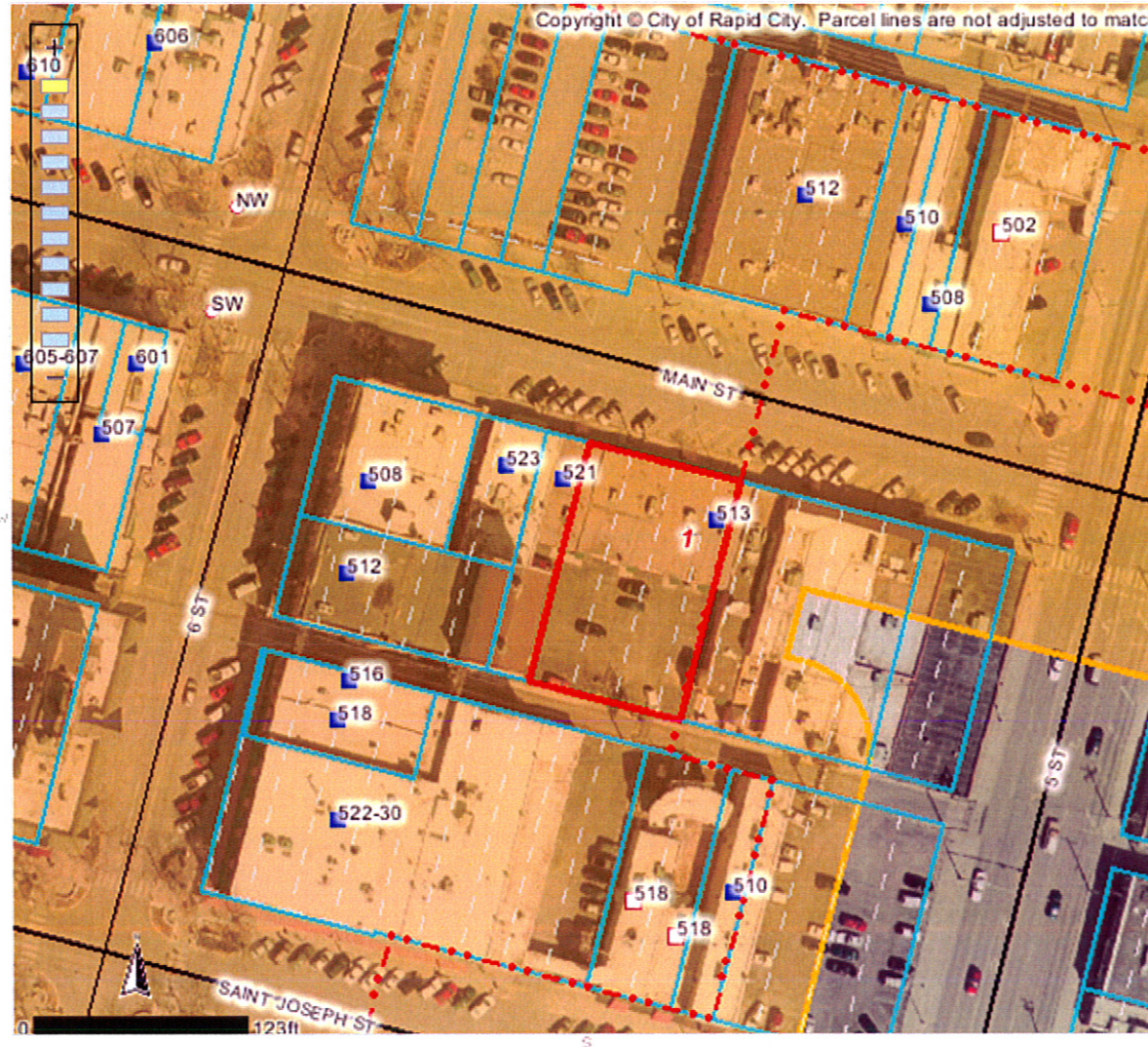

Identify Results

Coordinate Position

NAD 1983 SP SD South FT: 1208493, 650122  
Geographic: 44° 4' 50.5" N, 103° 13' 34.:

Tax Parcels

Parcel ID number: 3701131004  
Tax ID: 37442  
Property address: 513 MAIN ST  
Legal description: W14.4' OF LOT 7 & ALL OF LOT 8-10  
Block: 85  
Subdivision: ORIGINAL TOWN OF RAPID CIT  
Section: 1  
Township: 1  
Township direction: N  
Range: 7  
Range direction: E  
Acres: 0.29  
Property owner: LEE CONSOLIDATED HOLDINGS CO

Owner address: 507 MAIN ST  
Owner city: RAPID CITY  
Owner state: SD  
Owner zip: 57701  
Owner zip +4: 2733  
Land assessment: 187400  
Non-ag struct. assess.: 148200  
Ag structure assess.: 0  
Total assessment: 335600  
Land use code: N  
Land type code: D  
Improvements code: 2  
Commercial use code: C  
Tax districts code: 4D RC  
Subdivision code: 7480  
Deed type: WD  
Deed recording month: 07  
Deed recording day: 31

Scale: 1: 1,280

Quick View: Select a location

Map Tool: Identify Active Layer: Tax Parcels

