

# Customer Approval Form:

Signature: \_\_\_\_\_ Date: \_\_\_\_\_

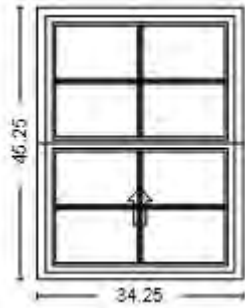

Viewed from the Exterior

Quote Number: 6052758

Line Number: 10

Quote Qty: 5

Scaling: 1/2" = 1'

Description: Impervia, Single Hung, 34.25 X 45.25, Tan

Rough Opening: 34.75" X 45.75"

These drawings are based on our interpretation of the information provided to us. They are submitted for final approval of the individual\*\* responsible for the project and are not intended to create any warranty or other liability. The user\*\* is responsible for compliance with applicable building codes or other regulations and determining the suitability of the suggestions for the particular application, including the final design of reinforcement, flashing, and sealant systems for all window and door installations.  
\*\* building owner, architect, contractor, installer and/or consumer



Quote Name: Immaculate Conception Chapel 9 Project Name: All Bidders IC Chapel 922

Jobsite Location: ,

Room Location: NORTH

Sales Branch Location: 23300 Heartland Pella

# Customer Approval Form:

Signature: \_\_\_\_\_ Date: \_\_\_\_\_

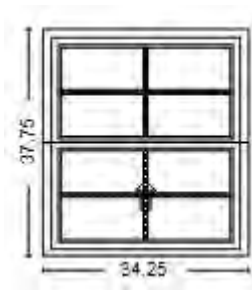

Viewed from the Exterior

Quote Number: 6052758

Line Number: 11

Quote Qty: 1

Scaling: 1/2" = 1'

Description: Impervia, Single Hung, 34.25 X 37.75, Tan

Rough Opening: 34.75" X 38.25"

These drawings are based on our interpretation of the information provided to us. They are submitted for final approval of the individual\*\* responsible for the project and are not intended to create any warranty or other liability. The user\*\* is responsible for compliance with applicable building codes or other regulations and determining the suitability of the suggestions for the particular application, including the final design of reinforcement, flashing, and sealant systems for all window and door installations.  
\*\* building owner, architect, contractor, installer and/or consumer



Quote Name: Immaculate Conception Chapel 9 Project Name: All Bidders IC Chapel 922

Jobsite Location: ,

Room Location: NORTH

Sales Branch Location: 23300 Heartland Pella

# Customer Approval Form:

Signature: \_\_\_\_\_ Date: \_\_\_\_\_

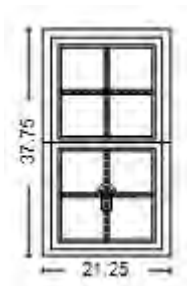

Viewed from the Exterior

Quote Number: 6052758

Line Number: 13

Quote Qty: 1

Scaling: 1/2" = 1'

Description: Impervia, Single Hung, 21.25 X 37.75, Tan

Rough Opening: 21.75" X 38.25"

These drawings are based on our interpretation of the information provided to us. They are submitted for final approval of the individual\*\* responsible for the project and are not intended to create any warranty or other liability. The user\*\* is responsible for compliance with applicable building codes or other regulations and determining the suitability of the suggestions for the particular application, including the final design of reinforcement, flashing, and sealant systems for all window and door installations.  
\*\* building owner, architect, contractor, installer and/or consumer



Quote Name: Immaculate Conception Chapel 9 Project Name: All Bidders IC Chapel 922

Jobsite Location: ,

Room Location: North BATHROOM

Sales Branch Location: 23300 Heartland Pella

# Customer Approval Form:

Signature: \_\_\_\_\_ Date: \_\_\_\_\_

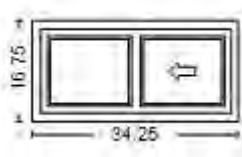

Viewed from the Exterior

Quote Number: 6052758

Line Number: 14

Quote Qty: 1

Scaling: 1/2" = 1'

Description: Impervia, Sliding Window Fixed / Vent Left, 34.25 X 16.75, Tan

Rough Opening: 34.75" X 17.25"

These drawings are based on our interpretation of the information provided to us. They are submitted for final approval of the individual\*\* responsible for the project and are not intended to create any warranty or other liability. The user\*\* is responsible for compliance with applicable building codes or other regulations and determining the suitability of the suggestions for the particular application, including the final design of reinforcement, flashing, and sealant systems for all window and door installations.  
\*\* building owner, architect, contractor, installer and/or consumer



Quote Name: Immaculate Conception Chapel 9 Project Name: All Bidders IC Chapel 922

Jobsite Location: ,

Room Location: South BATHROOM

Sales Branch Location: 23300 Heartland Pella

# Customer Approval Form:

Signature: \_\_\_\_\_ Date: \_\_\_\_\_

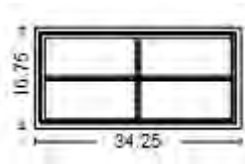

Viewed from the Exterior

Quote Number: 6052758

Line Number: 20

Quote Qty: 1

Scaling: 1/2" = 1'

Description: Impervia, Direct Set Fixed Frame Rectangle, 34.25 X 16.75, Tan

Rough Opening: 34.75" X 17.25"

These drawings are based on our interpretation of the information provided to us. They are submitted for final approval of the individual\*\* responsible for the project and are not intended to create any warranty or other liability. The user\*\* is responsible for compliance with applicable building codes or other regulations and determining the suitability of the suggestions for the particular application, including the final design of reinforcement, flashing, and sealant systems for all window and door installations.  
\*\* building owner, architect, contractor, installer and/or consumer



Quote Name: Immaculate Conception Chapel 9 Project Name: All Bidders IC Chapel 922

Jobsite Location: ,

Room Location: SOUTH SMALL

Sales Branch Location: 23300 Heartland Pella

# Customer Approval Form:

Signature: \_\_\_\_\_ Date: \_\_\_\_\_

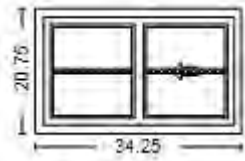

Viewed from the Exterior

Quote Number: 6052758

Line Number: 21

Quote Qty: 4

Scaling: 1/2" = 1'

Description: Impervia, Sliding Window Fixed / Vent Left, 34.25 X 20.75, Tan

Rough Opening: 34.75" X 21.25"

These drawings are based on our interpretation of the information provided to us. They are submitted for final approval of the individual\*\* responsible for the project and are not intended to create any warranty or other liability. The user\*\* is responsible for compliance with applicable building codes or other regulations and determining the suitability of the suggestions for the particular application, including the final design of reinforcement, flashing, and sealant systems for all window and door installations.  
\*\* building owner, architect, contractor, installer and/or consumer



Quote Name: Immaculate Conception Chapel 9 Project Name: All Bidders IC Chapel 922

Jobsite Location: ,

Room Location: SOUTH

Sales Branch Location: 23300 Heartland Pella

# Customer Approval Form:

Signature: \_\_\_\_\_ Date: \_\_\_\_\_



Viewed from the Exterior

Quote Number: 6052758

Line Number: 35

Quote Qty: 7

Scaling: 1/2" = 1'

Description: 2-1/2" Frame Expander, Length: 96, Tan

Rough Opening:

These drawings are based on our interpretation of the information provided to us. They are submitted for final approval of the individual\*\* responsible for the project and are not intended to create any warranty or other liability. The user\*\* is responsible for compliance with applicable building codes or other regulations and determining the suitability of the suggestions for the particular application, including the final design of reinforcement, flashing, and sealant systems for all window and door installations.  
\*\* building owner, architect, contractor, installer and/or consumer



Quote Name: Immaculate Conception Chapel 9 Project Name: All Bidders IC Chapel 922

Jobsite Location: ,

Room Location: 8FT

Sales Branch Location: 23300 Heartland Pella

# Customer Approval Form:

Signature: \_\_\_\_\_ Date: \_\_\_\_\_



Viewed from the Exterior

Quote Number: 6052758

Line Number: 40

Quote Qty: 12

Scaling: 1/2" = 1'

Description: 2-1/2" Frame Expander, Length: 144, Tan

Rough Opening:

These drawings are based on our interpretation of the information provided to us. They are submitted for final approval of the individual\*\* responsible for the project and are not intended to create any warranty or other liability. The user\*\* is responsible for compliance with applicable building codes or other regulations and determining the suitability of the suggestions for the particular application, including the final design of reinforcement, flashing, and sealant systems for all window and door installations.  
\*\* building owner, architect, contractor, installer and/or consumer



Quote Name: Immaculate Conception Chapel 9 Project Name: All Bidders IC Chapel 922

Jobsite Location: ,

Room Location: 12FT

Sales Branch Location: 23300 Heartland Pella



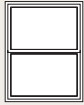

SINGLE-HUNG

# UNIT SECTIONS

## Frame Types



STANDARD  
BLOCK FRAME

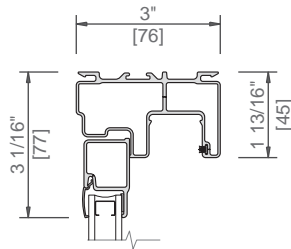

INTEGRAL NAILING FIN

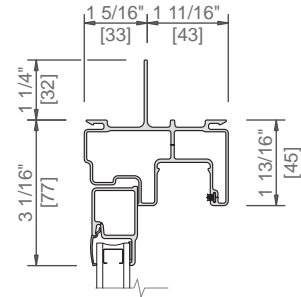

BLOCK FRAME  
STANDARD FIN

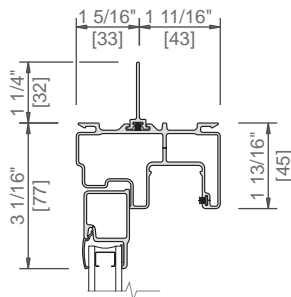

FLUSH FLANGE

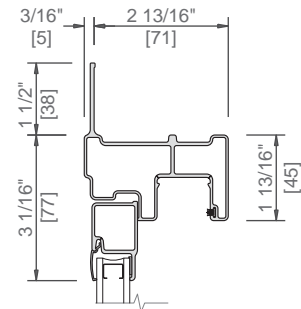

BLOCK FRAME  
OFFSET FIN

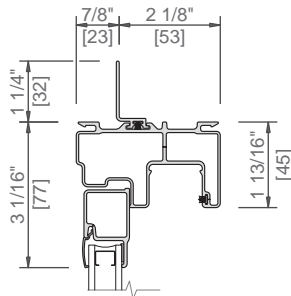

BLOCK FRAME  
DP50 SILL DAM

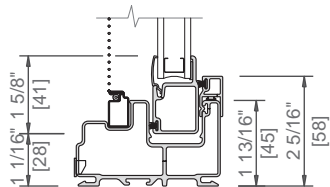

Scale 3" = 1' 0"

All dimensions are approximate.

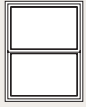

SINGLE-HUNG

## UNIT SECTIONS

Block Frame

Fixed Unit

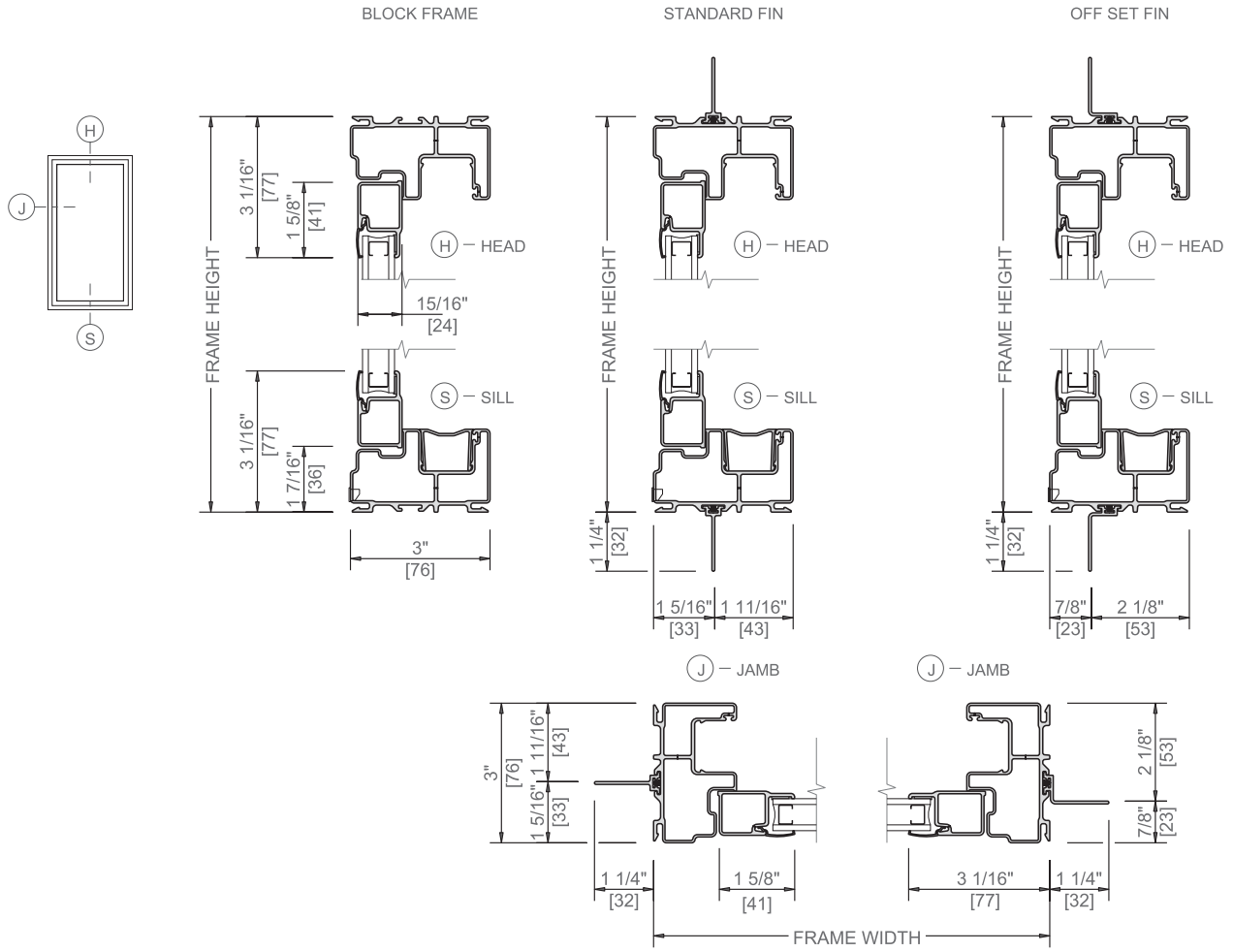

### TYPICAL JOINING MULLIONS

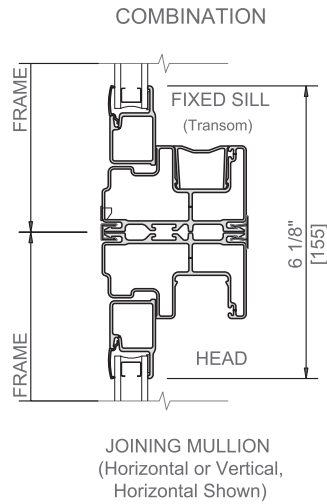

Scale 3" = 1' 0"

All dimensions are approximate.

See Combination section for mullion application and structural limitations.

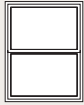

SINGLE-HUNG

## UNIT SECTIONS

### Block Frame

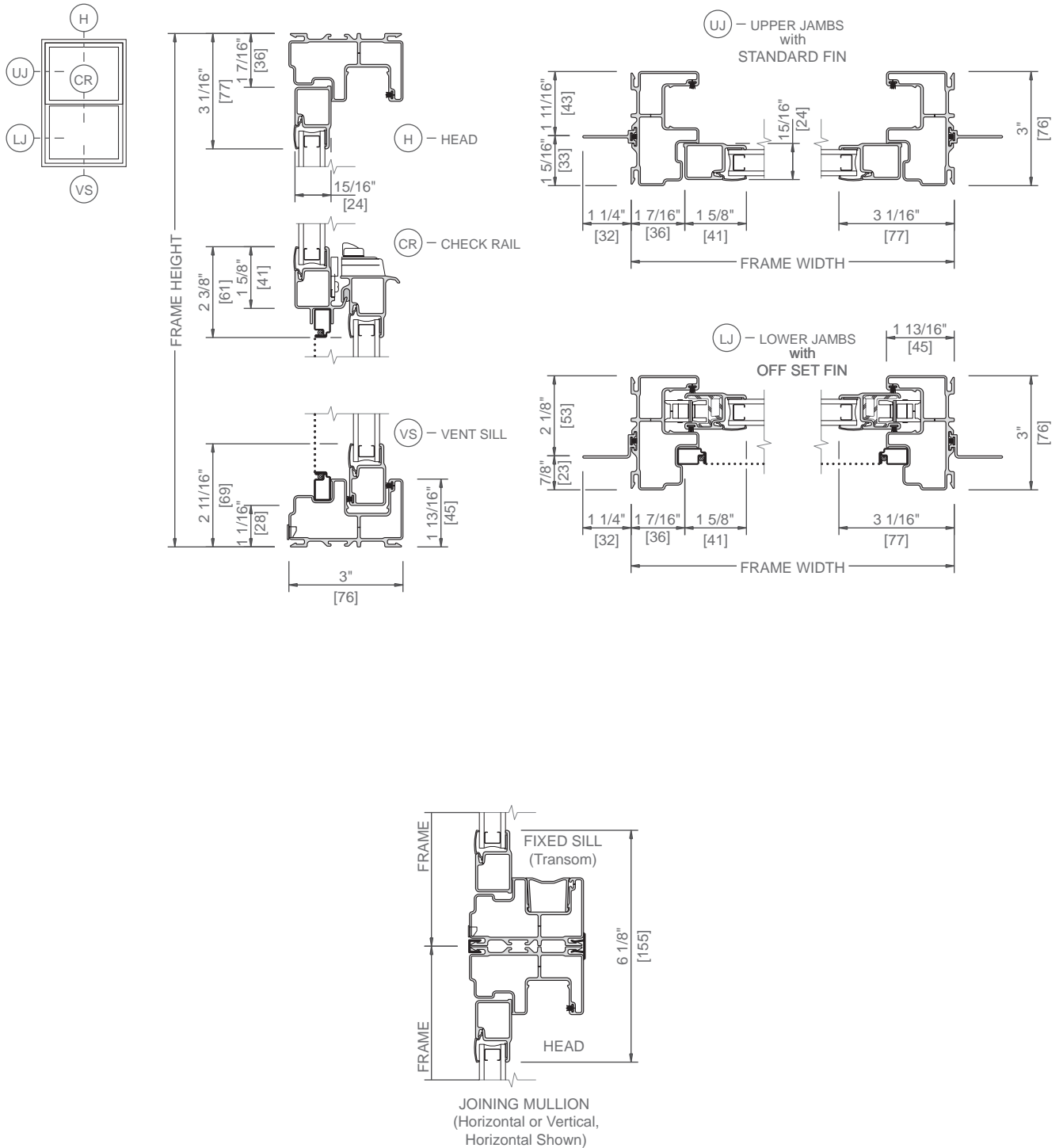

Scale 3" = 1' 0"

All dimensions are approximate.

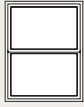

SINGLE-HUNG

# UNIT SECTIONS

## Integral Nailing Fin Frame / Flush Flange Frame

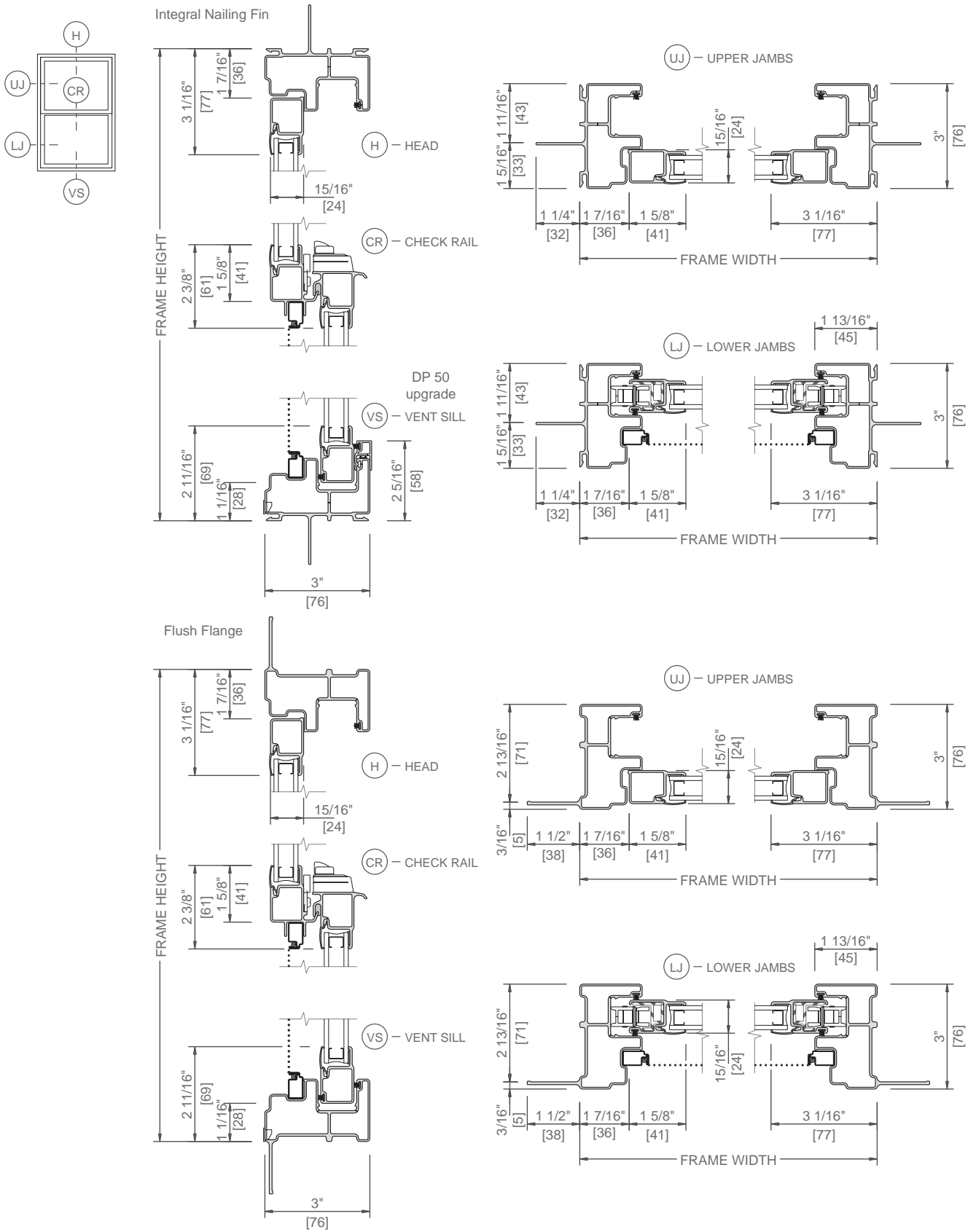

Scale 3" = 1' 0"

All dimensions are approximate.

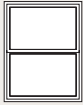

SINGLE-HUNG

# UNIT SECTIONS

## Block Frame with Integral Mullion Composites

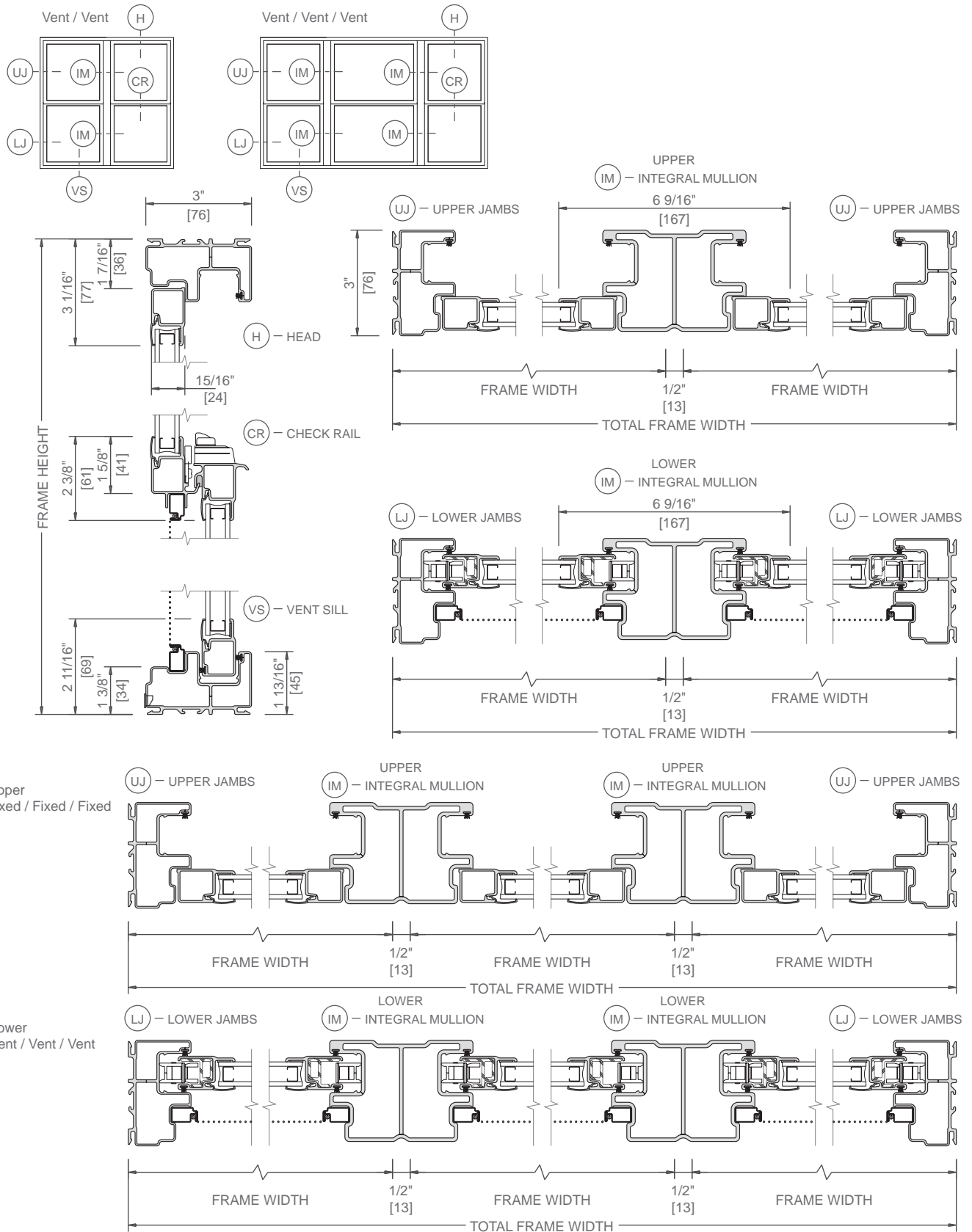

Scale 3" = 1' 0"

All dimensions are approximate.

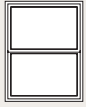

SINGLE-HUNG

# UNIT SECTIONS

## Block Frame with Integral Mullion Composites

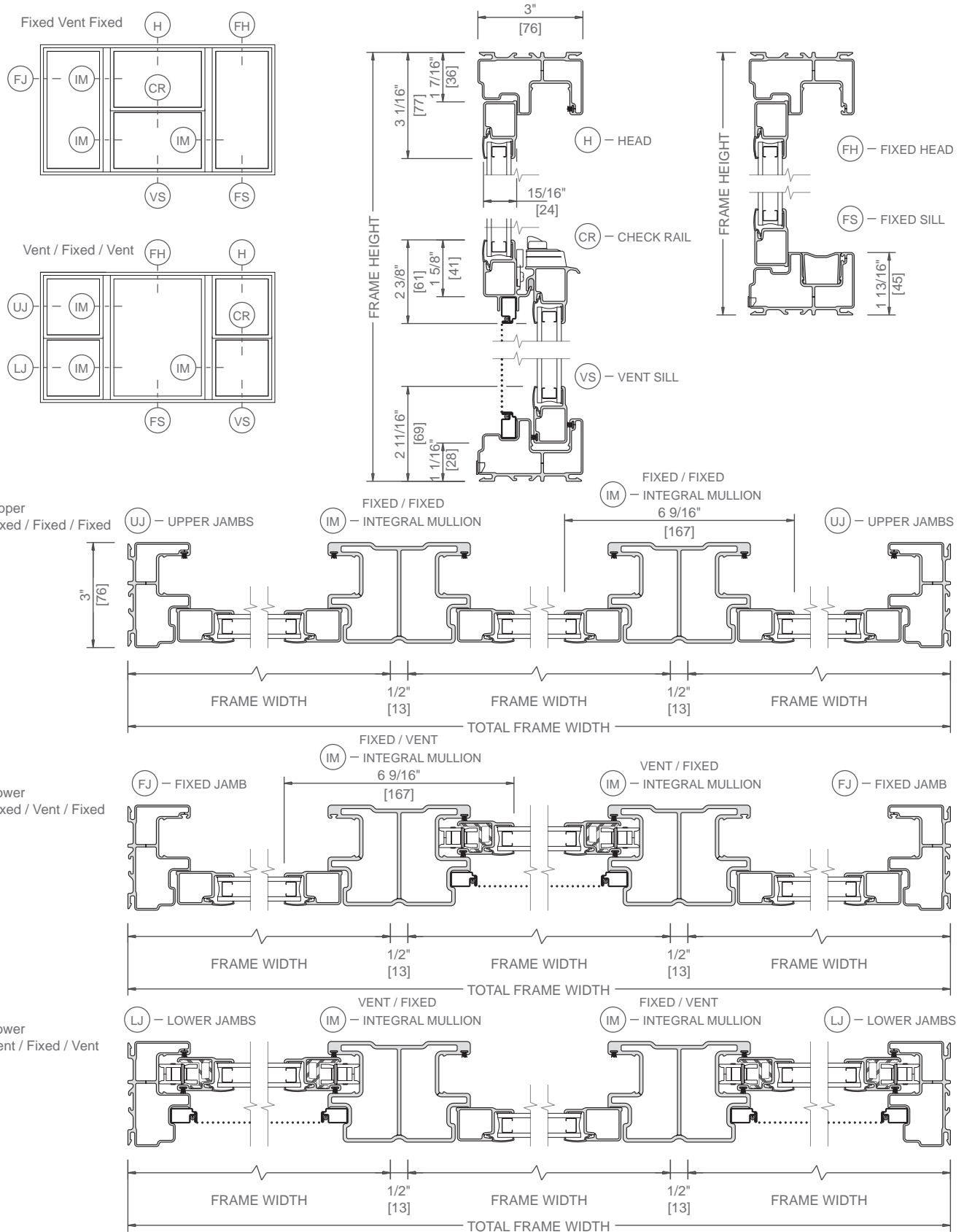

Scale 3" = 1' 0"

All dimensions are approximate.