

Community Planning & Development Services

City of Rapid City

300 Sixth Street, Rapid City, SD 57701-2724

Phone: (605) 394-4120

Fax: (605) 394-6636

Web: www.rcgov.org

**Historic
Preservation
11.1 Review**

Date of Submission: _____

Time of Submission: _____

Location Address: 940 Skyline DriveYear Constructed: 1936

Historic District:

☐ West Boulevard Historic District☐ Environs of West Boulevard Historic District☐ Downtown Historic District☐ Environs of Downtown Historic District☐ Individually Listed Property☒ Environs of an Individually Listed Property

Status:

☒ Contributing☐ Non-Contributing

Type:

☒ Commercial☐ Residential

Brief description of project request:

Planned improvements at Dinosaur Park include large vehicle parking upgrades to the existing parking lot, pedestrian crossing improvements, landscaping and sign improvements.

Applicant (*if different from owner*)

Phone Number

Fax Number

☒ Owner ☐ Architect ☐ Contractor

Street Address

City, State, Zip Code

Applicant's Signature

Date

City of Rapid City

605.394.5307

605.394.5307

Owner

Phone Number

Fax Number

Owner's Signature (**Required**)

300 Sixth Street

Rapid City, SD 57702

Street Address

City, State, Zip Code

8/26/14

Date

Applications must be submitted to the Community Planning & Development Services Department by 4:00 p.m. Thursday one week prior to the 1st and 3rd Friday of the month.

All required information must be submitted with the application. Incomplete applications will not be processed.

Historic Preservation Commission meetings are held on the 3rd floor in the West Community Room of the City/School Administration Building, 300 6th Street, at 7:30 a.m. the 1st and 3rd Friday of each month.

A representative must be present at the meeting or the application may be denied.

Date of Meeting

Application File #

Community Planning & Development Services

City of Rapid City

300 Sixth Street, Rapid City, SD 57701-2724

Phone: (605) 394-4120

Fax: (605) 394-6636

Web: www.rcgov.org

Historic Preservation 11.1 Review

Checklist for required information to be submitted with application:

- ☒ Completed Historic Preservation 11.1 Review Application Form
- ☒ Several color photographs of the existing structure that include:
 - ☒ A street frontage photo
 - ☒ Photos of all areas affected by the proposed project
 - ☐ 3-5 photos of rot or decay of an element that is to be replaced or repaired
- ☒ A site plan drawn to scale showing the existing structure(s) and the proposed project changes. The site plan should clearly create a graphic representation of the building footprint(s) and any other elements that are part of the request.
- ☒ Elevation sketches drawn to scale showing the proposed changes. The elevation sketches should provide a view that shows each affected exterior wall as though you were looking straight at it, with any relevant changes represented.
- ☒ A written description of the proposed project request that includes:
 - ☒ Description of the materials to be used in the project
 - ☒ Description of the materials to be replaced in the project (i.e. wood siding, masonite siding, cedar shakes, 4" reveal clapboard, dutch-lap, ship-lap, etc.)
 - ☒ Whether this project is attempting to qualify for the State Tax Moratorium (*if you are not sure what this is, don't hesitate to ask!*)
- ☐ Floor plan information drawn to scale and proposed changes **if interior work** is being requested. (Required for non-residential structures).
- ☒ Document demonstrating feasible and prudent alternatives have been considered for the project, describing how all possible efforts have been made to minimize harm to the historic property.

Staff to provide:

- ☐ Aerial map of the property
- ☐ Historic Site Inventory Description (if applicable)
- ☐ Elements of the structure(s) listed as contributing factors on the Historic Site Inventory



CITY OF RAPID CITY

Department of Parks and Recreation

515 West Boulevard
Rapid City, SD 57701
(605) 394-4175 -- FAX (605) 394-5307

Date: August 26, 2014
To: Historic Preservation Commission
From: Alex DeSmidt, Landscape Designer
Re: Historic Preservation 11.1 Review of the
Proposed Dinosaur Park Parking Lot Improvements

Project Narrative:

The proposed improvement project is focused on parking improvements and pedestrian safety at the Dinosaur Park Parking lot in conjunction with a trail and trailhead development project within the adjacent Skyline Wilderness Park. No work is being proposed on Dinosaur Hill or the west side of Skyline for development within this application.

The current configuration and size of the lot at Dinosaur Park does not accommodate large recreational vehicles, tour buses, public transportation and EMS vehicles. This project aims to accommodate these vehicles within a restricted footprint without decreasing the existing total number of spaces for public parking.

With an estimated 50,000+ annual visitors to Dinosaur Park this parking lot needs to be able to accommodate large vehicles while accommodating passenger vehicles and pedestrians within a confined area. This configuration does not affect any of the five large dinosaur sculptures – which are the only features listed on the National Register of Historic Places (NRHP) or any component with the NRHP boundary. All improvements fall within the 50-foot environs of this individually listed property known as Dinosaur Park.

No federal funds will be used for these improvements and the project is not attempting to qualify for the State Tax Moratorium. Funding for this project is from the City Vision Fund and the Parks and Recreation Capital Improvement Project Budget.

Feasible and Prudent Alternatives Consideration:

No work will remove or alter any historic or potentially historic or contributing components within Dinosaur Park, a National Registered Historic Place. The parking lot has seen several improvements since its development in the 1930's. The latest parking lot improvement project was completed in 1998 which developed the existing parking lot configuration.

The existing grades of the site limit the footprint that parking can occupy along Skyline Drive limiting the expansion and improvement possibilities for development. The parking lot pavement will be asphalt and match the existing road and parking lot. Site amenities and features have been selected to match existing materials used throughout the Park and along Skyline Drive. Wood and stone features are both used structurally and aesthetically to liken to the materials used during the initial Works Progress Administration (WPA) and subsequent projects along Skyline Drive and atop the adjacent Dinosaur Hill.

Parking and pedestrian improvements will match existing asphalt and concrete with paint markings. Retaining walls will utilize redi-rock “ledgestone” colored and textured concrete construction to provide a more natural aesthetic with structural integrity. Wood railing fence shall be used in conjunction with landscaping to direct pedestrians and soften the hardscape.



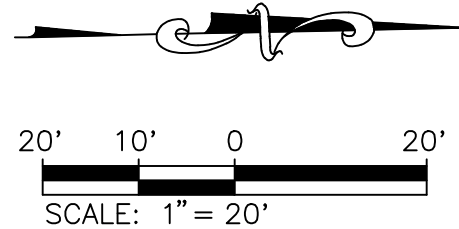

TOPO LEGEND

▲	CONTROL POINT	✱	RAILROAD SIGNAL
●	TEMPORARY CONTROL POINT	● BH#	BORHOLE OR TESTHOLE
○	R.O.W. MONUMENT	●	UNKNOWN MANHOLE
—	IRON PIPE	●	COLUMN
—	IRON ROD	●	MAILBOX
—	POWER POLE	—	BUILDING
—	POWER/LIGHT POLE	—	CONCRETE
—	LIGHT POLE	—	GUARDRAIL
—	GUY POLE	—	RAILROAD
—	GUY WIRE	—	SANITARY SEWER
—	TRAFFIC LIGHT	—	WATER LINE
—	ELECTRIC MANHOLE OR METER	—	STORM SEWER
—	TELEPHONE	—	BARBED WIRE FENCE
—	TELEPHONE BOX	—	CHAIN LINK FENCE
—	TELEPHONE MANHOLE	—	WOOD FENCE
—	CABLE TV BOX	—	WOVEN WIRE FENCE
—	GAS METER/VALVE	—	OHP OVERHEAD POWER
—	WATER MANHOLE	—	OHC OVERHEAD CABLE TV
—	WELL/TYPE	—	OHT OVERHEAD TELEPHONE
—	WATER VALVE	—	TV UG CABLE TV (UNKNOWN)
—	POST INDICATOR VALVE	—	UGT UNDERGROUND ELECTRIC (UNKNOWN)
—	CURB STOP	—	UGT UNDERGROUND TELEPHONE (UNKNOWN)
—	FIRE HYDRANT	—	FO FIBER OPTIC
—	YARD HYDRANT	—	G GAS LINE (UNKNOWN)
—	SPRINKLER HEAD	—	KNB KANEB PIPELINE
—	WATER METER	—	MDU MONTANA DAKOTA UTILITIES
—	CATHODIC TEST STATION	—	WBI WILLISTON BASIN INTERSTATE PIPELINE
—	HOSE BIBB	—	BEC BUTTE ELECTRIC UG
—	SANITARY MANHOLE	—	BHE BLACK HILLS ELEC UG
—	SEWER CLEAN OUT	—	BHP BLACK HILLS POWER UG
—	SEPTIC TANK	—	CWT GOLDEN WEST
—	WOOD OR STEEL POST	—	KNO KNOLOGY COMMUNICATIONS
—	VENT	—	MIDCO MIDCONTINENT COMMUNICATIONS
—	STUMP	—	MRT MOUNT RUSHMORE TELEPHONE
—	BUSH	—	CLNK CENTURY LINK COMMUNICATIONS
—	DECIDUOUS TREE	—	WRE WEST RIVER ELEC UG
—	CONIFEROUS TREE	—	ACP ASBESTOS CEMENT PIPE
—	STORM SEWER MANHOLE	—	CIP CAST IRON PIPE
—	SINGLE POST SIGN OR PARK METER	—	CMP CORRUGATED METAL PIPE
—	MULTI POST SIGN	—	DIP DUCTILE IRON PIPE
—	DELINEATOR	—	FRP FIBERGLASS REINFORCED PIPE
—		—	HDPE HIGH DENSITY POLYETHYLENE PIPE
—		—	PVC POLYVINYL CHLORIDE PIPE
—		—	RCP REINFORCED CONCRETE PIPE
—		—	VCP VITRIFIED CLAY PIPE

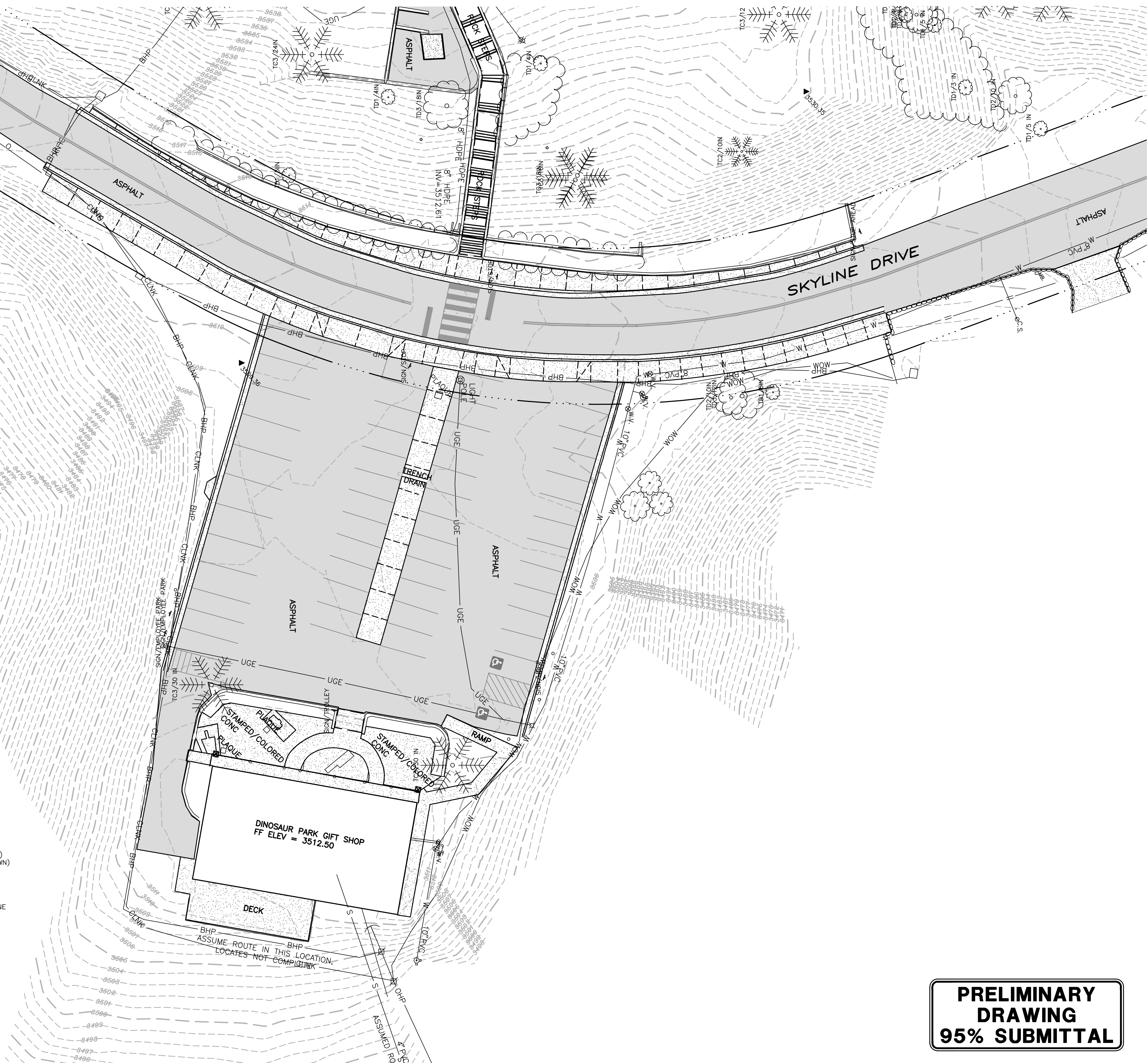

**PRELIMINARY
DRAWING
95% SUBMITTAL**



1560 Concourse Drive
Rapid City, SD 57703
Phone: (605) 341-7800
Fax: (605) 341-7864
www.cetecengineering.com

Prepared For:
Public Works Department
RAPID CITY, SOUTH DAKOTA
Engineering Services

Scale: AS NOTED

Designed By: GW
Drawn By: RF

Design Date: 12/11
Print Date: XXXXX

Internal Job No: 13166.00

Surveyed By: KP/JC/JD
Survey Date: 12/1

Revisions:

**SKYLINE WILDERNESS PARK
TRAILHEAD DEVELOPMENT
RAPID CITY PARKS AND RECREATION**

Sheet Title:
DINOSAUR PARK
EXISTING
SITE TOPOGRAPHY

Sheet:
C1.1

June 04, 2014 4:19:12 p.m.
Drawing: 6109DINO-GRAD.DWG (JOENS) (\\MAIN-DATA\CETEC\PROJECTS & PROPOSALS\13166.00 SKYLINE WILDERNESS AREA TRAILHEAD & DINOSAUR PARK IMPROVEMENTS\DRAWINGS\PLANS\DINO\)

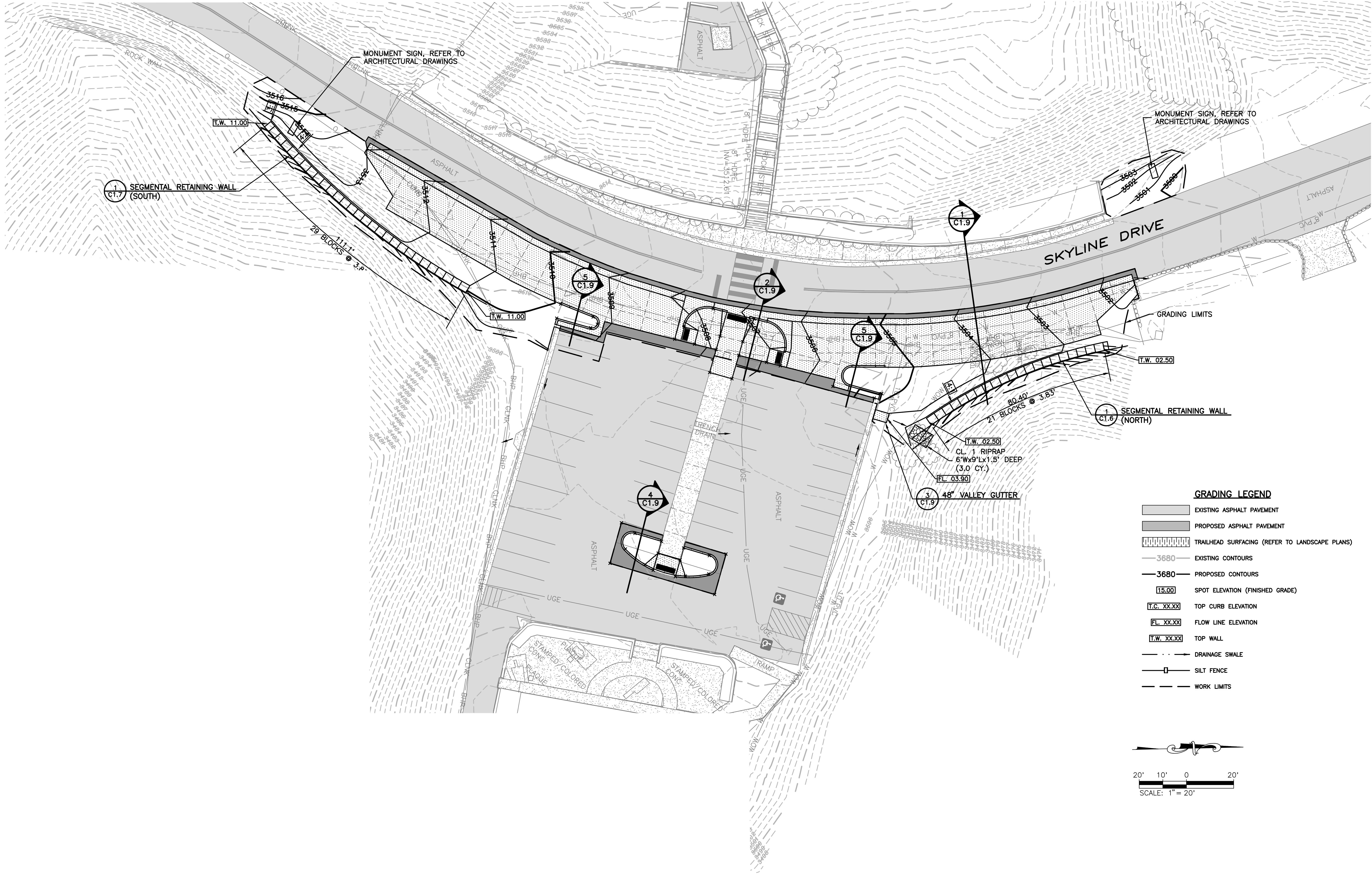

- GRADING LEGEND**
- EXISTING ASPHALT PAVEMENT
 - PROPOSED ASPHALT PAVEMENT
 - TRAILHEAD SURFACING (REFER TO LANDSCAPE PLANS)
 - EXISTING CONTOURS
 - PROPOSED CONTOURS
 - SPOT ELEVATION (FINISHED GRADE)
 - TOP CURB ELEVATION
 - FLOW LINE ELEVATION
 - TOP WALL
 - DRAINAGE SWALE
 - SILT FENCE
 - WORK LIMITS

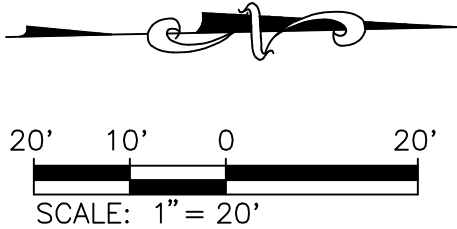

**PRELIMINARY
DRAWING
95% SUBMITTAL**

**SKYLINE WILDERNESS PARK
TRAILHEAD DEVELOPMENT
RAPID CITY PARKS AND RECREATION**

Sheet Title:
DINOSAUR PARK
GRADING PLAN

Sheet:
C1.4

Scale: AS NOTED

Designed By: GW	Drawn By: RF
Design Date: 12/11	Print Date: XXXXX
Internal Job No: 13166.00	
Surveyed By: KP/JC/JD	Survey Date: 12/1
Revisions:	

cetec
ENGINEERING SERVICES, INC.

1560 Concourse Drive
Rapid City, SD 57703
Phone: (605) 341-7800
Fax: (605) 341-7864
www.cetecengineering.com

Prepared For:
Public Works Department
RAPID CITY, SOUTH DAKOTA

Prepared By:
Engineering Services

March 07, 2014 11:27:37 a.m.
Drawing: 6109FULTON-DEM.DWG (Fox) (\\MAIN-DATA\CETEC\PROJECTS & PROPOSALS\13166.00 SKYLINE WILDERNESS AREA TRAILHEAD & DINOSAUR PARK IMPROVEMENTS\DRAWINGS\PLANS\FULTON\)

PLANT SCHEDULE

BOTANICAL NAME	COMMON NAME	SIZE	QUANTITY
TREES			
PINUS PONDEROSA	PONDEROSA PINE	4"	4
POPULUS BALSAMIFERA	BALSAM POPULAR	1-1/2" B & B	4

SHRUBS			
JUNIPERUS SABINA 'BUFFALO'	BUFFALO JUNIPER	3 GAL	12

SURFACING LEGEND

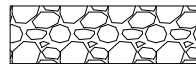
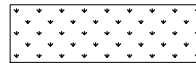
SYMBOL	DESCRIPTION
	MINERAL MULCH TYPE 1: 50% 2-4" COBBLES / 50% 4-6" COBBLES NATURAL COLOR, WASHED CLEAN. AVERAGE DEPTH 4" WITH WEED BARRIER.
	TYPE 1 SEED MIX: "BLACK HILLS RESTORATION MIX" 25 LB / AC OR SIM. RAPID CITY SPECIFICATION WARNE CHEMICAL 2680 COMMERCE RD RAPID CITY SD 605-342-7644

LANDSCAPE NOTES:

- SEE L5.1 FOR LANDSCAPE NOTES AND DETAILS
- MOUND ISLANDS SO THAT TOP OF MINERAL MULCH IS BETWEEN 12" & 18" ABOVE TOP OF CURB. SOIL IN ISLANDS WILL BE 4" - 6" BELOW CURB TO ALLOW FOR FULL MINERAL MULCH THICKNESS.
- PLANTING NOTES 13 & 14 APPLY TO ALL PLANTED OR MULCHED ISLANDS AT THIS PROJECT SITE.
- BOULDER PRIORITY AREAS INDICATED LIKE THIS:

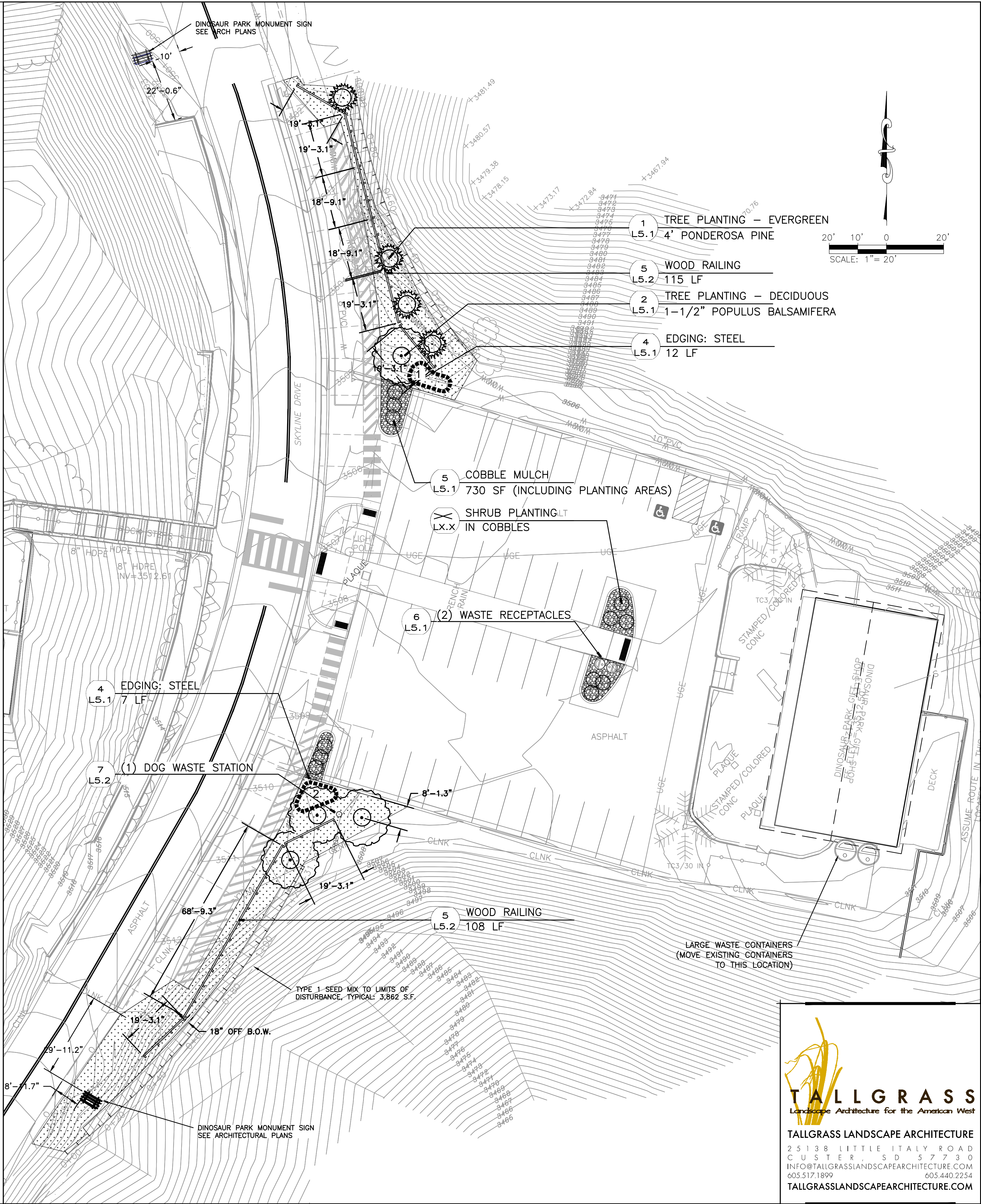
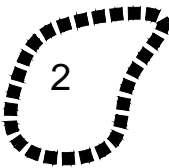



TALLGRASS
Landscape Architecture for the American West

TALLGRASS LANDSCAPE ARCHITECTURE
25138 LITTLE ITALY ROAD
CUSTER, SD 57730
INFO@TALLGRASSLANDSCAPEARCHITECTURE.COM
605.517.1899 605.440.2254
TALLGRASSLANDSCAPEARCHITECTURE.COM

Prepared For:

Public Works Department

1560 Concourse Drive
Rapid City, SD 57703
Phone: (605) 341-7800
Fax: (605) 341-7864
www.cetecengineering.com

Prepared By:

cetec
ENGINEERING SERVICES, INC.

NOT FOR CONSTRUCTION

95% CONSTRUCTION DOCUMENTS

Scale: AS NOTED

Designed By: TALLGRASS
Design Date: 06/06/14
Internal Job No: 13166.00
Surveyed By: KP/JC/JD
Revisions:

Drawn By: TALLGRASS
Print Date: 06/06/14
Survey Date: 12/1

**SKYLINE WILDERNESS PARK
TRAILHEAD DEVELOPMENT
RAPID CITY PARKS AND RECREATION**

CITY OF RAPID CITY PROJECT NO. PR13-6109

Sheet Title:

95% LANDSCAPE PLAN

DINOSAUR PARK
PARKING LOT

Sheet:

L-1.1 OF 7

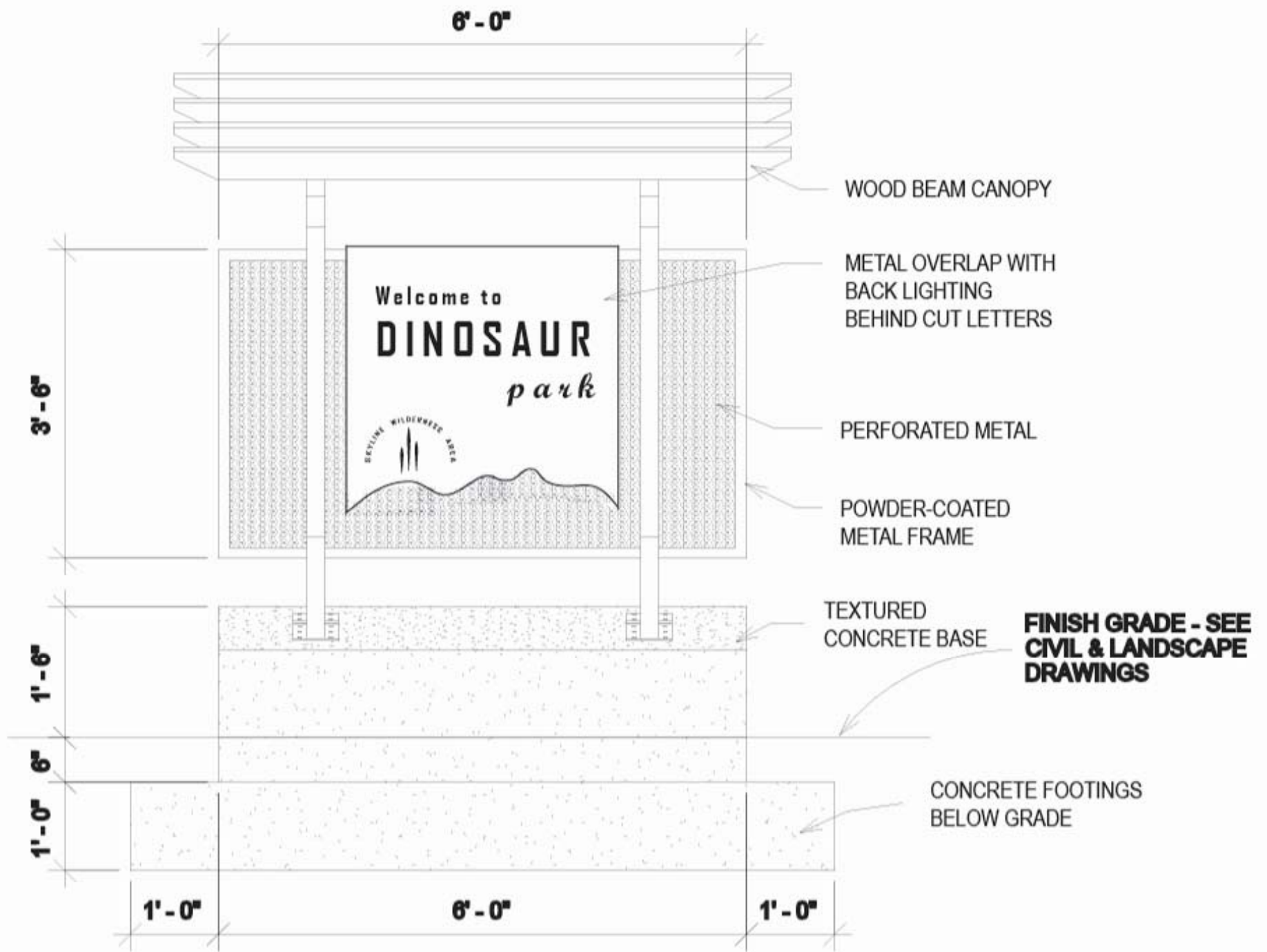

6/12

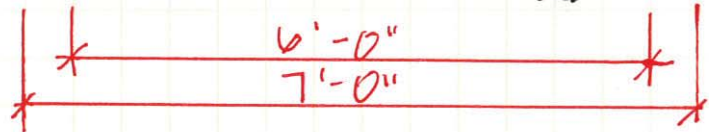
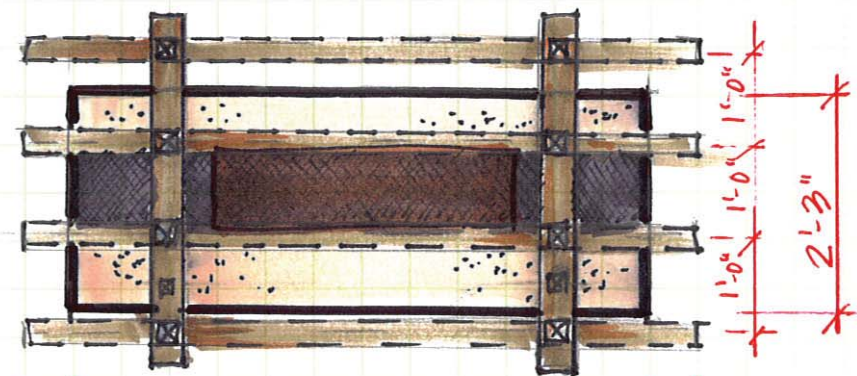

3'-6"
1'-6"

6'
7'-6" 2'-3"

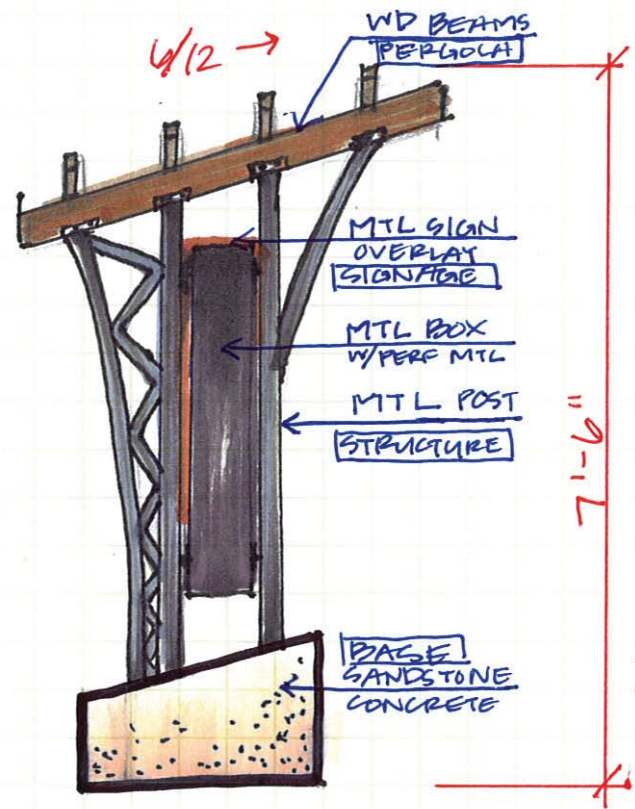
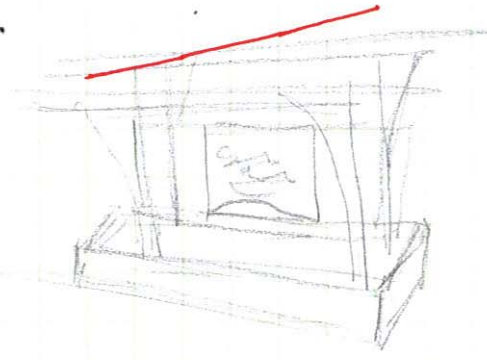

6/12

WD BEAMS
PERGOLA

MTL SIGN
OVERLAY
SIGNAGE

MTL BOX
W/PERF MTL

MTL POST
STRUCTURE

BASE
SANDSTONE
CONCRETE

7'-6"



SKYLINE | MONUMENT SIGN

BRINGING ARCHITECTURE TO YOUR WORLD

T: 605.341.2066 F: 605.341.3651

