

SOUTH DAKOTA HISTORIC SITES INVENTORY

Historic Name

Site Number
PN- RC -RC -WB-00194
CTY TWP CIT NBH NUM

Address/ Location 1015 Kansas City Street

DBASE 0000000000

Common Name

U.S.G.S. Quad Map Name

Historic Function House

Legal Description
0
Q1 Q2 SEC TWP RNG
Urban Only BLK 10
LOT 23-24
ADD Boulevard

Historic Context(s) V. Depression & Rebuilding: A.
Changing Urban Patterns: 3.
Residential Changes

Owner's Name Thomas J. & Mary Bodensteiner

Surveyors
L. Johnson/RTI

Owner's Address 1015 Kansas City Street
Rapid City, SD 57701

Owner's Phone # (605) 348-7165

Date 07/13/1991

Date(s) of Construction 1909

NR Eligible Y

Photographer L. Johnson
Roll # 8 **Frame #'s** 30-32
(Attach Photographs Below)

Future NR Y

Significance HIST, ARCH,
LOCL

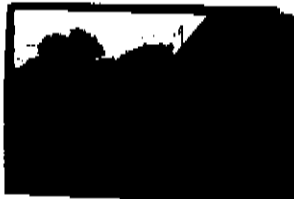

PLANNING

Site No. PN-RC -RC-WB-00194

Preservation Strengths of the Site

- In Use and Not Threatened
- X In Good Structural Condition
- X Owners Protecting Site
- Appreciated by Public
- X Valuable to Research

Preservation Threats of the Site of the Site

- Abandonment
- Deterioration Through Lack of Resources
- Vandalism or Looting
- Inappropriate Alterations
- Inappropriate or Poor Maintenance
- Fragile or Deteriorating Construction Materials
- Unsound Condition
- Lack of Support (Specify by Whom)

Environmental Situations Effecting Site (Specify What: May Include Mining, Flooding, Erosion, Pollution, Acid Rain, Weather, Isolation, Development, Ecc.)

HISTORY AND CONTEXT

Page 1
Site No. PN-RC -RC-WB-00194

Dates:
Founding of Institution or Settlement 1876
Town and Addition Platted 1877 1885 Initial Construction of Structure 1909

Original Owners:
Name (Include Spouse if Known)
Place of Origin
Date Arrived in S.D. 0000 In USA 0000

Occupation(s)

Religious Affiliation
Social/Fraternal Affiliation

Other Previous Owners:
Names and Dates of Occupation Herbert & Nellie Bouvia (R.L. Polk:
1928; Herbert listed as foreman)

Mrs. Hattie G. Maples (R.L. Polk:
1930-31)

Structural History:
Architect's Name and
Date of Commission

Builder's Name
Pattern, Book and Number/Name

Historic Uses of the Site House

Changes in Use

Statement of Historical Significance: (Including Relation to Historic Context Topics and Study Units)

This property has the potential to contribute to the West Boulevard Historic District. It is significant for its association with the growth of and development of the West Boulevard neighborhood in Rapid City from 1878 to 1942. Built circa 1909, the house corresponds with the rebuilding phase of residential development in Rapid City (1898 to 1929), a period in which the West Boulevard neighborhood rapidly grew in response to tremendous population growth in the city. The property illustrates the varied economic status of the neighborhood's inhabitants during this period and serves as a representative example of residential architecture popular at the time.

HISTORY AND CONTEXT

Page 2
Site No. PN-RC -RC-WB-00194

Miscellaneous Historical Information:

Historic research indicates that the house was built 1909. In 1910, George McCoy received a water permit for the property. It is unknown if McCoy built and/or ever owned the house, or resided at this address.

Bibliography:

Oral Interview (Name, Date & Relationship to Site)

Atlas (Date & Publisher)

County History (Title & Pages)

Deed Abstract

Tax Records Assessors' Card: 1909

Sanborn-Ferris Maps (Dates)

1909, 1915, 1923, & 1930

Census Records

Historical Photos (Description & Date)

Manuscripts (Name & Date)

Directories (Type & Date)

R.L. Polk: 1928, 1930-31

Other Sources Rapid City Public Works, Water Permit #482: G. McCoy, 1910

ARCHITECTURAL EVALUATION/PRINCIPAL STRUCTURE

Page 1

General Information:

Building # 1

Site No. PN-RC -RC-WB-00194 Date of Construction 1909 Photos 30-32

Function House	Plan Form Square	Height (Stories) 1.5
Style Vernacular	Method of Construction Wood-frame	Overall Condition E

Additions & Alterations (Types & Dates)

One-story addition on rear (south) was built after 1930, but likely before 1942; a modern greenhouse and deck have been constructed at the rear (south) of the house.

Evaluation of Specific Elements:

Foundation: Materials	Stone; coursed	Condition E
Walls: Cladding	4" Clapboard	Condition E
Windows: General/ Type	Unique	Glazing Pattern Condition Location
	G Double-hung, wood-sash	1/1 G
	U Cottage	Stain glass transom E North

Doors: Type	Glazing Pattern Condition Location
Not visible	

Roof: Form	Cross-gable	Materials Asphalt shingles	Condition E
Dormer: Type	Location(s)	Condition	
Chimneys/Ventilators: Materials	Brick chimney	Location(s) Interior: ridge, south of center	Condition E
Porches: Materials	Condition Height Roof Configuration	Location	

Round columns on square piers	# 1	Mansard	North
-------------------------------	-----	---------	-------

Bays/Towers: Form	Condition	Height(Stories)	Location(s)
Hexagonal bay	E	1	East

Significant Exterior Details:

Porch is cutaway from northwest corner;

Bay window is long and shallow

Significant Interior Details:

Interior not accessed

ARCHITECTURAL EVALUATION/ANCILLARY STRUCTURES

Site No. DN-RC -RC-WB-00124

=====

Bldg#	Date	C/NC	Function	Photo#	Construction Method	Height
2	c.1990	NC	Shed		Wood-frame	1

Overall Condition	E	Foundation: Materials-	Concrete	Individual Element Cond.
		Walls: Cladding-	Shiplap	E
		Windows: Type & Glazing Pattern-		
		Doors: Type & Glazing Pattern-	Solid core; 1 panel	E
		Roof: Form & Materials-	Gable w/shed; asphalt shingles	E
		Chimney/Vent: Material & Location-		

Significant Exterior Details

Significant Interior Details

Not accessed

Alterations & Dates

Change in Use

=====

Site Plan: Indicate all door and window openings, roof shapes, and landscape features.



Indicate North

KANSAS CITY ST.

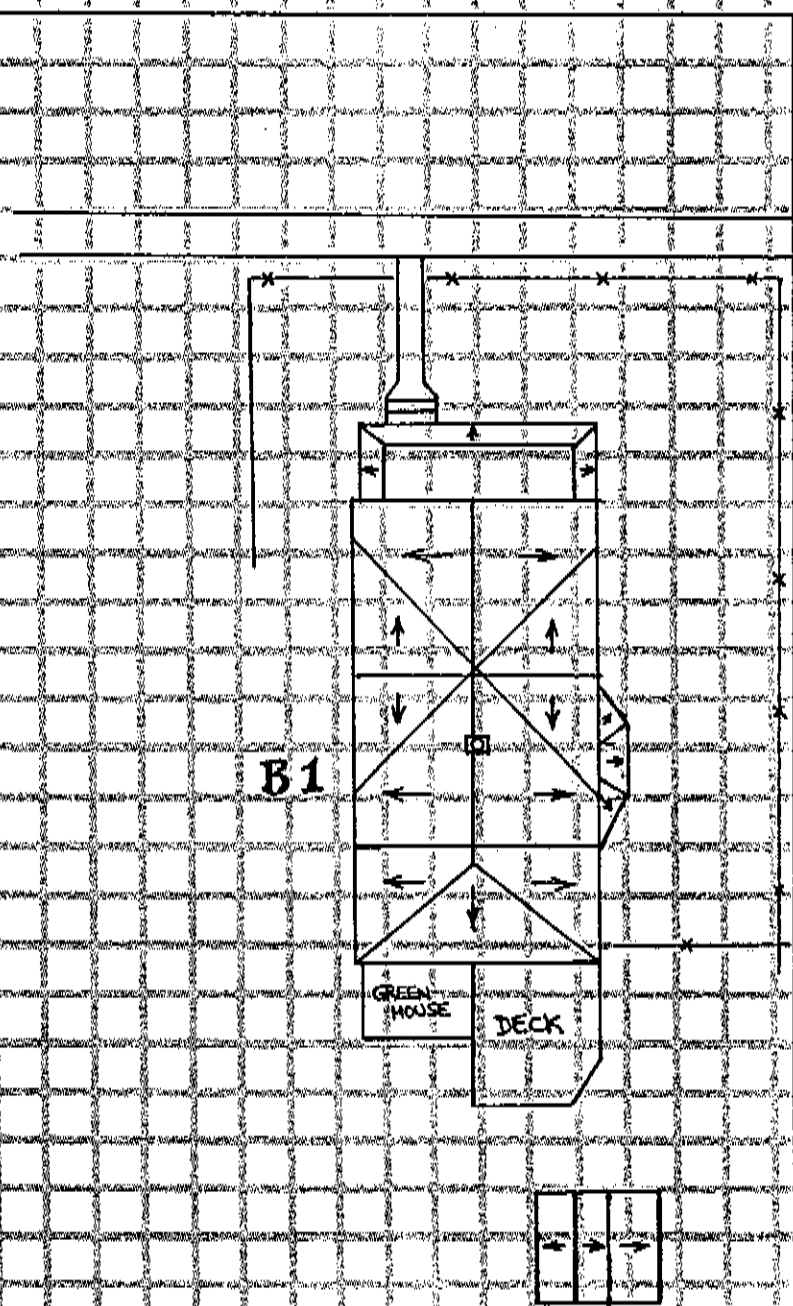

B1

GREEN HOUSE

DECK

ALLEY

B2