

SOUTH DAKOTA HISTORIC SITES INVENTORY

Historic Name _____

Address/Location 1423 9TH

Common Name _____

Historic Function _____

Historic Context(s) _____

Owner's Name _____

Owner's Address _____

Owner's Phone # _____

Date(s) of Construction _____

Photographer _____

Roll # _____ Frame #'s _____
(Attach Photographs Below)

Site Number

PN RC RC WB 447

CTY TWP CIT NBH NUM

DBASE _____

U.S.G.S. Quad Map Name

Legal Description

Q1 Q2 SEC TWP RNG

Urban LOT _____ BLK 3
Only ADD _____

Surveyors

Date _____

NR Eligible Yes _____ No _____

Future NR Yes _____ No _____

Significance

HIST ARCH ARCE

NATL STAT LOCL

SOUTH DAKOTA HISTORIC SITES INVENTORY

Historic

Name Fred & Orene Meyer

Address/

Location 1423 9th Street

Common

Name

Historic

Function House

Historic

Context(s) V. Depression & Rebuilding: A.
Changing Urban Patterns: 3.
Residential Changes

Owner's Name Phyllis Lang

Owner's Address 101 S. Galena
Lead, SD 57754

Owner's Phone # (605) 584-2363

Date(s) of Construction circa 1924

Photographer M. McCormick
Roll # 8 Frame #'s 21-23
(Attach Photographs Below)

Site Number

PN -RC -RC -WB -00447
CTY TWP CIT NBH NUM

DBASE 0000000000

U.S.G.S. Quad Map Name

Legal Description

0
Q1 Q2 SEC TWP RNG
Urban Only BLK 3
LOT 30-32
ADD West Boulevard

Surveyors

M. McCormick/RTI

Date 07/03/1992

NR Eligible Y

Future NR Y

Significance HIST, ARCH
LOCL



Preservation Strengths of the Site

- In Use and Not Threatened
- In Good Structural Condition
- Owners Protecting Site
- Appreciated by Public
- Valuable to Research

Preservation Threats

- Abandonment
- Deterioration Through Lack of Resources
- Vandalism or Looting
- Inappropriate Alterations
- Inappropriate or Poor Maintenance
- Fragile or Deteriorating Construction Materials
- Unsound Condition
- Lack of Support (Specify by Whom)

Environmental Situations Effecting Site (Specify What: May Include Mining, Flooding, Erosion, Pollution, Acid Rain, Weather, Isolation, Development, Etc.)

Dates:

Founding of Institution or Settlement 1876

Town and Addition Plated 1877 1886 Initial Construction of Structure 1924

Original Owners:

Name (Include Spouse if Known) Fred & Orene Meyers

Place of Origin

Date Arrived in S.D. 0000 In USA 0000

Occupation(s) Fred: salesman

Religious Affiliation

Social/Fraternal Affiliation

Other Previous Owners:

Names and Dates of Occupation

Structural History:

Architect's Name and

Date of Commission

Builder's Name

Pattern, Book and Number/Name

Historic Uses of the Site House

Changes in Use Apartments

Statement of Historical Significance: (Including Relation to Historic Context Topics and Study Units)

The Fred & Orene Meyer House has the potential to contribute to the West Boulevard Historic District. It is significant for its association with the growth and development of the West Boulevard neighborhood in Rapid City from 1878-1942. Built in 1924, the house corresponds to the rebuilding phase of residential development in Rapid City (1897-1929), a period in which the West Boulevard neighborhood rapidly grew in response to tremendous population growth in the city. The house helps to illustrate the varied economic status of the neighborhood's inhabitants during this era and serves as a representative example of residential architecture common at the time.

Miscellaneous Historical Information:

Research indicates the houses was built in 1924, around the time that Fred Meyers received water and sewer permits for the property. Mr. Meyers and his wife Orene were the original owners of the house and resided there until at least 1928.

Bibliography:

Oral Interview (Name, Date & Relationship to Site)

Atlas (Date & Publisher)

County History (Title & Pages)

Deed Abstract

Tax Records Assessors' Card: 1927

Sanborn-Ferris Maps (Dates)

1923: vacant; 1930: house & garage

Census Records

Historical Photos (Description & Date)

Manuscripts (Name & Date)

Directories (Type & Date)

R.L. Polk: 1928, lists Fred & Orene Meyers at this address

Other Sources Rapid City Public Works, Water Permit #1455 &
Sewer Permit #631: Fred Meyer, November 1924

General Information:

Building # 1

Site No. PN-RC -RC-WB-00447 Date of Construction c.1924 Photos 21-22

| | | |
|---------------------|-----------------------------------|----------------------|
| Function Apartments | Plan Form Rectangular | Height (Stories) 1.5 |
| Style Vernacular | Method of Construction Wood-frame | Overall Condition E |

Additions & Alterations (Types & Dates)

Original rear porch (west) was replaced by an exterior staircase and vestibule at rear dormer: these were modern alterations likely for conversion of the house into apartments

Evaluation of Specific Elements:

| | | |
|-----------------------|---------------|-------------|
| Foundation: Materials | Brick masonry | Condition E |
|-----------------------|---------------|-------------|

| | | |
|-----------------|------------------|-------------|
| Walls: Cladding | Clapboard siding | Condition E |
|-----------------|------------------|-------------|

| Windows: General/ Unique | Type | Glazing Pattern | Condition | Location |
|--------------------------|------------------------|-----------------|-----------|----------|
| G | Double-hung, wood-sash | 1/1 | E | |

| Doors: Type | Glazing Pattern | Condition | Location |
|-------------|-----------------|-----------|----------|
| Full light | 4x3 | E | East |
| Not visible | | | West |

| | | | |
|------------|------------|----------------------------|-------------|
| Roof: Form | Side gable | Materials Asphalt shingles | Condition E |
|------------|------------|----------------------------|-------------|

| | | |
|--------------|--------------------|-------------|
| Dormer: Type | Roof: shed-roofed | Condition E |
| Location(s) | East & west slopes | |

| | | |
|---------------------------------|-----------------------------|-------------|
| Chimneys/Ventilators: Materials | Brick chimney | Condition E |
| Location(s) | Interior: centered on ridge | |

| Porches: Materials | Condition | Height (Stories) | Roof Configuration | Location |
|--------------------------|-----------|------------------|--------------------|----------|
| Open: hood & knee braces | E | 1 | Shed | East |

| | | | |
|-------------------|-----------|------------------|-------------|
| Bays/Towers: Form | Condition | Height (Stories) | Location(s) |
|-------------------|-----------|------------------|-------------|

Significant Exterior Details:

Roof: boxed eaves with partial returns

Front porch (east): lattice wall on east, and concrete stoop

Significant Interior Details:

Not accessed

| Blgd# | Date | C/NC | Function | Photo# | Construction Method | Height |
|-------|--------|------|----------|--------|---------------------|--------|
| 2 | c.1924 | C | Garage | 23 | Wood-frame | 1 |

Individual Element Cond.

| | | | | |
|------------------------------------|---|------------------------|--------------------------------|---|
| Overall Condition | G | Foundation: Materials- | Concrete | E |
| | | Walls: Cladding- | Clapboard siding | E |
| Windows: Type & Glazing Pattern- | | | Fixed; 4 light | E |
| Doors: Type & Glazing Pattern- | | | Paneled folding (2); 1/2 light | E |
| Roof: Form & Materials- | | | Gable; asphalt shingles | E |
| Chimney/Vent: Material & Location- | | | | |

Significant Exterior Details

Significant Interior Details

Alterations & Dates

Change in Use

Site Plan: Indicate all door and window openings, roof shapes, and landscape features.



Indicate North

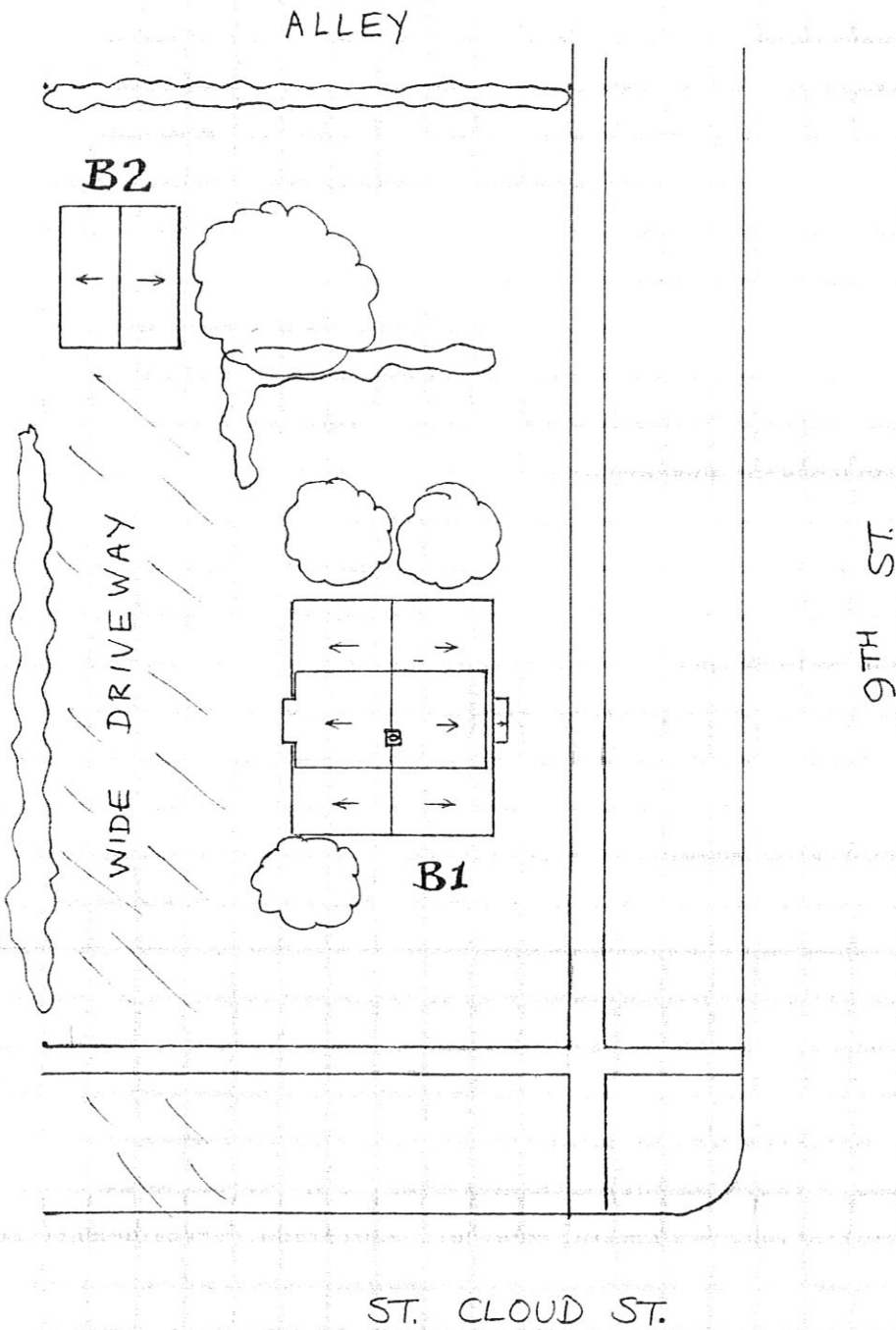

PLANNING

Site No. _____

Preservation Strengths of the Site

- _____ In Use and Not Threatened
- _____ In Good Structural Condition
- _____ Owners Protecting Site
- _____ Appreciated by Public
- _____ Valuable to Research

Preservation Threats

- _____ Abandonment
- _____ Deterioration Through Lack of Resources
- _____ Vandalism or Looting
- _____ Inappropriate Alterations
- _____ Inappropriate or Poor Maintenance
- _____ Fragile or Deteriorating Construction Materials
- _____ Unsound Condition
- _____ Lack of Support (Specify by Whom)

- _____ Environmental Situations Effecting Site (Specify What: May Include Mining, Flooding, Erosion, Pollution, Acid Rain, Weather, Isolation, Development, Ect.)
