

PLANNING

Site No. \_\_\_\_\_

Preservation Strengths of the Site

- \_\_\_\_\_ In Use and Not Threatened
- \_\_\_\_\_ In Good Structural Condition
- \_\_\_\_\_ Owners Protecting Site
- \_\_\_\_\_ Appreciated by Public
- \_\_\_\_\_ Valuable to Research

Preservation Threats

- \_\_\_\_\_ Abandonment
- \_\_\_\_\_ Deterioration Through Lack of Resources
- \_\_\_\_\_ Vandalism or Looting
- \_\_\_\_\_ Inappropriate Alterations
- \_\_\_\_\_ Inappropriate or Poor Maintenance
- \_\_\_\_\_ Fragile or Deteriorating Construction Materials
- \_\_\_\_\_ Unsound Condition
- \_\_\_\_\_ Lack of Support (Specify by Whom)

\_\_\_\_\_ Environmental Situations Effecting Site (Specify What: May Include Mining, Flooding, Erosion, Pollution, Acid Rain, Weather, Isolation, Development, Ect.)

\_\_\_\_\_

\_\_\_\_\_

\_\_\_\_\_

\_\_\_\_\_

\_\_\_\_\_

SOUTH DAKOTA HISTORIC SITES INVENTORY

Historic Name \_\_\_\_\_

Address/Location \_\_\_\_\_ 1115 COLUMBUS ST. \_\_\_\_\_

Common Name \_\_\_\_\_

Historic Function \_\_\_\_\_

Historic Context(s) \_\_\_\_\_

Owner's Name \_\_\_\_\_

Owner's Address \_\_\_\_\_

Owner's Phone # \_\_\_\_\_

Date(s) of Construction \_\_\_\_\_

Photographer \_\_\_\_\_

Roll # \_\_\_\_\_ Frame #'s \_\_\_\_\_

(Attach Photographs Below)

Site Number

PN	RC	RC	WB	239
CTY	TWP	CIT	NBH	NUM

DBASE \_\_\_\_\_

U.S.G.S. Quad Map Name \_\_\_\_\_

Legal Description

Q1	Q2	SEC	TWP	RNG

Urban LOT \_\_\_\_\_ BLK \_\_\_\_\_  
Only ADD \_\_\_\_\_

Surveyors \_\_\_\_\_

Date \_\_\_\_\_

NR Eligible Yes \_\_\_\_\_ No \_\_\_\_\_  
Future NR Yes \_\_\_\_\_ No \_\_\_\_\_

Significance

<input type="checkbox"/> HIST	<input type="checkbox"/> ARCH	<input type="checkbox"/> ARCE
<input type="checkbox"/> NATL	<input type="checkbox"/> STAT	<input type="checkbox"/> LOCL

Floor Plans of Major Buildings: Indicate room functions.

Site Plan: Indicate all door and window openings, roof shapes, and landscape features.

0 10 20 30 40 50

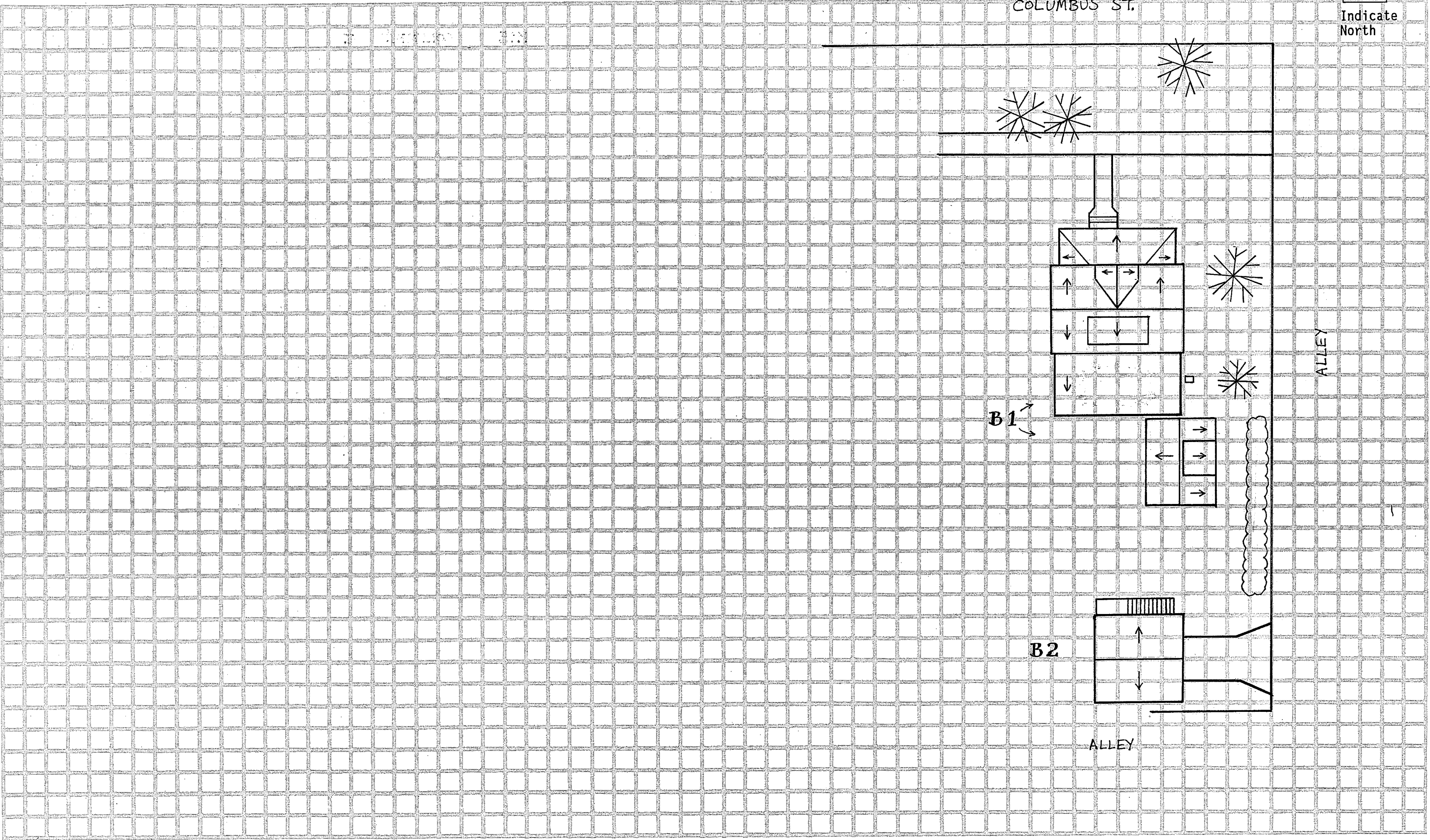
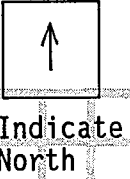

**SOUTH DAKOTA HISTORIC SITES INVENTORY**

**Historic  
Name**

**Address/  
Location** 1115 Columbus

**Common  
Name**

**Historic  
Function** House

**Historic  
Context(s)** V. Depression & Rebuilding: A.  
Changing Urban Patterns: 3.  
Residential Changes

**Owner's Name** Harmon & Evelyn Rose

**Owner's Address** 1115 Columbus Street  
Rapid City, SD 57701

**Owner's Phone #** (605) 342-1853

**Date(s) of Construction** 1909

**Photographer** L. Johnson  
**Roll #** 3 **Frame #'s** 9-10  
(Attach Photographs Below)

**Site Number**  
PN- RC -RC -WB-00239  
CTY TWP CIT NBH NUM

**DBASE** 0000000000

**U.S.G.S. Quad Map Name**

**Legal Description**

0  
Q1 Q2 SEC TWP RNG  
Urban Only BLK 17  
LOT 23-24  
ADD Boulevard

**Surveyors**  
L. Johnson/RTI

**Date** 07/16/1991

**NR Eligible** Y

**Future NR** Y

**Significance** HIST, ARCH,  
LOCL



**PLANNING**

**Site No. PN-RC -RC-WB-00239**

**Preservation Strengths of the Site**

- In Use and Not Threatened
- X In Good Structural Condition
- Owners Protecting Site
- Appreciated by Public
- X Valuable to Research

**Preservation Threats of the Site**

- Abandonment
- Deterioration Through Lack of Resources
- Vandalism or Looting
- Inappropriate Alterations
- Inappropriate or Poor Maintenance
- Fragile or Deteriorating Construction Materials
- Unsound Condition
- Lack of Support (Specify by Whom)

**Environmental Situations Effecting Site (Specify What: May Include Mining, Flooding, Erosion, Pollution, Acid Rain, Weather, Isolation, Development, Etc.)**

## HISTORY AND CONTEXT

Page 1

Site No. PN-RC -RC-WB-00239

### Dates:

Founding of Institution or Settlement 1876

Town and Addition Platted 1877 1885 Initial Construction of Structure 1909

### Original Owners:

Name (Include Spouse if Known)

Place of Origin

Date Arrived in S.D. 0000 In USA 0000

Occupation(s)

Religious Affiliation

Social/Fraternal Affiliation

### Other Previous Owners:

Names and Dates of Occupation Stephen A. & Grace Hearn (R.L. Polk:  
1928-31; Stephen listed as auditor,  
Rapid City, Black Hills & Western  
Railroad)

### Structural History:

Architect's Name and  
Date of Commission

Builder's Name

Pattern, Book and Number/Name

Historic Uses of the Site House

Changes in Use

### Statement of Historical Significance: (Including Relation to Historic Context Topics and Study Units)

This property has the potential to contribute to the West Boulevard Historic District. It is significant for its association with the growth of and development of the West Boulevard neighborhood in Rapid City from 1878 to 1942. Built circa 1909, the house corresponds with the rebuilding phase of residential development in Rapid City (1898 to 1929), a period in which the West Boulevard neighborhood rapidly grew in response to tremendous population growth in the city. The property illustrates the varied economic status of the neighborhood's inhabitants during this period and serves as a representative example of residential architecture popular at the time.

## **HISTORY AND CONTEXT**

**Site No. PN-RC -RC-WB-00239**

**Page**

### **Miscellaneous Historical Information:**

Historic research indicates that the house was built in 1909, around the time that Oscar Egemo received a water permit for the property. Egemo worked as a mason, and it seems likely that the house was one of his building projects. (The 1914 city directory shows Egemo living elsewhere in the city). The original owner and/or occupants of this

### **Bibliography:**

Oral Interview (Name, Date & Relationship to Site)

Atlas (Date & Publisher)

County History (Title & Pages)

Deed Abstract

Tax Records Assessors' Card: 1909

Sanborn-Ferris Maps (Dates)  
1923 (first map of area)

Census Records

Historical Photos (Description & Date)

Manuscripts (Name & Date)

Directories (Type & Date)  
R.L. Polk: 1928, 1930-31

Other Sources Rapid City Public Works, Water Permit #562: O.  
Egemo, 1909

# ARCHITECTURAL EVALUATION/PRINCIPAL STRUCTURE

Page 1

## General Information:

Building # 1

Site No. PN-RC -RC-WB-00239 Date of Construction 1909 Photos 9,10

Function House Plan Form Rectangular Height (Stories) 1.5

Style Vernacular Method of Construction Wood-frame Overall Condition E

## Additions & Alterations (Types & Dates)

Full-length, shed-roofed addition & gabled-roofed house at the rear (south) were added after 1930.

## Evaluation of Specific Elements:

Foundation: Materials Sandstone; coursed sandstone Condition E

Walls: Cladding 4" Clapboard Condition E

Windows: General/ Unique	Type	Glazing Pattern	Condition	Location
G	Double-hung, wood-sash	1/1	E	
U	Cottage		E	East
U	Cottage	Leaded transom	E	North

Doors: Type	Glazing Pattern	Condition	Location
Not visible			North

Roof: Form Gable with returns Materials Asphalt shingles Condition E

Dormer: Type Gable; Shed Condition E

Location(s) North; South (attached building)

Chimneys/Ventilators: Materials Concrete masonry unit (2) Condition E

Location(s) Exterior: east; Exterior: west (addition

Porches: Materials	Condition	Height (Stories)	Roof Configuration	Location
Tapered round columns	E	1	Hip	North

Bays/Towers: Form	Condition	Height(Stories)	Location(s)

**ARCHITECTURAL EVALUATION/PRINCIPAL STRUCTURE**

**Page 2**

**Site No. PN-RC -RC-WB-00239 Building # 1**

**Significant Exterior Details:**

Porch: 4" clapboard balustrade, lattice skirt

Cornice boards with cornice molding

Routed side panels flank the door on north side

**Significant Interior Details:**

Interior not accessed



**ARCHITECTURAL EVALUATION/ANCILLARY STRUCTURES**

Site No. PN-RC -RC-WB-00239

Bldg#	Date	C/NC	Function	Photo#	Construction Method	Height
2	1980	NC	Garage; Apartment		Wood-frame	1

					Individual Element Cond.
Overall Condition	E	Foundation: Materials-	Concrete		E
		Walls: Cladding-	4" Clapboard		E
Windows:		Type & Glazing Pattern-	1/1 double-hung Palladian		E
Doors:		Type & Glazing Pattern-	Overhead		E
		Roof: Form & Materials-	Gable		E
Chimney/Vent:		Material & Location-			

**Significant Exterior Details**  
Fixed lights on south side

**Significant Interior Details**  
Not accessed

**Alterations & Dates**  
Owner supplied construction date

**Change in Use**