

SOUTH DAKOTA HISTORIC SITES INVENTORY

Historic Name _____

Address/Location 1819 WEST BLVD.

Common Name _____

Historic Function _____

Historic Context(s) _____

Owner's Name _____

Owner's Address _____

Owner's Phone # _____

Date(s) of Construction _____

Photographer _____

Roll # _____ Frame #'s _____
(Attach Photographs Below)

Site Number

PN RC RC WB 563

CTY TWP CIT NBH NUM

DBASE _____

U.S.G.S. Quad Map Name _____

Legal Description

Q1 Q2 SEC TWP RNG

Urban LOT _____ BLK _____
Only ADD _____

Surveyors _____

Date _____

NR Eligible Yes _____ No _____
Future NR Yes _____ No _____

Significance

HIST ARCH ARCE

NATL STAT LOCL

SOUTH DAKOTA HISTORIC SITES INVENTORY

Historic Name Bert & Marguerite Flisnes House

Address/Location 1819 West Boulevard

Common Name

Historic Function House

Historic Context(s) VI. The Great Depression

Site Number
PN -RC -RC -WB -00563
CTY TWP CIT NBH NUM

DBASE 0000000000

U.S.G.S. Quad Map Name

Legal Description

0
Q1 Q2 SEC TWP RNG
Urban Only BLK 24
LOT 8-11, S99' L12-13
ADD West Boulevard

Owner's Name John & Marrta Sakai

Owner's Address 1819 West Boulevard
Rapid City, SD 57701

Owner's Phone # (000) 000-0000

Date(s) of Construction circa 1936

Photographer D. Martin
Roll # 13 **Frame #'s** 13-15
(Attach Photographs Below)

Surveyors
D. Martin/RTI

Date 07/06/1992

NR Eligible Y

Future NR Y

Significance HIST, ARCH
LOCL



Preservation Strengths of the Site

- In Use and Not Threatened
- In Good Structural Condition
- Owners Protecting Site
- Appreciated by Public
- Valuable to Research

Preservation Threats

- Abandonment
- Deterioration Through Lack of Resources
- Vandalism or Looting
- Inappropriate Alterations
- Inappropriate or Poor Maintenance
- Fragile or Deteriorating Construction Materials
- Unsound Condition
- Lack of Support (Specify by Whom)

Environmental Situations Effecting Site (Specify What: May Include Mining, Flooding, Erosion, Pollution, Acid Rain, Weather, Isolation, Development, Etc.)

Dates:

Founding of Institution or Settlement 1876
Town and Addition Plated 1877 1886 Initial Construction of Structure 1936

Original Owners:

Name (Include Spouse if Known) Bert A. & Marguerite Flisnes
Place of Origin
Date Arrived in S.D. 0000 In USA 0000

Occupation(s) Owners, A&F Cafe

Religious Affiliation
Social/Fraternal Affiliation

Other Previous Owners:

Names and Dates of Occupation

Structural History:

Architect's Name and
Date of Commission

Builder's Name
Pattern, Book and Number/Name

Historic Uses of the Site House

Changes in Use

Statement of Historical Significance: (Including Relation to Historic Context Topics and Study Units)

The Bert & Marguerite Flisnes House has the potential to contribute to the West Boulevard Historic District. It is significant for its association with the development of the West Boulevard neighborhood in Rapid City from 1878 to 1942. Built in about 1936, the house corresponds to the Great Depression, a time of economic uncertainty across the nation. Rapid City experienced limited construction in the early Depression years. In the mid 1930s, however, its construction industry revived largely because of the city's relatively healthy and diverse economy; many new homes were built in the West Boulevard neighborhood. This house helps to illustrate the economic vitality of the city during the Depression, as well as the varied social and economic status of those living in the West Boulevard neighborhood. It also serves as a representative example of the Picturesque style, the vernacular variant of the various Revival styles that dominated domestic construction in the country in the 1920s and 1930s.

Miscellaneous Historical Information:

Research indicates the house was built in about 1936, and was originally owned and occupied by Bert Flisnes and his wife Marguerite.

Bibliography:

Oral Interview (Name, Date & Relationship to Site)

Atlas (Date & Publisher)

County History (Title & Pages)

Deed Abstract

Tax Records Assessors' Card: 1925

Sanborn-Ferris Maps (Dates)

No coverage

Census Records

Historical Photos (Description & Date)

Manuscripts (Name & Date)

Directories (Type & Date)

R.L. Polk: 1934-1935, house address is not listed; 1936-37 & 1939, show the Flisnes at this address

Other Sources Rapid City Public Works, Water Permit #2397
(change of line): B.A. Flisnes, March 1936

General Information:

Building # :

Site No. PN-RC -RC-WB-00563 Date of Construction c.1936 Photos 13-14

Function House	Plan Form T-shaped	Height (Stories) 2
	Method of	Overall
Style Picturesque	Construction Wood-frame	Condition E

Additions & Alterations (Types & Dates)

Porch on east and wrapping around to the north has been enclosed with modern windows

Evaluation of Specific Elements:

Foundation: Materials Concrete Condition E

Walls: Cladding Clapboard siding Condition E

Windows: General/ Unique	Type	Glazing Pattern	Condition	Locatic
G	Casement, wood-sash	2x4 & 3x4	E	
G	Double-hung, wood-sash	6/6	E	
U	Fixed w/ transom	2x3/3x5	E	E wing

Doors: Type	Glazing Pattern	Condition	Location
Arched, wood-paneled	1 light	E	East
French doors	Multi	E	West

Roof: Form Cross gable Materials Cedar shakes Condition E

Dormer: Type Roof: gable-roofed; wall: shed-roof Condition E
 Location(s) E. wing: north & south; south slope

Chimneys/Ventilators: Materials 3 brick chimneys Condition
 Location(s) Exterior: north and south walls; interio

Porches: Materials	Condition	Height (Stories)	Roof Configuration	Location
--------------------	-----------	---------------------	-----------------------	----------

Enclosed: windows	E	1	Flat	E & N
Vestibule: clapboard siding	E	1	Shed	East

Bays/Towers: Form	Condition	Height (Stories)	Location (s)
-------------------	-----------	------------------	--------------

Significant Exterior Details:

Roof: steep pitch; and boxed eaves with slight overhangs

Setting: house is on a rise and setback a hundred feet or more from West Boulevard. It is surrounded by a large lawn landscaped with many mature trees and bushes. A flagstone retaining wall runs along the east side of the property along West Boulevard, and a flagstone sidewalk links the house and the avenue.

Significant Interior Details:

Not accessed

Blgd#	Date	C/NC	Function	Photo#	Construction Method	Height
2	c.1936	C	Garage	15	Wood-frame	1

Overall Condition E Foundation: Materials- Not visible
 Walls: Cladding- Clapboard siding
 Windows: Type & Glazing Pattern- Double-hung, 1/1
 Doors: Type & Glazing Pattern- Paneled overhead
 Roof: Form & Materials- Gable; asphalt shingles
 Chimney/Vent: Material & Location-

Individual Element Cond.
 E
 E
 E
 E

Significant Exterior Details

Significant Interior Details

Alterations & Dates

Change in Use



Site Plan: Indicate all door and window openings, roof shapes, and landscape features.



Indicate North

ALLEY

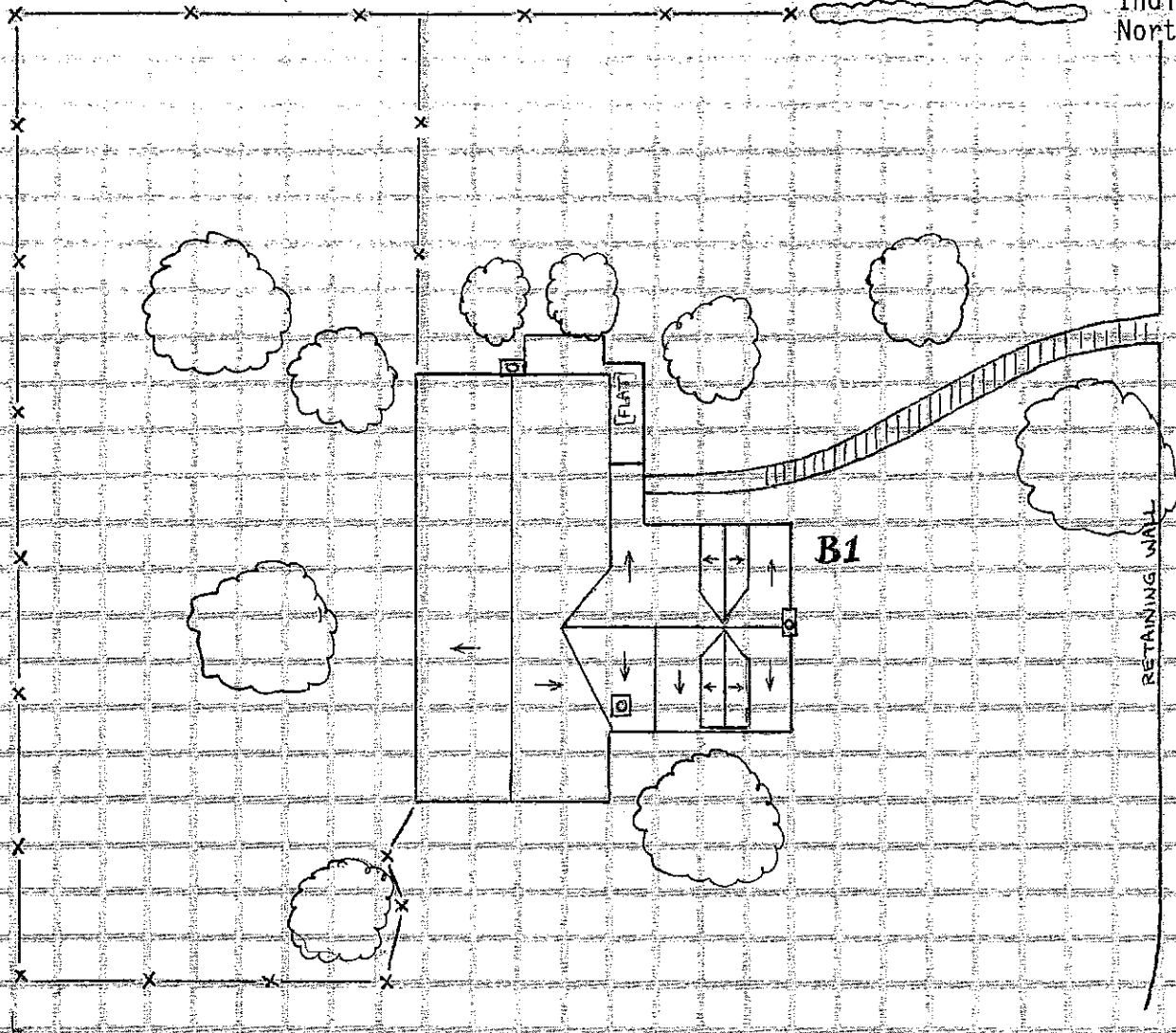

B1

RETAINING WALL

WEST BLVD.

ST. PATRICK ST.