

Map Service:

[About](#) [Layers](#) [Legend](#) [Search](#) [Selection Set](#) [Keymap](#) [Bookmarks](#) [Print Map](#) [Settings](#) [Help](#) [PDF Maps](#) [Exit](#)

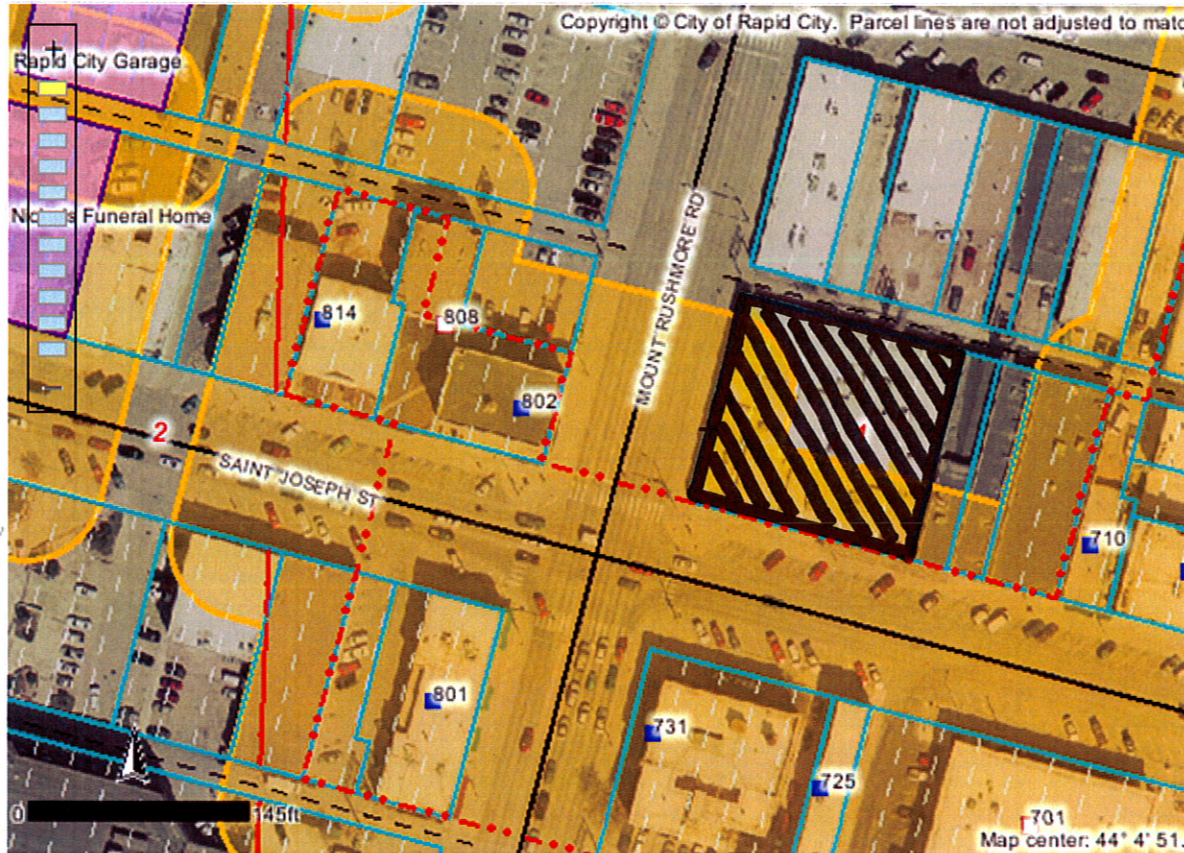

**Identify Results**

**Coordinate Position**

NAD 1983 SP SD South FT: 1207370, 650208  
 Geographic: 44° 4' 51.0" N, 103° 13' 49.0" W

**Tax Parcels**

Parcel number: 3701104013  
 Tax ID: 37407  
 Property address: 738 SAINT JOSEPH ST  
 Legal description: LOT 17-22  
 Block: 83  
 Subdivision: ORIGINAL TOWN OF RAPID CITY  
 Section: 1  
 Township: 1  
 Township direction: N  
 Range: 7  
 Range direction: E  
 Acres: 0.48  
 Property owner: BLACK HILLS WORKSHOP FOUNDATION

Owner address: PO BOX 2104  
 Owner city: RAPID CITY  
 Owner state: SD  
 Owner zip: 57709  
 Land assessment: 315000  
 Non-ag struct. assess.: 754300  
 Ag structure assess.: 0  
 Total assessment: 1069300  
 Land use code: N  
 Land type code: D  
 Improvements code: 2  
 Commercial use code: C  
 Tax districts code: 4D RC  
 Subdivision code: 7480  
 Deed type: WD  
 Deed recording month: 05  
 Deed recording day: 16  
 Deed recording year: 11  
 Book number: 208

Scale: 1: 1,515

Quick View:

Map Tool: **Identify** Active Layer: Tax Parcels

powered by **Geocortex**