

SOUTH DAKOTA HISTORIC SITES INVENTORY

Historic Name _____

Address/ Location _____ 1815 9TH _____

Common Name _____

Historic Function _____

Historic Context(s) _____

Owner's Name _____

Owner's Address _____

Owner's Phone # _____

Date(s) of Construction _____

Photographer _____

Roll # _____ Frame #'s _____
(Attach Photographs Below)

Site Number

PN RC RC WB 559
CTY TWP CIT NBH NUM

DBASE _____

U.S.G.S. Quad Map Name _____

Legal Description

Q1 Q2 SEC TWP RNG

Urban LOT _____ BLK _____
Only ADD _____

Surveyors _____

Date _____

NR Eligible Yes _____ No _____
Future NR Yes _____ No _____

Significance

HIST ARCH ARCE
 NATL STAT LOCL

Site Plan: Indicate all door and window openings, roof shapes, and landscape features.



Indicate North

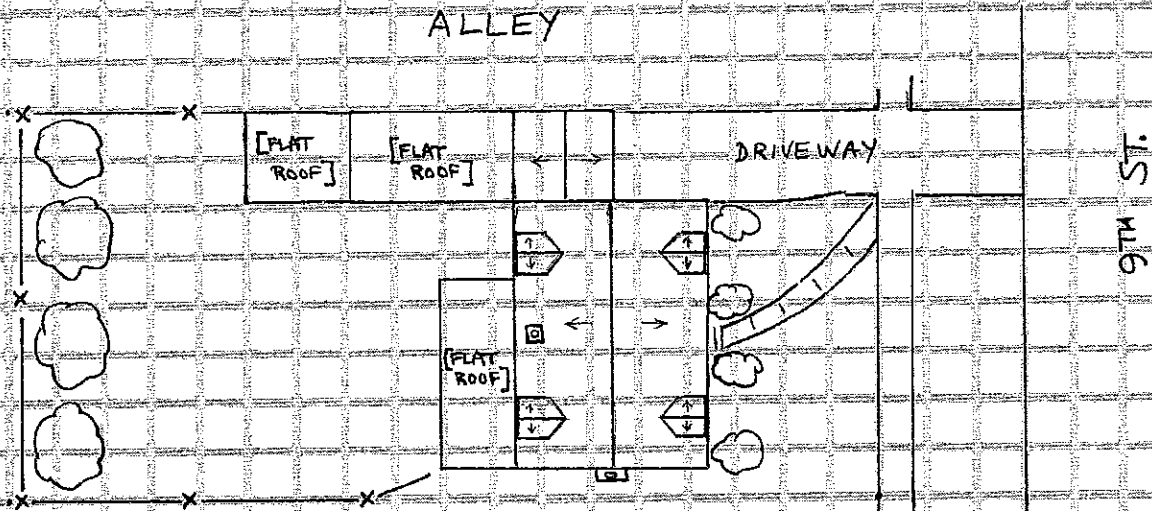

SOUTH DAKOTA HISTORIC SITES INVENTORY

Historic Name Edwin & Minnie Lighter House

Address/Location 1815 9th Street

Common Name

Historic Function House

Historic Context(s) VI. The Great Depression

Site Number
PN -RC -RC -WB -00559
CTY TWP CIT NBH NUM

DBASE 0000000000

U.S.G.S. Quad Map Name

Legal Description
0
Q1 Q2 SEC TWP RNG
Urban Only BLK 23
LOT N1/2 L27-31
ADD West Boulevard

Owner's Name Jeremiah Murphy
Owner's Address 1815 9th Street
Rapid City, SD 57701

Surveyors
M. McCormick/RTI

Owner's Phone # (605) 348-4061

Date 07/08/1992

Date(s) of Construction 1937

NR Eligible Y

Photographer M. McCormick
Roll # 17 Frame #'s 8-11
(Attach Photographs Below)

Future NR Y

Significance HIST, ARCH
LOCL



Preservation Strengths of the Site

- In Use and Not Threatened
- In Good Structural Condition
- Owners Protecting Site
- Appreciated by Public
- Valuable to Research

Preservation Threats

- Abandonment
- Deterioration Through Lack of Resources
- Vandalism or Looting
- Inappropriate Alterations
- Inappropriate or Poor Maintenance
- Fragile or Deteriorating Construction Materials
- Unsound Condition
- Lack of Support (Specify by Whom)

Environmental Situations Effecting Site (Specify What: May Include Mining, Flooding, Erosion, Pollution, Acid Rain, Weather, Isolation, Development, Etc.)

Dates:

Founding of Institution or Settlement 1876
Town and Addition Plated 1877 1886 Initial Construction of Structure 1937

Original Owners:

Name (Include Spouse if Known) Edwin H. & Minnie Lighter
Place of Origin
Date Arrived in S.D. 0000 In USA 0000

Occupation(s) Edwin: business mngr, Journal Publishing

Religious Affiliation
Social/Fraternal Affiliation

Other Previous Owners:

Names and Dates of Occupation

Structural History:

Architect's Name and
Date of Commission

Builder's Name
Pattern, Book and Number/Name

Historic Uses of the Site House

Changes in Use

Statement of Historical Significance: (Including Relation to Historic Context Topics and Study Units)

The Edwin & Minnie Lighter House has the potential to contribute to the West Boulevard Historic District. It is significant for its association with the development of the West Boulevard neighborhood in Rapid City from 1878 to 1942. Built in 1937, the house corresponds to the Great Depression, a time of economic uncertainty across the nation. Rapid City experienced limited construction in the early Depression years. In the mid 1930s, however, its construction industry revived largely because of the city's relatively healthy and diverse economy; many new homes were built in the West Boulevard neighborhood. This house helps to illustrate the economic vitality of the city during the Depression, as well as the varied social and economic status of those living in the West Boulevard neighborhood. It also serves as a representative example of the Colonial Revival style, one of various Revival styles that dominated domestic construction in the country in the 1920s and 1930s.

Miscellaneous Historical Information:

Research indicates the house was built in 1937, and was originally owned and occupied by Edwin Lighter and his wife Minnie.

Bibliography:

Oral Interview (Name, Date & Relationship to Site)

Atlas (Date & Publisher)

County History (Title & Pages)

Deed Abstract

Tax Records Assessors' Card: 1937

Sanborn-Ferris Maps (Dates)

No coverage

Census Records

Historical Photos (Description & Date)

Manuscripts (Name & Date)

Directories (Type & Date)

R.L. Polk: 1939, shows the Lighters residing at this address

Other Sources Rapid City Public Works, Water Permit #2559: E.H. Lighter, 9 June 1937

General Information:

Building # 1

Site No. PN-RC -RC-WB-00559 Date of Construction 1937 Photos 8-11
 Function House & Garage Plan Form Irregular Height (Stories) 2
 Method of Overall
 Style Colonial Revival Construction Wood-frame ? Condition E

Additions & Alterations (Types & Dates)

2nd story resided, one-story rear wing (west) enlarged to west with fixed windows and panel in-fill, and two shed additions added to rear (west) of the original attached garage: modern alterations

Evaluation of Specific Elements:

Foundation: Materials Not visible Condition

Walls: Cladding Brick on 1st story Condition E

Windows: General/ Unique	Type	Glazing Pattern	Condition	Location
G	Double-hung, wood-sash	6sq/6sq		E 2nd story
G	Fixed, wood-sash	4x3		E 1st story
U	Casement	Single		E W. wing

Doors: Type	Glazing Pattern	Condition	Location
Wood-paneled	sm. arched lights	E	East

Roof: Form Side gable Materials Wood shingles Condition E

Dormer: Type Wall: gable roofed Condition E
 Location(s) 2 on east slope and 2 on west slope

Chimneys/Ventilators: Materials 2 brick chimneys Condition E
 Location(s) Exterior: south wall; interior: west

Porches: Materials	Condition	Height (Stories)	Roof Configuration	Location
Open: brick & concrete stoop	E	0	None	East
Open: post balustrade	E	0	None	W. wing

Bays/Towers: Form Condition Height (Stories) Location(s)

Significant Exterior Details:

Cladding: horizontal steel siding on 2nd story

Windows: 1st story openings on facade (east) have a paneled wood below the window

Front door (east): wooden surround with fluted pilasters and round-topped cornice

Roof: steep pitch; and narrow, boxed eaves

West wing: one-story; brick cladding (original portion); and flat roof serving as porch balcony

Attached garage (north): original garage has a concrete foundation; brick cladding; paneled, overhead garage door; 6sq/6sq double-hung windows; and a steeply-pitched side gable roof. It has been enlarged to the west by a large ashlar-clad addition which in-turn is adjoined to the north by a vertical-siding clad addition; the additions are under a common flat roof and both apparently function as sheds

Significant Interior Details:

Not accessed