

Map Service: -Select from the following-

About Layers Legend Search Selection Set Keymap Bookmarks Print Map Settings Help PDF Maps Exit

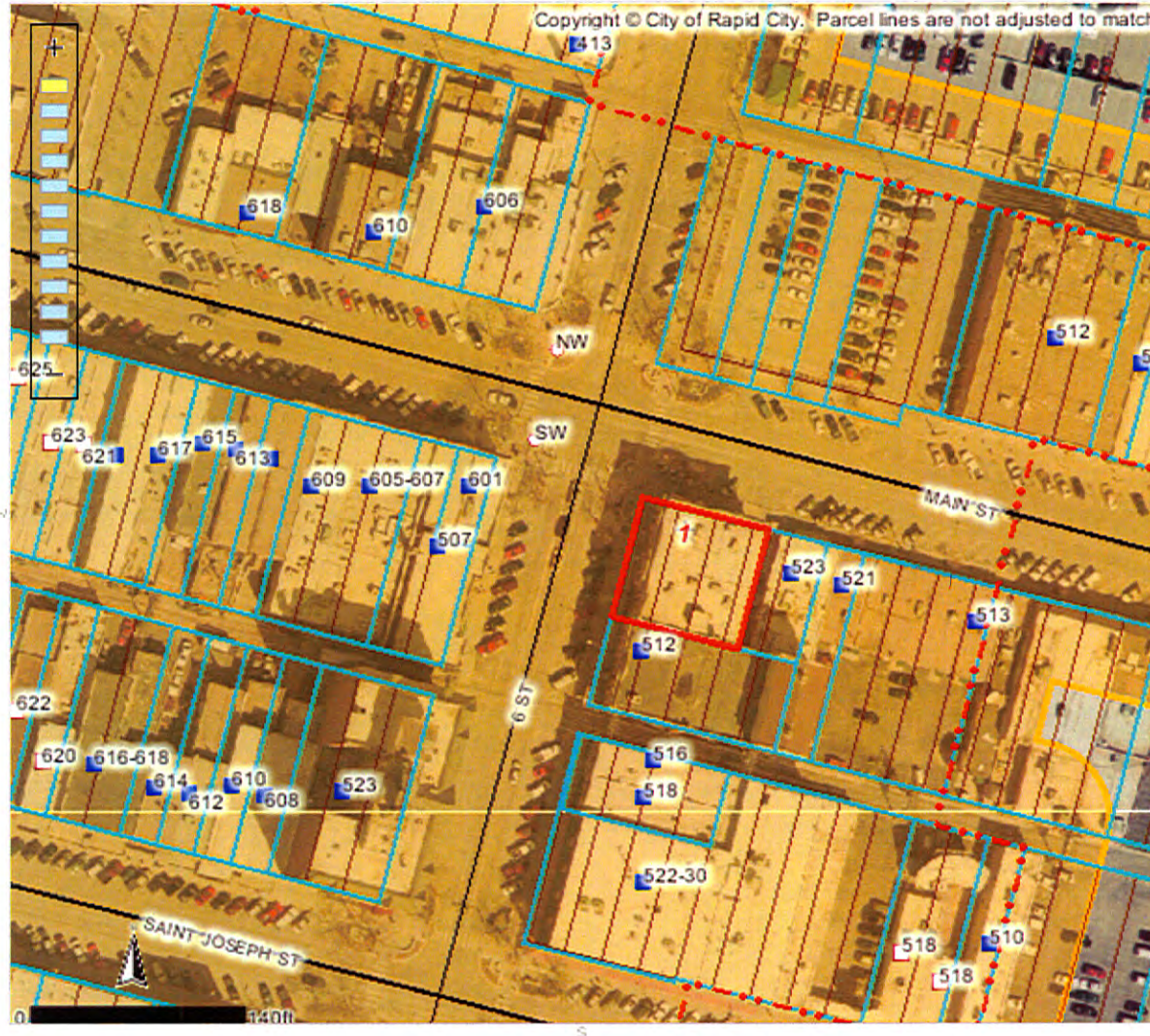

Identify Results

Coordinate Position

NAD 1983 SP SD South FT: 1208351, 650147
Geographic: 44° 4' 50.7" N, 103° 13' 36.:

Tax Parcels

Parcel ID number: 3701131001
Tax ID: 37446
Property address: 508 6TH ST
Legal description: W10' OF LOT 13, ALL OF LOT 14'
16 EXCEPTS 59.5' OF LOT 13-16

Block: 85
Subdivision: ORIGINAL TOWN OF RAPID CIT
Section: 1
Township: 1
Township direction: N
Range: 7
Range direction: E
Acres: 0.16
Property owner: DOWNTOWN ELKS BUILDING
LLC

Owner address: 2834 JACKSON BLVD STE 202
Owner city: RAPID CITY
Owner state: SD
Owner zip: 57702
Land assessment: 102600
Non-ag struct. assess.: 1205600
Ag structure assess.: 0
Total assessment: 1308200
Land use code: N
Land type code: D
Improvements code: 2
Commercial use code: C
Tax districts code: 4D RC
Subdivision code: 7480
Deed type: WD
Deed recording month: 09
Deed recording day: 28
Deed recording year: 10

Scale: 1: 1,460

Quick View: Select a location

Map Tool: Identify Active Layer: Tax Parcels

powered by Geocortex