

Note: Addition is not attached to garage.

View From Fulton Street

Brosz Engineering, Inc.
 Registered in South Dakota, South Dakota,
 Wyoming, Missouri, and Nebraska

CONSULTING ENGINEERS - LAND SURVEYORS
 REGISTERED IN SOUTH DAKOTA,
 NORTH DAKOTA, MONTANA AND WYOMING

PO Box 630
 Rapid, SD 57702

Phone: (605) 341-2720 Fax: (605) 341-2822

Designer: **TJG**
 Drafter/Checker: **JC**
 Checked By: _____
 Project Number: **S10-S720**

1103 W. BOULEVARD
 RAPID CITY, SD

No.	Description	Date	By

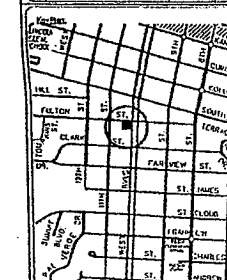

Project Name:
 1103 W. BOULEVARD
 RAPID CITY, SD
 Drawing Name:
 SIDE VIEW
 WITH ADDITION

Drawing Filename:
 10720\side_view.dgn
 Date:
 March 10, 2010
 Author:
 Designer/Checker:
 Scale:
 1" = 10'

Sheet Number:
S4

FULTON STREET

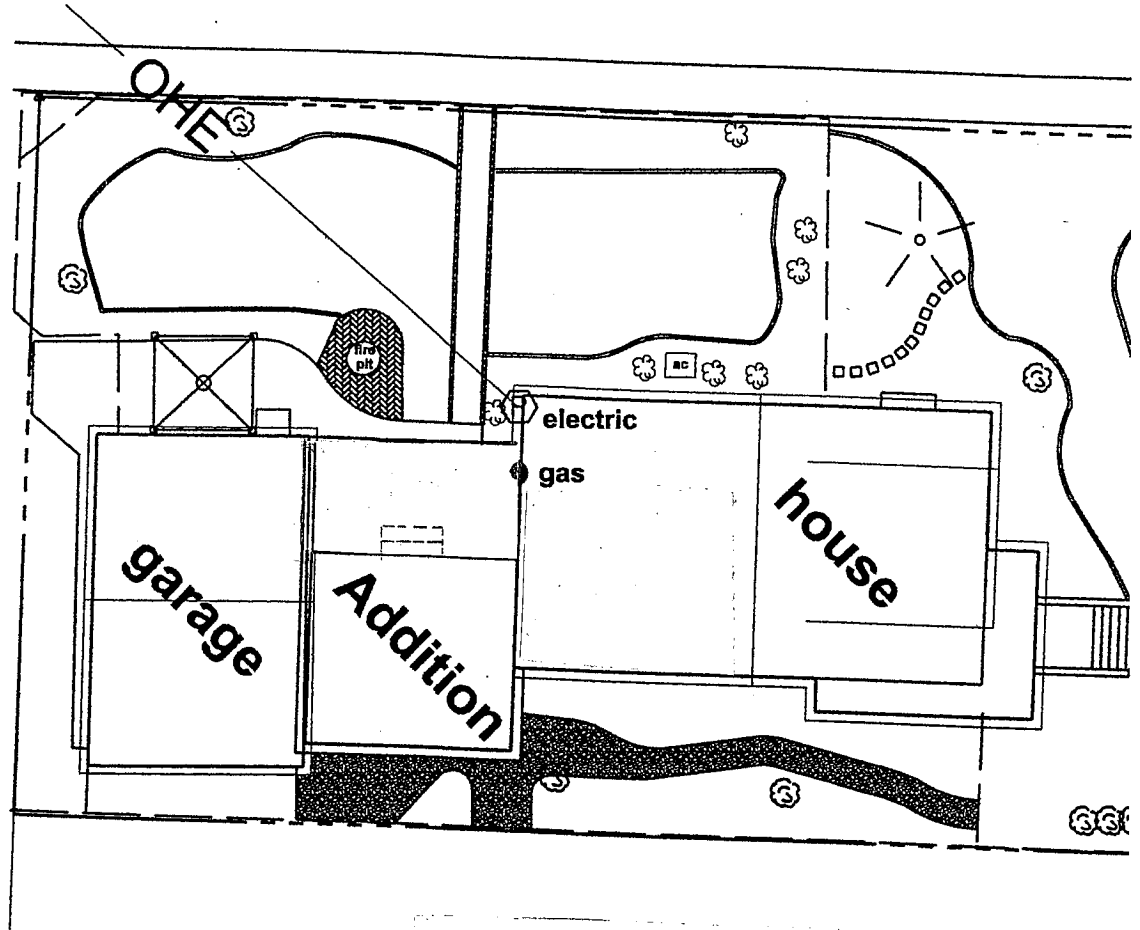

* Measurement per contractor
on March 8, 2010

Gap between garage
and addition 1" to 4"±

