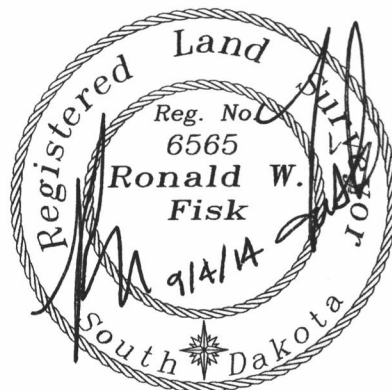
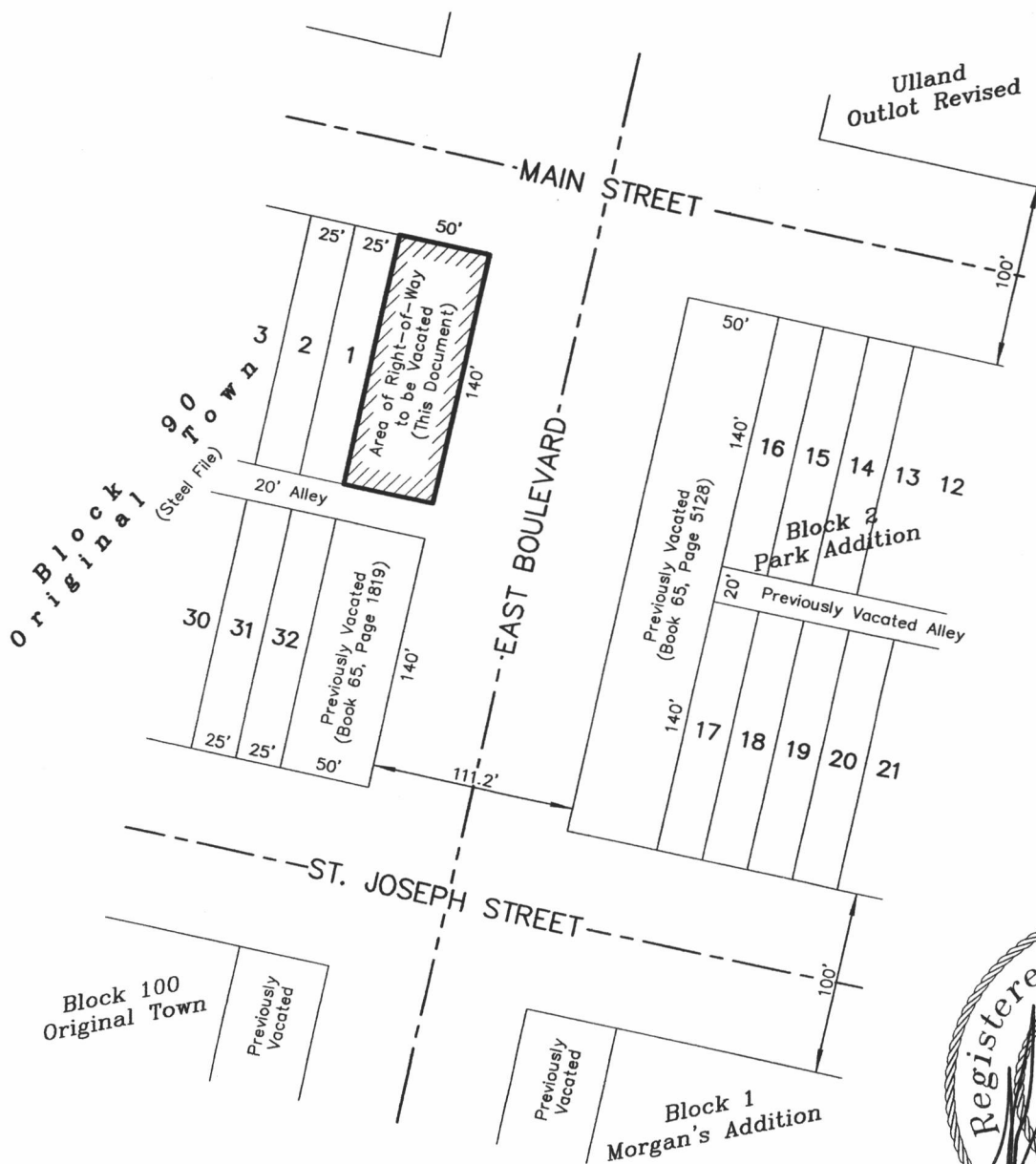

EXHIBIT A

VACATION OF THAT PORTION OF THE WESTERLY 50 FEET OF EAST BOULEVARD RIGHT-OF-WAY ADJOINING AND EASTERLY OF LOT 1 OF BLOCK 90, ORIGINAL TOWN OF RAPID CITY, IN THE NE1/4 OF SECTION 1, T1N, R7E, BHM, RAPID CITY, PENNINGTON COUNTY, SOUTH DAKOTA



1"=100'



PREPARED BY:
 FISK LAND SURVEYING & CONSULTING ENGINEERS, INC.
 P.O. BOX 8154, RAPID CITY, SD 57709 (605) 348-1538 August 26, 2014