

11RZ024

METES AND BOUNDS LOT 4 OF BLOCK 3, STONEY CREEK SOUTH SUBDIVISION

LOCATED IN THE SW1/4,
SECTION 22, T1N, R7E, BHM
RAPID CITY, PENNINGTON COUNTY, SOUTH DAKOTA

SEPTEMBER 12, 2011

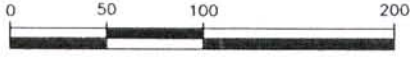

SCALE 1" = 100'

LOT 7

LOT 5

OC TO GC
0.426 Ac.±

S89°21'43"W
125.70'

N19°11'19"E
116.69'

124.48'

17

LOT 4

LDR TO GC
3.404 Ac.±

180.16'

S70°48'41"E
193.96'

N25°51'53"E

290.02'

S63°36'24"E

1/16 LINE

148.06'

N00°06'46"W
331.83'

296.95'

S26°23'14"W

46.12'

N62°34'47"W
600.53'

CATRON BLVD

GAD TO GC
0.505 Ac.±

POINT OF BEGINNING

POINT OF BEGINNING

Rapid City Growth
Management Department

BLOCK 2

BLOCK 3

BLOCK 5

RECEIVED

SEP 15 2011

LINE	BEARING	LENGTH
L1	N01°34'53"E	40.08'

CURVE	LENGTH	RADIUS	DELTA	CHORD BEARING	CHORD DISTANCE
C1	123.86	174.00	40°47'10"	N21°58'28"E	121.26

RENNER & ASSOCIATES, LLC.

616 SIXTH ST. * RAPID CITY, SD 57701
PHONE: 605/721-7310 FAX: 605/721-7313
SPEARFISH OFFICE: 605/717-0016

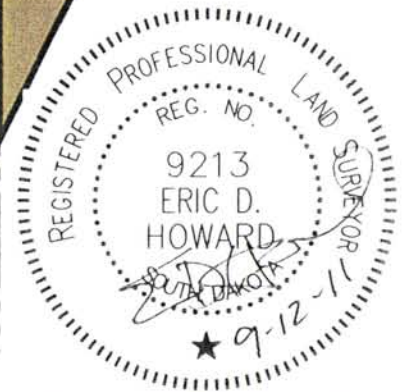

CITY HALL 1903