

# EXHIBIT "A"

PARTIAL VACATION OF ALLEY RIGHT-OF-WAY ADJACENT TO LOTS 24 - 32 OF BLOCK 75 OF THE ORIGINAL TOWNSITE OF THE CITY OF RAPID CITY, LOCATED IN SECTION 1, T1N, R7E, BHM. RAPID CITY, PENNINGTON COUNTY, SD

LOT 21-23 & VACATED PORTION OF MAIN ST ADJACENT TO SAID LOT 21-22  
Block: 75  
ORIGINAL TOWN OF RAPID CITY

PREVIOUS R.O.W VACATION  
BOOK NO. 201, PAGE 4868

2.00' S14°34'41"W

ASPHALT

PARKING  
MARKERS

20'  
ROW

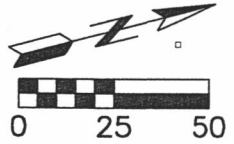

VACATED PREVIOUSLY 2' OF ALLEY RIGHT-OF-WAY ON LOTS 24-32 (0.01 AC.)

512 MAIN ST  
LOT 24-27 Block: 75  
ORIGINAL TOWN OF RAPID CITY

VACATE 2' OF ALLEY RIGHT-OF-WAY ON LOTS 24-32 (0.01 AC.) THIS DOCUMENT

510 MAIN ST  
LOT 28 Block: 75  
ORIGINAL TOWN OF RAPID CITY

508 MAIN ST  
LOT 29 Block: 75  
ORIGINAL TOWN OF RAPID CITY

502 MAIN ST  
LOT 30-32 Block: 75  
ORIGINAL TOWN OF RAPID CITY

ASPHALT

GAZEBO  
DOOR

2.00' N14°34'41"E

ALLEY

225.00' S75°25'19"E  
225.00' N75°25'19"W

PARKING GARAGE

BOLLARD

SHED TOWER

MAIN STREET

(100' R.O.W. OF RECORD)

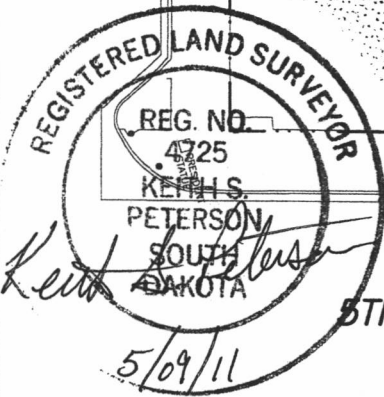

5TH STREET



1560 Concourse Dr.  
Rapid City, SD 57703  
Phone: (605) 341-7800  
Fax: (605) 341-7864  
www.cetecengineering.com  
Date: 5/9/11