

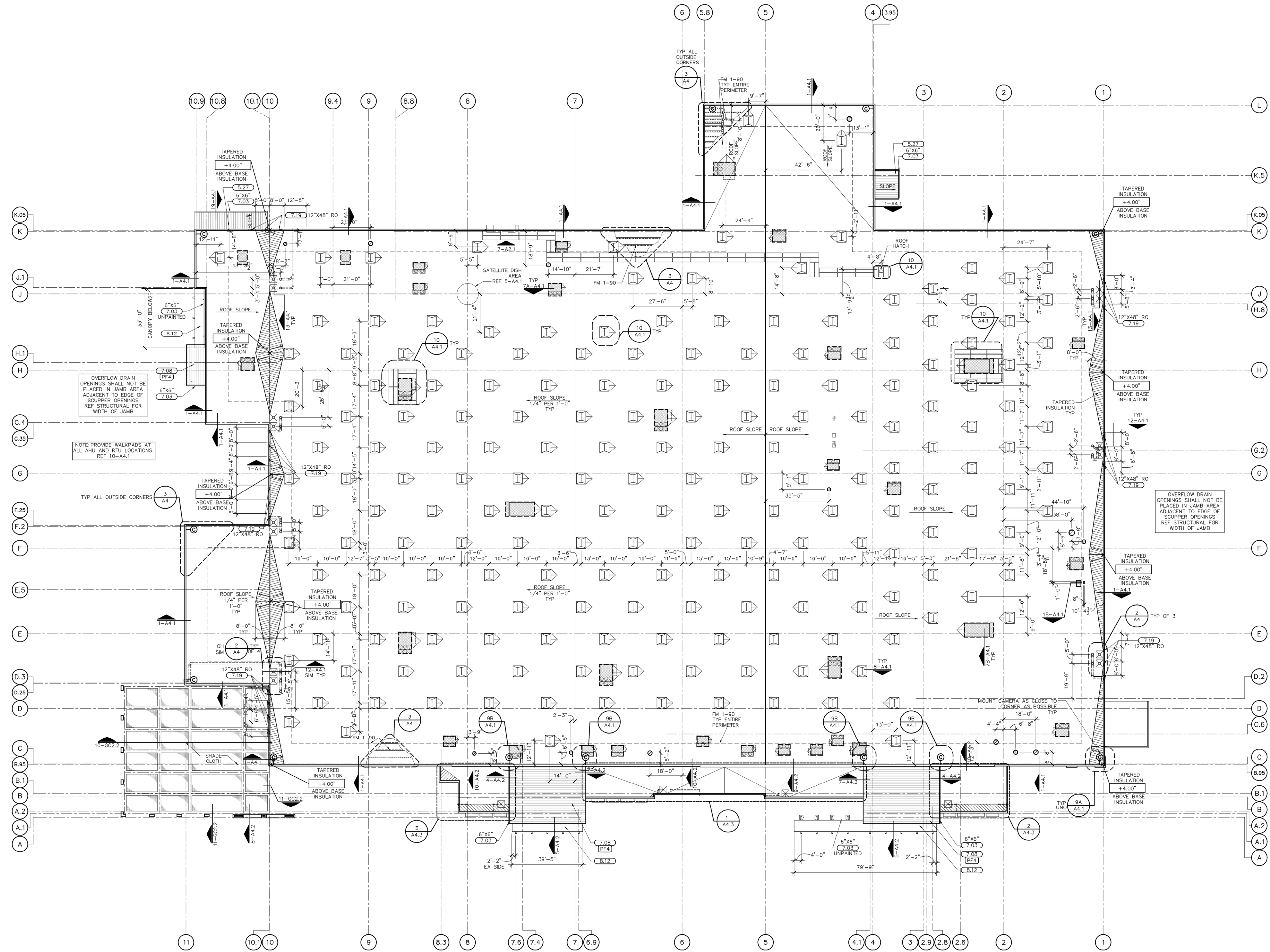

June 24, 2010

Rapid City (S), SD Store #3872

Roof Perspective



OVERFLOW DRAIN OPENINGS SHALL NOT BE PLACED IN JAMB AREA ADJACENT TO EDGE OF SCUPPER OPENINGS REF STRUCTURAL FOR WIDTH OF JAMB

NOTE: PROVIDE WALKPADS AT ALL AHU AND RTU LOCATIONS, REF 10-A4.1

OVERFLOW DRAIN OPENINGS SHALL NOT BE PLACED IN JAMB AREA ADJACENT TO EDGE OF SCUPPER OPENINGS REF STRUCTURAL FOR WIDTH OF JAMB



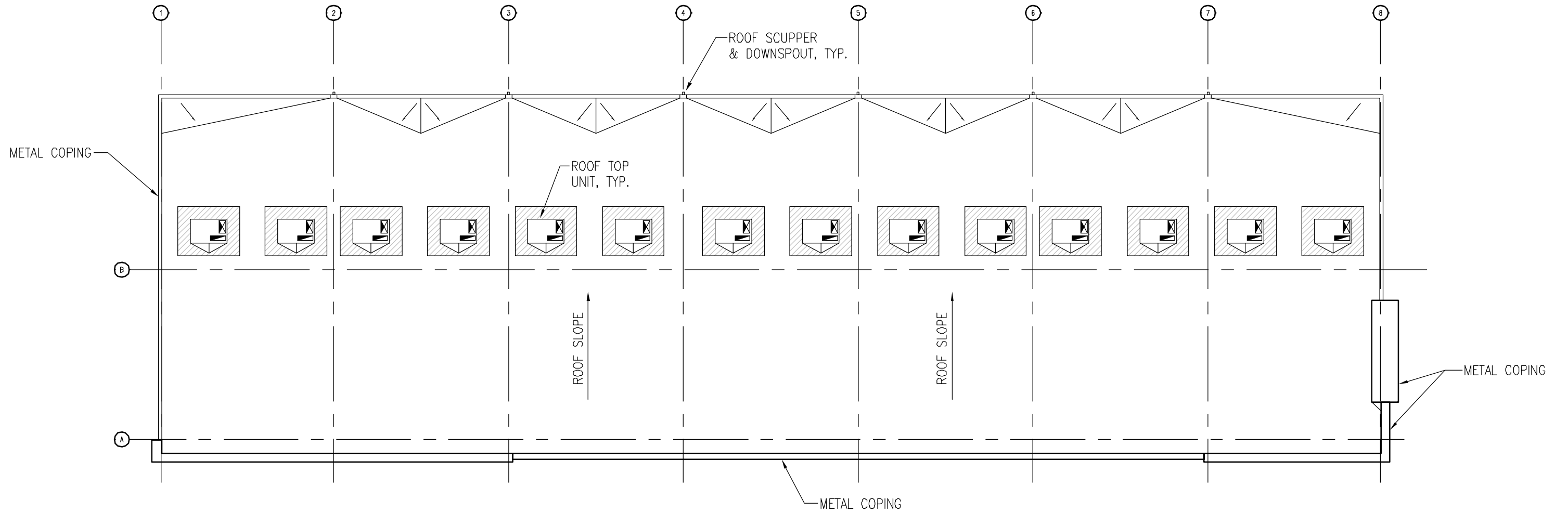

ROOF PLAN

SCALE: 1" = 20'-0"

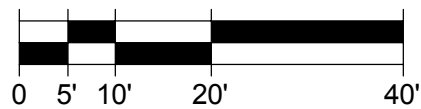

**RETAIL SHOPS
BLACK HILLS CENTER**

RAPID CITY,
10-141

SOUTH DAKOTA
12.08.10