

THIS MAP IS A COPY OF THE ORIGINAL AND IS NOT TO BE USED FOR ANY OTHER PURPOSE. THE ORIGINAL MAP IS KEPT AT THE OFFICE OF THE ENGINEER. ANY CHANGES TO THIS MAP MUST BE APPROVED BY THE ENGINEER.

**Wolverton & Associates**  
 Consulting Engineers & Land Surveyors  
 2500 N. 19th Avenue, Suite 200  
 Fort Collins, CO 80504  
 Phone: (970) 225-7700

NOT FOR CONSTRUCTION / PERMIT REVIEW ONLY

PROPOSED BLACK HILLS CENTER  
 Walmart # 3872-03  
 RAPID CITY, PENNINGTON COUNTY, S.D.  
 BY: THE STONERIDGE DEVELOPMENT, LLC  
 ST. LOUIS, MO

REVISIONS	BY

**SITE PLAN 'A'**  
**SIGHTLINES**  
 GRAPHIC SCALE

DATE: 12/08/2010  
 TIME: 1:00  
 DRAWN BY: J.K.H.  
 CHECKED BY: J.K.H.  
 SCALE: AS SHOWN  
 SHEET: 08-140

**SL-A**

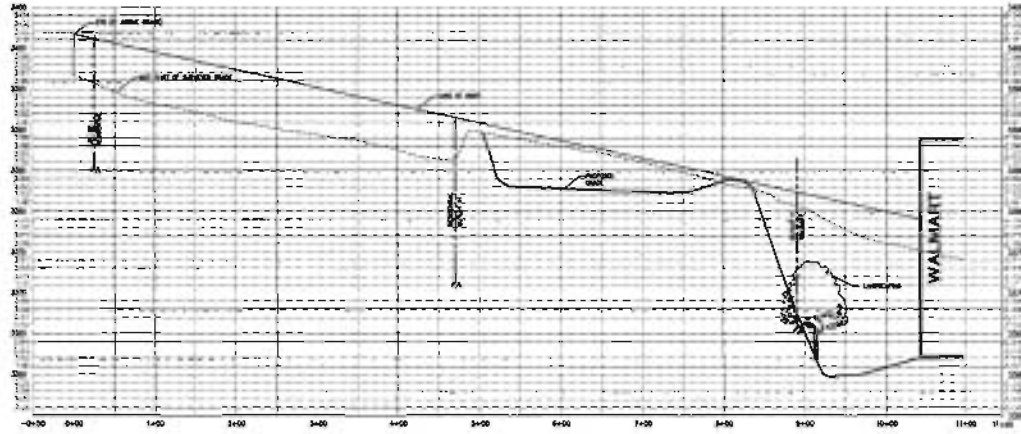

**SIGHT LINE LOT 8B**  
 scale: 1"=60' horizontal  
 1"=6' vertical

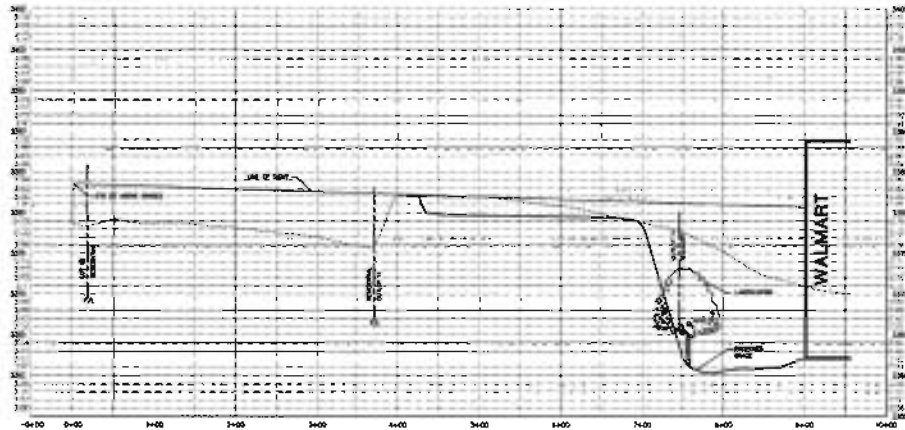

**SIGHT LINE LOT 6B**  
 scale: 1"=60' horizontal  
 1"=6' vertical

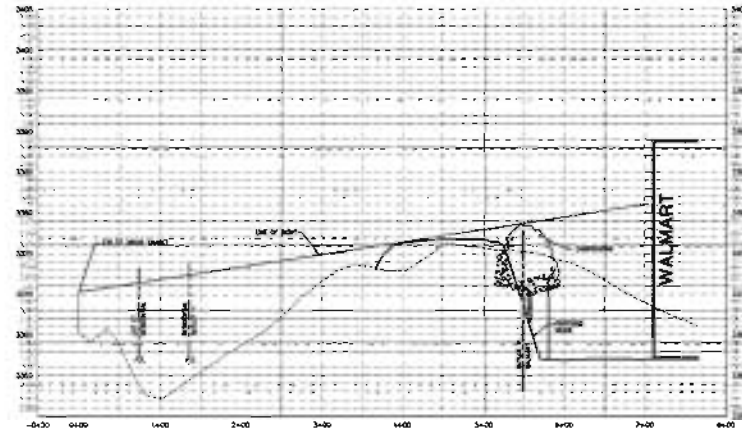

**SIGHT LINE LOT 17**  
 scale: 1"=60' horizontal  
 1"=6' vertical

**SITE PLAN 'A'  
 SIGHTLINES  
 PROFILES**

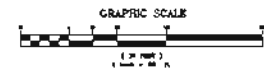

NOT FOR CONSTRUCTION / PERMIT REVIEW ONLY

PROPOSED BLACK HILLS CENTER  
 Walmart # 3872-08  
 RAPID CITY, PENNINGTON COUNTY, S.D.  
 BY: THF, STONERIDGE DEVELOPMENT, LLC  
 ST. LOUIS, MO

REVISIONS	BY

**Wolverton & Associates**  
 Consulting Engineers & Surveyors  
 10401 Olive Street  
 St. Louis, MO 63143  
 Phone: (314) 644-0900  
 Fax: (314) 644-0901  
 www.wolverton.com



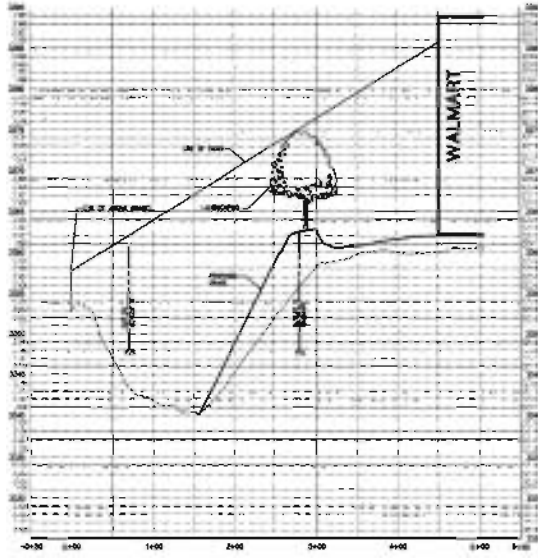

**SIGHT LINE LOT 20**  
 scale: 1"=60' horizontal  
 1"=6' vertical

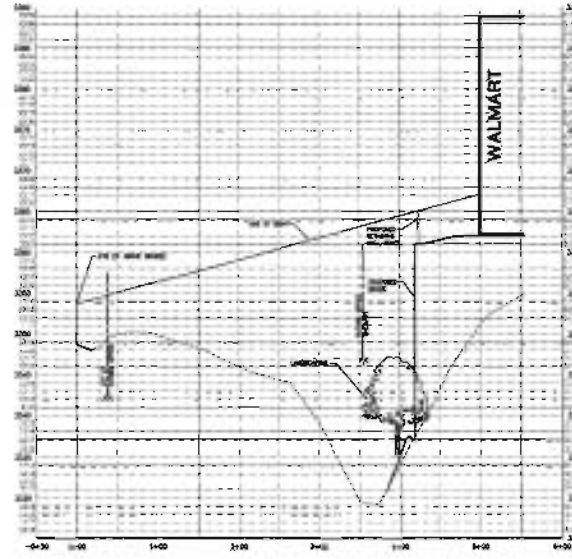

**SIGHT LINE LOT 23**  
 scale: 1"=60' horizontal  
 1"=6' vertical

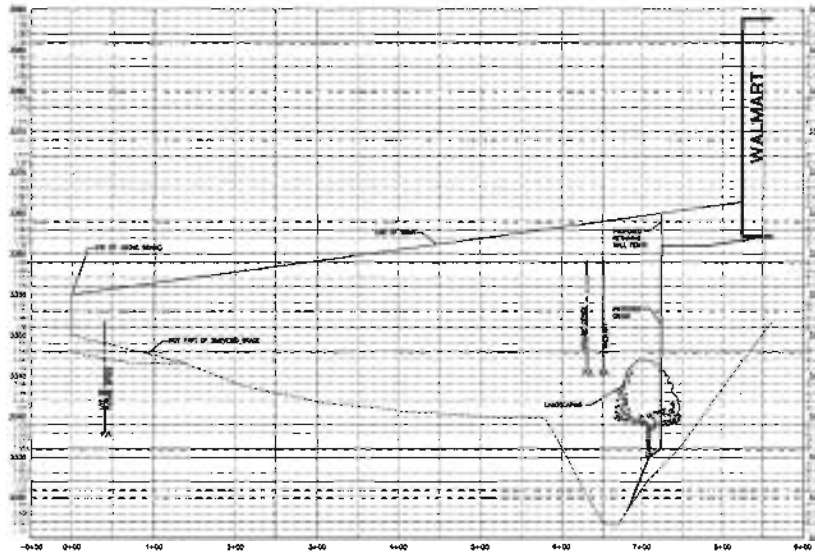

**SIGHT LINE LOT 26**  
 scale: 1"=60' horizontal  
 1"=6' vertical

**SITE PLAN 'A'  
 SIGHTLINES  
 PROFILES**



NOT FOR CONSTRUCTION / PERMIT REVIEW ONLY

PROPOSED BLACK HILLS CENTER  
 Walmart # 3872-03  
 RAPID CITY, PENNINGTON COUNTY, S.D.  
 BY: THE STONERIDGE DEVELOPMENT, LLC  
 ST. LOUIS, MO

REVISIONS	BY

DESIGNED BY	DLN/CRP
DRAWN BY	ZJW
DATE	12/08/2020
SCALE	AS NOTED
DATE	08-14-20
HEET NUMBER	

**SL-A2**  
 OF SHEETS

**W**  
**Wolverton Associates**  
 Consulting Engineers • Land Surveyors  
 1000 North Broadway, Suite 200, Rapid City, South Dakota 57701  
 P: 605.342.1100  
 F: 605.342.1101  
 www.wolvertonassociates.com



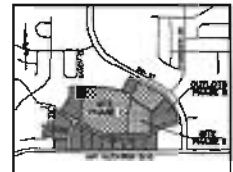
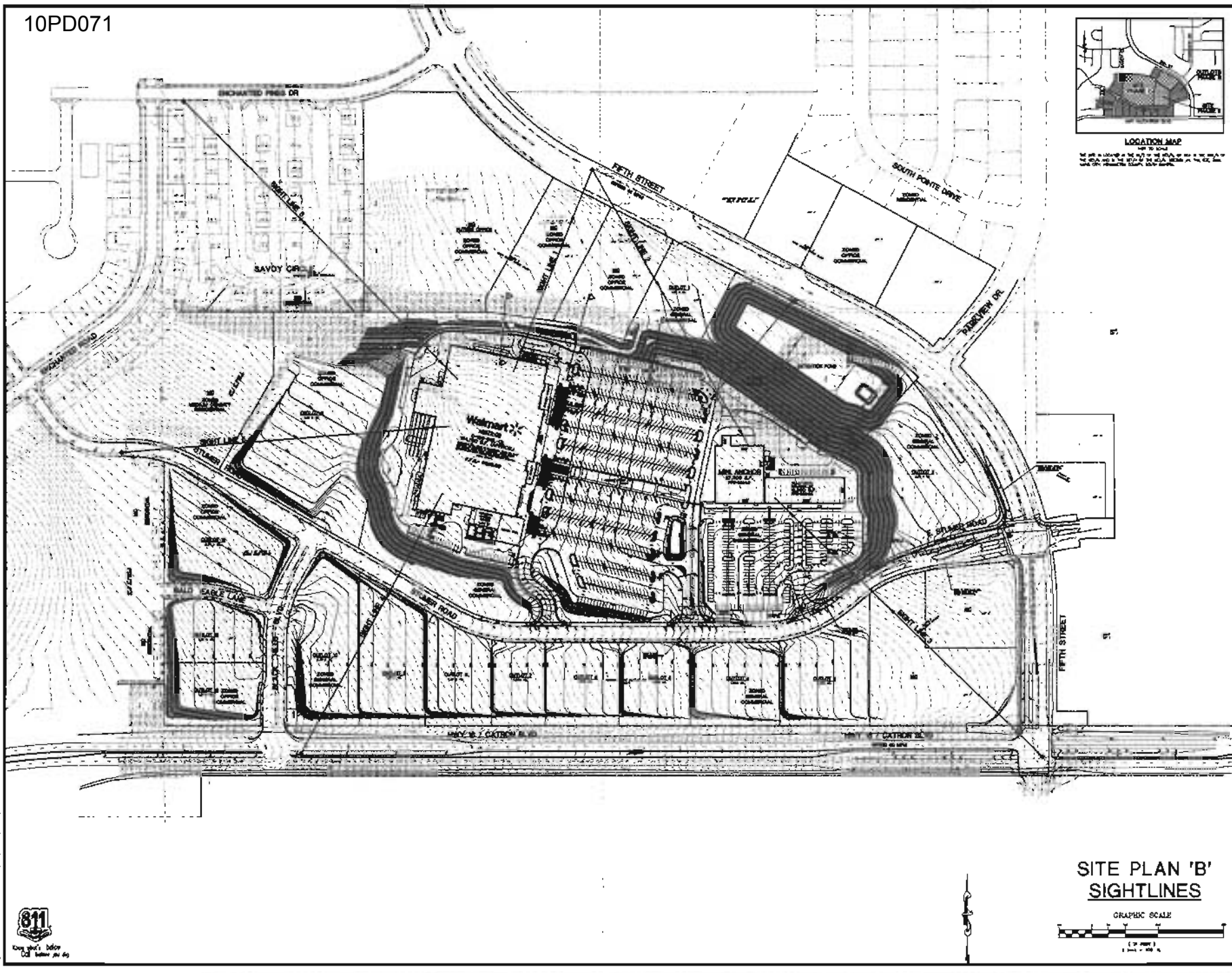

**W**  
**Wolverton & Associates**  
 Consulting Engineers • Land Surveyors  
 and Architects • 1000 South Grand Street  
 St. Louis, Missouri 63104  
 www.wolverton.com

PROPOSED BLACK HILLS CENTER  
 Westmont • # 8872-03  
 RAPID CITY, PENNINGTON COUNTY, S.D.  
 BY: THF, STONERIDGE DEVELOPMENT, LLC  
 ST. LOUIS, MO

NOT FOR CONSTRUCTION / PERMIT REVIEW ONLY

REVISIONS	21
-----------	----

DESIGNED BY	DMB/CSP
CHECKED BY	K-W
DATE	02/06/2010
SCALE	1" = 100'
JOB NO.	08-160
DATE PLOTTED	

**SL-B**

**SITE PLAN 'B'  
 SIGHTLINES**

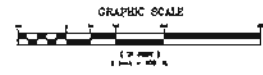



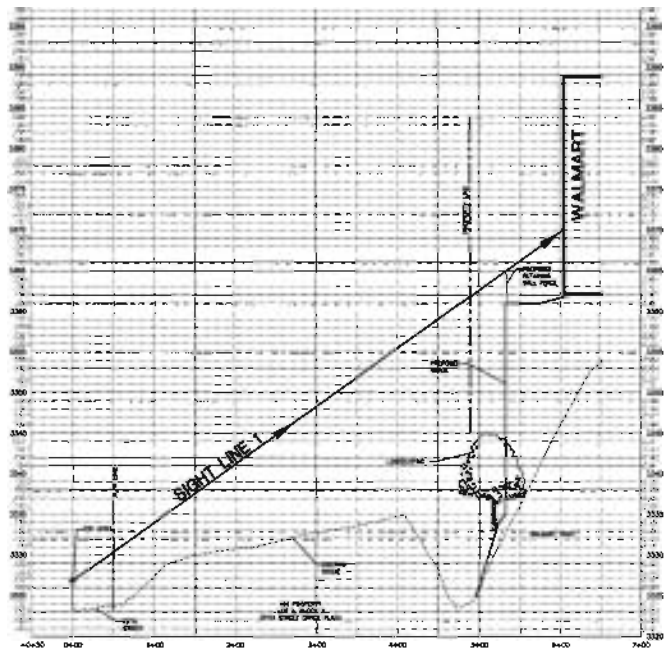

**SIGHT LINE 1**  
 scale: 1"=60' horizontal  
 1"=6' vertical

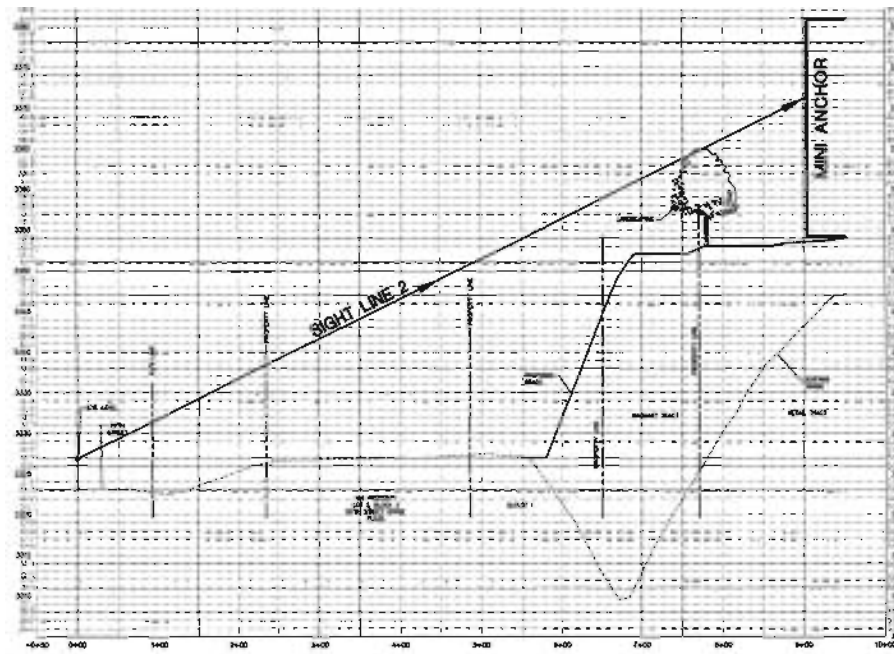

**SIGHT LINE 2**  
 scale: 1"=60' horizontal  
 1"=6' vertical

**SITE PLAN 'B'  
 SIGHTLINES  
 PROFILES**



**W**olverton & Associates  
 Consulting Engineers • Land Surveyors  
 2525 W. 7th Street, Suite 200  
 St. Louis, MO 63105  
 Phone: (314) 963-2200  
 Fax: (314) 963-2201  
 www.wolverton.com

PROPOSED BLACK HILLS CENTER  
 Walmart # 3872-03  
 RAPID CITY, PENNINGTON COUNTY, S.D.  
 BY: THF, STONERIDGE DEVELOPMENT, LLC  
 ST. LOUIS, MO

NOT FOR CONSTRUCTION / PERMIT REVIEW ONLY

REVISIONS	BY

DESIGNED BY: DML/CRP  
 CHECKED BY: KAW  
 DATE: 12/09/2020  
 SCALE: AS NOTED  
 JOB NO: 09-140  
 SHEET NUMBER: **SL-B1**  
 OF: 04/079



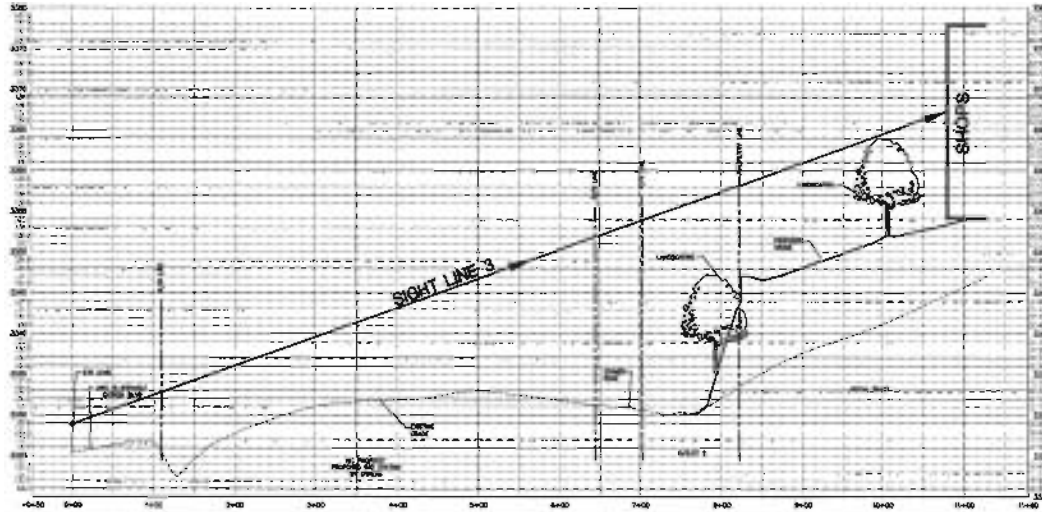

**SIGHT LINE 3**  
 scale: 1"=60' horizontal  
 1"=6' vertical

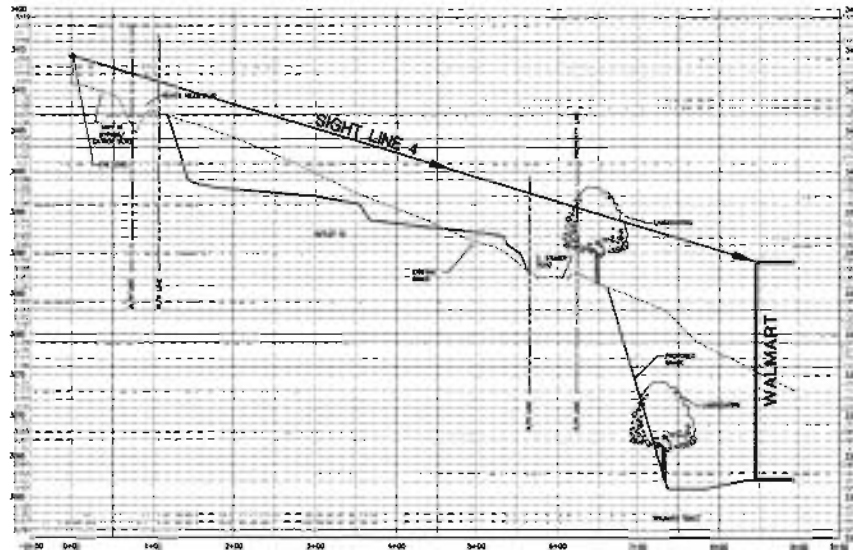

**SIGHT LINE 4**  
 scale: 1"=60' horizontal  
 1"=6' vertical

**SITE PLAN 'B'  
 SIGHTLINES  
 PROFILES**



NOT FOR CONSTRUCTION / PERMIT REVIEW ONLY

PROPOSED BLACK HILLS CENTER  
 Walmart # 3872-03  
 RAPID CITY, PENNINGTON COUNTY, S.D.  
 BY: THF, STONERIDGE DEVELOPMENT, LLC  
 ST. LOUIS, MO

REVISIONS	BY

DESIGN BY: DMV/CRP  
 CHECKED BY: KJW  
 DATE: 02/08/2010  
 SCALE: AS NOTED  
 JOB NO: 08-160  
 SHEET NAME:  
**SL-B2**

**W**  
**Wolverton & Associates**  
 Consulting Engineers • Land Surveyors  
 One West 7th Street, Suite 200 • St. Louis, MO 63101  
 Phone: 314.433.2222 • Fax: 314.433.2222  
 www.wolvertonassociates.com



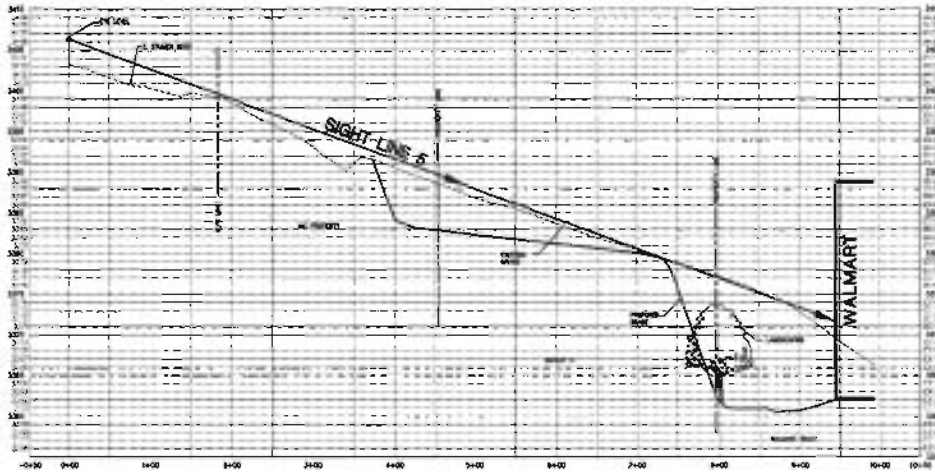

SIGHT LINE 5  
scale: 1"=60' horizontal  
1"=6' vertical

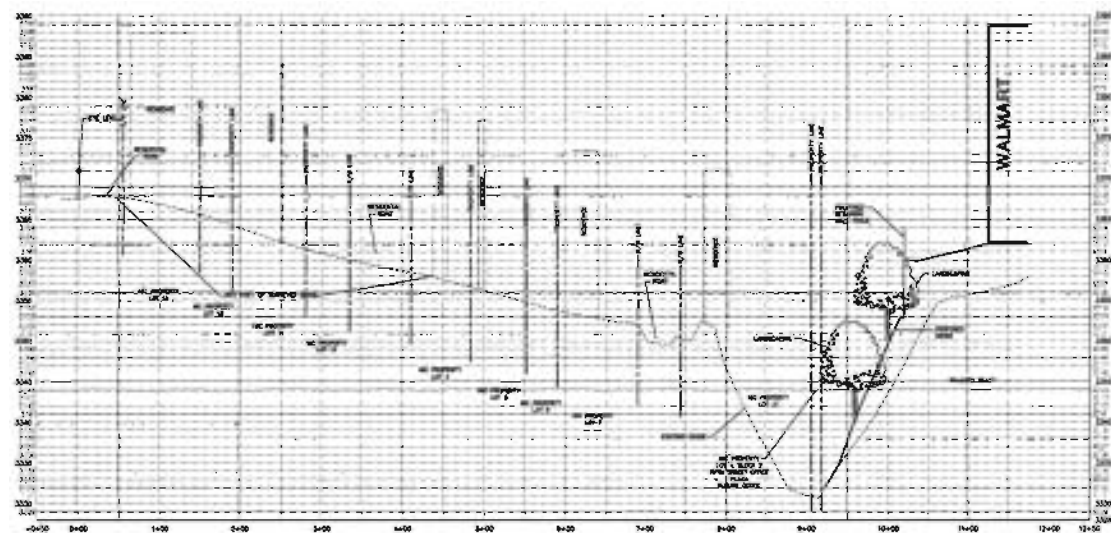

SIGHT LINE 6  
scale: 1"=60' horizontal  
1"=6' vertical

SITE PLAN 'B'  
SIGHTLINES  
PROFILES



NOT FOR CONSTRUCTION / PERMIT REVIEW ONLY

PROPOSED BLACK HILLS CENTER  
Walmart # 3672-03  
RAPID CITY, PENNINGTON COUNTY, S.D.  
BY: THE STONERIDGE DEVELOPMENT, LLC  
ST. LOUIS, MO

REVISIONS	BY

SL-B3

