

RECEIVED

DEC 21 2010

Rapid City Growth Management Department

PROPOSED DEVELOPMENT PLANS BLACK HILLS CENTER

Walmart STORE# 3872-03

RAPID CITY, PENNINGTON COUNTY, S.D. HWY 16 / CATRON BOULEVARD INTERSECTION FIFTH STREET

UTILITY RESPONSIBILITY MATRIX FOR THIS PROJECT

Table with 3 columns: UTILITY/GOVERNING AGENCIES CONTACTS, CONTRACTOR RESPONSIBILITY, OTHERS RESPONSIBILITY. Rows include Gas Service, Electric, Sewer, Water, Fire, and ERE.

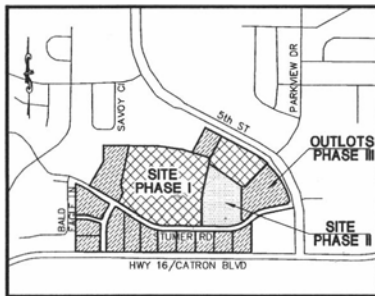

LOCATION MAP

NOT TO SCALE

THE SITE IS LOCATED IN THE S1/2 OF THE NE1/4, OR AKA IN THE SW1/4 OF THE NE1/4 AND IN THE SE1/4 OF THE NE1/4, SECTION 24, T1N, R7E, B9M, RAPID CITY, PENNINGTON COUNTY, SOUTH DAKOTA.

NOTES:

- 1. THE STIPWORK FOR THE WALMART PORTION OF THIS PROJECT SHALL MEET OR EXCEED THE "WALMART STANDARD STIPWORK SPECIFICATIONS".
2. ALL NECESSARY WORKINGS AND/OR CERTIFICATIONS REQUIRED BY CODES AND/OR UTILITY SERVICE COMPANIES SHALL BE PERFORMED PRIOR TO ANNOUNCED BIDDING POSSESSION AND THE FINAL CONNECTION OF SERVICES.

SHEET INDEX table with columns: Page No., Description, Issue Date, Latest Revision, Comment. Lists sheets from 1 to 77, including COVER SHEET, TOPOGRAPHIC MAP, PROPERTY MAP, SITE PLAN, GRADING PLAN, UTILITY PLAN, etc.

NOTE: PLANS SUBMITTED UNDER A SEPARATE COVER INCLUDE: -FIFTH STREET AND EAST STUMER ROAD INTERSECTION IMPROVEMENT PLANS. -TRAFFIC SIGNAL REGULATION PLAN US 16B / CATRON BOULEVARD AND BLACKHILLS BOULEVARD.

NOT FOR CONSTRUCTION / PERMIT REVIEW ONLY. Project Developer: THE STONERIDGE DEVELOPMENT, LLC. 2127 INNERBELT BUSINESS CENTER DR. SUITE 200 / ST. LOUIS, MO. 63114

Wolverton & Associates Consulting Engineers + Land Surveyors. 1000 North 10th Street, Suite 200, Rapid City, SD 57701. www.wolverton-associ.com



PROPOSED BLACK HILLS CENTER Walmart # 3872-03 RAPID CITY, PENNINGTON COUNTY, S.D. BY: THF, STONERIDGE DEVELOPMENT, LLC

Project Developer: THE STONERIDGE DEVELOPMENT, LLC 2127 INNERBELT BUSINESS CENTER DR. SUITE 200 / ST. LOUIS, MO. 63114

ENGINEER- Wolverton & Associates Consulting Engineers + Land Surveyors. 6745 Sugarloaf Parkway • Suite 100 • Duluth, Georgia 30097. Phone: (770) 447-8999 • Fax: (770) 447-9070. www.wolverton-associ.com CONTACT: MR. KELLY J. WAGONER

OWNER / DEVELOPER- THF STONERIDGE DEVELOPMENT, LLC 2127 INNERBELT BUSINESS CENTER DR. SUITE 200 / ST. LOUIS, MO. 63114. PHONE: (314) 429-0900 FAX: (314) 429-0999

Sheet Number: C-0

SOIL EROSION/SEDIMENTATION CONTROL OPERATION TIME SCHEDULE

NOTE: GENERAL CONTRACTOR TO COMPLETE TABLE WITH THEIR SPECIFIC PROJECT SCHEDULE

CONSTRUCTION SEQUENCE	1	2	3	4	5	6	7	8	9	10	11	12	13	14	15	16	17	18	19	20
TEMPORARY CONSTRUCTION EXITS																				
TEMPORARY CONTROL MEASURES																				
SEMENT CONTROL BARRIERS																				
STORM & SEDIMENT TRENCHES																				
STORM FACILITIES																				
SITE CONSTRUCTION																				
PERMANENT CONTROL STRUCTURES																				
FOUNDATION / BUILDING CONSTRUCTION																				
FRESH GRADES																				
LANDSCAPING/VEGETATION STABILIZATION																				

1) CONTRACTOR SHALL UPDATE THE TABLE BY DASHING OR SAYING THE APPLICABLE ACTIVITIES AS PROJECT PROGRESSES.

2) THE SCHEDULE MUST CONFORM WITH SEQUENCE OF CONSTRUCTION.

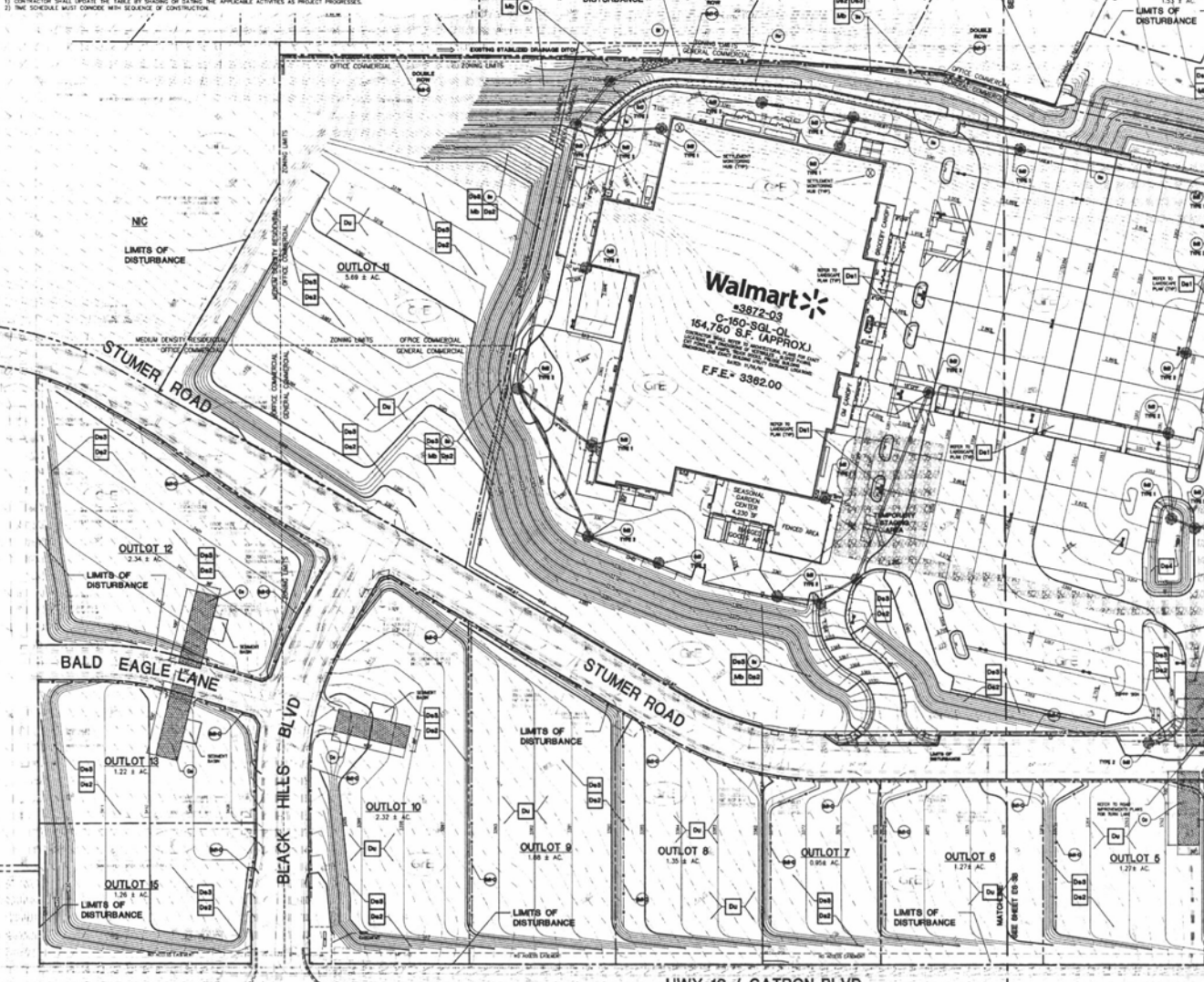

BEST MANAGEMENT PRACTICES SEQUENCE

1. TEMPORARY SEED THROUGHOUT CONSTRUCTION BARRIERS AREAS SHALL BE MAINTAINED FOR 14 DAYS OF WORK.
2. METALS, NITRATES, NITROGENOUS, STORM SEWER, CLAYS AND SILTS SHALL BE REMOVED.
3. METALS REPAIR AREAS AROUND STRUCTURES AS EACH OUPLET LOCATED AS REQUIRED.
4. METALS MUST PROTECT ALL AT ALL STORM SEWER STRUCTURES AS EACH MUST BE PROTECTED BY METALS AS THEY ARE SUBJECT TO FRESH GRADES.
5. METALS APPROPRIATE MUST PROTECT DEVICES FOR PAVED AREAS AS WELL AS UNPAVED AREAS.
6. COMPLETE GRADES AND INSTALLATION OF PERMANENT CONTROL MEASURES SHALL BE COMPLETED BY THE END OF THE CONSTRUCTION PERIOD.
7. MAINTAIN ALL REMAINING TEMPORARY EROSION AND SEDIMENT CONTROL DEVICES.
8. STABILIZE ANY AREAS DISTURBED BY THE REMOVAL OF CONTROL MEASURES.
9. COMPLETE GRADES AND INSTALLATION OF PERMANENT CONTROL MEASURES SHALL BE COMPLETED BY THE END OF THE CONSTRUCTION PERIOD.
10. COMPLETE GRADES AND INSTALLATION OF PERMANENT CONTROL MEASURES SHALL BE COMPLETED BY THE END OF THE CONSTRUCTION PERIOD.
11. COMPLETE GRADES AND INSTALLATION OF PERMANENT CONTROL MEASURES SHALL BE COMPLETED BY THE END OF THE CONSTRUCTION PERIOD.
12. COMPLETE GRADES AND INSTALLATION OF PERMANENT CONTROL MEASURES SHALL BE COMPLETED BY THE END OF THE CONSTRUCTION PERIOD.
13. COMPLETE GRADES AND INSTALLATION OF PERMANENT CONTROL MEASURES SHALL BE COMPLETED BY THE END OF THE CONSTRUCTION PERIOD.
14. COMPLETE GRADES AND INSTALLATION OF PERMANENT CONTROL MEASURES SHALL BE COMPLETED BY THE END OF THE CONSTRUCTION PERIOD.
15. COMPLETE GRADES AND INSTALLATION OF PERMANENT CONTROL MEASURES SHALL BE COMPLETED BY THE END OF THE CONSTRUCTION PERIOD.



STRUCTURAL PRACTICES

CODE	PRACTICE	DETAIL	MAP SYMBOL	DESCRIPTION
D1	DEED SIGN			1. A sign shall be placed at the entrance of the site to advise the public of the construction project.
D2	DESTRUCTION			1. All existing structures to be demolished shall be demolished in accordance with the approved plan.
D3	DEMOLITION			1. All existing structures to be demolished shall be demolished in accordance with the approved plan.
D4	DEMOLITION			1. All existing structures to be demolished shall be demolished in accordance with the approved plan.
D5	DEMOLITION			1. All existing structures to be demolished shall be demolished in accordance with the approved plan.
D6	DEMOLITION			1. All existing structures to be demolished shall be demolished in accordance with the approved plan.
D7	DEMOLITION			1. All existing structures to be demolished shall be demolished in accordance with the approved plan.
D8	DEMOLITION			1. All existing structures to be demolished shall be demolished in accordance with the approved plan.
D9	DEMOLITION			1. All existing structures to be demolished shall be demolished in accordance with the approved plan.
D10	DEMOLITION			1. All existing structures to be demolished shall be demolished in accordance with the approved plan.
D11	DEMOLITION			1. All existing structures to be demolished shall be demolished in accordance with the approved plan.
D12	DEMOLITION			1. All existing structures to be demolished shall be demolished in accordance with the approved plan.
D13	DEMOLITION			1. All existing structures to be demolished shall be demolished in accordance with the approved plan.
D14	DEMOLITION			1. All existing structures to be demolished shall be demolished in accordance with the approved plan.
D15	DEMOLITION			1. All existing structures to be demolished shall be demolished in accordance with the approved plan.

PHASE II

1. TEMPORARY SEED THROUGHOUT CONSTRUCTION BARRIERS AREAS SHALL BE MAINTAINED FOR 14 DAYS OF WORK.
2. METALS, NITRATES, NITROGENOUS, STORM SEWER, CLAYS AND SILTS SHALL BE REMOVED.
3. METALS REPAIR AREAS AROUND STRUCTURES AS EACH OUPLET LOCATED AS REQUIRED.
4. METALS MUST PROTECT ALL AT ALL STORM SEWER STRUCTURES AS EACH MUST BE PROTECTED BY METALS AS THEY ARE SUBJECT TO FRESH GRADES.
5. METALS APPROPRIATE MUST PROTECT DEVICES FOR PAVED AREAS AS WELL AS UNPAVED AREAS.
6. COMPLETE GRADES AND INSTALLATION OF PERMANENT CONTROL MEASURES SHALL BE COMPLETED BY THE END OF THE CONSTRUCTION PERIOD.
7. MAINTAIN ALL REMAINING TEMPORARY EROSION AND SEDIMENT CONTROL DEVICES.
8. STABILIZE ANY AREAS DISTURBED BY THE REMOVAL OF CONTROL MEASURES.
9. COMPLETE GRADES AND INSTALLATION OF PERMANENT CONTROL MEASURES SHALL BE COMPLETED BY THE END OF THE CONSTRUCTION PERIOD.
10. COMPLETE GRADES AND INSTALLATION OF PERMANENT CONTROL MEASURES SHALL BE COMPLETED BY THE END OF THE CONSTRUCTION PERIOD.
11. COMPLETE GRADES AND INSTALLATION OF PERMANENT CONTROL MEASURES SHALL BE COMPLETED BY THE END OF THE CONSTRUCTION PERIOD.
12. COMPLETE GRADES AND INSTALLATION OF PERMANENT CONTROL MEASURES SHALL BE COMPLETED BY THE END OF THE CONSTRUCTION PERIOD.
13. COMPLETE GRADES AND INSTALLATION OF PERMANENT CONTROL MEASURES SHALL BE COMPLETED BY THE END OF THE CONSTRUCTION PERIOD.
14. COMPLETE GRADES AND INSTALLATION OF PERMANENT CONTROL MEASURES SHALL BE COMPLETED BY THE END OF THE CONSTRUCTION PERIOD.
15. COMPLETE GRADES AND INSTALLATION OF PERMANENT CONTROL MEASURES SHALL BE COMPLETED BY THE END OF THE CONSTRUCTION PERIOD.

ACREAGE SUMMARY

AREA	ACRES
ON-SITE DISTURBED AREA	38.87
OFF-SITE DISTURBED AREA	5.13
TOTAL DISTURBED AREA	44.00
PERMANENT AREA AT COMPLETION	44.00

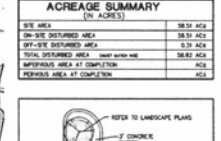

TEMPORARY SEEDING SCHEDULE

SPECIES	DURATION (FT)	RATE/ACRE	PLANTING DATES
BLUE FESCUE (DMS)	200 LBS	APRIL - SEPT 1	
PERMANENT AREA AT COMPLETION	44.00		

PERMANENT SEEDING SCHEDULE

SPECIES	DURATION (FT)	RATE/ACRE	PLANTING DATES
PERMANENT AREA AT COMPLETION	44.00		

SOD PLANTING AND FERTILIZATION REQUIREMENTS

SPECIES	FERTILIZER	RATE	APPLY DATE
FESCUE	6-12-12	50-100	500

VEGETATIVE PRACTICES

CODE	PRACTICE	DETAIL	MAP SYMBOL	DESCRIPTION
V1	VEGETATIVE PRACTICES			1. All areas to be vegetated shall be planted with native species.
V2	VEGETATIVE PRACTICES			1. All areas to be vegetated shall be planted with native species.
V3	VEGETATIVE PRACTICES			1. All areas to be vegetated shall be planted with native species.
V4	VEGETATIVE PRACTICES			1. All areas to be vegetated shall be planted with native species.
V5	VEGETATIVE PRACTICES			1. All areas to be vegetated shall be planted with native species.
V6	VEGETATIVE PRACTICES			1. All areas to be vegetated shall be planted with native species.
V7	VEGETATIVE PRACTICES			1. All areas to be vegetated shall be planted with native species.
V8	VEGETATIVE PRACTICES			1. All areas to be vegetated shall be planted with native species.
V9	VEGETATIVE PRACTICES			1. All areas to be vegetated shall be planted with native species.
V10	VEGETATIVE PRACTICES			1. All areas to be vegetated shall be planted with native species.

EROSION CONTROL LEGEND

- PROPERTY LINE
- LIMITS OF DISTURBANCE
- GRADE BENCH
- CONTOUR ELEVATIONS
- STORM DRAIN
- PERCENT OF SLOPING
- TYPE OF GRADE
- PERCENT BOUNDARY
- SILT FENCE
- SWEEP INFORMATION SIGN
- STORM ACTUAL WEATHER
- SEEDED AREA

SOL SERIES LEGEND

SYMBOL	DESCRIPTION
---	NEAR LEVEL TO 4 PERCENT SLOPES
---	PERCENT SLOPES
---	PERCENT SLOPES
---	PERCENT SLOPES
---	PERCENT SLOPES
---	PERCENT SLOPES
---	PERCENT SLOPES
---	PERCENT SLOPES
---	PERCENT SLOPES
---	PERCENT SLOPES

OFF-SITE RUN-ON ACREAGE SUMMARY

OFF-SITE DRAINAGE AREA	ACREAGE	AVERAGE SLOPE	MAXIMUM SLOPE	COVER TYPE
AREA 1	48.77	9.5	33.6	Woods

MULCHING SCHEDULE

MULCHING MATERIAL	RATE/TON
STRIP OR MAT	2.5 TONS
WOOD WASTE, GRASS, HAY, OR SOIL	5 TO 8 TONS

OFF-SITE MATERIAL AREAS INFORMATION

BURNER SITE NAME	OFFICIAL SITE NAME
BURNER SITE ADDRESS <td>OFFICIAL SITE ADDRESS </td>	OFFICIAL SITE ADDRESS
BURNER SITE PERMIT NUMBER <td>OFFICIAL SITE PERMIT NUMBER </td>	OFFICIAL SITE PERMIT NUMBER
BURNER SITE POINT NO. <td>OFFICIAL SITE POINT NO. </td>	OFFICIAL SITE POINT NO.
BURNER SITE PERMITTING AGENCY <td>OFFICIAL SITE PERMITTING AGENCY </td>	OFFICIAL SITE PERMITTING AGENCY

24 HR LOCAL EMERGENCY CONTACT

ROBERT GREEN (24-HR) 314-429-0900
 THF, STONERIDGE DEVELOPMENT LLC
 314-429-0900

DEVELOPER/OWNER: THF, STONERIDGE DEVELOPMENT LLC
PHASE II - SITE MAP
EROSION, SEDIMENTATION & POLLUTION CONTROL PLAN

DATE: 12/08/2010
SCALE: 1" = 80'
JOB NO.: 08-1488
SHEET NUMBER: ES-2A

Wolverton & Associates
 Consulting Engineers & Land Surveyors
 1000 N. Grand Blvd., Suite 100, St. Louis, MO 63103
 www.wolvertonassoc.com

NOT FOR CONSTRUCTION / PERMIT REVIEW ONLY

PROPOSED BLACK HILLS CENTER
Walmart # 3872-03
RAPID CITY, PENNINGTON COUNTY, S.D.
BY: THF, STONERIDGE DEVELOPMENT, LLC
ST. LOUIS, MO

REVISIONS BY:

NO.	DATE	DESCRIPTION	BY

ES-2A

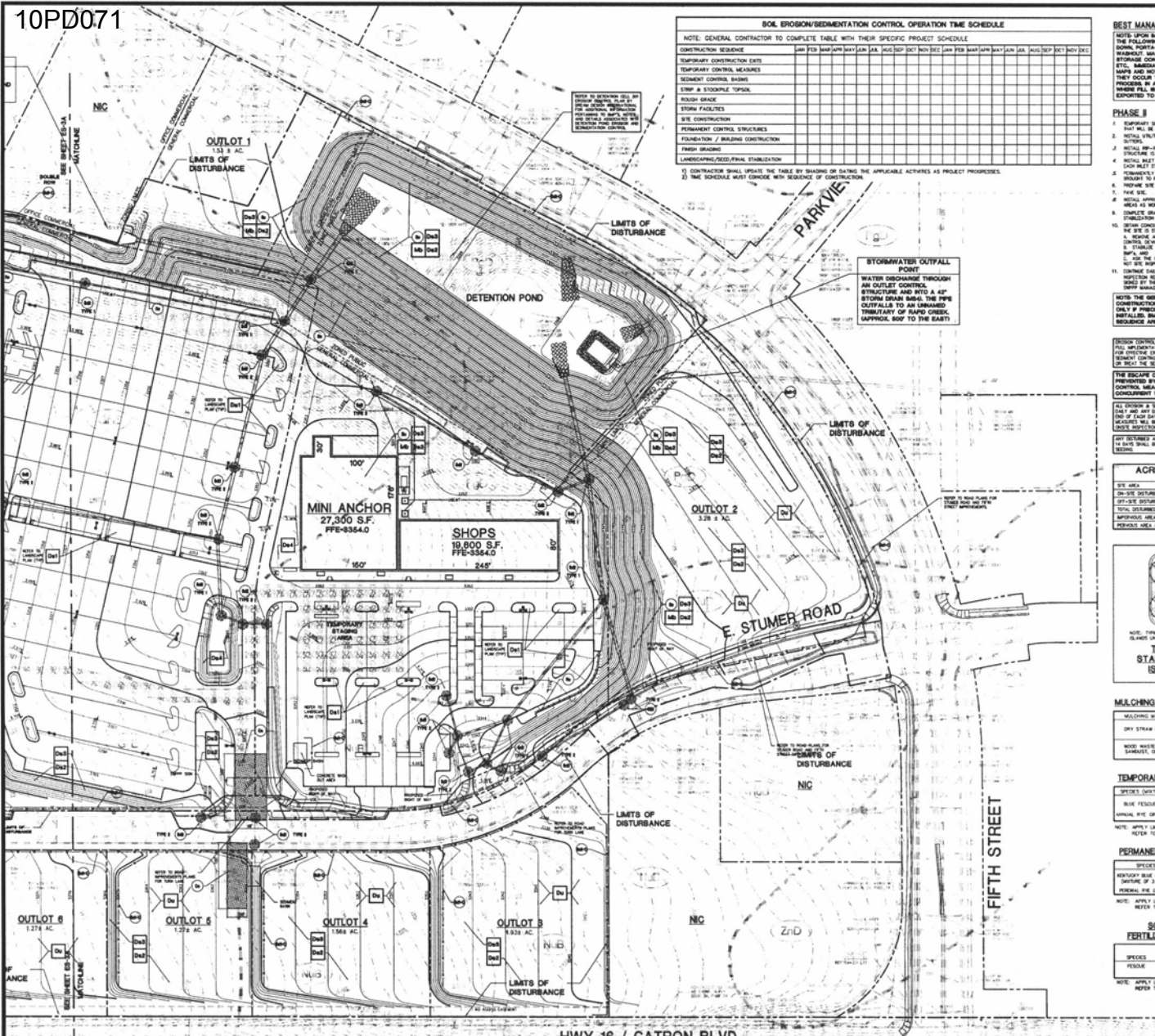

SOIL EROSION/SEDIMENTATION CONTROL OPERATION TIME SCHEDULE

NOTE: GENERAL CONTRACTOR TO COMPLETE TABLE WITH THEIR SPECIFIC PROJECT SCHEDULE

CONSTRUCTION SEQUENCE	JAN	FEB	MAR	APR	MAY	JUN	JUL	AUG	SEP	OCT	NOV	DEC
TEMPORARY CONSTRUCTION DITCHES												
TEMPORARY CONTROL MEASURES												
SEDIMENT CONTROL BASINS												
STORM & STORMFLOW TRENCHES												
ROUNDER GRASS												
STORM FACILITIES												
SITE CONSTRUCTION												
PERMANENT CONTROL STRUCTURES												
FOUNDATION / BUILDING CONSTRUCTION												
FINISH GRADING												
LANDSCAPING/VEGETAL STABILIZATION												

1) CONTRACTOR SHALL UPDATE THE TABLE BY SHADING OR DATING THE APPLICABLE ACTIVITIES AS PROJECT PROGRESSES.
2) THE SCHEDULE MUST CONFORM WITH SEQUENCE OF CONSTRUCTION.

BEST MANAGEMENT PRACTICES SEQUENCE

1. SITE SPECIFIC EROSION CONTROL MEASURES SHALL BE INSTALLED PRIOR TO THE FOLLOWING AREAS: TRAILER, PARKING LAY DOWN, PORTA-POTTIES, WASH TRUCK, WASH AREA, WASHOUT WAREHOUSE AREA, FUEL AND MATERIAL STORAGE CONTAINERS, WASH AREA, WASTE CONTAINERS, ETC. IMMEDIATELY DISPOSE THEM ON THE WASTE MOUNTAIN AND NOTIFY ANY CHANGES IN LOCATION AS THEY OCCUR THROUGHOUT THE CONSTRUCTION PROCESS. IN ADDITION, NOTIFY ANY OFF-SITE AREA BEING FILLED IS SUPPORTED FROM ON-SITE SOIL IS EXPORTED TO THE WASTE MOUNTAIN.

- PHASE I**
- TEMPORARY SEED THROUGHOUT CONSTRUCTION, BARRIERS AREAS THAT WILL BE MAINTAINED FOR 14 DAYS OR MORE.
 - INSTALL PERMANENT UNDERDRAIN, STORM SEWER, CURBS AND GUTTERS.
 - INSTALL 18" x 18" AROUND OUTLET STRUCTURES AS EACH OUTLET.
 - INSTALL SLOTTED PROTECTION AT ALL STORM SEWER STRUCTURES AS EACH ACCESS POINT TO PREVENT EROSION.
 - TEMPORARILY STABILIZE AREAS THAT ARE VULNERABLE AS THEY ARE MAINTAINED FOR 14 DAYS.
 - REMOVE SEED FOR PLANTING.
 - PAVE SITE.
 - INSTALL APPROPRIATE BUILT PERMANENT DEVICES FOR PAVED AREAS TO PREVENT EROSION.
 - COMPLETE GRADING AND INSTALLATION OF PERMANENT CONSTRUCTION RELATED ACTIVITIES CONCURRENTLY.
 - GENERAL CONFORMANCE WITH THE CONSTRUCTION MANAGER THAT:
 - REMOVE ALL REMAINING TEMPORARY EROSION AND SEDIMENT CONTROL DEVICES.
 - STABILIZE ANY AREAS OBTAINED BY THE REMOVAL OF BMPs.
 - FOR THE JOB TO CONTACT THE DEC TO COMPLETE THE DEC SITE INSPECTION AND REPORT.
 - COMPLETE DAILY INSPECTION REPORTS UNTIL THE FINAL DAILY INSPECTION REPORT. REPORTS SHALL BE SUBMITTED TO THE DEC BY THE END OF EACH DAY. REPORTS SHALL BE MAINTAINED AS A PERMANENT RECORD AND BE AVAILABLE TO THE DEC UPON REQUEST.
- NOTE: THE GENERAL CONTRACTOR MAY COMPLETE CONSTRUCTION RELATED ACTIVITIES CONCURRENTLY WITH THE INSTALLATION OF PERMANENT EROSION AND SEDIMENT CONTROL MEASURES. THE GENERAL CONTRACTOR SHALL BE RESPONSIBLE FOR THE SEQUENCE OF CONSTRUCTION AND THE SEQUENCE OF CONSTRUCTION SHALL BE MAINTAINED AS A PERMANENT RECORD.



LOCATION MAP

THE SITE IS LOCATED IN THE SW 1/4 OF THE NE 1/4 OR NE 1/4 OF THE SW 1/4 OF THE NE 1/4 OF THE SW 1/4 OF SECTION 16, T14N, R10E, S14W, MAP OF CITY, PENNINGTON COUNTY, SOUTH DAKOTA.

STRUCTURAL PRACTICES

CODE	PRACTICE	DETAIL	MAP SYMBOL	DESCRIPTION
Ca	CHECK DAM			Check dam to be installed in all areas where erosion control is required. Check dam shall be constructed of concrete or stone and shall be installed in accordance with the details shown on this plan.
Cb	CONSTRUCTION			Construction shall be completed in accordance with the details shown on this plan.
Cc	CONCRETE FOUNDATION			Concrete foundation shall be installed in accordance with the details shown on this plan.
D	DISSECTION			Dissection shall be installed in all areas where erosion control is required. Dissection shall be constructed of concrete or stone and shall be installed in accordance with the details shown on this plan.
Dd1	DISSECTION			Dissection shall be installed in all areas where erosion control is required. Dissection shall be constructed of concrete or stone and shall be installed in accordance with the details shown on this plan.
F	FILTER FABRIC			Filter fabric shall be installed in all areas where erosion control is required. Filter fabric shall be installed in accordance with the details shown on this plan.
N	RETAINING WALL			Retaining wall shall be installed in all areas where erosion control is required. Retaining wall shall be constructed of concrete or stone and shall be installed in accordance with the details shown on this plan.
Nd	ROCK FILTER WALL			Rock filter wall shall be installed in all areas where erosion control is required. Rock filter wall shall be constructed of rock and shall be installed in accordance with the details shown on this plan.
R	ROCKING			Rocking shall be installed in all areas where erosion control is required. Rocking shall be constructed of rock and shall be installed in accordance with the details shown on this plan.
Rd1	SEDIMENT BARRIERS			Sediment barriers shall be installed in all areas where erosion control is required. Sediment barriers shall be constructed of concrete or stone and shall be installed in accordance with the details shown on this plan.
Sd	STORM SEWER			Storm sewer shall be installed in all areas where erosion control is required. Storm sewer shall be constructed of concrete or stone and shall be installed in accordance with the details shown on this plan.
Sd1	STORM SEWER			Storm sewer shall be installed in all areas where erosion control is required. Storm sewer shall be constructed of concrete or stone and shall be installed in accordance with the details shown on this plan.
S	STORM DRAIN PROTECTION			Storm drain protection shall be installed in all areas where erosion control is required. Storm drain protection shall be constructed of concrete or stone and shall be installed in accordance with the details shown on this plan.
Sd1	STORM DRAIN PROTECTION			Storm drain protection shall be installed in all areas where erosion control is required. Storm drain protection shall be constructed of concrete or stone and shall be installed in accordance with the details shown on this plan.

CONSTRUCTION RELATED ACTIVITIES SHALL BE MAINTAINED AS A PERMANENT RECORD AND BE AVAILABLE TO THE DEC UPON REQUEST.

THE SEQUENCE OF CONSTRUCTION FROM THE SITE SHALL BE MAINTAINED AS A PERMANENT RECORD AND BE AVAILABLE TO THE DEC UPON REQUEST.

ALL EROSION & SEDIMENT CONTROL MEASURES SHALL BE CHECKED DAILY AND REPORTS SHALL BE SUBMITTED TO THE DEC BY THE END OF EACH DAY. REPORTS SHALL BE MAINTAINED AS A PERMANENT RECORD AND BE AVAILABLE TO THE DEC UPON REQUEST.

CONSTRUCTION RELATED ACTIVITIES SHALL BE MAINTAINED AS A PERMANENT RECORD AND BE AVAILABLE TO THE DEC UPON REQUEST.

ACREAGE SUMMARY

ITEM	ACRES
SITE AREA	58.31
ON-SITE DISTURBED AREA	28.31
OFF-SITE DISTURBED AREA	0.34
TOTAL DISTURBED AREA	28.65
UNDISTURBED AREA AT COMPLETION	29.66
NET LOSS OF SOIL	0.00

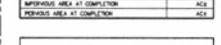

REFER TO LINESHAFT PLANS FOR CONCRETE SUPPORT.

NOTE: PERMANENT STABILIZATION FOR ALL CULVERT ISLANDS UNLESS NOTED OTHERWISE ON THE PLANS.

TYPICAL PERMANENT STABILIZATION FOR RAISED ISLANDS INSET DETAIL.

MULCHING SCHEDULE

MULCHING MATERIAL	RATE/ACRE
DRY STRAW OR HAY	2.0 TONS
WOOD CHIPS, CHIPPED SAWDUST, OR BARK	6 TO 8 TONS

TEMPORARY SEEDING SCHEDULE

SEEDS (LBS/AC)	RATE/ACRE	PLANTING DATES
BLUE FESCUE (TONE)	200 LBS	APRIL - SEPT 1
ORNAMENTAL GRASS (TONE)	200 LBS	APRIL - SEPT 1

NOTE: APPLY LIME AT THE RATE OF 1 TON/ACRE REFER TO ES-4 FOR FERTILIZER REQUIREMENTS.

PERMANENT SEEDING SCHEDULE

SEEDS	RATE/ACRE	PLANTING DATES
HEAVYTOP BLUE GRASS (TONE)	175 LBS	SEPT 1 - DEC 31
ORNAMENTAL GRASS (TONE)	175 LBS	SEPT 1 - DEC 31

NOTE: APPLY LIME AT THE RATE OF 1 TON/ACRE REFER TO ES-4 FOR FERTILIZER REQUIREMENTS.

SOIL PLANTING AND FERTILIZATION REQUIREMENTS

SEEDS	FERTILIZER	RATE	APPLY DATE
FESCUE	8-12-12	50-100	900

NOTE: APPLY LIME AT THE RATE OF 1 TON/ACRE REFER TO ES-4 FOR FERTILIZER REQUIREMENTS.

EROSION CONTROL LEGEND



SOIL SERIES LEGEND



NOTE: SEE SURVEY FOR EXISTING EROSION CONTROL.

REFER TO PLAN SHEET ES-4 FOR GENERAL NOTES, MAINTENANCE NOTES, SITE DATA & QUAD MAP.

NOT FOR CONSTRUCTION / PERMIT REVIEW ONLY

PROPOSED BLACK HILLS CENTER
Wal-Mart # 3872-03
RAPID CITY, PENNINGTON COUNTY, S.D.
BY: THF, STONERIDGE DEVELOPMENT, LLC
ST. LOUIS, MO

REVISIONS BY

NO.	DATE	BY

DRAWN BY DMN/CRP

CHECKED BY K/JW

DATE: 12/09/2010

SCALE: 1" = 80'

JOB NO: 08-140

DESIGN NUMBER

ES-2B

OF SHEETS

PHASE II - SITE MAP
EROSION, SEDIMENTATION
& POLLUTION CONTROL PLAN

GRAPHIC SCALE

1" = 80'

1" = 80'

1" = 80'

1" = 80'

1" = 80'

OFF-SITE RUN-ON ACREAGE SUMMARY

OFF-SITE DRAINAGE AREA ACREAGE	AVERAGE SLOPE	MAXIMUM SLOPE	COVER TYPE
AREA 1	4% N	8%	33% GRASS

NOTE: OFF-SITE RUN-ON AREAS FOR EACH PERMITTED AREA WITHIN RUN-ON SHALL BE PRELIMINARY. TIME OF SURFACE COVER IS BASED ON 15% PERCENT COVER.



Know what's below
Call before you dig
(800)781-7474 Outside SD

OFF-SITE MATERIAL AREAS INFORMATION

BORROW SITE NAME	DISPERSAL SITE NAME
BORROW SITE ADDRESS <td>DISPERSAL SITE ADDRESS </td>	DISPERSAL SITE ADDRESS
BORROW SITE POINT NUMBER <td>DISPERSAL SITE POINT NUMBER </td>	DISPERSAL SITE POINT NUMBER
BORROW SITE POINT NO. <td>DISPERSAL SITE POINT NO. </td>	DISPERSAL SITE POINT NO.
BORROW SITE PERMITTING AGENCY <td>DISPERSAL SITE PERMITTING AGENCY </td>	DISPERSAL SITE PERMITTING AGENCY

24 HR LOCAL EMERGENCY CONTACT

PERSON	PHONE NUMBER
ROBERT GREEN	(260)498-9000
THE STONERIDGE DEVELOPMENT LLC	

DEVELOPER/OWNER:
THF STONERIDGE DEVELOPMENT LLC
INNERBELT BUSINESS CENTER DR
SUITE 200 ST. LOUIS MO 63114
314-428-0900

CONTRACTOR'S NAME: PHONE NUMBER:
NOTE: CONTRACTOR TO PROVIDE UPDATED INFORMATION ONCE CONTRACT IS AWARDED.

SITE OPERATOR/GENERAL CONTRACTOR:
SUPERINTENDENT:

Wolvertson & Associates
Consulting Engineers & Land Surveyors
1000 N. GARDNER STREET
ST. LOUIS, MISSOURI 63102
www.wolvertson-associates.com

Professional Engineer
STATE OF SOUTH DAKOTA
No. 10000
JAMES W. WOLVERTSON

NOT FOR CONSTRUCTION / PERMIT REVIEW ONLY

PROPOSED BLACK HILLS CENTER
Wal-Mart # 3872-03
RAPID CITY, PENNINGTON COUNTY, S.D.
BY: THF, STONERIDGE DEVELOPMENT, LLC
ST. LOUIS, MO

REVISIONS BY

NO.	DATE	BY

DRAWN BY DMN/CRP

CHECKED BY K/JW

DATE: 12/09/2010

SCALE: 1" = 80'

JOB NO: 08-140

DESIGN NUMBER

ES-2B

OF SHEETS

