

BID AWARD SUMMARY

LETTING DATE: September 14, 2010

PROJECT: Northridge Water Storage Reservoir
Project No. W09-1792 / CIP No. 50754

RECOMMENDATION: Award Total Bid Schedule A and Bid Schedule B in the amount of \$2,223,000.00 to CB&I, Inc. at the September 20, 2010 Council Meeting.

BIDDERS' SUMMARY

<u>Bidder</u>	<u>Bid Schedule A</u>	<u>Bid Schedule B</u>	<u>Bid Schedule B Alternate</u>
CB&I, Inc.	\$1,954,050.00	\$268,950.00	\$224,400.00
Caldwell Tanks, Inc.	\$1,916,000.00	\$511,800.00	\$367,200.00
Maguire Iron, Inc.	\$1,998,000.00	\$324,252.00	\$210,936.00

City staff recommends awarding this project to CB&I, Inc. for a total bid amount of \$2,223,000.00 based on unit pricing with the following appropriation:

FUNDING SOURCE	TOTAL	Non-City Funds	Water Expansion
ADVERTISING AUTHORITY	\$2,125,000.00	\$675,000.00	\$1,450,000.00
ENGINEER'S ESTIMATE	\$2,593,000.00	\$675,000.00	\$1,918,000.00

APPROPRIATION DATA:

FUNDING SOURCE	TOTAL	Non-City Funds	Water Expansion
COST CENTER		TID 54	0934
LINE ITEM		Developer Funding	4381
FUNDING CENTER			0602
BID AMOUNT	\$2,223,000.00	\$675,000.00	\$1,548,000.00

CONSULTANT:

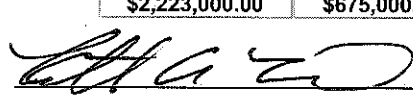

Keith Winter, PE
Banner Associates, Inc.

DATE:

9/15/2010

PROJECT MANAGER:

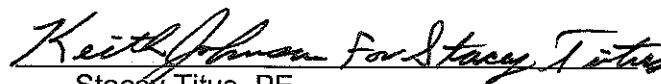

Stacey Titus, PE
City of Rapid City

DATE:

9/15/10

BID TABULATION
NORTHRIDGE WATER STORAGE RESERVOIR
PROJECT NO. W09-1792 / CIP NO. 50754
BID LETTING DATE: SEPTEMBER 14, 2010

ITEM NO.	DESCRIPTION OF ITEM	UNIT	QTY (EST)	ENGINEER'S ESTIMATE		CB&I, INC.		CALDWELL TANKS, INC.		MAGUIRE IRON, INC.	
				UNIT COST	TOTAL COST	UNIT COST	TOTAL COST	UNIT COST	TOTAL COST	UNIT COST	TOTAL COST
Bid Schedule A											
1	Mobilization	LS	1.0	\$55,000.00	\$55,000.00	\$100,000.00	\$100,000.00	\$20,000.00	\$20,000.00	\$20,000.00	\$20,000.00
2	Construction Staking (by Contractor)	LS	1.0	\$6,500.00	\$6,500.00	\$5,000.00	\$5,000.00	\$1,000.00	\$1,000.00	\$1,000.00	\$1,000.00
3	Clearing & Grubbing	LS	1.0	\$3,444.44	\$3,444.44	\$6,050.00	\$6,050.00	\$5,000.00	\$5,000.00	\$5,000.00	\$5,000.00
4	Clearing & Grubbing (Trees 10" and Larger)	EA	30.0	\$365.00	\$10,950.00	\$193.00	\$5,790.00	\$300.00	\$9,000.00	\$300.00	\$9,000.00
5	4" Perforated Drain Pipe	LF	275.0	\$8.40	\$2,310.00	\$7.00	\$1,925.00	\$12.00	\$3,300.00	\$10.00	\$2,750.00
6	16" PVC Water Main C-905, DR 25, CERTA LOK	LF	220.0	\$80.00	\$17,600.00	\$102.00	\$22,440.00	\$125.00	\$27,500.00	\$130.00	\$28,600.00
7	16" x 12" Reducer	EA	1.0	\$1,300.00	\$1,300.00	\$842.00	\$842.00	\$1,000.00	\$1,000.00	\$1,000.00	\$1,000.00
8	6" PVC RJ Watermain	LF	105.0	\$47.00	\$4,935.00	\$34.00	\$3,570.00	\$50.00	\$5,250.00	\$50.00	\$5,250.00
9	12" PVC Water Main C-900, Class 200, CERTA LOK	LF	60.0	\$50.00	\$3,000.00	\$55.00	\$3,300.00	\$105.00	\$6,300.00	\$100.00	\$6,000.00
10	16" x 16" x 6" Tee	EA	1.0	\$1,450.00	\$1,450.00	\$1,260.00	\$1,260.00	\$1,400.00	\$1,400.00	\$1,500.00	\$1,500.00
11	16" 11.25 Degree Bend	EA	3.0	\$1,154.00	\$3,462.00	\$1,018.00	\$3,054.00	\$1,200.00	\$3,600.00	\$1,100.00	\$3,300.00
12	6" 45 Degree Bend	EA	2.0	\$1,350.00	\$2,700.00	\$425.00	\$850.00	\$250.00	\$500.00	\$300.00	\$600.00
13	16" 22.5 Degree Bend	EA	2.0	\$325.00	\$650.00	\$2,090.00	\$4,180.00	\$750.00	\$1,500.00	\$800.00	\$1,600.00
14	16" MJ Plug	EA	2.0	\$640.00	\$1,280.00	\$1,045.00	\$2,090.00	\$600.00	\$1,200.00	\$700.00	\$1,400.00
15	Connect to Existing Watermain (not in service)	LS	1.0	\$1,600.00	\$1,600.00	\$2,486.00	\$2,486.00	\$4,000.00	\$4,000.00	\$4,000.00	\$4,000.00
16	12" Gate Valve	EA	1.0	\$2,600.00	\$2,600.00	\$3,740.00	\$3,740.00	\$3,000.00	\$3,000.00	\$3,000.00	\$3,000.00

17	16" Gate Valve	EA	3.0	\$6,800.00	\$20,400.00	\$9,900.00	\$29,700.00	\$8,000.00	\$24,000.00	\$8,000.00	\$24,000.00
18	Rock Excavation	CY	190.0	\$56.00	\$10,640.00	\$55.00	\$10,450.00	\$100.00	\$19,000.00	\$100.00	\$19,000.00
19	Contractor Supplied Density Tests	EA	10.0	\$212.00	\$2,120.00	\$198.00	\$1,980.00	\$100.00	\$1,000.00	\$100.00	\$1,000.00
20	Excavation (Unclassified)	CY	850.0	\$7.00	\$5,950.00	\$4.20	\$3,570.00	\$10.00	\$8,500.00	\$10.00	\$8,500.00
21	Embankment Fill	CY	775.0	\$20.00	\$15,500.00	\$3.00	\$2,325.00	\$20.00	\$15,500.00	\$18.00	\$13,950.00
22	Topsoil, Stockpile or Import/Replace	CY	500.0	\$14.00	\$7,000.00	\$8.00	\$4,000.00	\$30.00	\$15,000.00	\$30.00	\$15,000.00
23	3/4" Aggregate Base Course	T	275.0	\$22.00	\$6,050.00	\$23.00	\$6,325.00	\$35.00	\$9,625.00	\$35.00	\$9,625.00
24	Asphalt Compaction Tests	EA	3.0	\$31.00	\$93.00	\$220.00	\$660.00	\$100.00	\$300.00	\$1,000.00	\$3,000.00
25	AC, Class G, Type 1 Pg 64-28	T	70.0	\$107.00	\$7,490.00	\$154.00	\$10,780.00	\$10.00	\$700.00	\$100.00	\$7,000.00
26	Bituminous Tack Coat	GAL	25.0	\$8.00	\$200.00	\$6.00	\$150.00	\$20.00	\$500.00	\$200.00	\$5,000.00
27	Concrete Curb & Gutter Type B66	LF	410.0	\$18.00	\$7,380.00	\$33.00	\$13,530.00	\$20.00	\$8,200.00	\$15.00	\$6,150.00
28	Concrete Test Set	EA	3.0	\$222.00	\$666.00	\$198.00	\$594.00	\$50.00	\$150.00	\$1,000.00	\$3,000.00
29	PCC Pavement, 6" Reinforced	SY	175.0	\$74.46	\$13,030.50	\$193.00	\$33,775.00	\$10.00	\$1,750.00	\$5.00	\$875.00
30	18" RCP Class III	LF	80.0	\$48.00	\$3,840.00	\$49.00	\$3,920.00	\$60.00	\$4,800.00	\$60.00	\$4,800.00
31	18" RCP FES	EA	3.0	\$900.00	\$2,700.00	\$1,100.00	\$3,300.00	\$1,000.00	\$3,000.00	\$1,200.00	\$3,600.00
32	Class II Riprap with Bedding	CY	50.0	\$44.00	\$2,200.00	\$43.00	\$2,150.00	\$75.00	\$3,750.00	\$80.00	\$4,000.00
33	12" EC Wattles	LF	50.0	\$6.30	\$315.00	\$11.00	\$550.00	\$10.00	\$500.00	\$50.00	\$2,500.00
34	Erosion Control Blanket	SY	235.0	\$4.06	\$954.10	\$10.00	\$2,350.00	\$10.00	\$2,350.00	\$5.00	\$1,175.00
35	Erosion Control, Perimeter Control	LF	500.0	\$6.00	\$3,000.00	\$8.80	\$4,400.00	\$5.00	\$2,500.00	\$2.00	\$1,000.00
36	Repair Silt Fence	LF	500.0	\$5.00	\$2,500.00	\$2.20	\$1,100.00	\$5.00	\$2,500.00	\$1.00	\$500.00
37	Cathodic Control Anode, 18 lb - Zinc	EA	15.0	\$279.39	\$4,190.85	\$270.60	\$4,059.00	\$200.00	\$3,000.00	\$200.00	\$3,000.00
38	Remove Silt Fence	LF	500.0	\$3.00	\$1,500.00	\$2.20	\$1,100.00	\$5.00	\$2,500.00	\$1.00	\$500.00
39	Concrete Washout Area	EA	1.0	\$500.00	\$500.00	\$550.00	\$550.00	\$500.00	\$500.00	\$1,000.00	\$1,000.00
40	8' Colored Chain Link Fence	LF	665.0	\$45.00	\$29,925.00	\$42.00	\$27,930.00	\$20.00	\$13,300.00	\$37.00	\$24,605.00

41	Gate and Motorized Operator	LS	1.0	\$5,000.00	\$5,000.00	\$10,500.00	\$10,500.00	\$1,000.00	\$1,000.00	\$12,000.00	\$12,000.00
42	Seeding/Fertilizing/Mulching	SY	7,260.0	\$2.50	\$18,150.00	\$1.00	\$7,260.00	\$5.00	\$36,300.00	\$1.00	\$7,260.00
43	Irrigation System Temporary	LS	1.0	\$5,000.00	\$5,000.00	\$1,650.00	\$1,650.00	\$5,000.00	\$5,000.00	\$1,000.00	\$1,000.00
44	Landscaping	LS	1.0	\$24,000.00	\$24,000.00	\$14,600.00	\$14,600.00	\$13,000.00	\$13,000.00	\$18,000.00	\$18,000.00
45	Reinforced Concrete Sidewalk (4") (4000 psi)	SY	32.0	\$6.00	\$192.00	\$6.00	\$192.00	\$10.00	\$320.00	\$5.00	\$160.00
46	Storm Box	EA	1.0	\$4,500.00	\$4,500.00	\$4,675.00	\$4,675.00	\$4,500.00	\$4,500.00	\$5,000.00	\$5,000.00
47	Fire Hydrant and Lead	EA	1.0	\$3,700.00	\$3,700.00	\$5,830.00	\$5,830.00	\$6,000.00	\$6,000.00	\$6,000.00	\$6,000.00
48	Frost Free Yard Hydrant	EA	1.0	\$3,000.00	\$3,000.00	\$3,520.00	\$3,520.00	\$2,000.00	\$2,000.00	\$3,000.00	\$3,000.00
49	750,000 Gallon Steel Spheroid Water Tower**	LS	1.0	\$1,315,000.00	\$1,315,000.00	\$1,115,654.00	\$1,115,654.00	\$1,302,905.00	\$1,302,905.00	\$1,329,300.00	\$1,329,300.00
50	Painting and Coatings	LS	1.0	\$255,000.00	\$255,000.00	\$208,142.00	\$208,142.00	\$105,000.00	\$105,000.00	\$130,000.00	\$130,000.00
51	Interior Piping & Tank Mixing System	LS	1.0	\$42,500.00	\$42,500.00	\$76,102.00	\$76,102.00	\$50,000.00	\$50,000.00	\$59,000.00	\$59,000.00
52	Enclosure (Building, insulation, finishes, etc)	LS	1.0	\$12,000.00	\$12,000.00	\$22,000.00	\$22,000.00	\$10,000.00	\$10,000.00	\$10,000.00	\$10,000.00
53	Mechanical Work (Sump, Dehumidifier, drains, meter, etc.)	LS	1.0	\$15,000.00	\$15,000.00	\$9,100.00	\$9,100.00	\$2,000.00	\$2,000.00	\$1,000.00	\$1,000.00
54	Electrical Work (Service, Heater, Lights, Outlets, etc.)	LS	1.0	\$32,500.00	\$32,500.00	\$36,500.00	\$36,500.00	\$30,000.00	\$30,000.00	\$45,000.00	\$45,000.00
55	Instrumentation & Controls Allowance	LS	1.0	\$60,000.00	\$60,000.00	\$60,000.00	\$60,000.00	\$60,000.00	\$60,000.00	\$60,000.00	\$60,000.00
56	Overhead Electrical Allowance	LS	1.0	\$25,000.00	\$25,000.00	\$25,000.00	\$25,000.00	\$25,000.00	\$25,000.00	\$25,000.00	\$25,000.00
57	Facility Start-Up	LS	1.0	\$15,000.00	\$15,000.00	\$15,000.00	\$15,000.00	\$15,000.00	\$15,000.00	\$15,000.00	\$15,000.00
58	Power Line Trench (from Cul-de-sac to Tower)	LF	150.0	\$20.00	\$3,000.00	\$13.00	\$1,950.00	\$10.00	\$1,500.00	\$30.00	\$4,500.00
59	Incidental	LS	1.0	\$6,532.11	\$6,532.11	\$550.00	\$550.00	\$10,000.00	\$10,000.00	\$10,000.00	\$10,000.00
Total Bid Schedule A (Words and Figures)											
					\$2,112,000.00		\$1,954,050.00		\$1,916,000.00		\$1,998,000.00
Bid Schedule B											
60	Mobilization	LS	1.0	\$44,000.00	\$44,000.00	\$23,250.00	\$23,250.00	\$20,000.00	\$20,000.00	\$10,000.00	\$10,000.00
61	Surface Prep & Coating - Interior Wet	SF	15,200.0	\$12.00	\$182,400.00	\$8.00	\$121,600.00	\$9.50	\$144,400.00	\$9.00	\$136,800.00
62	Surface Prep & Coating - Interior Dry	SF	8,000.0	\$10.00	\$80,000.00	\$4.50	\$36,000.00	\$8.50	\$68,000.00	\$6.00	\$48,000.00

63	Surface Prep & Coating - Exterior Dry	SF	20,400.0	\$8.00	\$163,200.00	\$4.00	\$81,600.00	\$11.00	\$224,400.00	\$5.88	\$119,952.00
64	Access Tube Repairs	LS	1.0	\$2,500.00	\$2,500.00	\$500.00	\$500.00	\$50,000.00	\$50,000.00	\$2,500.00	\$2,500.00
65	Fall Prevention	LS	1.0	\$8,900.00	\$8,900.00	\$6,000.00	\$6,000.00	\$5,000.00	\$5,000.00	\$7,000.00	\$7,000.00
Total Bid Schedule B (Words and Figures)					\$481,000.00		\$268,950.00		\$511,800.00		\$324,252.00
Bid Schedule B - Bid Alternate											
66	Surface Prep (near white blast) & Coating - Exterior Dry	SF	20,400.00	\$9.50	\$193,800.00	\$11.00	\$224,400.00	\$18.00	\$367,200.00	\$10.34	\$210,936.00
TOTAL					\$2,786,800.00		\$2,447,400.00		\$2,795,000.00		\$2,533,188.00

CONSULTANT

I certify that, to the best of my knowledge, this is a true tabulation of bids received for this project.

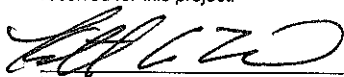
 9/15/2010
 Keith Winter, PE Date
 Banner Associates, Inc.

Contract awarded to _____ in the amount of
 \$ _____ at the _____ Council Meeting.

CITY OF RAPID CITY

Reviewed by:

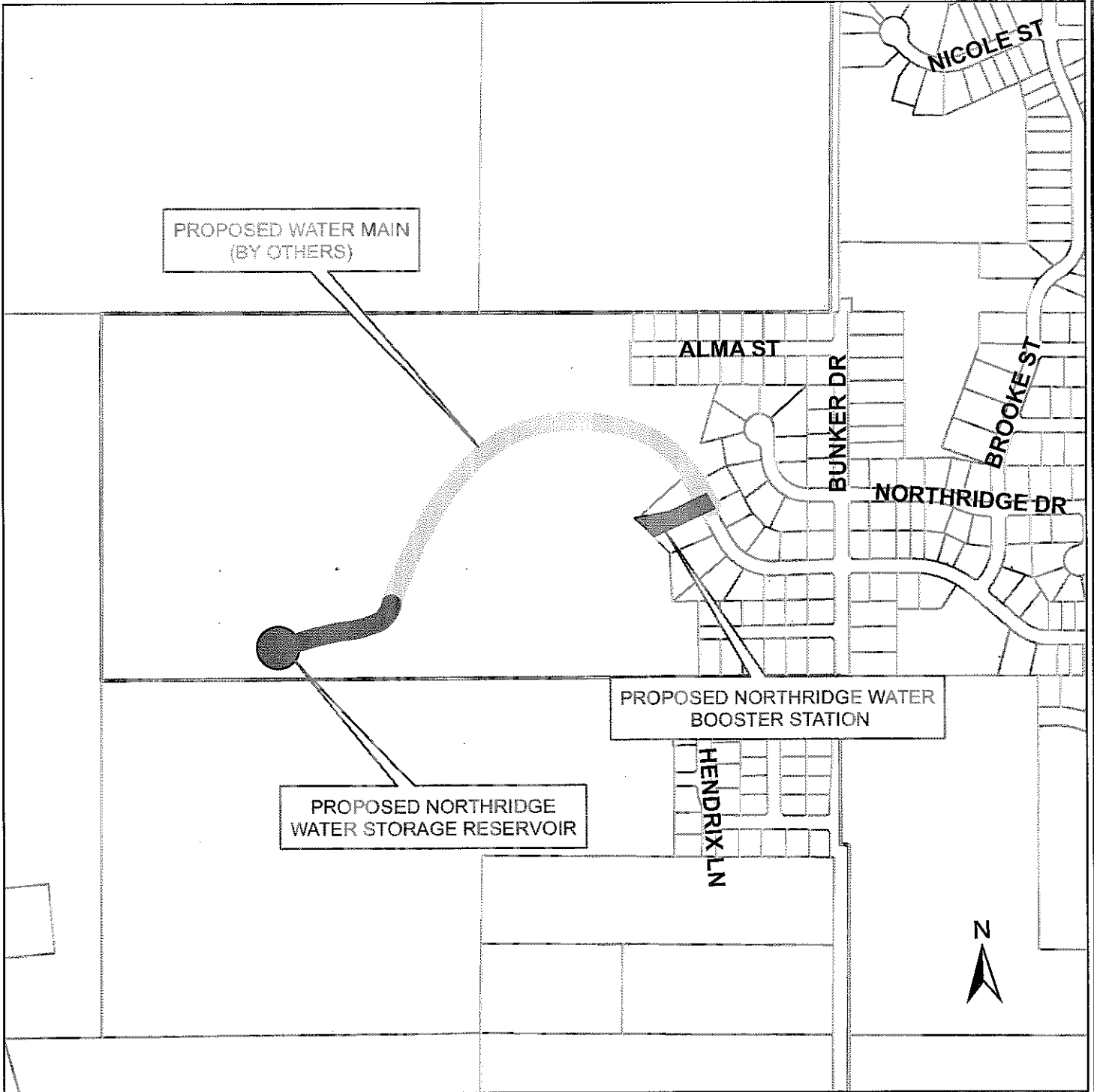
 9/19/10
 Stacey Titus, PE Date

EXHIBIT "A"



**NORTHRIDGE WATER BOOSTER STATION
PROJECT NO. W10-1898 CIP # 50834**

**NORTHRIDGE WATER STORAGE RESERVIOR
PROJECT NO. W09-1792 CIP # 50754**