

# REQUEST AUTHORIZATION FOR MAYOR AND FINANCE OFFICER TO SIGN PROFESSIONAL SERVICES AGREEMENT AMENDMENT 1 Date: 6/18/2010

**Project Name & Number:** Robbindale Reconstruction – Phase I, Maple & E. Idaho, ST09-1809      **CIP #:** 50626

**Project Description:** Construction Observation on Streets, Drainage, and Utilities Reconstruction.

**Consultant:** Sperlich Consulting, Inc.

<b>Original Contract Amount:</b> \$48,292.50	<b>Original Contract Date:</b> 9/7/2009	<b>Original Completion Date:</b> 11/25/2011
--	---	---

**Addendum No:** 1



**Amendment Description:** Additional Services provided due to Contractor working beyond the Fixed Completion Date.



<b>Current Contract Amount:</b> \$48,292.50	<b>Current Completion Date:</b> November 25, 2011
<b>Change Requested:</b> \$10,777.50	
<b>New Contract Amount:</b> \$59,070.00	<b>New Completion Date:</b> November 25, 2011

**Funding Source This Request:**

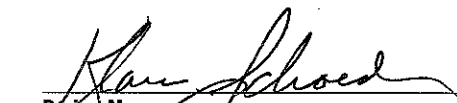
Amount	Dept.	Line Item	Fund	Comments
\$2,155.50	833	4223	604	sewer
\$2,694.37	8910	4223	505	streets
\$2,694.38	8911	4223	505	drainage
\$3,233.25	933	4223	602	water
<b>\$10,777.50</b>	<b>Total</b>			

### Agreement Review & Approvals

  
 Project Manager      6/18/10      Date  
  
 Compliance Specialist      6/22/10      Date

  
 Division Manager      6-23-10      Date  
  
 Department Director      6-23-10      Date

\_\_\_\_\_  
City Attorney      Date

\_\_\_\_\_  
Division Manager      Date

**ROUTING INSTRUCTIONS**

Route **two** originals of the Agreement for review and signatures.  
 Finance Office - Retain one original  
 Project Manager - Retain second original for delivery to Consultant  
 cc: Public Works  
 Engineering  
 Project Manager

**FINANCE OFFICE USE ONLY**

(Note to Finance: Please write date of Agreement in appropriate space in the Agreement document)

Date	Initials	Approved
Appropriation		Y    N
Cash Flow		Y    N

**AMENDMENT NO. 1 TO AGREEMENT**

**Project:** Robbinsdale Reconstruction – Phase 1  
Maple and East Idaho  
Project No. ST09-1809 / CIP No. 50626

**Background Data:** Original Contract Date: September 7, 2009  
Owner: City of Rapid City  
Engineer: Sperlich Consulting, Inc.

**Nature of Amendment:** Additional expense incurred for on-site inspector beyond the scheduled completion date for the project.

**Current Contract Amount:** \$48,292.50

**Change Requested:** \$10,777.50

**New Contract Amount:** \$59,070.00

Owner and Engineer hereby agree to modify the above referenced Agreement as set forth in this Amendment. All provisions of the Agreement not modified by this or previous Amendments remain in effect. The effective date of this Amendment is: July 6, 2010.

CITY OF RAPID CITY:

ENGINEER:

By: \_\_\_\_\_  
Mayor

By: Kale R. McElroy  
Sperlich Consulting, Inc.

Date Signed: \_\_\_\_\_

Date Signed: 6-21-10

ATTEST:

By: \_\_\_\_\_  
Finance Officer

Date Signed: \_\_\_\_\_

REVIEWED BY:

Klare Schroeder 6/18/10  
Klare Schroeder, Project Manager

PROJECT: MAPLE AVENUE AND E. IDAHO STREET RECONSTRUCTION PROJECT  
 PHASE 1 PROJECT 1  
 PROJECT NO. ST09-1809 / CIP NO. 50626  
 May 20, 2010

DAY OF WEEK	WORKING			WORKING DAY TO CONTRACTOR \$650.00	HOURS WORKED		
	MONTH	DAY	YEAR		NATE \$45.00	KALE \$85.00	JEFF \$47.50
Thursday		26					
Friday		27					
Saturday	November	28	2009				
Sunday		29					
Monday		30		1	8		
Tuesday		1		1	8		
Wednesday		2		1	8		
Thursday		3		1	8		
Friday		4		1		6	
Saturday		5					
Sunday		6					
Monday		7					
Tuesday		8					
Wednesday		9					
Thursday		10					
Friday		11		1	8		
Saturday		12					
Sunday		13					
Monday		14					
Tuesday		15		1	8		
Wednesday	December	16	2009	1	8		
Thursday		17		1	8		
Friday		18		1	8		
Saturday		19					
Sunday		20					
Monday		21		1	8		
Tuesday		22		1	8		
Wednesday		23					
Thursday		24					
Friday		25					
Saturday		26					
Sunday		27					
Monday		28		1	8		
Tuesday		29		1	8		
Wednesday		30		1	6		
Thursday		31		1	7		
Monday		22					
Tuesday		23					
Wednesday		24					
Thursday		25					
Friday	March	26	2010				
Saturday		27					
Sunday		28					
Monday		29		1		6	
Tuesday		30		1			8
Wednesday		31		1			8
Thursday		1					
Friday		2					
Saturday		3					
Sunday		4					
Monday		5					
Tuesday		6					

DAY OF WEEK	WORKING			WORKING DAY TO CONTRACTOR \$650.00	HOURS WORKED		
	MONTH	DAY	YEAR		NATE	KALE	JEFF
					\$45.00	\$85.00	\$47.50
Wednesday		7		1			9
Thursday		8		1			7
Friday		9		1		5	
Saturday		10					
Sunday		11					
Monday		12		1	9		
Tuesday		13		1			9
Wednesday	April	14	2010	1			9
Thursday		15		1			9
Friday		16		1	8		
Saturday		17					
Sunday		18					
Monday		19		1			2
Tuesday		20		1	9		
Wednesday		21		1			
Thursday		22					
Friday		23					
Saturday		24					
Sunday		25					
Monday		26		1			
Tuesday		27		1			
SUB-TOTAL				32	\$6,435.00	\$1,445.00	\$2,897.50
TOTAL					\$10,777.50		

# EXHIBIT "A"

PW062910-10

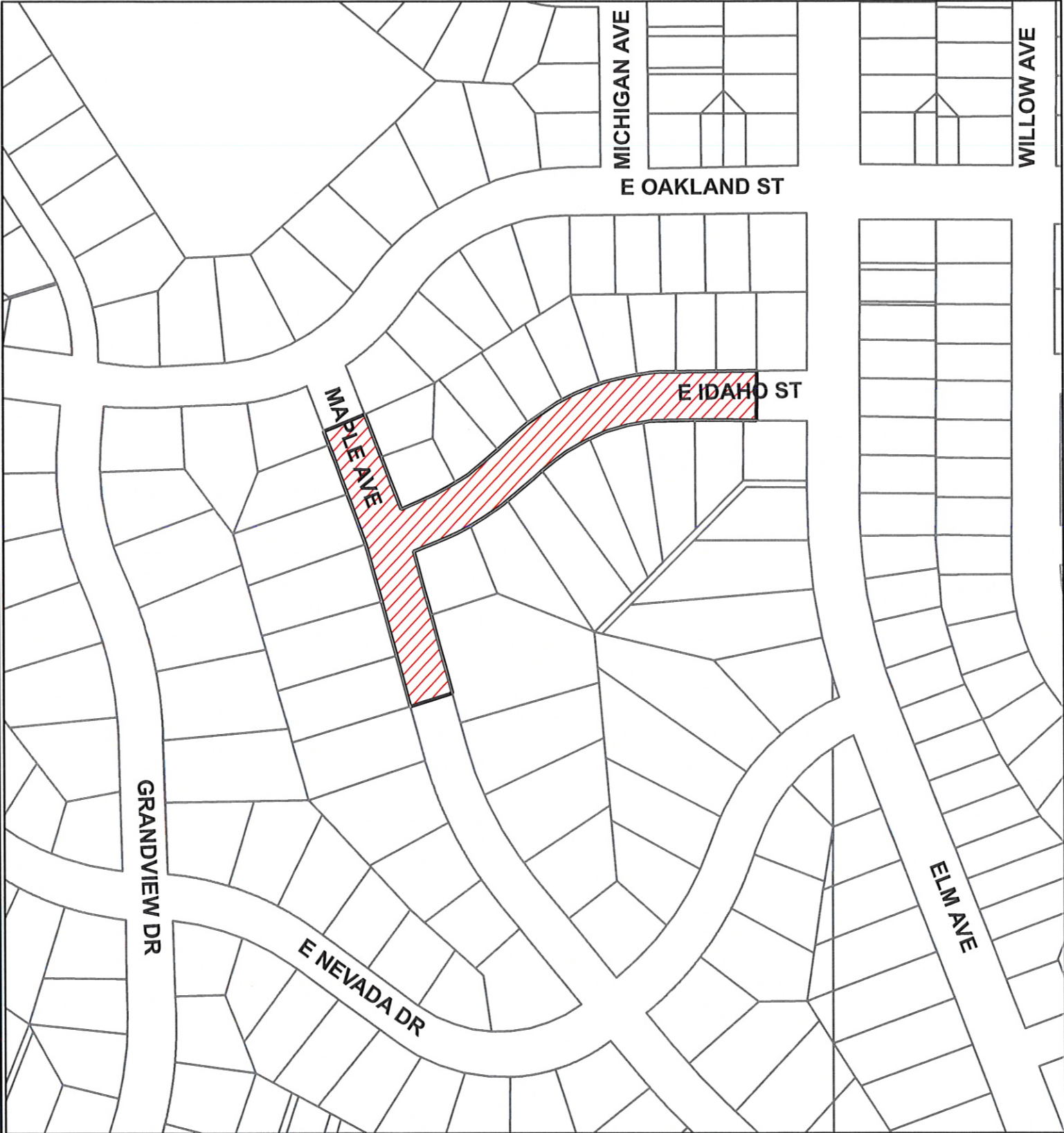

**MAPLE AVE. & E. IDAHO ST.  
RECONSTRUCTION PROJECT PH-1  
PROJECT NO. ST09-1809 CIP #50626**