

PROPOSED PRELIMINARY PLANS BLACK HILLS CENTER Walmart STORE # 3872-03 RAPID CITY, PENNINGTON COUNTY, S.D.

HWY 16 / CATRON BOULEVARD INTERSECTION FIFTH STREET



FOR REVIEW ONLY

UTILITY RESPONSIBILITY MATRIX FOR THIS PROJECT

UTILITY CONCERNING AGENCIES CONTACTS	CONTRACTOR RESPONSIBILITY-	OTHERS RESPONSIBILITY-
GAS S&S SERVICE MONTANA-SOUTH UTILITIES CO. BLACK HILLS POWER CONTACT: MR. MARK JACOBS PHONE: (605) 336-6163 FAX: (605) 336-6048 Email: Mark.Jacobs@sas.com EMERGENCY PHONE: 800-438-3274	-COORDINATE CONSTRUCTION ACTIVITIES WITH GAS COMPANY TO ENSURE INSTALLATION OF GAS LINES ARE COMPLETED PRIOR TO START OF GROUND PLACEMENT -INSTALL BOLDED PROTECTION AS SHOWN ON THE PLANS AND PER THE GAS COMPANY REQUIREMENTS	-SERVICE FROM THE POINT OF CONNECTION AT THE EXISTING LINE UP TO AND INCLUDING SETTING OF METER WILL BE DONE BY THE GAS COMPANY -PENNINGTON COUNTY UTILITIES CO. (PCU) -ANY RELOCATION OF EXISTING WILL BE DONE BY MUI
TELEPHONE AT&T WORLDWIDE COMMUNICATIONS 1800 W. 10TH ST RICHMOND, MO 64117 PHONE: (800) 451-4646 FAX: (816) 381-3100 Email: myatt@att.net Website: www.att.net	-COORDINATE CONSTRUCTION ACTIVITIES WITH TELEPHONE COMPANY TO ENSURE INSTALLATION OF TELEPHONE LINES ARE COMPLETED PRIOR TO START OF GROUND PLACEMENT -PROVIDE AND INSTALL 3/4" SCHEDULE 40 PVC CONDUITS WITH FILL PROTECTIVE POLYURETHANE AND BACKFILLING FROM THE DEEP FILL UP TO THE SURFACE -PROVIDE AND INSTALL SIGNAL WIRE AS PER TELEPHONE COMPANY REQUIREMENTS	-TELEPHONE COMPANY WILL REMOVE AND INSTALL ALL TELEPHONE CABLES FROM THE POINT OF CONNECTION UP TO AND INCLUDING SETTING OF METER AT THE PHONE COMPANY -PRESENT RESPONSIBILITY PART OF THE COMPANY
ELECTRIC ELECTRIC SERVICE BLACK HILLS POWER PLUMBER 100 RAPID CITY, SD 57704 CONTACT: MR. DON MARTINEZ PHONE: (605) 721-2888 FAX: (605) 721-2887 Email: Donmartinez@blackhillspower.com EMERGENCY PHONE: 800-721-2888 TOLL FREE CALL OR CALL 1-800-788-5474	-COORDINATE CONSTRUCTION ACTIVITIES WITH ELECTRIC COMPANY TO ENSURE INSTALLATION OF UNDERGROUND LINES ARE COMPLETED PRIOR TO START OF GROUND PLACEMENT -PROVIDE AND INSTALL 3/4" SCHEDULE 40 PVC CONDUITS WITH FILL PROTECTIVE POLYURETHANE AND BACKFILLING FROM THE DEEP FILL UP TO THE SURFACE -PROVIDE AND INSTALL SIGNAL WIRE AS PER THE ELECTRIC COMPANY REQUIREMENTS	-ELECTRIC COMPANY BLACK HILLS POWER WILL PROVIDE AND INSTALL ALL MATERIALS NEEDED TO ESTABLISH PRIMARY OVERHEAD SERVICE FROM POINT OF CONNECTION AT THE EXISTING LINE UP TO THE TRANSFORMER -ELECTRIC COMPANY WILL PROVIDE AND INSTALL PRIMARY CABLES FOR ALL UNDERGROUND LINES UP TO THE TRANSFORMER -PENNINGTON COUNTY UTILITIES CO. -ANY RELOCATION OF EXISTING LINES OR POLES WILL BE DONE BY BLACK HILLS POWER -PRESENT RESPONSIBILITY PART OF THE COMPANY
SEWERAGE SYSTEM CITY OF RAPID CITY / SEWER PUBLIC WORKS DEPARTMENT 300 WEST STREET, RAPID CITY, SD 57701 CONTACT: MR. BRADY STIVO PHONE: (605) 386-3083 FAX: (605) 386-3083	-PROVIDE AND INSTALL SANITARY SEWER LINES AND SPECIFICATIONS FOR THE PLANS -ALL SANITARY SEWER LINES SHALL BE PVC AND SCHEDULE 40 -CONFORM TO ALL APPLICABLE REGULATIONS AND SPECIFICATIONS	-SEWERAGE SYSTEMS SHALL BE PROVIDED BY THE CITY OF RAPID CITY
WATER CITY OF RAPID CITY / WATER PUBLIC WORKS DEPARTMENT 300 WEST STREET, RAPID CITY, SD 57701 CONTACT: MR. BRADY STIVO PHONE: (605) 386-3083 FAX: (605) 386-3083	-PROVIDE AND INSTALL ALL WATER MAINS AND ACCESSORIES PER THE PLANS AND SPECIFICATIONS -ALL WATER MAINS SHALL BE 8" DIA. PVC AND SCHEDULE 40 -CONFORM TO ALL APPLICABLE REGULATIONS AND SPECIFICATIONS	-WATER MAINS SHALL BE PROVIDED BY THE CITY OF RAPID CITY
STORM SEWER CITY OF RAPID CITY / STORM SEWER PUBLIC WORKS DEPARTMENT 300 WEST STREET CONTACT: MR. BRADY STIVO PHONE: (605) 386-4180 FAX: (605) 386-4030 WEB: www.rapidcity.org	-PROVIDE AND INSTALL ALL STORM SEWER LINES AND ACCESSORIES PER THE PLANS AND SPECIFICATIONS -STORM SEWER SHALL BE PER THE PLANS AND SPECIFICATIONS -STORM SEWER SHALL BE PROVIDED BY THE CITY OF RAPID CITY	-STORM SEWER SHALL BE PROVIDED BY THE CITY OF RAPID CITY
DEED P&E DEPARTMENT 1000 W. 10TH STREET, SUITE 4 RICHMOND, MO 64117 CONTACT: CHRYL B. BALDWIN 800-394-8323 FAX 384-5820	-PROVIDE AND INSTALL ALL WATER MAINS AND ACCESSORIES PER THE PLANS AND SPECIFICATIONS -ALL WATER MAINS SHALL BE 8" DIA. PVC AND SCHEDULE 40 -CONFORM TO ALL APPLICABLE REGULATIONS AND SPECIFICATIONS	-DEEDS SHALL BE PROVIDED BY THE CITY OF RAPID CITY

SEE THESE HAS BEEN PROVIDED FOR INFORMATION PURPOSES. THE CONTRACTOR SHALL PROVIDE ANY AND ALL APPROPRIATE DESIGN AND MATERIALS AND OTHER NECESSARY TO MEET OR EXCEED THE SPECIFICATIONS OF THE CITY USED.

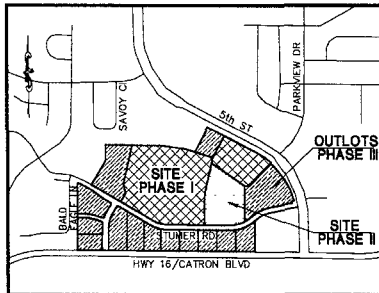

LOCATION MAP
NOT TO SCALE

THE SITE IS LOCATED IN THE S1/2 OF THE NE1/4, OR AKA IN THE SW1/4 OF THE NE1/4 AND IN THE SE1/4 OF THE NE1/4, SECTION 24, T1N, R7E, B1M, RAPID CITY, PENNINGTON COUNTY, SOUTH DAKOTA.

1. THE SITEWORK FOR THE WALMART PORTION OF THIS PROJECT SHALL MEET OR EXCEED THE "WALMART STANDARD SITEWORK SPECIFICATIONS".
2. ALL NECESSARY INSPECTIONS AND/OR CERTIFICATIONS REQUIRED BY CODES AND/OR UTILITY COMPANIES SHALL BE COMPLETED BY THE CONTRACTOR'S QUALIFIED PERSONNEL.

RECEIVED

MAY 26 2010

Rapid City Growth
Management Department

WALMART SUPERCENTER # 3872-03
BLACK HILLS CENTER, RAPID CITY, SD

SHEET INDEX

Page Num	Description	Issued	Latest Revision	Comment
1	C-0 COVER SHEET	05/24/2010		
2	EX-1 EXISTING CONDITIONS	02/04/2010		
3	C-1 PRELIMINARY MASTER PLAN	05/24/2010		
4	C-1A PRELIMINARY SITE PLAN (80 SCALE)	05/24/2010		
5	C-1B PRELIMINARY SITE PLAN (80 SCALE)	05/24/2010		
6	C-2 PRELIMINARY OVERALL GRADING PLAN	05/24/2010		
7	C-2A PRELIMINARY GRADING PLAN (80 SCALE)	05/24/2010		
8	C-2B PRELIMINARY GRADING PLAN (80 SCALE)	05/24/2010		
9	C-3 PRELIMINARY OVERALL UTILITY PLAN	05/24/2010		
10	C-3A PRELIMINARY UTILITY PLAN (80 SCALE)	05/24/2010		
11	C-3B PRELIMINARY UTILITY PLAN (80 SCALE)	05/24/2010		
12	L-1 PRELIMINARY PLANTING PLAN (80 SCALE)	03/16/2010	05/24/2010	
13	L-2 PRELIMINARY PLANTING PLAN (30 SCALE)	03/16/2010	05/24/2010	
14	L-3 PRELIMINARY PLANTING PLAN (30 SCALE)	03/16/2010	05/24/2010	
15	L-4 PRELIMINARY PLANTING PLAN (30 SCALE)	03/16/2010	05/24/2010	
16	L-5 PRELIMINARY PLANTING PLAN (30 SCALE)	03/16/2010	05/24/2010	
17	L-6 PRELIMINARY PLANTING DETAIL PLAN	03/16/2010	05/24/2010	
18	L-7 PRELIMINARY PLANTING DETAIL PLAN	03/16/2010	05/24/2010	
19	LO-1 SITE LIGHTING PHOTOMETRIC PLAN	03/16/2010	05/24/2010	
20	SL-A SITE PLAN 'A' SKIGHTLINE	05/24/2010		
21	SL-A1 SITE PLAN 'A' SKIGHTLINE PROFILES	05/24/2010		
22	SL-A2 SITE PLAN 'A' SKIGHTLINE PROFILES	05/24/2010		
23	SL-B SITE PLAN 'B' SKIGHTLINE	05/24/2010		
24	SL-B1 SITE PLAN 'B' SKIGHTLINE PROFILES	05/24/2010		
25	SL-B2 SITE PLAN 'B' SKIGHTLINE PROFILES	05/24/2010		
26	SL-B3 SITE PLAN 'B' SKIGHTLINE PROFILES	05/24/2010		
27	TH-1 OPERATIONAL SITE PLAN	05/24/2010		
28	TH-2 CITY SAFETY ACCESS PLAN	05/24/2010		

ENGINEER-

W
Wolverton & Associates
Consulting Engineers + Land Surveyors

6745 Sugarloaf Parkway • Suite 100 • Duluth, Georgia 30097
Phone (770) 447-8989 • Fax: (770) 447-9070

www.wolverton-assoc.com
CONTACT: MR. KELLY J. WAGONER



Keep what's below
Clear before you go

Wolverton & Associates
Consulting Engineers + Land Surveyors
6745 Sugarloaf Parkway • Suite 100 • Duluth, Georgia 30097
Phone: (770) 447-8989 • Fax: (770) 447-9070
www.wolverton-assoc.com

PROPOSED BLACK HILLS CENTER
Walmart # 3872-03
RAPID CITY, PENNINGTON COUNTY, S.D.
BY: THF STONERIDGE DEVELOPMENT, LLC
ST. LOUIS, MO

Project Developer
THF STONERIDGE DEVELOPMENT, LLC
2127 INNERBELT BUSINESS CENTER DR.
SUITE 200 / ST. LOUIS, MO. 63114

C-0

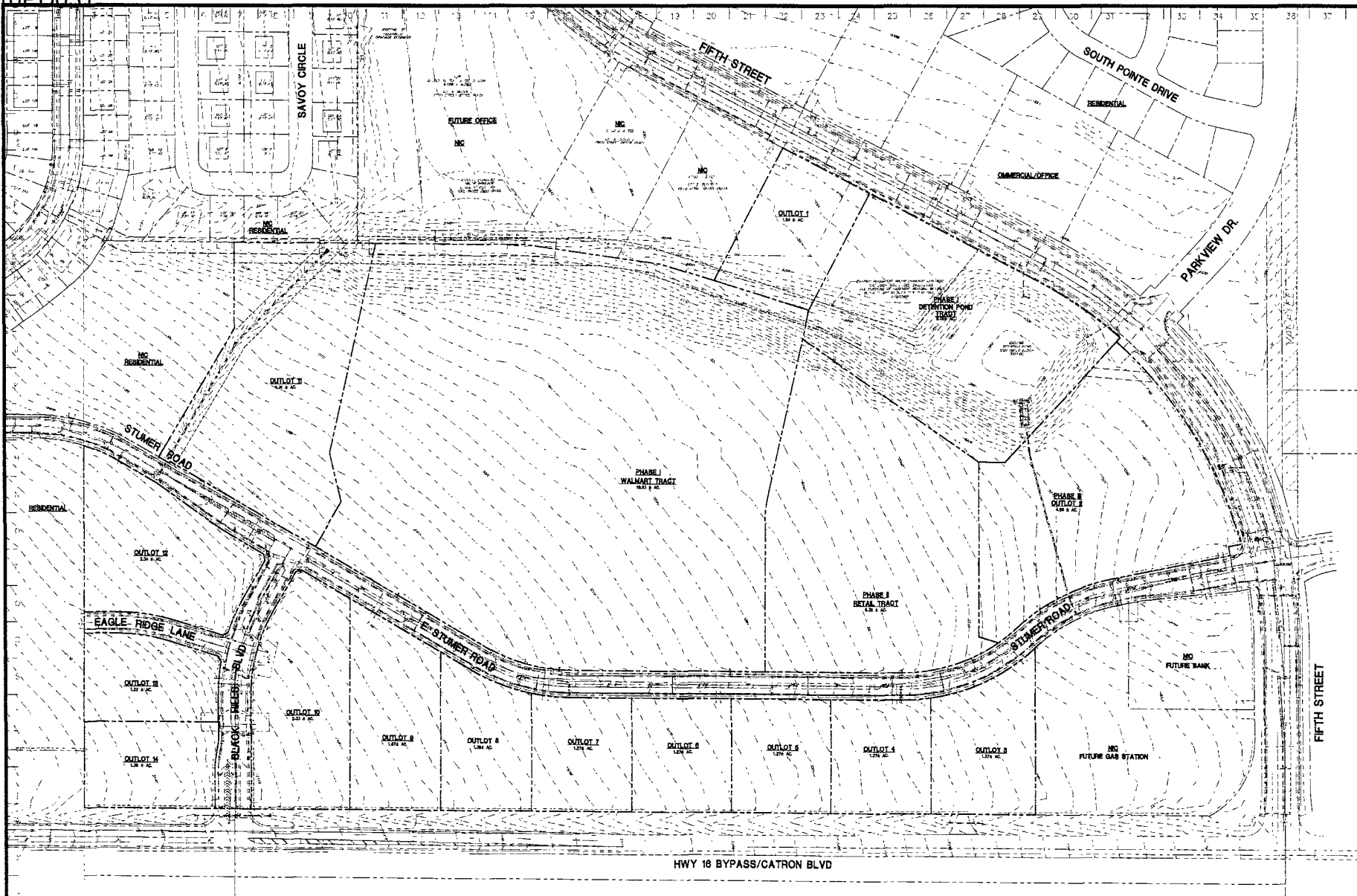

W
Wolverton & Associates
 4115 S. Highway 100, Suite 100, Omaha, Nebraska 68106
 Phone: (402) 426-1000 Fax: (402) 426-1001
 www.wolvertonandassociates.com

PROPOSED BLACK HILLS CENTER
Walmart SUPERCENTER #3872-03
 RAPID CITY, PENNINGTON COUNTY, S.D.
 BY: THE STONERIDGE DEVELOPMENT, LLC
 ST. LOUIS, MO

REVISIONS BY

DRAWN BY: CRP
 CHECKED BY: KJW
 DATE: 02/04/2010
 SCALE: 1" = 80'
 JOB NO.: 08-140
 SHEET NUMBER

EX-1
 OF SHEETS

**PRELIMINARY
 EXISTING CONDITIONS**

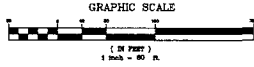

10PD031.dwg, 02/04/2010, 1:58 PM, User: crp

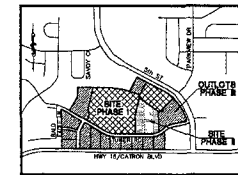

LOCATION MAP
NOT TO SCALE
THE SITE IS LOCATED ON THE N71°27'30\"/>

OVERALL SITE ANALYSIS

WALMART RETAIL	154,750 S.F.
TOTAL GROSS AREA	48,800 S.F.
TOTAL PARKING	201,850 S.F.
PROPOSED RATIO	4.887/1,000 S.F.

WALMART SITE ANALYSIS

WALMART	154,750 S.F.
STANDARD SPACES	714 SPACES
ACCESSIBLE SPACES	20 SPACES
CART CORRAL	28 SPACES
TOTAL PARKING	734 SPACES
RATIO	4.74/1,000 S.F.

RETAIL SITE ANALYSIS

RETAIL	48,800 S.F.
TOTAL PARKING	271 SPACES
RATIO	5.78/1,000 S.F.

SITE AREA ANALYSIS

WALMART	10.17 ± AC.
RETAIL	6.40 ± AC.
DEFENTION POND TRACT	4.47 ± AC.
R/W DEDICATION	1.05 ± AC.
OUTLOTS 1 TO 15	27.42 ± AC.
SITE AREA	58.61 ± AC.

WALMART SUPPLEMENTAL PARKING RATIO BY USE

WALMART MAIN SALES	125,978 S.F.	6.07/1,000 S.F.	629.9 BP
TIRE & LIQE EXPRESS (TLE)	1,278 S.F.	10.0/1,000 S.F.	12.8 BP
FOOD SERVICE	892 S.F.	11.0/1,000 S.F.	8.8 BP
PHARMACY	771 S.F.	6.0/1,000 S.F.	3.9 BP
FOOD TENANT	710 S.F.	11.0/1,000 S.F.	7.8 BP
RETAIL TENANT	970 S.F.	6.0/1,000 S.F.	3.3 BP
OPTICAL SALES	776 S.F.	6.0/1,000 S.F.	3.9 BP
STORE OFFICE & PREPARATION AREAS	10,791 S.F.	6.0/1,000 S.F.	54.0 BP
NON-PUBLIC ACCESSIBLE AREAS	21,438 S.F.	0.25/1,000 S.F.	5.4 BP
WALMART GROSS AREA	183,212 S.F.		728.8 BP

NOTE:
1. WALMART BUILDING AREAS BASED ON AREAS PROVIDED BY ARCHITECTURAL FLOOR PLAN DATE: 04/01/2010.
2. NON-PUBLIC ACCESSIBLE AREAS INCLUDE STAIRWAYS, RESTROOMS, ELECTRICAL/Mechanical ROOMS, WAREHOUSES, USE, REE, ETC. NOT OPEN TO THE PUBLIC. THESE OFFICE AND PREPARATION AREAS OFFER OTHER AREAS INCLUDING THESE AREAS NOT OPEN TO THE PUBLIC.
3. ALL SALES RATIO/ACCESSIBLE SPACES RATIO. SPACES PROVIDED INCLUDE THE SALES AND SERVICE AND OUTDOOR VEHICLE SERVICES INCLUDING ALL CORRAL AND SATURDAY DELIVERY.
4. TOTAL AREA SHOWN HERE INCLUDES CERTAIN OUTDOOR AND SERVICE AREAS NOT REPRESENTED IN THE OVERALL SITE ANALYSIS TABLE. OVERALL RATIO TAKES INTO THE TOTAL DEVELOPMENT.

SITE PLAN NOTES

- ALL WORK AND MATERIALS SHALL COMPLY WITH ALL CITY/COUNTY REGULATIONS AND CODES AND O.S.H.A. STANDARDS.
- CONTRACTOR SHALL REFER TO THE ARCHITECTURAL PLANS FOR EXACT LOCATIONS AND DIMENSIONS OF INTERSECTIONS, DRIVE PAVINGS, SIDEWALKS, C&G, PAVEMENT, TRUCK DRIVES, PEEDS, MAILBOX AND WATER MAINS, AND EXISTING UTILITIES AND RECORD DRAWINGS.
- ALL UTILITIES SHALL BE DELETED FROM RECORDS OF TOWN, RECORD, RECORD AND WATER MAINS, A. ALL UTILITIES SHALL BE DELETED FROM RECORDS OF TOWN, RECORD, RECORD AND WATER MAINS, A. ALL UTILITIES SHALL BE DELETED FROM RECORDS OF TOWN, RECORD, RECORD AND WATER MAINS, A.
- ALL UTILITIES SHALL BE DELETED FROM RECORDS OF TOWN, RECORD, RECORD AND WATER MAINS, A. ALL UTILITIES SHALL BE DELETED FROM RECORDS OF TOWN, RECORD, RECORD AND WATER MAINS, A.
- ALL UTILITIES SHALL BE DELETED FROM RECORDS OF TOWN, RECORD, RECORD AND WATER MAINS, A. ALL UTILITIES SHALL BE DELETED FROM RECORDS OF TOWN, RECORD, RECORD AND WATER MAINS, A.
- ALL UTILITIES SHALL BE DELETED FROM RECORDS OF TOWN, RECORD, RECORD AND WATER MAINS, A. ALL UTILITIES SHALL BE DELETED FROM RECORDS OF TOWN, RECORD, RECORD AND WATER MAINS, A.
- CONTRACTOR SHALL BE RESPONSIBLE FOR THE DESIGN, CONSTRUCTION AND MAINTENANCE OF ALL UTILITIES, INCLUDING BUT NOT LIMITED TO, WATER, SEWER, GAS, AND ELECTRIC. ALL UTILITIES SHALL BE DELETED FROM RECORDS OF TOWN, RECORD, RECORD AND WATER MAINS, A.
- TOTAL LAND AREA IS 53.6 ± ACRES.
- THE SITE WORK FOR THIS PROJECT SHALL BE IN ACCORDANCE WITH THE WALMART SITE WORK SPECIFICATIONS.
- SHIPPING CENTER SIGN SHALL BE CONSTRUCTED BY DEVELOPER'S SIGN CONTRACTOR.
- REFER TO ARCHITECTURAL PLANS FOR SITE LIGHTING ELECTRICAL PLAN.
- THE CURRENT ZONING OF ALL PROPERTY SHOWN FOR DEVELOPMENT IS "GENERAL COMMERCIAL", "OFFICE COMMERCIAL" AND "RETAIL" W/ALMART PROPERTY ZONED AS "RETAIL".
- ACCESS ROADS, WALMART AND RETAIL TRUCKS ARE PROVIDED FOR PRIVATE AGREEMENT BETWEEN THE PROPERTY OWNERS.

OVERALL MASTER PLAN

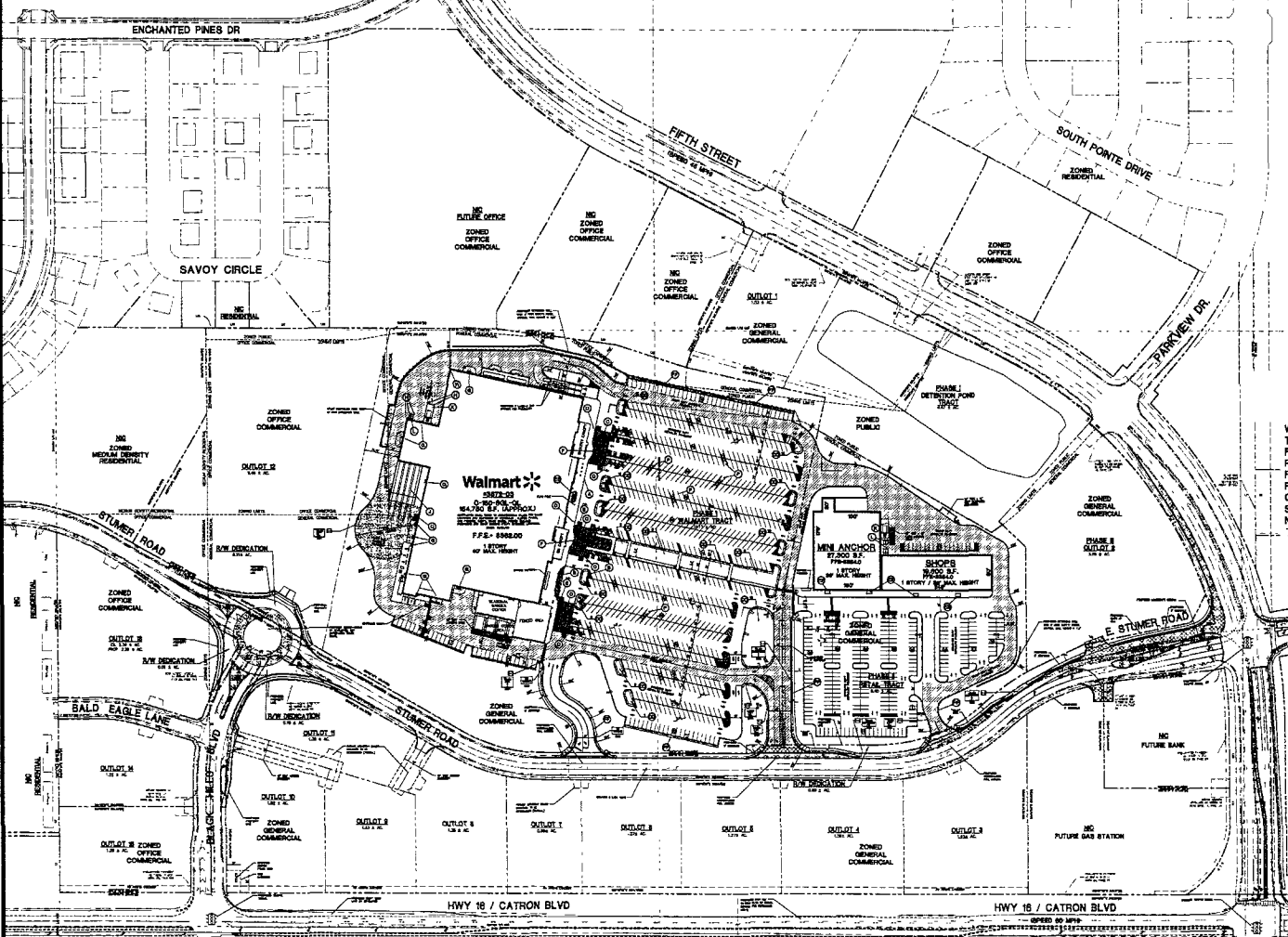
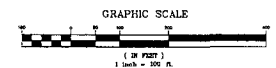

FOR REVIEW ONLY



PROPOSED BLACK HILLS CENTER
Walmart # 3872-03
RAPID CITY, PENNINGTON COUNTY, S.D.
BY: THF STONERIDGE DEVELOPMENT, LLC
ST. LOUIS, MO

REVISIONS BY



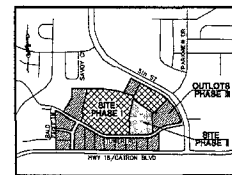

LOCATION MAP
THE SITE IS LOCATED IN THE SE 1/4 OF THE NE 1/4 OF SECTION 24, T1N, R10E, SW/4, RAPID CITY, PENNINGTON COUNTY, SOUTH DAKOTA.

SITE GRADING NOTES

- 1. CONTRACTOR IS RESPONSIBLE FOR DEVELOPMENT OF EXISTING STRUCTURES INCLUDING REMOVAL OF ALL EXISTING UTILITIES SERVING THE STRUCTURE...
2. THE CONTRACTOR IS RESPONSIBLE FOR DETERMINING THE LOCATION AND THE EXTENSION OF ALL EXISTING UTILITIES...
3. ALL CUT OR FILL SLOPES SHALL BE 3:1 OR FLATTER UNLESS OTHERWISE NOTED...
4. PRECAST STRUCTURES SHALL BE CONSTRUCTED IN ACCORDANCE WITH THE PRECAST STRUCTURES...
5. STORM PIPES SHALL BE AS FOLLOWS UNLESS OTHERWISE NOTED...
6. EXISTING DRAINAGE STRUCTURES TO BE REPAIRED AND REPAIRED AS NOTED...
7. EXISTING GRADE CONTOUR SHOWN AT 1 FOOT INTERVALS...
8. IF ANY EXISTING STRUCTURES TO REMAIN ARE DAMAGED DURING CONSTRUCTION IT SHALL BE THE CONTRACTOR'S RESPONSIBILITY TO REPAIR OR REPLACE THE SAME...
9. ALL EXISTING AND EXTERIOR FINISHES SHALL BE CONSTRUCTED TO ASSURE CONNECTION AT STRUCTURE INTERSECTIONS...
10. ALL EXISTING ROAD MARKINGS IN PAVED AREAS SHALL BE FURNISHED WITH PAINTWORK AND SIGNS...
11. THE CONTRACTOR SHALL BE RESPONSIBLE FOR THE PROTECTION OF ALL UTILITIES...
12. ALL EXISTING UTILITIES SHALL BE PROTECTED AND MAINTAINED THROUGHOUT THE CONSTRUCTION...
13. OPERATOR SHALL MAINTAIN AND/OR CUT EXISTING PAVEMENT AS NECESSARY TO ASSURE A SMOOTH FIT AND CONNECTION...
14. OPERATOR SHALL ASSURE POSITIVE DRAINAGE AWAY FROM AREAS FOR ALL NATURAL AND PAVED AREAS...
15. PROPOSED SIGNAGE SHALL BE INSTALLED IN ACCORDANCE WITH THE SIGNAGE REGULATIONS...
16. ALL EXISTING UTILITIES SHALL BE PROTECTED AND MAINTAINED THROUGHOUT THE CONSTRUCTION...
17. EXISTING UTILITIES SHALL BE PROTECTED AND MAINTAINED THROUGHOUT THE CONSTRUCTION...
18. ALL EXISTING UTILITIES SHALL BE PROTECTED AND MAINTAINED THROUGHOUT THE CONSTRUCTION...
19. CONTRACTOR TO CONTACT THE CITY/COUNTY FIRE DEPARTMENT FOR PLACING FIREWORKS...
20. WHERE APPLICABLE, ALL UTILITIES SHALL BE PROTECTED AND MAINTAINED THROUGHOUT THE CONSTRUCTION...
21. THE CONTRACTOR SHALL MAINTAIN ALL UTILITIES AND STRUCTURES AS NOTED ON THE GRADING PLAN...
22. THE CONTRACTOR SHALL MAINTAIN ALL UTILITIES AND STRUCTURES AS NOTED ON THE GRADING PLAN...

THE CONTRACTOR IS RESPONSIBLE FOR DETERMINING THE LOCATION AND THE EXTENSION OF ALL EXISTING UTILITIES SERVING THE STRUCTURE...
THE CONTRACTOR SHALL BE RESPONSIBLE FOR THE PROTECTION OF ALL UTILITIES...
ALL EXISTING UTILITIES SHALL BE PROTECTED AND MAINTAINED THROUGHOUT THE CONSTRUCTION...
EXISTING UTILITIES SHALL BE PROTECTED AND MAINTAINED THROUGHOUT THE CONSTRUCTION...
ALL EXISTING UTILITIES SHALL BE PROTECTED AND MAINTAINED THROUGHOUT THE CONSTRUCTION...
CONTRACTOR TO CONTACT THE CITY/COUNTY FIRE DEPARTMENT FOR PLACING FIREWORKS...
WHERE APPLICABLE, ALL UTILITIES SHALL BE PROTECTED AND MAINTAINED THROUGHOUT THE CONSTRUCTION...
THE CONTRACTOR SHALL MAINTAIN ALL UTILITIES AND STRUCTURES AS NOTED ON THE GRADING PLAN...
THE CONTRACTOR SHALL MAINTAIN ALL UTILITIES AND STRUCTURES AS NOTED ON THE GRADING PLAN...

STRUCTURE TYPE

- CONCRETE - SEE DETAIL SHEETS
PRECAST STRUCTURE - SEE DETAIL SHEETS
SLOPE AREA - SEE DETAIL SHEETS
SLOPE AREA - SEE DETAIL SHEETS
SLOPE AREA - SEE DETAIL SHEETS
SLOPE AREA - SEE DETAIL SHEETS
SLOPE AREA - SEE DETAIL SHEETS
SLOPE AREA - SEE DETAIL SHEETS
SLOPE AREA - SEE DETAIL SHEETS

PIPE TYPE

- UNLESS A PIPE TYPE MATERIAL IS SPECIFIED IN THE DRAINAGE SCHEDULE, THE CONTRACTOR SHALL USE AS AT THE DISCRETION OF THE ENGINEER THE PIPE MATERIALS AS APPROVED FROM THE PIPE MATERIALS IN THE SITE GRADING NOTES.

GRADING/DRAINAGE PLAN LEGEND



OVERALL GRADING PLAN
GRAPHIC SCALE
1" = 100'

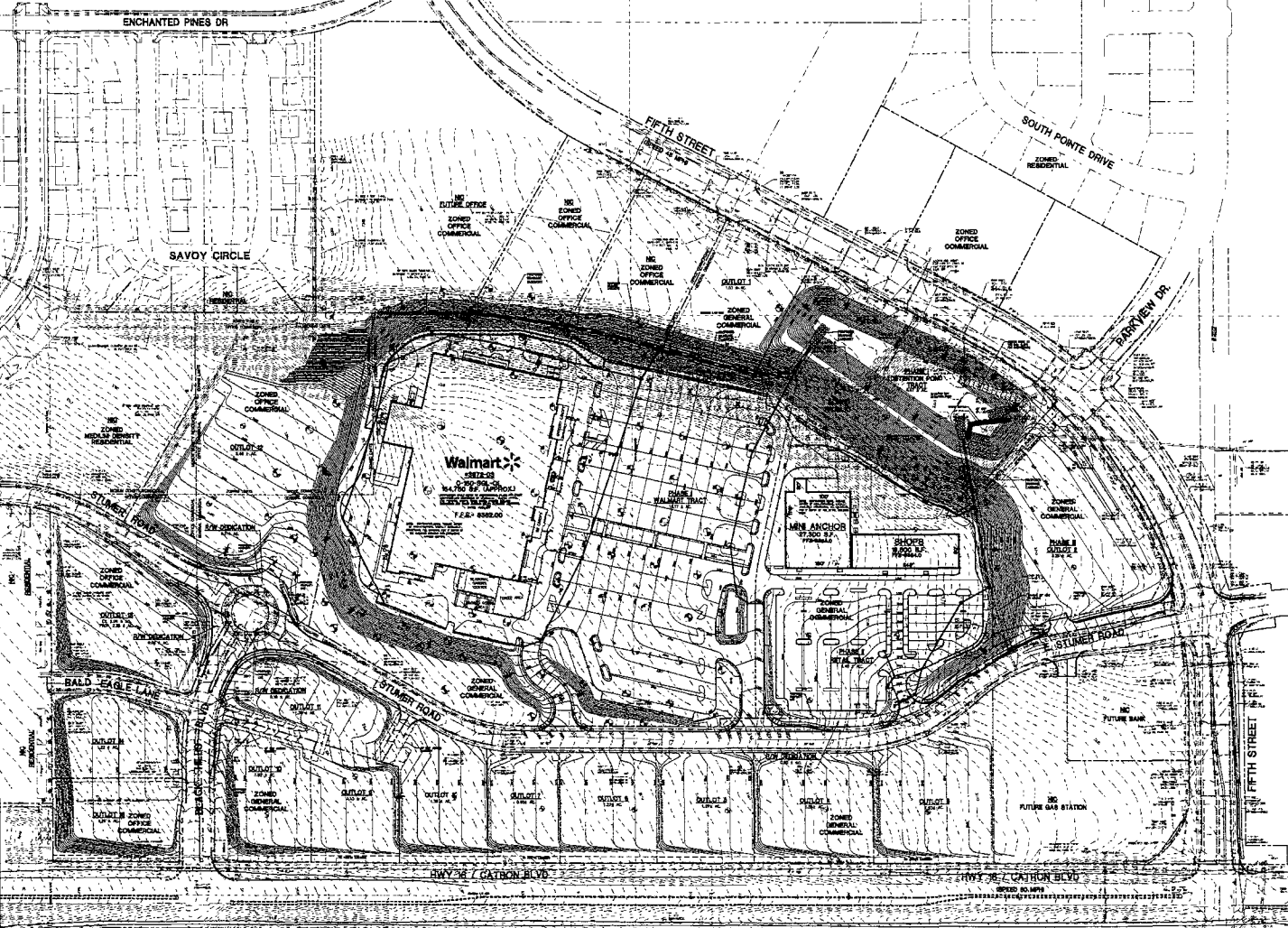

Wolveton & Associates
Consulting Engineers & Land Surveyors
612 National Parkway, Suite 500, Rapid City, South Dakota 57701
www.wolveton.com

PROPOSED BLACK HILLS CENTER
Walmart # 3872-03
RAPID CITY, PENNINGTON COUNTY, S.D.
BY: THF, STONERIDGE DEVELOPMENT, LLC
ST. LOUIS, MO

Table with columns: REVISIONS, BY, DRAWN BY, CHECKED BY, DATE, SCALE, JOB NO., SHEET NUMBER. Includes drawing date 06/24/2010 and sheet number C-2.



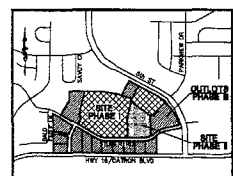
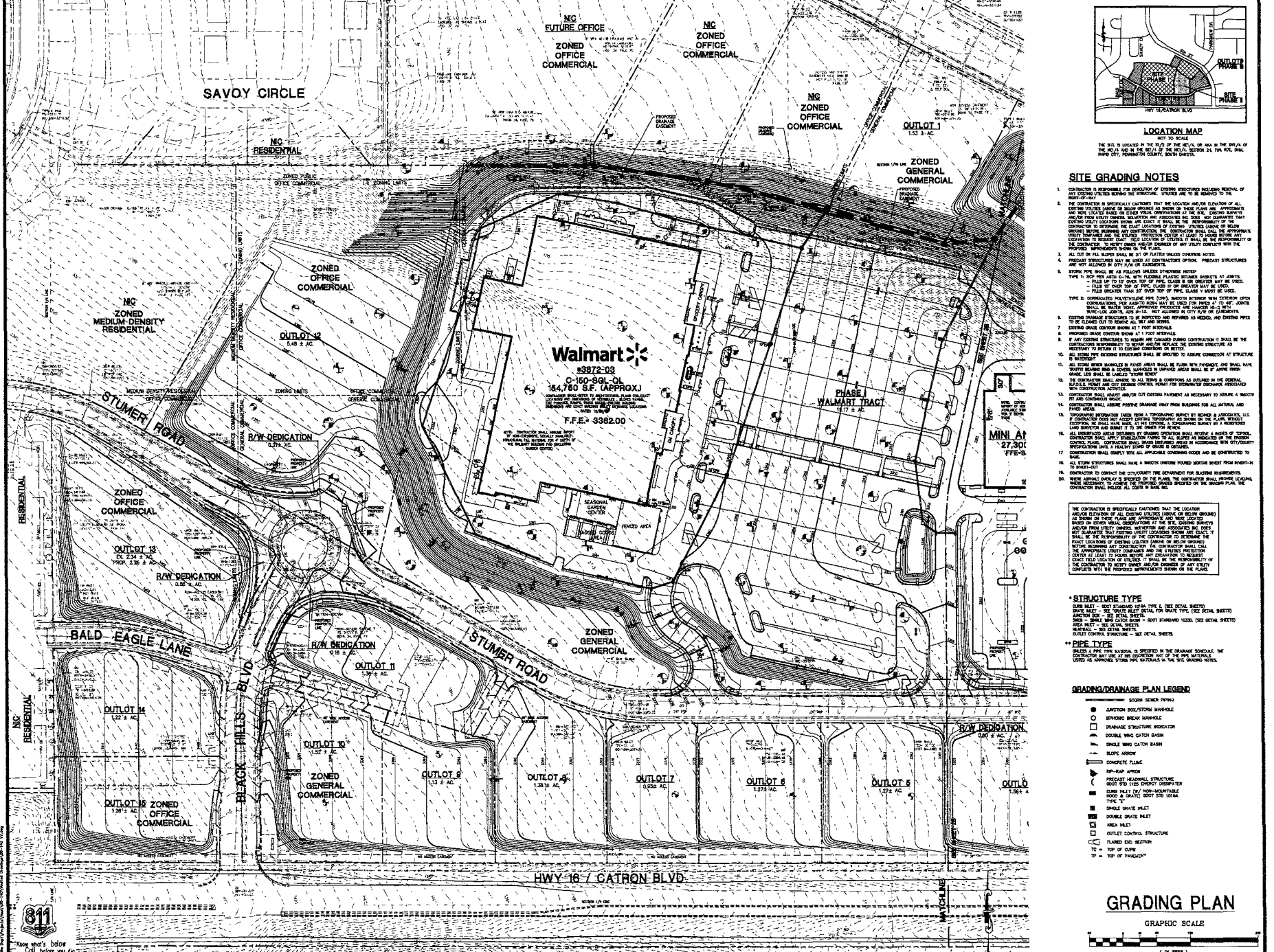

LOCATION MAP
 THE SITE IS LOCATED IN THE NW CORNER OF THE INTERSECTION OF HWY 16 ON THE WEST OF THE HWY 16 AND IN THE WEST OF THE NORTH SECTION 24, 2A, RT. 1646, ST. LOUIS, MISSOURI (CORNER SOUTH QUARTER).

SITE GRADING NOTES

1. THE CONTRACTOR SHALL VERIFY THE ELEVATIONS OF EXISTING STRUCTURES BEFORE REMOVAL OF ANY EXISTING UTILITIES BEING THE STRUCTURE. UTILITIES ARE TO BE RELOCATED TO THE PROPOSED GRADE.
2. THE CONTRACTOR IS SPECIFICALLY CAUTIONED THAT THE LOCATION AND OR ELEVATION OF ALL EXISTING UTILITIES LOCATED TO BE MOVED SHOULD AS SHOWN ON THESE PLANS AND, APPROPRIATE AND NEW LOCATED BASED ON FIELD SURVEY OBSERVATIONS AT THE SITE. EXISTING UTILITIES LOCATED TO BE MOVED SHALL BE SHOWN AS MOVED BY THIS PLAN. THE CONTRACTOR SHALL GUARANTEE THAT CONTRACTOR TO STRIKE THE EXACT LOCATIONS OF EXISTING UTILITIES (UNDER OR BELOW GROUND) BEFORE ANY CONSTRUCTION. THE CONTRACTOR SHALL BE RESPONSIBLE FOR VERIFYING EXISTING UTILITIES PROTECTION SYSTEM AT LEAST 14 DAYS BEFORE ANY EXISTING UTILITIES TO BE MOVED. THE CONTRACTOR SHALL GUARANTEE THAT THE PROPOSED CONSTRUCTION SHALL BE IN ACCORDANCE WITH THE PREVIOUS AGREEMENTS MADE WITH THE CITY.
3. ALL UTILITY REPAIRS SHALL BE OF A GREATER QUALITY THAN THE ORIGINAL UTILITY.
4. PRECAST STRUCTURES SHALL BE USED AT CONTRACTORS OPTION. PRECAST STRUCTURES ARE NOT ALLOWED IN ANY OF THE AREAS SHOWN HEREON.
5. STORM PIPES SHALL BE AS FOLLOWS UNLESS OTHERWISE NOTED:
 - FULL SIZE UP TO 14" OVER TOP OF PIPE, CLASS B OR GREATER SHALL BE USED.
 - FULL SIZE UP TO 18" OVER TOP OF PIPE, CLASS B OR GREATER SHALL BE USED.
 - FULLS GREATER THAN 18" OVER TOP OF PIPE, CLASS V SHALL BE USED.
6. EXISTING DRAINAGE STRUCTURES SHALL BE IMPROVED AND REPAIRED AS NEEDED. ALL EXISTING PIPES TO BE CLEARED OUT TO INSURE ALL 100' INTERVALS.
7. PROPOSED GRADE CONTROL SHALL BE 4' FOOT INTERVALS.
8. IF ANY EXISTING STRUCTURES TO BE REMOVED OR CHANGED DURING CONSTRUCTION SHALL BE THE CONTRACTORS RESPONSIBILITY TO REPAIR AND/OR REPLACE THE EXISTING STRUCTURE AS NECESSARY TO RETAIN IT TO EXISTING CONDITIONS.
9. ALL STORM PIPES EXISTING STRUCTURES SHALL BE REPAIRED TO ASSURE CONSTRUCTION AT STRUCTURE IS NECESSARY.
10. ALL STORM PIPES EXISTING STRUCTURES SHALL BE REPAIRED TO ASSURE CONSTRUCTION AT STRUCTURE IS NECESSARY.
11. ALL STORM PIPES EXISTING STRUCTURES SHALL BE REPAIRED TO ASSURE CONSTRUCTION AT STRUCTURE IS NECESSARY.
12. EXISTING GRADE CONTROL SHALL BE 4' FOOT INTERVALS.
13. THE CONTRACTOR SHALL GUARANTEE THAT THE PROPOSED CONSTRUCTION SHALL BE IN ACCORDANCE WITH THE PREVIOUS AGREEMENTS MADE WITH THE CITY.
14. ALL EXISTING UTILITIES TO BE MOVED SHALL BE MOVED TO THE PROPOSED LOCATION AND SHALL BE MOVED TO THE PROPOSED LOCATION AND SHALL BE MOVED TO THE PROPOSED LOCATION.
15. EXISTING UTILITIES TO BE MOVED SHALL BE MOVED TO THE PROPOSED LOCATION AND SHALL BE MOVED TO THE PROPOSED LOCATION.
16. ALL EXISTING UTILITIES TO BE MOVED SHALL BE MOVED TO THE PROPOSED LOCATION AND SHALL BE MOVED TO THE PROPOSED LOCATION.
17. ALL EXISTING UTILITIES TO BE MOVED SHALL BE MOVED TO THE PROPOSED LOCATION AND SHALL BE MOVED TO THE PROPOSED LOCATION.
18. ALL EXISTING UTILITIES TO BE MOVED SHALL BE MOVED TO THE PROPOSED LOCATION AND SHALL BE MOVED TO THE PROPOSED LOCATION.

THE CONTRACTOR IS SPECIFICALLY CAUTIONED THAT THE LOCATION AND OR ELEVATION OF ALL EXISTING UTILITIES (UNDER OR BELOW GROUND) AS SHOWN ON THESE PLANS ARE APPROXIMATE AND NEW LOCATIONS SHOULD BE BASED ON FIELD SURVEY OBSERVATIONS AT THE SITE. EXISTING UTILITIES LOCATED TO BE MOVED SHALL BE SHOWN AS MOVED BY THIS PLAN. THE CONTRACTOR SHALL GUARANTEE THAT CONTRACTOR TO STRIKE THE EXACT LOCATIONS OF EXISTING UTILITIES (UNDER OR BELOW GROUND) BEFORE ANY CONSTRUCTION. THE CONTRACTOR SHALL BE RESPONSIBLE FOR VERIFYING EXISTING UTILITIES PROTECTION SYSTEM AT LEAST 14 DAYS BEFORE ANY EXISTING UTILITIES TO BE MOVED. THE CONTRACTOR SHALL GUARANTEE THAT THE PROPOSED CONSTRUCTION SHALL BE IN ACCORDANCE WITH THE PREVIOUS AGREEMENTS MADE WITH THE CITY.

- *STRUCTURE TYPE**
 CURB MILET - (SEE DETAIL SHEET)
 AREA MILET - (SEE DETAIL SHEET)
 DOUBLE MILET - (SEE DETAIL SHEET)
- *PIPE TYPE**
 12" - (SEE DETAIL SHEET)
 18" - (SEE DETAIL SHEET)
 24" - (SEE DETAIL SHEET)
 30" - (SEE DETAIL SHEET)
 36" - (SEE DETAIL SHEET)

GRADING/ DRAINAGE PLAN LEGEND

STORM SEWER SYSTEM	
●	JUNCTION BOX/STATION MARKHOLE
○	SEWERING BREAK MARKHOLE
⬭	DRAINAGE STRUCTURE INDICATOR
□	DOUBLE WING CATCH BASIN
⬭	SHOULDER WING CATCH BASIN
→	SLOPE ARROW
—	CONCRETE FLANGE
↖	REPAIR APPROX
⬭	PRECAST HEADWALL STRUCTURE
⬭	ROOT END CONTROL STRUCTURE
⬭	CURB MILET (OF NON-MOUNTABLE ROAD AS DETAIL, SEE DETAIL SHEET)
⬭	AREA MILET
⬭	DOUBLE GRATE MILET
⬭	AREA MILET
⬭	OUTLET CONTROL STRUCTURE
⬭	FLANGE END SECTION
⬭	TOP OF CURB
⬭	TOP OF PARADEWAY

GRADING PLAN

GRAPHIC SCALE
 0' 10' 20' 30'

DRAWN BY: DMN
 CHECKED BY: K.O.W.
 DATE: 05/24/2010
 SCALE: 1" = 80'
 JOB NO: 08-140
 SHEET NUMBER: C-2A

Wolvertton & Associates
 Consulting Engineers & Land Surveyors
 4748 Westbound Avenue, Suite 202, Omaha, Nebraska 68137
 (402) 426-8888
 www.wolvertton.com

PROPOSED BLACK HILLS CENTER
 Walmart # 3872-03
 RAPID CITY, PENNINGTON COUNTY, S.D.
 BY: THE STONERIDGE DEVELOPMENT, L.L.C
 ST. LOUIS, MO

REVISIONS BY

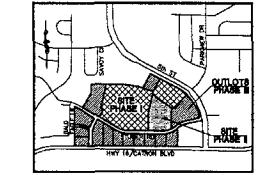
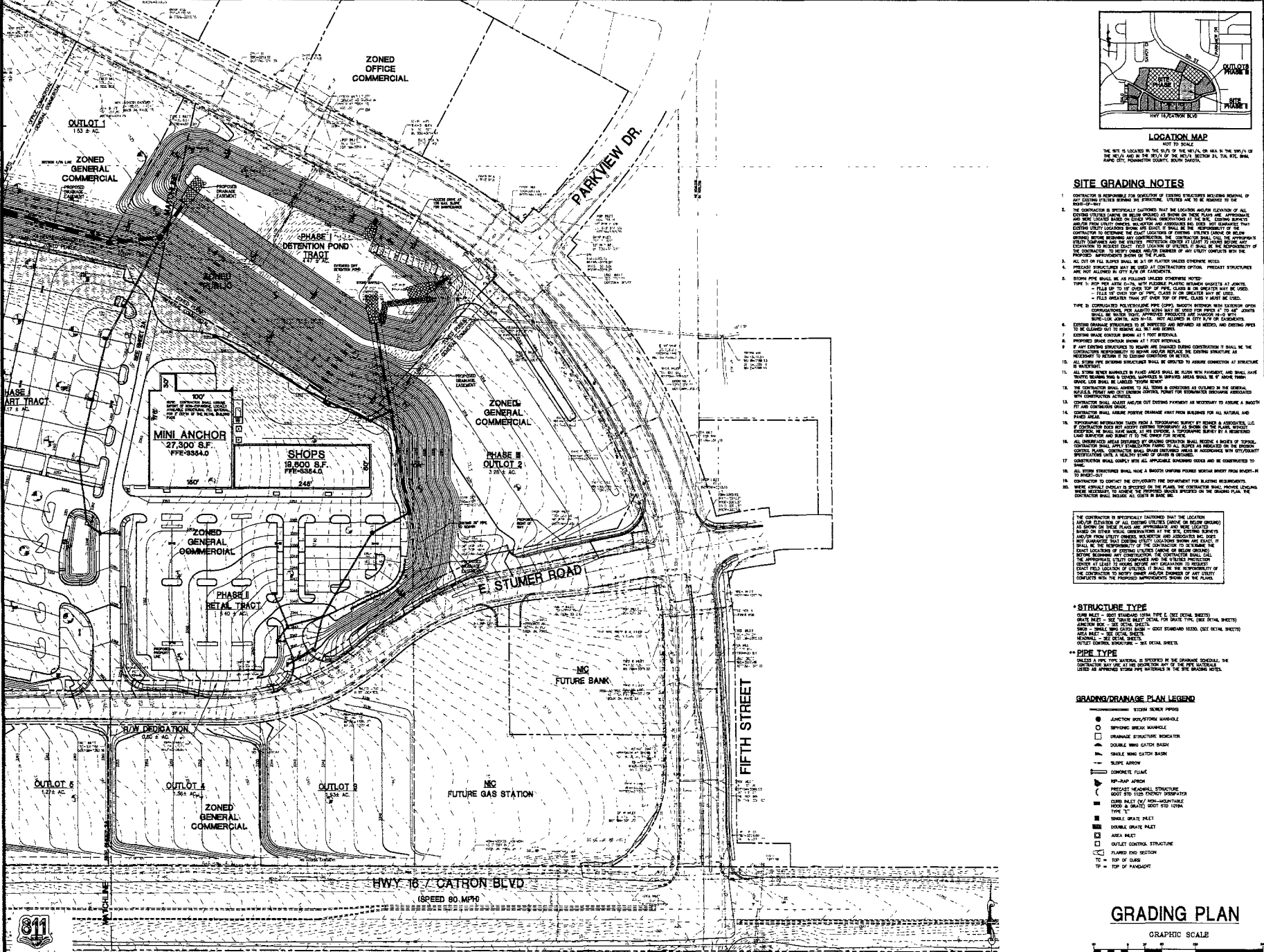

SITE GRADING NOTES

- CONTRACTOR IS RESPONSIBLE FOR DETERMINING OF EXISTING STRUCTURES INCLUDING MINIMUM OF 20' SPACING FROM FOUNDATIONS OF EXISTING STRUCTURES TO BE REMOVED TO BE REMOVED TO THE CONTRACTOR IS SPECIFICALLY CAUTIONED THAT THE LOCATION AND/OR ELEVATION OF ALL EXISTING UTILITIES (LINE OR TRENCH) BEING BURIED OR COVERED BY NEW AND APPROXIMATE AND BEING LOCATED AS SHOWN ON THESE PLANS OR OTHERWISE TO BE LOCATED BY THE CONTRACTOR. CONTRACTOR SHALL BE RESPONSIBLE FOR OBTAINING ALL NECESSARY PERMITS FROM ALL CITY AND COUNTY AGENCIES AND ALL NECESSARY CONSTRUCTION SCHEDULES. CONTRACTOR SHALL BE RESPONSIBLE FOR OBTAINING ALL NECESSARY PERMITS FROM ALL CITY AND COUNTY AGENCIES AND ALL NECESSARY CONSTRUCTION SCHEDULES. CONTRACTOR SHALL BE RESPONSIBLE FOR OBTAINING ALL NECESSARY PERMITS FROM ALL CITY AND COUNTY AGENCIES AND ALL NECESSARY CONSTRUCTION SCHEDULES.
- ALL UTILITIES TO BE REMOVED SHALL BE 3" DIA. UNLESS OTHERWISE NOTED.
- PRECAST STRUCTURES MAY BE USED AT CONTRACTOR OPTION. PRECAST STRUCTURES ARE NOT ALLOWED IN CITY RWY OR EASEMENTS.
- CONCRETE SHALL BE AS FOLLOWS UNLESS OTHERWISE NOTED:
TYPE 1: 4" HP PER AREA (3-4") WITH PLASTIC WITHIN GROUTS AT JOINTS.
- FILL UP TO 4" OVER TOP OF THE CLASS OR UNLESS OTHERWISE NOTED.
- FILL OF CURB TOP OF THE CLASS OR UNLESS OTHERWISE NOTED.
TYPE 2: COMPACTED POLYESTER FIBRE CONCRETE WITH 3% EXTENSION CAPACITY. CONTRACTOR SHALL BE RESPONSIBLE FOR OBTAINING ALL NECESSARY PERMITS FROM ALL CITY AND COUNTY AGENCIES AND ALL NECESSARY CONSTRUCTION SCHEDULES. CONTRACTOR SHALL BE RESPONSIBLE FOR OBTAINING ALL NECESSARY PERMITS FROM ALL CITY AND COUNTY AGENCIES AND ALL NECESSARY CONSTRUCTION SCHEDULES.
- EXISTING GRADE SHALL BE MAINTAINED AS MUCH AS POSSIBLE. EXISTING GRADE SHALL BE MAINTAINED AS MUCH AS POSSIBLE. EXISTING GRADE SHALL BE MAINTAINED AS MUCH AS POSSIBLE.
- IF ANY EXISTING STRUCTURES TO BE REMOVED OR ABANDONED, CONTRACTOR SHALL BE RESPONSIBLE FOR OBTAINING ALL NECESSARY PERMITS FROM ALL CITY AND COUNTY AGENCIES AND ALL NECESSARY CONSTRUCTION SCHEDULES.
- ALL STEEL PIPE STRUCTURES SHALL BE PROVIDED TO ASSURE CONNECTION AT STRUCTURES IS WEATHERTIGHT.
- ALL STEEL PIPE STRUCTURES IN PLACE SHALL BE PLACED WITH PERMANENT AND SHALL HAVE TRUCK BEARING HOLES AS SHOWN ON THESE PLANS OR OTHERWISE TO BE LOCATED BY THE CONTRACTOR.
- CONTRACTOR SHALL ADVISE AND/OR OBTAIN PERMISSION AS NECESSARY TO ASSURE A SMOOTH AND CONTINUOUS GRADE.
- CONTRACTOR SHALL ADVISE AND/OR OBTAIN PERMISSION AS NECESSARY TO ASSURE A SMOOTH AND CONTINUOUS GRADE.
- CONTRACTOR SHALL ADVISE AND/OR OBTAIN PERMISSION AS NECESSARY TO ASSURE A SMOOTH AND CONTINUOUS GRADE.
- CONTRACTOR SHALL ADVISE AND/OR OBTAIN PERMISSION AS NECESSARY TO ASSURE A SMOOTH AND CONTINUOUS GRADE.
- CONTRACTOR SHALL ADVISE AND/OR OBTAIN PERMISSION AS NECESSARY TO ASSURE A SMOOTH AND CONTINUOUS GRADE.
- CONTRACTOR SHALL ADVISE AND/OR OBTAIN PERMISSION AS NECESSARY TO ASSURE A SMOOTH AND CONTINUOUS GRADE.
- CONTRACTOR SHALL ADVISE AND/OR OBTAIN PERMISSION AS NECESSARY TO ASSURE A SMOOTH AND CONTINUOUS GRADE.
- CONTRACTOR SHALL ADVISE AND/OR OBTAIN PERMISSION AS NECESSARY TO ASSURE A SMOOTH AND CONTINUOUS GRADE.

THE CONTRACTOR IS SPECIFICALLY CAUTIONED THAT THE LOCATION AND/OR ELEVATION OF ALL EXISTING UTILITIES (LINE OR TRENCH) BEING BURIED OR COVERED BY NEW AND APPROXIMATE AND BEING LOCATED AS SHOWN ON THESE PLANS OR OTHERWISE TO BE LOCATED BY THE CONTRACTOR. CONTRACTOR SHALL BE RESPONSIBLE FOR OBTAINING ALL NECESSARY PERMITS FROM ALL CITY AND COUNTY AGENCIES AND ALL NECESSARY CONSTRUCTION SCHEDULES.

- STRUCTURE TYPE**
- CONCRETE - SEE DETAIL SHEETS
 - PRECAST HEADWALL STRUCTURE - SEE DETAIL SHEETS
 - CURB (SLOPE) OF NON-APPROPRIATE - SEE DETAIL SHEETS
 - WOOD & GRATE - SEE DETAIL SHEETS
 - SMALL GRATE (SLOPE) - SEE DETAIL SHEETS
 - DOUBLE GRATE (SLOPE) - SEE DETAIL SHEETS
 - MANHOLE (SLOPE) - SEE DETAIL SHEETS
 - OUTLET CONTROL STRUCTURE - SEE DETAIL SHEETS

- PIPE TYPE**
- 12" DIA. 15' SPAN. 15' SPAN. 15' SPAN.
 - 12" DIA. 15' SPAN. 15' SPAN. 15' SPAN.
 - 12" DIA. 15' SPAN. 15' SPAN. 15' SPAN.
 - 12" DIA. 15' SPAN. 15' SPAN. 15' SPAN.

GRADING/DRAINAGE PLAN LEGEND

(Symbol)	STATION NUMBER POINT
(Symbol)	MANHOLE BUSH/STORM MANHOLE
(Symbol)	STRUCTURE INDICATOR
(Symbol)	DOUBLE WING CATCH BASIN
(Symbol)	WINGLE WING CATCH BASIN
(Symbol)	SLOPE ARROW
(Symbol)	CONCRETE FLUME
(Symbol)	PRECAST HEADWALL STRUCTURE
(Symbol)	CURB (SLOPE) OF NON-APPROPRIATE
(Symbol)	WOOD & GRATE - SOOT 15" DIA
(Symbol)	SMALL GRATE (SLOPE)
(Symbol)	DOUBLE GRATE (SLOPE)
(Symbol)	MANHOLE (SLOPE)
(Symbol)	OUTLET CONTROL STRUCTURE
(Symbol)	FLUMED DHD SECTION
(Symbol)	TOP OF CURB
(Symbol)	TOP OF FINISHMENT

GRAPHIC SCALE



Wolvetton & Associates
Consulting Engineers & Land Surveyors
4142 Sandpoint Highway, Suite 202, Rapid City, South Dakota 57701
Phone: (605) 342-2830
www.wolvetton.com

PROPOSED BLACK HILLS CENTER
Walmart - # 3872-03
RAPID CITY, PENNINGTON COUNTY, S.D.
BY: THE STONERIDGE DEVELOPMENT, LLC
ST. LOUIS, MO

REVISIONS	BY

DRAWN BY: DMR
CHECKED BY: KJW
DATE: 08/24/2010
SCALE: 1" = 60'
JOB NO: 08-140
SHEET NUMBER: **C-2B**
OF SHEETS

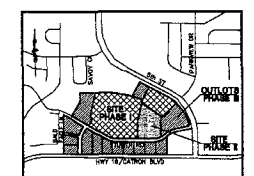
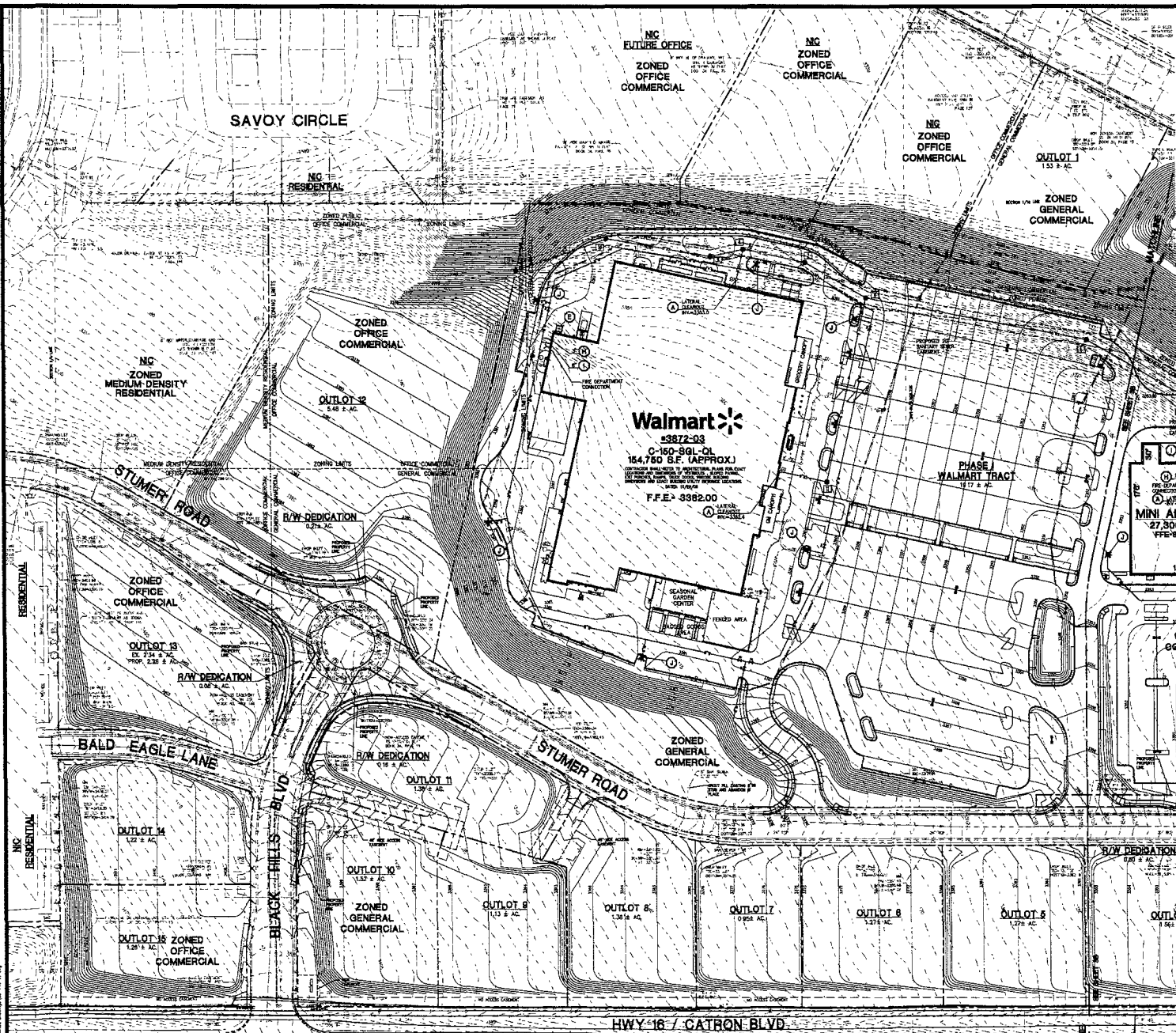

UTILITY LEGEND

1. SANITARY SEWER LATERAL AT MANHOLE 1 OR SEWER CONDUIT WITH...
2. GAS ENTRY WITH GAS METER AT READING CONTRACTOR RESPONSIBLE FOR INSTALLING COMPANY FOR THREE OF NECESSARY SIZES...
3. ELECTRIC CONDUIT TO BE COORDINATED WITH GAS COMPANY REGARDING THE SIZE AND INSTALLATION OF GAS SERVICE LINE...
4. RECONSTRUCT EXISTING SERVICE FROM PULL IN BUILDING CONSTRUCTION IF NECESSARY...
5. PROVIDED LOCATION OF TRANSFORMER PAD CONSTRUCTOR TO VERIFY EXACT LOCATION AND SIZE WITH POWER COMPANY PRIOR TO INSTALLATION...
6. CONSTRUCTOR RESPONSIBLE FROM DATE OF BEGINNING TO BE DETERMINED BY TELEPHONE COMPANY...
7. CONTRACTOR IS RESPONSIBLE TO COORDINATE WITH THE UTILITY COMPANIES FOR THE INSTALLATION OF OVERHEAD/UNDERGROUND ELECTRIC AND TELEPHONE LINES...
8. CONTRACTOR SHALL BE RESPONSIBLE TO COORDINATE WITH LOCAL WATER COMPANY REPRESENTATIVE...
9. CONTRACTOR SHALL BE RESPONSIBLE TO COORDINATE WITH LOCAL WATER COMPANY REPRESENTATIVE...
10. CONTRACTOR SHALL BE RESPONSIBLE TO COORDINATE WITH LOCAL WATER COMPANY REPRESENTATIVE...
11. CONTRACTOR SHALL BE RESPONSIBLE TO COORDINATE WITH LOCAL WATER COMPANY REPRESENTATIVE...
12. CONTRACTOR SHALL BE RESPONSIBLE TO COORDINATE WITH LOCAL WATER COMPANY REPRESENTATIVE...
13. CONTRACTOR SHALL BE RESPONSIBLE TO COORDINATE WITH LOCAL WATER COMPANY REPRESENTATIVE...
14. CONTRACTOR SHALL BE RESPONSIBLE TO COORDINATE WITH LOCAL WATER COMPANY REPRESENTATIVE...
15. CONTRACTOR SHALL BE RESPONSIBLE TO COORDINATE WITH LOCAL WATER COMPANY REPRESENTATIVE...

- UTILITY PLAN LEGEND**
- E— ELECTRICAL CONDUIT
 - G— GAS
 - W— WATER
 - S— SANITARY SEWER PIPE
 - P— WATER MAIN PIPE
 - C— SANITARY SEWER MANHOLE
 - S— GAS MANHOLE
 - T— TAPPING SWITCH CONDUIT
 - V— TAPPING SLEEVE & VALVE
 - V— WATER VALVE
 - T— FIRE HYDRANT
 - B— FIBER OPTIC BLEND
 - S— SANITARY TRENCH MANHOLE
 - P— POWER POLE
 - M— GAS METER



W
 Wolverson & Associates
 Consulting Engineers & Land Surveyors
 618 Number 10 Street
 Rapid City, SD 57701
 www.wolverson.com

PROPOSED BLACK HILLS CENTER
 Walmart # 3872-03
 RAPID CITY, PENNINGTON COUNTY, S.D.
 BY: THE STONERIDGE DEVELOPMENT, LLC
 ST. LOUIS, MO

REVISIONS	BY

DRAWN BY: DAN
 CHECKED BY: KJW
 DATE: 05/24/2010
 SCALE: 1" = 60'
 JOB NO.: 08-140
 SHEET NUMBER:

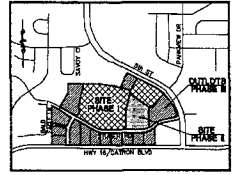
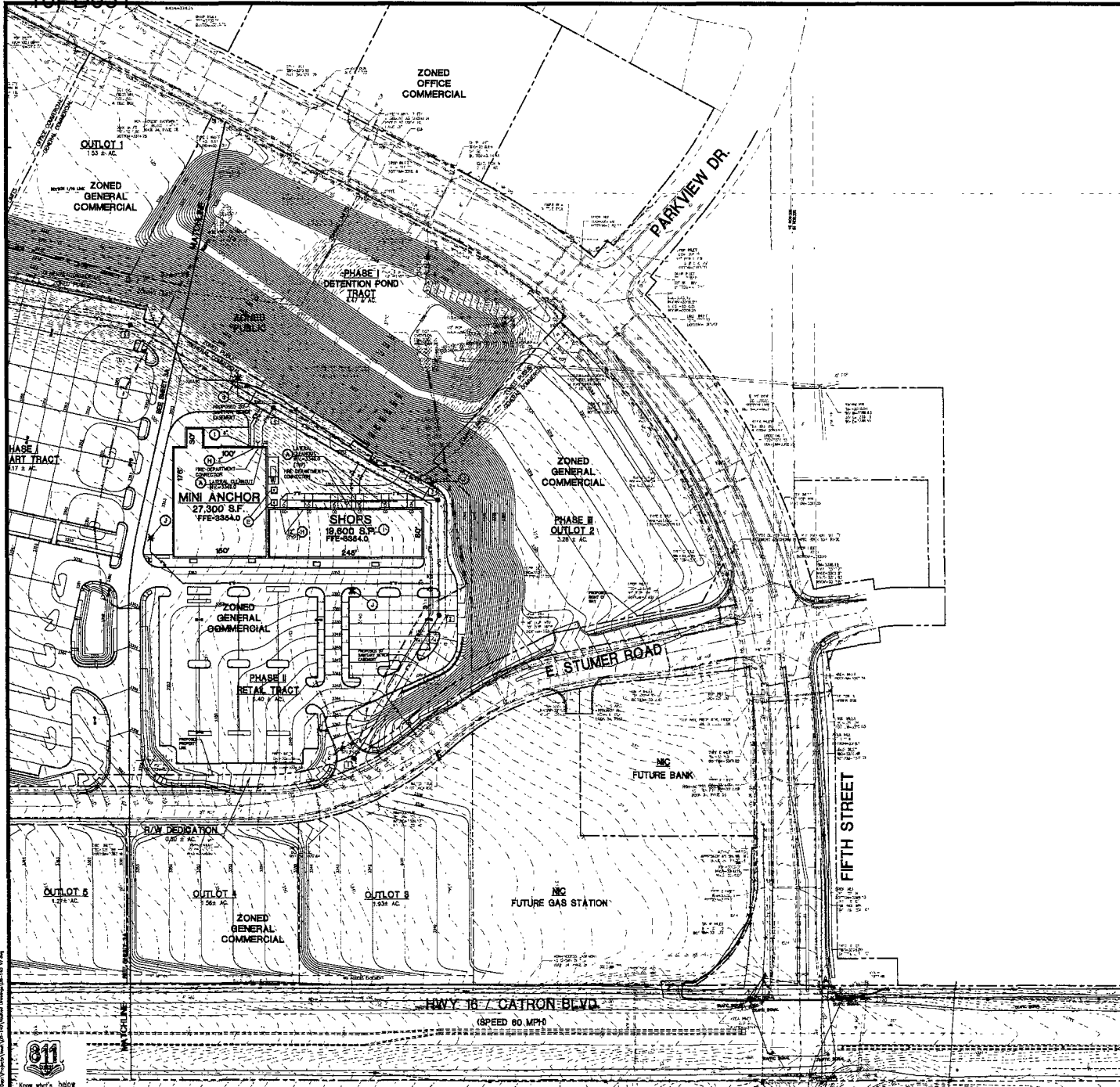

LOCATION MAP
NOT TO SCALE
THE SITE IS LOCATED ON THE SW 1/4 OF THE SE 1/4 OF THE SW 1/4 OF THE NW 1/4 AND IN THE SW 1/4 OF THE NW 1/4 OF THE NW 1/4 OF THE NW 1/4, SEC. 24, T. 22, S. 24, R. 24, MAP CITY, PENNINGTON COUNTY, ST. LOUIS, MO.

UTILITY LEGEND

- (A) SANITARY SEWER LATERAL, AT MINIMUM 1.0% SLOPE, COORDINATE WITH ARCHITECTURAL PLANS.
- (B) GAS ENTRY WITH GAS METER AT BUILDING. CONTRACTOR RESPONSIBLE FOR INSTALLING PER BUILDING SPECIFICATIONS AS SHOWN. CONTRACTOR SHALL COORDINATE WITH GAS COMPANY FOR TIME OF INDIVIDUAL METER.
- (C) COORDINATION IS RESPONSIBLE FOR COORDINATION WITH GAS COMPANY REGARDING THE SIZE AND INSTALLATION OF GAS SERVICE LINE.
- (D) UNDERGROUND ELECTRIC SERVICE FROM THE BUILDING CONTRACTOR IS RESPONSIBLE FOR ALL UNDERGROUND SERVICE. CONTRACTOR SHALL VERIFY SECONDARY CONTRACTOR'S DATE TIME SCHEDULES, ETC. WHICH MAY BE CHANGED BY ELECTRIC COMPANY. CONTRACTOR SHALL COORDINATE SAG WORK WITH POWER COMPANY. THE CONTRACTOR IN COORDINATION WITH THE UTILITY COMPANY SHALL DETERMINE THE HEIGHT OF UTILITY LINE HE IS TO PROVIDE OUTSIDE THE UTILITY COMPANY'S ALLOWANCE.
- (E) PROPOSED LOCATION OF TRANSFORMER PANEL CONTRACTOR TO VERIFY EXACT LOCATION. CONTRACTOR SHALL VERIFY WITH UTILITY COMPANY. CONTRACTOR SHALL BE RESPONSIBLE FOR INSTALLATION OF CONCRETE PAD, CONDUIT AND PIPE BOLLARDS AS REQUIRED BY THE ELECTRIC COMPANY. CONTRACTOR SHALL COORDINATE SAG WORK WITH THE ELECTRIC COMPANY.
- (F) UNDERGROUND TELEPHONE FROM PILES TO BUILDING TO BE PROVIDED BY TELEPHONE COMPANY. CONTRACTOR SHALL BE RESPONSIBLE FOR ANY UNDERGROUND SERVICE. CONTRACTOR SHALL VERIFY SECONDARY CONTRACTOR'S DATE TIME SCHEDULES, ETC. WHICH MAY BE CHANGED BY TELEPHONE COMPANY. CONTRACTOR SHALL COORDINATE WITH TELEPHONE COMPANY FOR SAG WORK. CONTRACTOR SHALL COORDINATE WITH TELEPHONE COMPANY FOR SAG WORK.
- (G) CONTRACTOR IS RESPONSIBLE FOR COORDINATION WITH THE UTILITY COMPANIES FOR THE INSTALLATION OF OVERHEAD/UNDERGROUND ELECTRIC AND TELEPHONE LINES TYPICAL OF THE AREA. CONTRACTOR SHALL VERIFY WITH UTILITY COMPANIES FOR SAG WORK. CONTRACTOR SHALL VERIFY WITH UTILITY COMPANIES FOR SAG WORK. CONTRACTOR SHALL VERIFY WITH UTILITY COMPANIES FOR SAG WORK.
- (H) CONTRACTOR SHALL VERIFY WITH LOCAL WATER COMPANY REQUIREMENTS. CONTRACTOR SHALL BE RESPONSIBLE FOR INSTALLING ANY APPROPRIATE OF THE DOMESTIC LINE IN SAG WORK. SAG WORK AS SHOWN ON PROVISION SERVICE GATE VALVES. ETC. WHICH MAY BE CHANGED BY CONTRACTOR WITH THE COMPANY.
- (I) CONTRACTOR SHALL BE RESPONSIBLE TO VERIFY ANY APPROPRIATE OF THE DOMESTIC LINE IN SAG WORK. SAG WORK AS SHOWN ON PROVISION SERVICE GATE VALVES. ETC. WHICH MAY BE CHANGED BY CONTRACTOR WITH THE COMPANY.
- (J) CONTRACTOR SHALL BE RESPONSIBLE TO VERIFY ANY APPROPRIATE OF THE DOMESTIC LINE IN SAG WORK. SAG WORK AS SHOWN ON PROVISION SERVICE GATE VALVES. ETC. WHICH MAY BE CHANGED BY CONTRACTOR WITH THE COMPANY.
- (K) CONTRACTOR SHALL BE RESPONSIBLE TO VERIFY ANY APPROPRIATE OF THE DOMESTIC LINE IN SAG WORK. SAG WORK AS SHOWN ON PROVISION SERVICE GATE VALVES. ETC. WHICH MAY BE CHANGED BY CONTRACTOR WITH THE COMPANY.
- (L) CONTRACTOR SHALL BE RESPONSIBLE TO VERIFY ANY APPROPRIATE OF THE DOMESTIC LINE IN SAG WORK. SAG WORK AS SHOWN ON PROVISION SERVICE GATE VALVES. ETC. WHICH MAY BE CHANGED BY CONTRACTOR WITH THE COMPANY.
- (M) CONTRACTOR SHALL BE RESPONSIBLE TO VERIFY ANY APPROPRIATE OF THE DOMESTIC LINE IN SAG WORK. SAG WORK AS SHOWN ON PROVISION SERVICE GATE VALVES. ETC. WHICH MAY BE CHANGED BY CONTRACTOR WITH THE COMPANY.
- (N) CONTRACTOR SHALL BE RESPONSIBLE TO VERIFY ANY APPROPRIATE OF THE DOMESTIC LINE IN SAG WORK. SAG WORK AS SHOWN ON PROVISION SERVICE GATE VALVES. ETC. WHICH MAY BE CHANGED BY CONTRACTOR WITH THE COMPANY.
- (O) CONTRACTOR SHALL BE RESPONSIBLE TO VERIFY ANY APPROPRIATE OF THE DOMESTIC LINE IN SAG WORK. SAG WORK AS SHOWN ON PROVISION SERVICE GATE VALVES. ETC. WHICH MAY BE CHANGED BY CONTRACTOR WITH THE COMPANY.
- (P) CONTRACTOR SHALL BE RESPONSIBLE TO VERIFY ANY APPROPRIATE OF THE DOMESTIC LINE IN SAG WORK. SAG WORK AS SHOWN ON PROVISION SERVICE GATE VALVES. ETC. WHICH MAY BE CHANGED BY CONTRACTOR WITH THE COMPANY.
- (Q) CONTRACTOR SHALL BE RESPONSIBLE TO VERIFY ANY APPROPRIATE OF THE DOMESTIC LINE IN SAG WORK. SAG WORK AS SHOWN ON PROVISION SERVICE GATE VALVES. ETC. WHICH MAY BE CHANGED BY CONTRACTOR WITH THE COMPANY.
- (R) CONTRACTOR SHALL BE RESPONSIBLE TO VERIFY ANY APPROPRIATE OF THE DOMESTIC LINE IN SAG WORK. SAG WORK AS SHOWN ON PROVISION SERVICE GATE VALVES. ETC. WHICH MAY BE CHANGED BY CONTRACTOR WITH THE COMPANY.
- (S) CONTRACTOR SHALL BE RESPONSIBLE TO VERIFY ANY APPROPRIATE OF THE DOMESTIC LINE IN SAG WORK. SAG WORK AS SHOWN ON PROVISION SERVICE GATE VALVES. ETC. WHICH MAY BE CHANGED BY CONTRACTOR WITH THE COMPANY.
- (T) CONTRACTOR SHALL BE RESPONSIBLE TO VERIFY ANY APPROPRIATE OF THE DOMESTIC LINE IN SAG WORK. SAG WORK AS SHOWN ON PROVISION SERVICE GATE VALVES. ETC. WHICH MAY BE CHANGED BY CONTRACTOR WITH THE COMPANY.
- (U) CONTRACTOR SHALL BE RESPONSIBLE TO VERIFY ANY APPROPRIATE OF THE DOMESTIC LINE IN SAG WORK. SAG WORK AS SHOWN ON PROVISION SERVICE GATE VALVES. ETC. WHICH MAY BE CHANGED BY CONTRACTOR WITH THE COMPANY.
- (V) CONTRACTOR SHALL BE RESPONSIBLE TO VERIFY ANY APPROPRIATE OF THE DOMESTIC LINE IN SAG WORK. SAG WORK AS SHOWN ON PROVISION SERVICE GATE VALVES. ETC. WHICH MAY BE CHANGED BY CONTRACTOR WITH THE COMPANY.
- (W) CONTRACTOR SHALL BE RESPONSIBLE TO VERIFY ANY APPROPRIATE OF THE DOMESTIC LINE IN SAG WORK. SAG WORK AS SHOWN ON PROVISION SERVICE GATE VALVES. ETC. WHICH MAY BE CHANGED BY CONTRACTOR WITH THE COMPANY.
- (X) CONTRACTOR SHALL BE RESPONSIBLE TO VERIFY ANY APPROPRIATE OF THE DOMESTIC LINE IN SAG WORK. SAG WORK AS SHOWN ON PROVISION SERVICE GATE VALVES. ETC. WHICH MAY BE CHANGED BY CONTRACTOR WITH THE COMPANY.
- (Y) CONTRACTOR SHALL BE RESPONSIBLE TO VERIFY ANY APPROPRIATE OF THE DOMESTIC LINE IN SAG WORK. SAG WORK AS SHOWN ON PROVISION SERVICE GATE VALVES. ETC. WHICH MAY BE CHANGED BY CONTRACTOR WITH THE COMPANY.
- (Z) CONTRACTOR SHALL BE RESPONSIBLE TO VERIFY ANY APPROPRIATE OF THE DOMESTIC LINE IN SAG WORK. SAG WORK AS SHOWN ON PROVISION SERVICE GATE VALVES. ETC. WHICH MAY BE CHANGED BY CONTRACTOR WITH THE COMPANY.

UTILITY PLAN LEGEND

- 12" FEDERAL CONDUIT
- 12" TELEPHONE CONDUIT
- 12" SANITARY SEWER PIPE
- 12" WATER MAIN PIPE
- 12" DOMESTIC WATER PIPING
- GAS PIPE
- TAMPER SWITCH CONDUIT
- ⊕ TAPPING SLAVE & VALVE
- ⊕ WATER VALVE
- ⊕ FIRE HYDRANT
- ⊕ TAMPER BLOCK
- ⊕ SANITARY SEWER MANHOLE
- ⊕ POWER POLE
- ⊕ GAS METER

UTILITY PLAN

GRAPHIC SCALE



Wolverton & Associates
Consulting Engineers & Land Surveyors
1000 N. 10th Street
St. Louis, MO 63101
www.wolverton.com

PROPOSED BLACK HILLS CENTER
Walmart # 3872-03
RAPID CITY, PENNINGTON COUNTY, S.D.
BY: THF, STONERIDGE DEVELOPMENT, LLC
ST. LOUIS, MO

REVISIONS | BY

DRAWN BY: DWN
CHECKED BY: KJW
DATE: 08/24/2010
SCALE: 1" = 80'
JOB NO: 08-140
SHEET NUMBER

C-3B

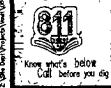

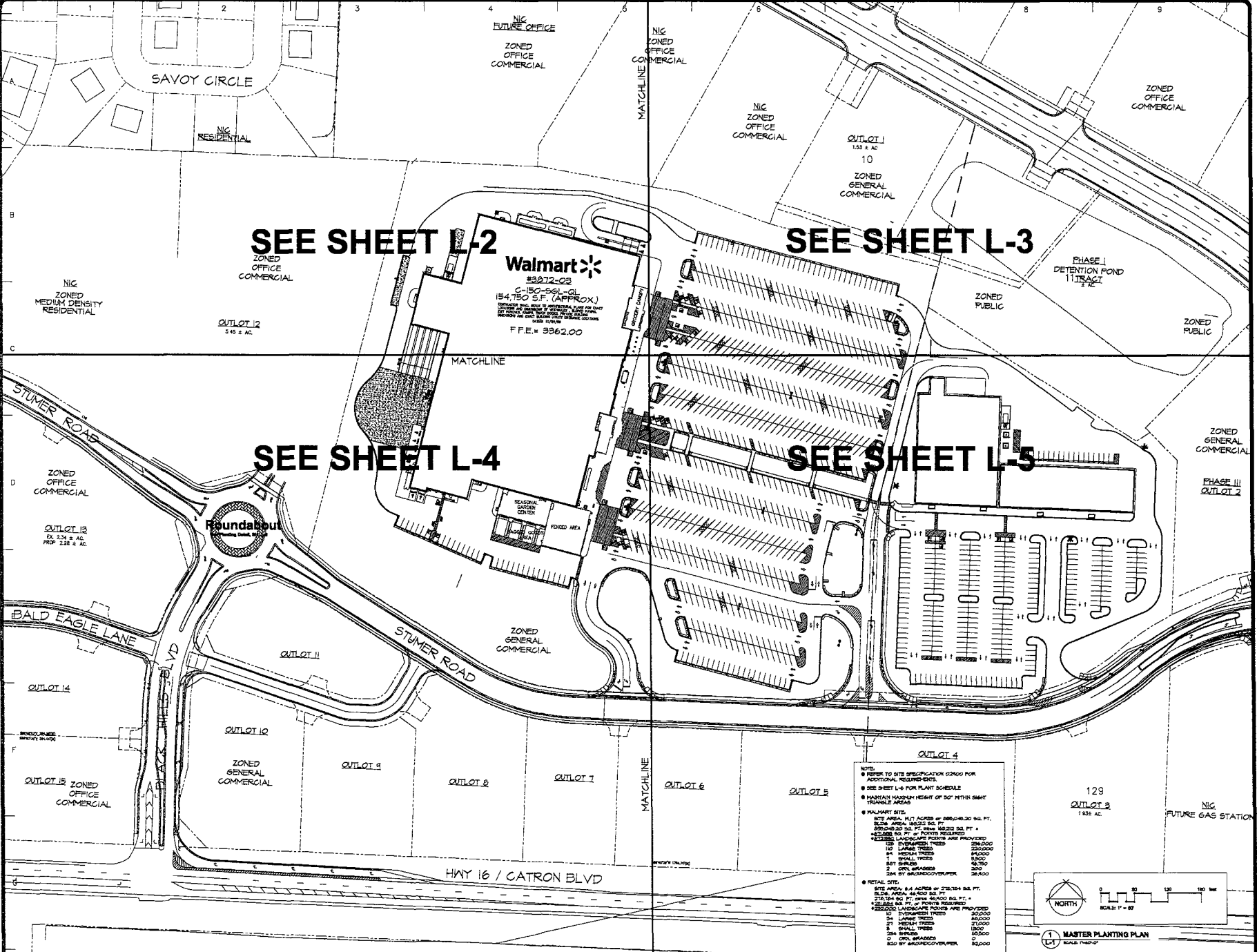

SEE SHEET L-2

SEE SHEET L-3

SEE SHEET L-4

SEE SHEET L-5

Walmart
 #3872-03
 C-150-561-01
 154,750 S.F. (APPROX.)
 F.F.E. = 3362.00

Foundation
 Learning Center

- OUTLOT 4**
- NOTES:**
- 1. REFER TO SITE SPECIFICATION 02000 FOR ADDITIONAL REQUIREMENTS.
 - 2. SEE SHEET L-6 FOR PLANT SCHEDULE.
 - 3. MAINTAIN MAXIMUM HEIGHT OF 50' WITHIN SHADY TRAVEL AREAS.
 - 4. WALMART SITE:
 SITE AREA: 14.17 ACRES @ 200,000 SQ. FT.
 12.74 ACRES @ 252,000 SQ. FT.
 1.43 ACRES @ 322,500 SQ. FT.
 22,000 SQ. FT. @ 20' SPACING REQUIRED
 - 5. LANDSCAPE POINTS ARE PROVIDED:
 120 1" DIAMETER TREES 200,000
 100 LARGE TREES 200,000
 84 MEDIUM TREES 84,000
 501 SMALL TREES 50,100
 234 2" DIAMETER TREES 234,000
 234 2" DIAMETER TREES 234,000
 - 6. RETAIL SITE:
 SITE AREA: 4.4 ACRES @ 220,000 SQ. FT.
 12.74 ACRES @ 252,000 SQ. FT.
 1.43 ACRES @ 322,500 SQ. FT.
 22,000 SQ. FT. @ 20' SPACING REQUIRED
 - 7. LANDSCAPE POINTS ARE PROVIDED:
 120 1" DIAMETER TREES 200,000
 100 LARGE TREES 200,000
 84 MEDIUM TREES 84,000
 501 SMALL TREES 50,100
 234 2" DIAMETER TREES 234,000
 234 2" DIAMETER TREES 234,000

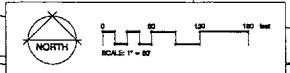

MASTER PLANTING PLAN
 L-1

REVISIONS	BY
4/20/10	1041
8/28/10	1041

PRELIMINARY PLANTING PLAN FOR THE PROPOSED
Black Hills Center
WAL-MART #3872-03
RAPID CITY, PENNINGTON COUNTY, SOUTH DAKOTA

LandscAPE TECHNOLOGIES
 2100 S. UNIVERSITY AVENUE
 SUITE 100
 RAPID CITY, SD 57701
 TEL: 605-342-2200
 FAX: 605-342-2200
 WWW.LANDSCAPETECH.COM

DRAWN BY: MCH
 CHECKED BY: MCH
 DATE: 8/28/10
 SCALE: 1" = 50'
 SHEET: L-1
 OF SEVEN SHEETS

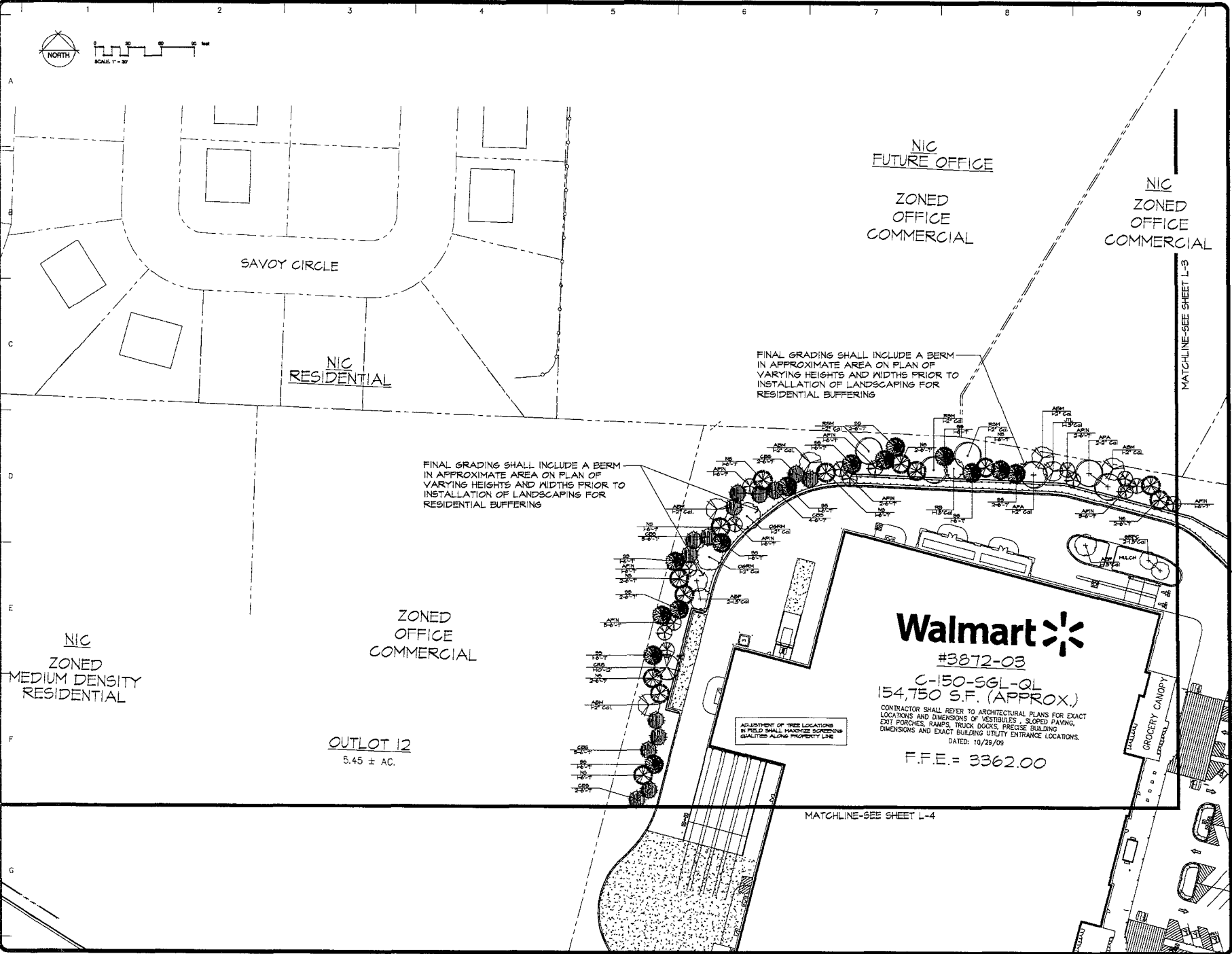
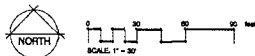

FINAL GRADING SHALL INCLUDE A BERM IN APPROXIMATE AREA ON PLAN OF VARYING HEIGHTS AND WIDTHS PRIOR TO INSTALLATION OF LANDSCAPING FOR RESIDENTIAL BUFFERING

FINAL GRADING SHALL INCLUDE A BERM IN APPROXIMATE AREA ON PLAN OF VARYING HEIGHTS AND WIDTHS PRIOR TO INSTALLATION OF LANDSCAPING FOR RESIDENTIAL BUFFERING

Walmart *

#3872-03
C-150-SGL-QL
154,750 S.F. (APPROX.)

CONTRACTOR SHALL REFER TO ARCHITECTURAL PLANS FOR EXACT LOCATIONS AND DIMENSIONS OF VESTIBULES, SLOPED PAVING, EXIT PORCHES, RAMPS, TRUCK DOCKS, PRECISE BUILDING DIMENSIONS AND EXACT BUILDING UTILITY ENTRANCE LOCATIONS.
DATED: 10/28/09

F.F.E. = 3362.00

ADJUSTMENT OF TREE LOCATIONS IN FIELD SHALL MAINTAIN SCREENING QUALITY ALONG PROPERTY LINE

REVISIONS	BY
4/20/10	RPM
5/28/10	RPM

Landscape
TECHNOLOGIES

5500 13th Avenue SW
Edmonton, Alberta T6C 2G2
Tel: (780) 443-0000

**PRELIMINARY PLANTING PLAN FOR THE PROPOSED
Black Hills Center
WAL-MART #3872-03
RAPID CITY, PENNINGTON COUNTY, SOUTH DAKOTA**

DRAWN	BY
CHECKED	DATE
DATE	SHEET
SCALE	OF
PROJECT	NO.
DATE	BY
NO.	OF
SHEET	NO.
L-2	OF



MATCHLINE-SEE SHEET L-2

NIC
ZONED
OFFICE
COMMERCIAL

NIC
ZONED
OFFICE
COMMERCIAL

OUTLOT 1
1.53 ± AC.
10
ZONED
GENERAL
COMMERCIAL

ZONED
OFFICE
COMMERCIAL

PHASE I
DETENTION POND
11 TRACT
± AC.

ZONED
PUBLIC

ZONED
PUBLIC

ADJUSTMENT OF TREE LOCATIONS
IN FIELD SHALL MAXIMIZE SCREENING
QUALITIES ALONG PROPERTY LINE

MATCHLINE-SEE SHEET L-3

REVISIONS	BY
4/30/10	RPM
5/26/10	RPM

Landscape TECHNOLOGIES
 4000 13th Ave SW
 Rapid City, SD 57701
 P: 605/342-2200
 F: 605/342-2202

PRELIMINARY PLANTING PLAN FOR THE PROPOSED
Black Hills Center
 WAL-MART #3872-03
 RAPID CITY, PENNINGTON COUNTY, SOUTH DAKOTA

DRAWN BY: MARCH
 CHECKED BY: JAMES
 DATE: 5/10/10
 SCALE: 1" = 30'
 SHEET NO.: 10PD031-03
 SHEET:
3
 OF SEVEN SHEETS

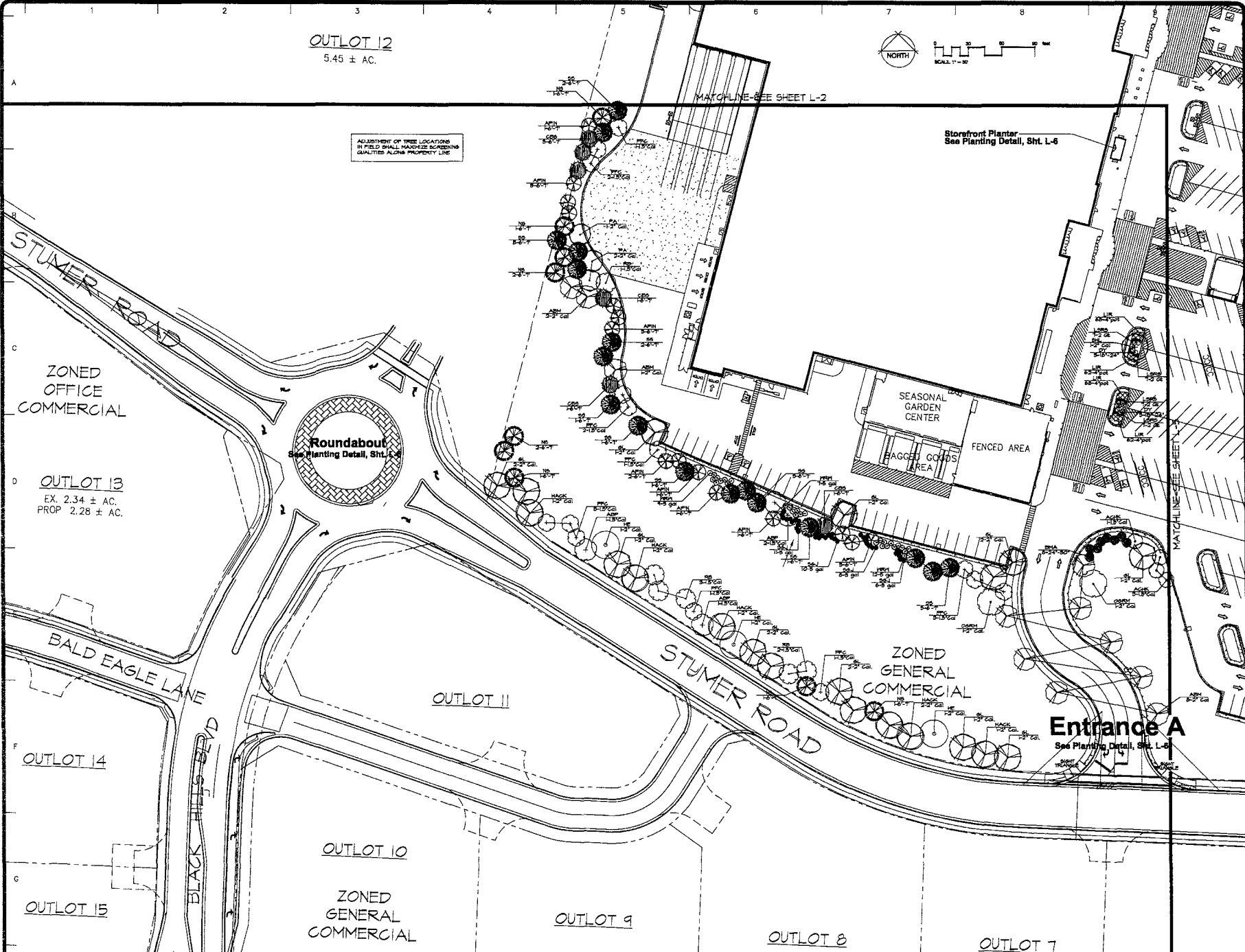

OUTLOT 12
5.45 ± AC.

ADJUSTMENT OF TREE LOCATIONS
IN FIELD SHALL MAXIMIZE SCREENING
QUALITIES ALONG PROPERTY LINE

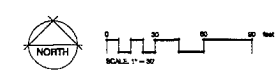

STUMER ROAD

ZONED
OFFICE
COMMERCIAL

Roundabout
See Planting Detail, Sht. L-6

OUTLOT 13
EX. 2.34 ± AC.
PROP. 2.28 ± AC.

BALD EAGLE LANE

OUTLOT 11

STUMER ROAD

ZONED
GENERAL
COMMERCIAL

Entrance A
See Planting Detail, Sht. L-6

OUTLOT 14

OUTLOT 10

ZONED
GENERAL
COMMERCIAL

OUTLOT 9

OUTLOT 8

OUTLOT 7

OUTLOT 15

BLACK HILLS BEND

REVISIONS	BY
4/20/10	RW
5/26/10	RW

LandscAPE
TECHNOLOGIES
1601 25th Street
 St. Cloud, MN 56301
 Phone: (828) 438-2800

PRELIMINARY PLANTING PLAN FOR THE PROPOSED
Black Hills Center
 WAL-MART #3872-03
 RAPID CITY, PENNINGTON COUNTY, SOUTH DAKOTA

DRAWN PLANNED CHECKED REVIEWED DATE SCALE SHEET NO. OF TOTAL SHEETS	RW RW RW RW 05/10 1" = 30'-0" 25 OF 28 L4 OF SEVEN SHEETS
--	---

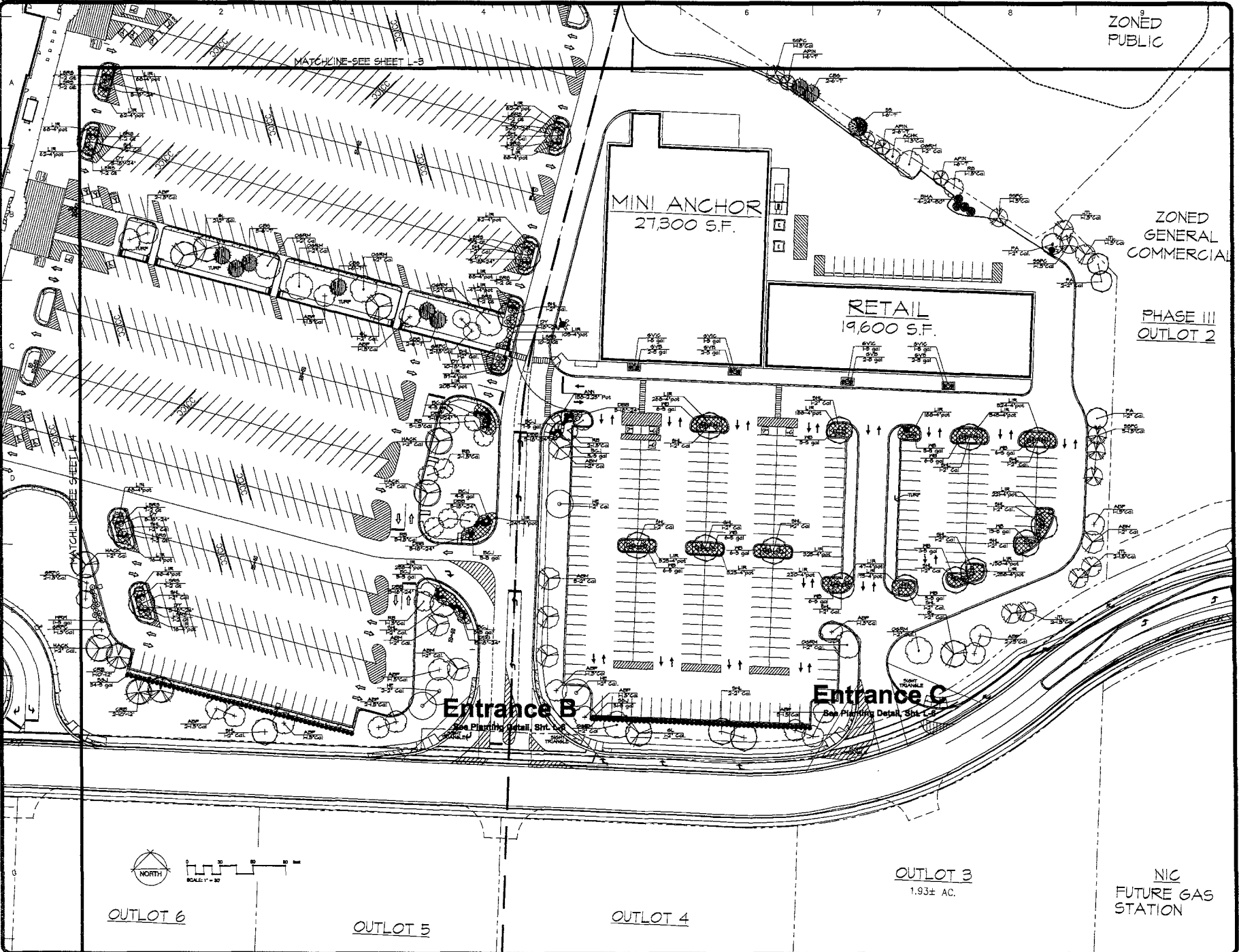

REVISIONS	BY

landscape TECHNOLOGIES

47 JOHNSON CIRCLE, DUNDAGE, IOWA 52008
 P: 562-220-2200 F: 562-220-2202

PRELIMINARY PLANTING PLAN FOR THE PROPOSED
Black Hills Center
 WAL-MART #3872-03
 RAPID CITY, PENNINGTON COUNTY, SOUTH DAKOTA

DRAIN
 K. HANSEN
 CHECKED
 REVALS
 DATE
 DRAWN
 SCALE
 PROJECT
 JOB NO.
 SHEET
L-5
 OF 25/26 SHEETS

LANDSCAPE GUIDELINE SPEC:

GENERAL:

- All natural vegetation shall be maintained where it does not interfere with construction or the permanent post of operation. If any effort possible shall be made to protect existing structures from damage by root penetration or insect activity. Structural shall be marked and protected and marked against entry to plants. All other site related work being performed by other contractors shall be coordinated with the landscape contractor. The landscape contractor shall be responsible for the protection of existing structures, utilities and other facilities, structures and utilities that are considered appropriate and any that do not have to be removed or altered in the course of the construction shall be the responsibility of the contractor. A tree shall not be planted in the same location as a tree that has been removed. The landscape contractor shall be responsible for the protection of existing structures, utilities and other facilities, structures and utilities that are considered appropriate and any that do not have to be removed or altered in the course of the construction shall be the responsibility of the contractor. A tree shall not be planted in the same location as a tree that has been removed.

- It shall be the landscape contractor's responsibility to:
 - Verify all existing and proposed facilities, structures and utilities prior to commencement of work.
 - Protect all structures, utilities and other facilities, structures and utilities that are considered appropriate and any that do not have to be removed or altered in the course of the construction shall be the responsibility of the contractor. A tree shall not be planted in the same location as a tree that has been removed.
 - Verify that all proposed plant material is of suitable size and quantity for the project and that it is suitable for the site conditions. The contractor shall be responsible for the protection of existing structures, utilities and other facilities, structures and utilities that are considered appropriate and any that do not have to be removed or altered in the course of the construction shall be the responsibility of the contractor. A tree shall not be planted in the same location as a tree that has been removed.

MISC:

- All trees to be planted shall be installed at 4" depth (other than 1/2" drip emitter). Install shall be clean and free of all foreign material, including weeds, roots, debris, etc. All trees to be planted shall be installed at 4" depth (other than 1/2" drip emitter). Install shall be clean and free of all foreign material, including weeds, roots, debris, etc.

TOPSOIL:

- Topsoil shall be as proposed landscape plan and shall be 6" thick. Topsoil shall be as proposed landscape plan and shall be 6" thick. Topsoil shall be as proposed landscape plan and shall be 6" thick.

MISC. MATERIALS:

- Provide stakes and fasteners of sound, non-harmful, free of insecticide and debris. Provide stakes and fasteners of sound, non-harmful, free of insecticide and debris.

MAINTENANCE:

- Landscape Contractor shall provide a separate proposal to maintain all plants, shrubs, groundcover, perennials and annuals for a period of 12 months after acceptance. Landscape Contractor shall provide a separate proposal to maintain all plants, shrubs, groundcover, perennials and annuals for a period of 12 months after acceptance.

ADDITIONAL TERRACE NOTES:

- All landscaped areas are to receive a minimum of 4" topsoil. See 2000 Specification. All plant material shall be healthy, vigorous and free of pests and diseases. All plant material shall be healthy, vigorous and free of pests and diseases.

PLANT SCHEDULE

TREES	QTY	BOTANICAL NAME / COMMON NAME	SIZE
RSM	2	Acer rubrum 'Franksred' / Red Sunset Maple	2' Cal.
OSRM	11	Acer rubrum 'October Glory' / October Glory Maple	2' Cal.
ABM	25	Acer x freemanii 'Jeffersred' / Autumn Blaze Maple	2' Cal.
CRB	4	Betula nigra 'Cully' / Heritage River Birch	10'-12"
HACK	7	Celtis occidentalis / Common Hackberry	2' Cal.
APA	10	Fraxinus americana 'Autumn Purple' / Autumn Purple Ash	2' Cal.
FL	28	Fraxinus pennsylvanica 'Patmore' / Patmore Ash	2' Cal.
SH	18	Gleditsia triacanthos 'Skyline' / Skyline Locust	2' Cal.
SL	17	Tilia cordata 'Greenspire' / Greenspire Littleleaf Linden	2' Cal.
GE	19	Ulmus 'Homestead' / Homestead Elm	2' Cal.
EVERGREEN TREES	QTY	BOTANICAL NAME / COMMON NAME	SIZE
NV	25	Picea abies / Norway Spruce	6'-7'
SS	37	Picea amara / Serbian Spruce	6'-7'
CBS	31	Picea pungens 'Glauca' / Colorado Blue Spruce	6'-7'
APIN	39	Pinus nigra / Austrian Pine	6'-7'
FLOWERING TREES	QTY	BOTANICAL NAME / COMMON NAME	SIZE
RB	19	Cercis canadensis / Redbud	1.5' Cal.
GRFC	15	Malus 'Golden Raindrops' / Golden Raindrops Flowering Crab	1.5' Cal.
PFC	15	Malus 'Prairie Fire' / Prairie Fire Flowering Crab	1.5' Cal.
SGFC	10	Malus 'Spring Snow' / Spring Snow Flowering Crab	1.5' Cal.
ACHK	10	Pyrus calleryana 'Autumn Blaze' / Autumn Blaze Pear	1.5' Cal.
ABP	29	Syringa reticulata 'Ivory Silk' / Ivory Silk Japanese Tree Lilac	1.5' Cal.
JTL	10	Syringa reticulata 'Ivory Silk' / Ivory Silk Japanese Tree Lilac	1.5' Cal.
SHRUBS	QTY	BOTANICAL NAME / COMMON NAME	SIZE
GVV	8	Buxus 'Green Velvet' / Green Velvet Boxwood	5 gal.
WB	11	Buxus microphylla 'Wintergreen' / Wintergreen Boxwood	5 gal.
DEB	34	Evyonymus alatus 'Compactus' / Compact Burning Bush	18"-24"
FOR	84	Forsythia intermedia 'Northern Gold' / Northern Gold Forsythia	5 gal.
LH	140	Hydrangea paniculata 'Limelight' TM / Limelight Hydrangea	5 gal.
B-GJ	62	Juniperus chinensis 'Sea Green' / Sea Green Juniper	5 gal.
B-GJ	62	Juniperus horizontalis 'Blue Chip' / Blue Chip Juniper	5 gal.
GVIC	60	Ligustrum vicaryi / Golden Privet	5 gal.
PSC	7	Prunus X cistena / Purple Sand Cherry	24"-30"
MKL	18	Syringa pavia 'Miss Kim' / Miss Kim Lilac	5 gal.
DY	127	Taxus media 'Densiformis' / Dense Yew	18"-24"
BMA	13	Viburnum dentatum 'Blue Muffin' / Blue Muffin Arrowwood	24"-30"
MRA	39	Meigelia florida 'Nine & Roses' / Nine & Roses Meigelia	5 gal.
ANNUALS/PERENNIALS	QTY	BOTANICAL NAME / COMMON NAME	SIZE
ART	16	Artemisia schmidtiana 'Silver Mound' / Silver Mound Artemisia	1 gal.
AST	18	Aster novae-angliae 'Purple Dome' / Purple Dome Aster	1 gal.
HRD	277	Hemerocallis hybrid 'Happy Returns' / Happy Returns Daylily	1 gal.
LSRS	178	Ferovskia atriplicifolia 'Little Spire' TM / Little Spire Russian Sage	2 Qt.
GRASSES	QTY	BOTANICAL NAME / COMMON NAME	SIZE
MLMS	2	Miscanthus sinensis 'Morning Light' / Morning Light Maiden Grass	5 gal.
GROUND COVERS	QTY	BOTANICAL NAME / COMMON NAME	SIZE
	4,860	Liriope spicata / Creeping Liriope	4" pot @ 12" oc
	2,880	Min. of Five Varieties / Mixed Annuals	2.25" Pot @ 12" oc

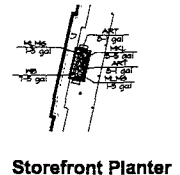
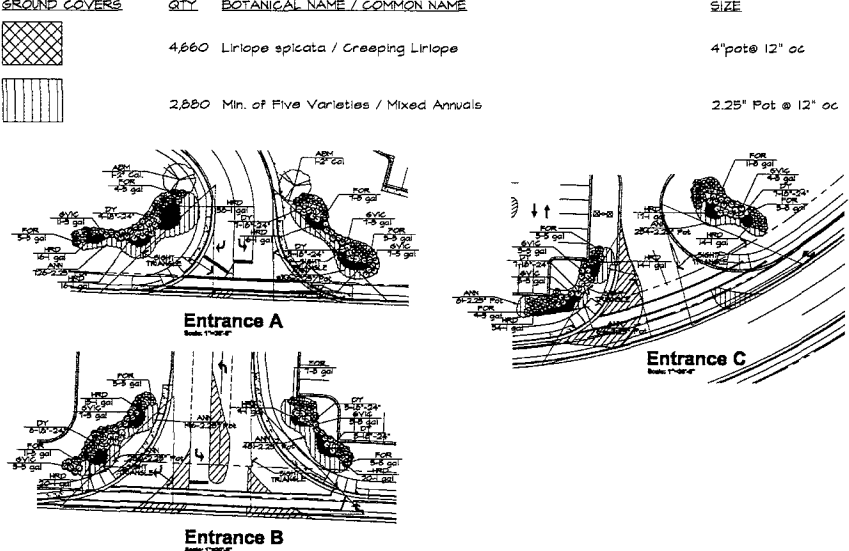
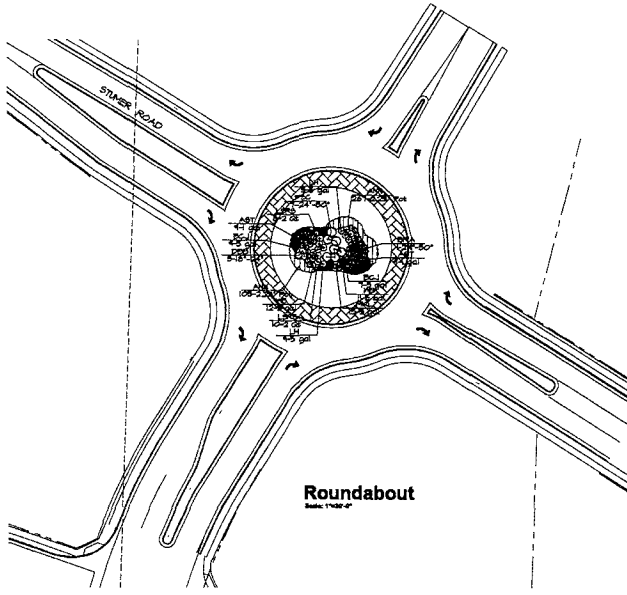

REVISIONS	BY
4/22/10	RKH
5/26/10	RKH

landscape TECHNOLOGIES
 1005 E. Broadway, Suite 100
 Rapid City, SD 57701
 P: 605-223-8888
 F: 605-223-8889

**PRELIMINARY PLANTING PLAN FOR THE PROPOSED
 Black Hills Center
 WAL-MART #3872-03
 RAPID CITY, PENNINGTON COUNTY, SOUTH DAKOTA**

DRAN
 1005 E. Broadway, Suite 100
 Rapid City, SD 57701
 P: 605-223-8888
 F: 605-223-8889

REVISIONS	BY
4/20/10	RFH
5/26/10	RFH

landscape TECHNOLOGIES
 1000 13th Street NW
 Rapid City, SD 57701
 Phone: (605) 342-0000
 Fax: (605) 342-0000

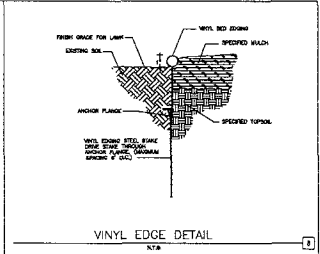

1. FINISH GRADE
 2. BACKFILL WITH PREPARED PLANTING SOIL MIX AS SPECIFIED
 3. 1/2" CLEAN SAND COMPACTED AGAINST EXISTING CURB TO TOP OF ROOTBALL IS AT LEAST 1" ABOVE FINISHED GRADE
 4. FILTER CLOTH
 5. SLOPE BOTTOM TO DRAIN
 6. 16" ASSURED HOLE PENETRATES THROUGH OCCURRING LAYER TO WATER TABLE OR TO A DEPTH OF 3' TO ASSURE PROPER FLOODING
 7. ROOTBALL WITH 1/2" - 3/4" DRILL
 8. WATER TABLE
- FOR A PARKING ISLAND PLANTING STRIP, CONTRACTOR TO BACKFILL ENTIRE LENGTH OF PLANTING AREA TO WITHIN 8" OF DRAINAGE CURB.

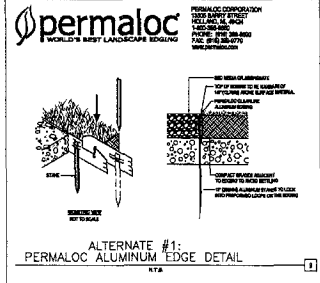

1. TOP OF SHRUB ROOTBALLS TO BE PLANTED 1" - 2" FROM WET SOIL MOVING UP TO THE TOP OF ROOTBALL
2. WHEN USED IN MASSES - PRUNE ALL SHRUBS TO ACHIEVE A UNIFORM MASS EFFECT
3. 4" MINIMUM OF HARDWOOD BARK MULCH COMPACTED OR AS SPECIFIED
4. EXCAVATE ENTIRE BED SPECIFIED FOR DRAINAGE BED
5. 4" MINIMUM OF TOPSOIL TO BRING TO FINISHED GRADE (SEE GRADING PLAN)
6. PREPARED PLANTING SOIL AS SPECIFIED. NOTE: WHEN GRASS/COVERS AND SHRUBS USED IN MASSES, ENTIRE BED TO BE AMENDED WITH PLANTING SOIL MIX AS SPECIFIED
7. SCARIFY ROOTBALL SIDES AND BOTTOM

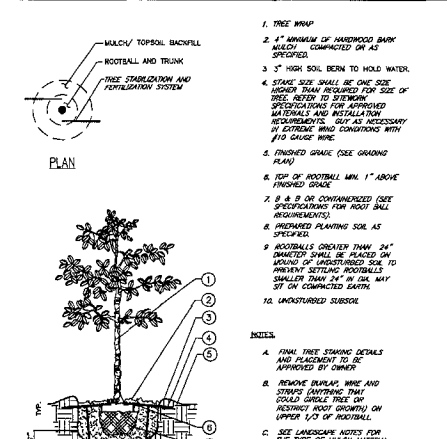
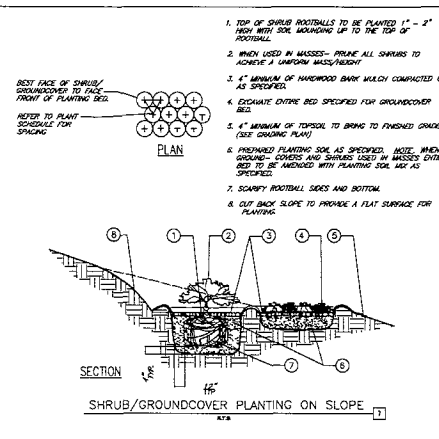
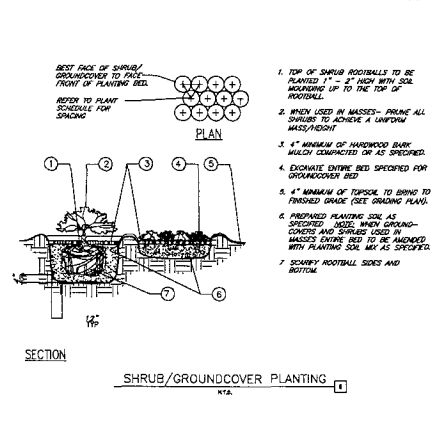
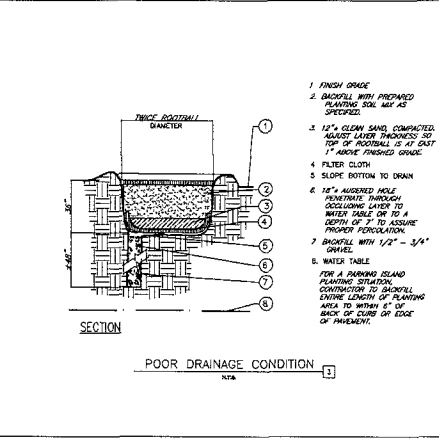

1. FINISH GRADE
 2. 4" MINIMUM OF HARDWOOD BARK MULCH COMPACTED OR AS SPECIFIED
 3. 3" HIGH SOIL BERM TO HOLD WATER
 4. STAKE SIZE SHALL BE ONE SIZE HIGHER THAN REQUIRED FOR SIZE OF TREE. REFER TO SPECIFICATIONS FOR APPROVED MATERIALS AND INSTALLATION REQUIREMENTS. CUT AS NECESSARY IN EXTREME WIND CONDITIONS WITH #10 GAUGE WIRE
 5. FINISHED GRADE (SEE GRADING PLAN)
 6. TOP OF ROOTBALL MIN. 1" ABOVE FINISHED GRADE
 7. 8" B OR CONTINGENT (SEE SPECIFICATIONS FOR ROOT BALL REQUIREMENTS)
 8. PREPARED PLANTING SOIL AS SPECIFIED
 9. ROOTBALLS GREATER THAN 24" DIAMETER SHALL BE PLACED ON MOUND OF UNDISTURBED SOIL TO PREVENT SETTLING. ROOTBALLS SMALLER THAN 24" IN DIA. MAY SET ON COMPACTED EARTH
 10. UNDISTURBED SUBGRADE
- NOTES:**
- A. FINAL TREE STAKING DETAILS AND PLACEMENT TO BE APPROVED BY OWNER
 - B. REMOVE BURGLAR WIRE AND STRAPS (ANYTHING THAT COULD RESTRICT ROOT GROWTH) ON UPPER 1/3 OF ROOTBALL
 - C. SEE LANDSCAPE NOTES FOR THE TYPE OF MULCH MATERIAL TO USE
 - D. PRUNE TREE AS DIRECTED BY LANDSCAPE ARCHITECT
 - E. BRANCHING HEIGHT TO A.A.N. STANDARDS

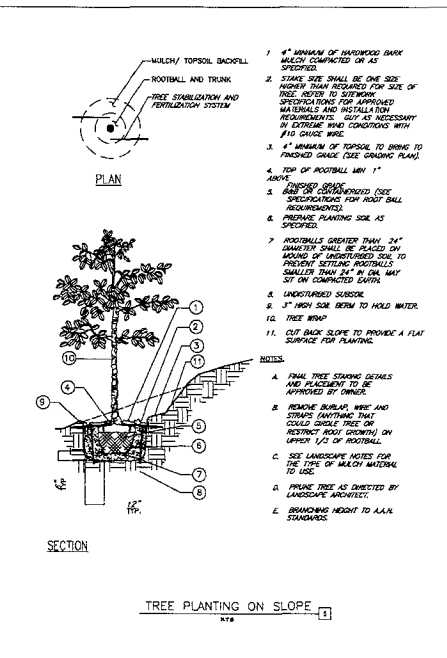

1. FINISH GRADE
 2. 4" MINIMUM OF HARDWOOD BARK MULCH COMPACTED OR AS SPECIFIED
 3. 3" HIGH SOIL BERM TO HOLD WATER
 4. TREE WRP
 5. FINISHED GRADE
 6. 8" B OR CONTINGENT (SEE SPECIFICATIONS FOR ROOT BALL REQUIREMENTS)
 7. PREPARED PLANTING SOIL AS SPECIFIED
 8. UNDISTURBED SUBGRADE
 9. 3" HIGH SOIL BERM TO HOLD WATER
 10. TREE WRP
 11. CUT BACK SLOPE TO PROVIDE A FLAT SURFACE FOR PLANTING
- NOTES:**
- A. FINAL TREE STAKING DETAILS AND PLACEMENT TO BE APPROVED BY OWNER
 - B. REMOVE BURGLAR WIRE AND STRAPS (ANYTHING THAT COULD RESTRICT ROOT GROWTH) ON UPPER 1/3 OF ROOTBALL
 - C. SEE LANDSCAPE NOTES FOR THE TYPE OF MULCH MATERIAL TO USE
 - D. PRUNE TREE AS DIRECTED BY LANDSCAPE ARCHITECT
 - E. BRANCHING HEIGHT TO A.A.N. STANDARDS

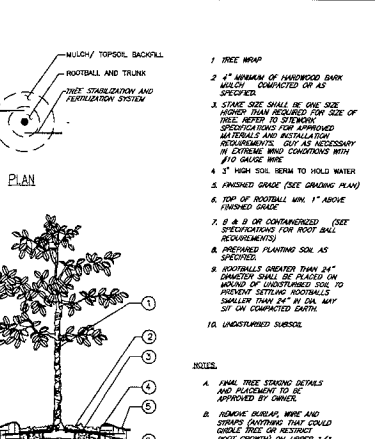

1. FINISH GRADE
 2. 4" MINIMUM OF HARDWOOD BARK MULCH COMPACTED OR AS SPECIFIED
 3. 3" HIGH SOIL BERM TO HOLD WATER
 4. STAKE SIZE SHALL BE ONE SIZE HIGHER THAN REQUIRED FOR SIZE OF TREE. REFER TO SPECIFICATIONS FOR APPROVED MATERIALS AND INSTALLATION REQUIREMENTS. CUT AS NECESSARY IN EXTREME WIND CONDITIONS WITH #10 GAUGE WIRE
 5. FINISHED GRADE (SEE GRADING PLAN)
 6. TOP OF ROOTBALL MIN. 1" ABOVE FINISHED GRADE
 7. 8" B OR CONTINGENT (SEE SPECIFICATIONS FOR ROOT BALL REQUIREMENTS)
 8. PREPARED PLANTING SOIL AS SPECIFIED
 9. ROOTBALLS GREATER THAN 24" DIAMETER SHALL BE PLACED ON MOUND OF UNDISTURBED SOIL TO PREVENT SETTLING. ROOTBALLS SMALLER THAN 24" IN DIA. MAY SET ON COMPACTED EARTH
 10. UNDISTURBED SUBGRADE
- NOTES:**
- A. FINAL TREE STAKING DETAILS AND PLACEMENT TO BE APPROVED BY OWNER
 - B. REMOVE BURGLAR WIRE AND STRAPS (ANYTHING THAT COULD RESTRICT ROOT GROWTH) ON UPPER 1/3 OF ROOTBALL
 - C. SEE LANDSCAPE NOTES FOR THE TYPE OF MULCH MATERIAL TO USE
 - D. PRUNE TREE AS DIRECTED BY LANDSCAPE ARCHITECT
 - E. BRANCHING HEIGHT TO A.A.N. STANDARDS

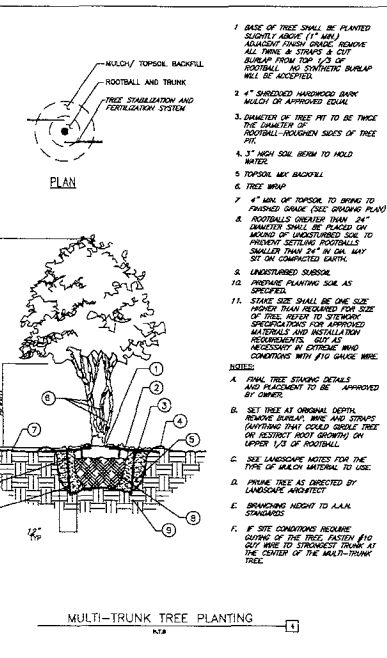

1. BASE OF TREE SHALL BE PLANTED SLIGHTLY ABOVE (1" MIN.) ADJACENT FINISH GRADE. REMOVE ALL TRUNKS & STAKES & CUT BURGLAR WIRE FROM TOP 1/3 OF ROOTBALL. NO SYNTHETIC BURGLAR WIRE TO BE ACCEPTED
 2. 4" SHREDDED HARDWOOD BARK MULCH OR APPROVED EQUAL
 3. DIAMETER OF TREE FIT TO BE TWICE THE DIAMETER OF ROOTBALL. RAUGHEN SIDES OF TREE FIT
 4. 3" HIGH SOIL BERM TO HOLD WATER
 5. TOPSOIL AND BACKFILL
 6. TREE WRP
 7. 4" MIN. OF TOPSOIL TO BRING TO FINISHED GRADE (SEE GRADING PLAN)
 8. ROOTBALLS GREATER THAN 24" DIAMETER SHALL BE PLACED ON MOUND OF UNDISTURBED SOIL TO PREVENT SETTLING. ROOTBALLS SMALLER THAN 24" IN DIA. MAY SET ON COMPACTED EARTH
 9. UNDISTURBED SUBGRADE
 10. PREPARED PLANTING SOIL AS SPECIFIED
 11. STAKE SIZE SHALL BE ONE SIZE HIGHER THAN REQUIRED FOR SIZE OF TREE. REFER TO SPECIFICATIONS FOR APPROVED MATERIALS AND INSTALLATION REQUIREMENTS. CUT AS NECESSARY IN EXTREME WIND CONDITIONS WITH #10 GAUGE WIRE
- NOTES:**
- A. FINAL TREE STAKING DETAILS AND PLACEMENT TO BE APPROVED BY OWNER
 - B. SET TREE AT ORIGINAL DEPTH. REMOVE BURGLAR WIRE AND STRAPS (ANYTHING THAT COULD RESTRICT ROOT GROWTH) ON UPPER 1/3 OF ROOTBALL
 - C. SEE LANDSCAPE NOTES FOR THE TYPE OF MULCH MATERIAL TO USE
 - D. PRUNE TREE AS DIRECTED BY LANDSCAPE ARCHITECT
 - E. BRANCHING HEIGHT TO A.A.N. STANDARDS
 - F. IF SITE CONDITIONS REQUIRE CURVING OF THE TREE, FASTEN #10 CUT WIRE TO STRONGEST TRUNK AT THE CENTER OF THE BALT-TRUNK TREE

PRELIMINARY PLANTING PLAN FOR THE PROPOSED
Black Hills Center
 WAL-MART #3872-03
 RAPID CITY, PENNINGTON COUNTY, SOUTH DAKOTA

DRINK	RFH
CREATED	RFH
DATE	4/20/10
SCALE	N.T.S.
JOB NO.	10PD031
SHEET	L-7

OF SEVEN SHEETS

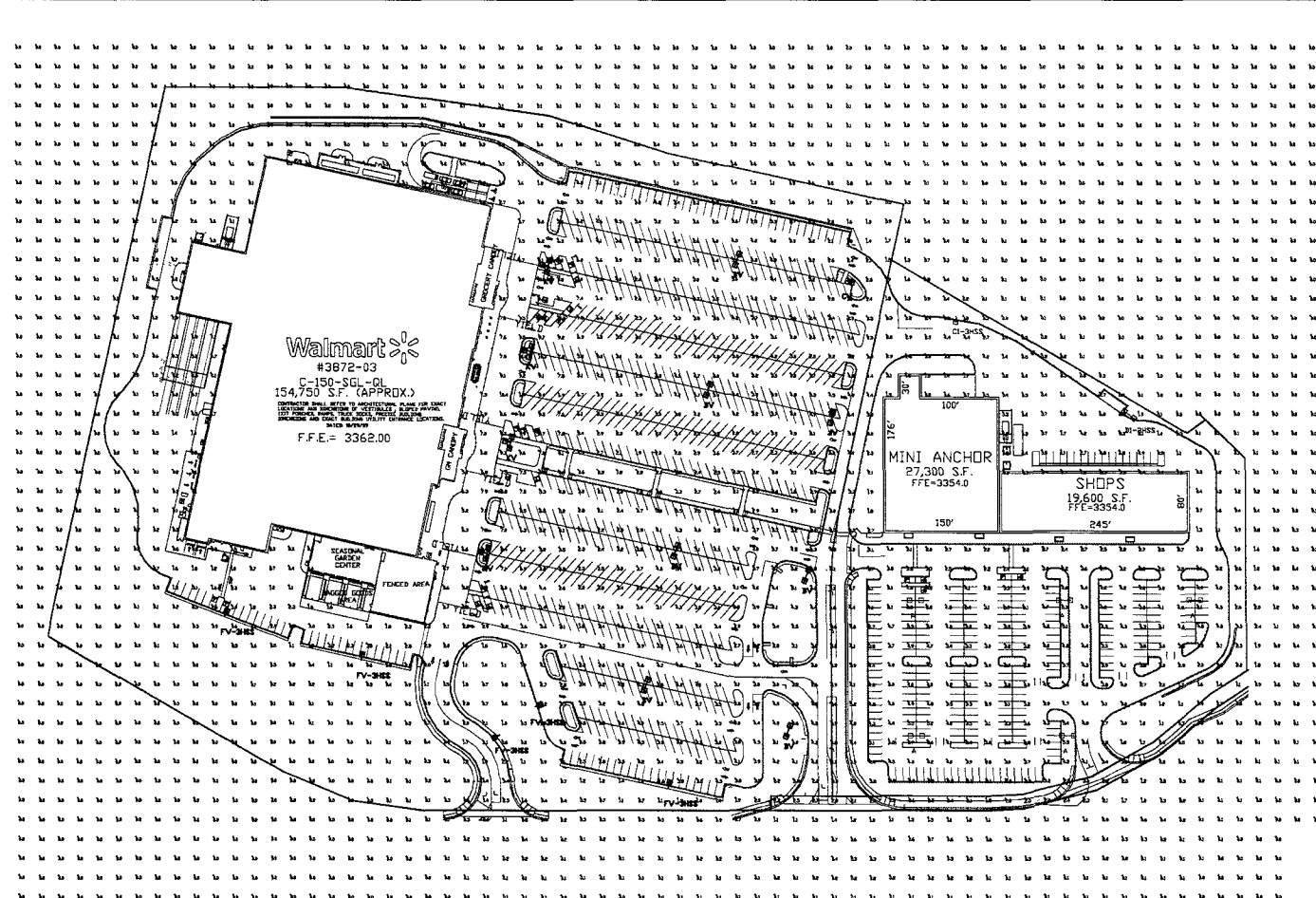

GREENBRIAR
FLAT LENS
IESNA FULL CUTOFF

Lei INDUSTRIES
CHERI KIEFFER NATIONAL ACCIDENT SALES
800 ALLIANCE BL. #100 WEEHAWK, NEW JERSEY 07095
908-985-7900 EXT. 303 • FAX 908-795-8147

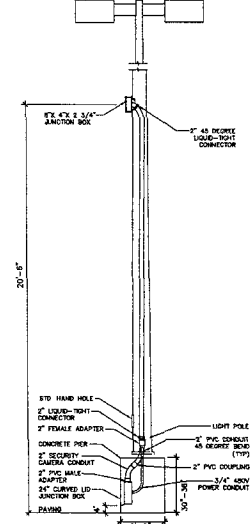

Code	FQty	Label	Arrangement	Lumen	LF	Description	Total Watts
D1	4	3V	3-BAY-3-BAY	10000	8750	GF-340-300-PRV-V-2W P.O.L.E. + 2 WALS	2540
D2	1	12V	3-BAY	10000	8750	GF-340-300-PRV-V-2W P.O.L.E. + 2 WALS	1000
D3	5	7V-3-BAY	3-BAY	10000	8750	GF-340-300-PRV-V-2W P.O.L.E. + 2 WALS	1980
D4	1	12V	NOTATED IN W	10000	8750	GF-340-300-PRV-V-2W P.O.L.E. + 2 WALS	1210
D5	4	12V	5 IN W BAYAGES	10000	8750	GF-340-300-PRV-V-2W P.O.L.E. + 2 WALS	3740
D6	1	12V-3-BAY	NOTATED IN W	10000	8750	GF-340-300-PRV-V-2W P.O.L.E. + 2 WALS	1000
D7	1	12V-3-BAY	3-BAY	10000	8750	GF-340-300-PRV-V-2W P.O.L.E. + 2 WALS	1980
D8	3	12V	3-BAY	10000	8750	GF-340-300-PRV-V-2W P.O.L.E. + 2 WALS	5140
D9	1	12V-3-BAY	3-BAY	10000	8750	GF-340-300-PRV-V-2W P.O.L.E. + 2 WALS	1980
D10	1	12V-3-BAY	NOTATED IN W	10000	8750	GF-340-300-PRV-V-2W P.O.L.E. + 2 WALS	1000

Lumen	Area	Foot	Per	Per	Per
Light	750	24	22	234	234
Light Drive Summary	120	36	32	234	234
Light LIT Summary	120	36	32	234	234

Based on the information provided, all dimensions and luminaire locations shown represent recommended positions. The engineer and/or architect must determine applicability of the report to existing or future field conditions.

This lighting system represents simulation levels calculated from laboratory tests. You are under contract to maintain lighting system. Industry standard test ranges to accommodate site. Illuminating Engineering Society approved methods. Actual performance may vary due to variations in electrical voltage, lamp life and other factors. Please contact us for more information.

**SITE LIGHTING
PHOTOMETRIC PLAN**

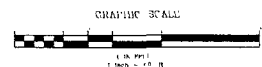

REVISIONS	BY

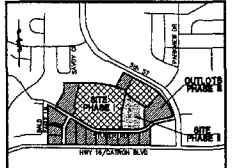
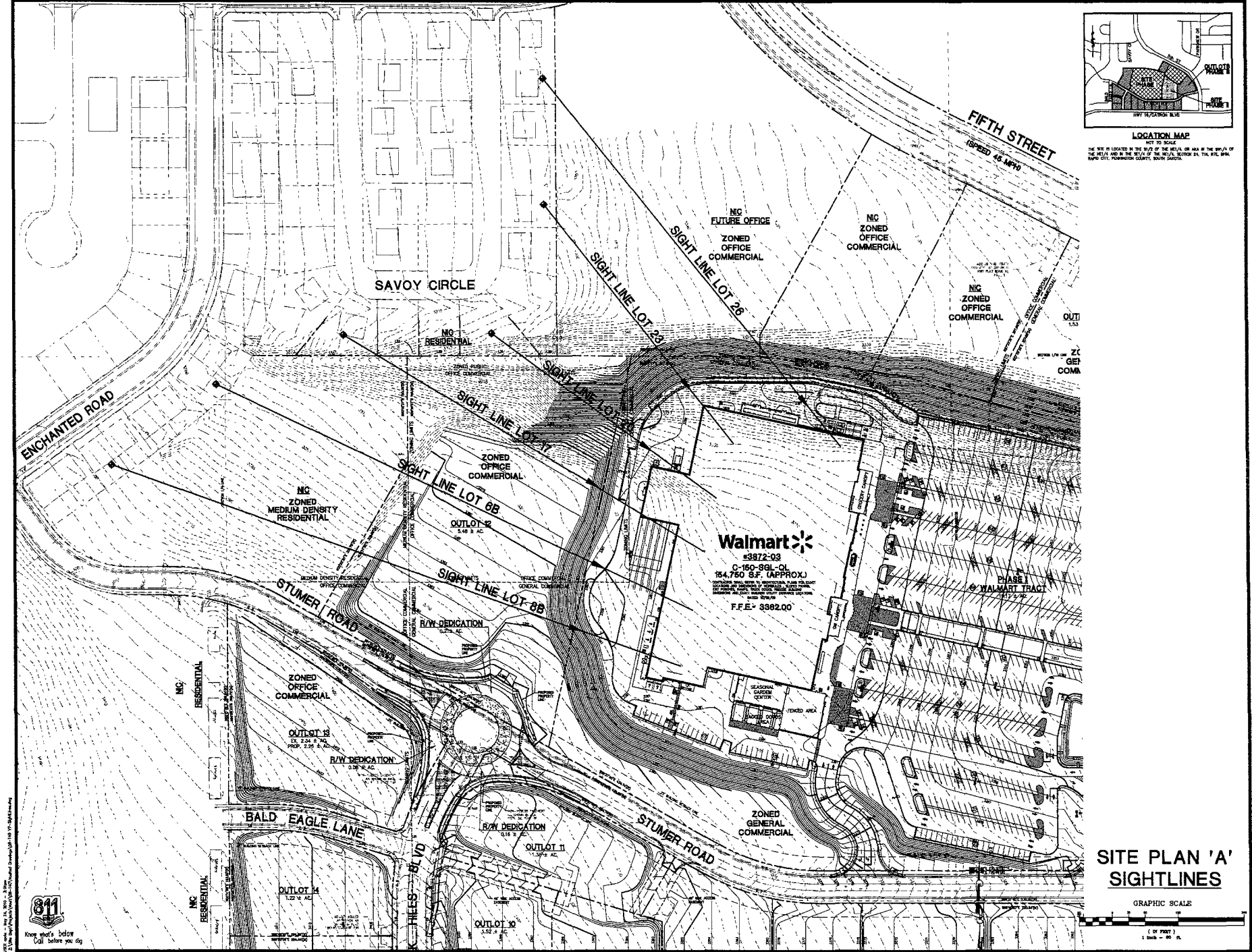

LOCATION MAP
NOT TO SCALE
THE SITE IS LOCATED IN THE SE 1/4 OF THE NE 1/4 OF THE NE 1/4 OF THE NW 1/4 AND IN THE NE 1/4 OF THE NE 1/4 SECTION ON THE NW 1/4, W&P RFD, PENNINGTON COUNTY, SOUTH CAROLINA.



Walmart
#3872-03
C-150-SGL-OL
154,750 S.F. (APPROX.)
GENERAL COMMERICAL DISTRICT
F.F.E. - 3392.00

SITE PLAN 'A'
SIGHTLINES

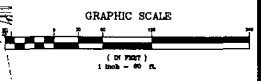

W
Wolverton & Associates
Consulting Engineers & Land Surveyors
4748 Quailview Drive, Suite 100, Omaha, Nebraska 68147
Phone: (402) 764-4470
www.wolvertonassociates.com

PROPOSED BLACK HILLS CENTER
Walmart # 3872-03
RAPID CITY, PENNINGTON COUNTY, S.D.
BY THE STONERIDGE DEVELOPMENT, LLC
ST. LOUIS, MO

REVISIONS BY

DRAWN BY: DMK
CHECKED BY: K/JW
DATE: 08/24/2010
SCALE: 1" = 50'
JOB NO.: 08-140
SHEET NUMBER

SL-A
OF SHEETS



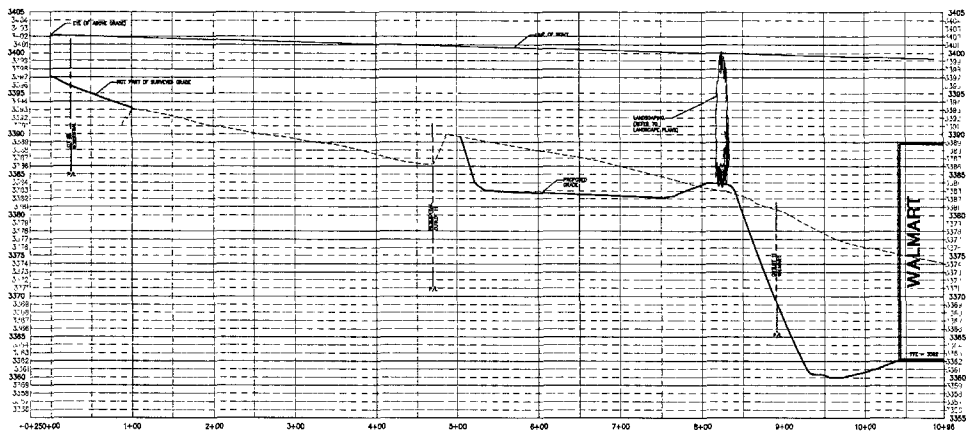

SIGHT LINE LOT 8B
 scale: 1"=60' horizontal
 1"=6' vertical

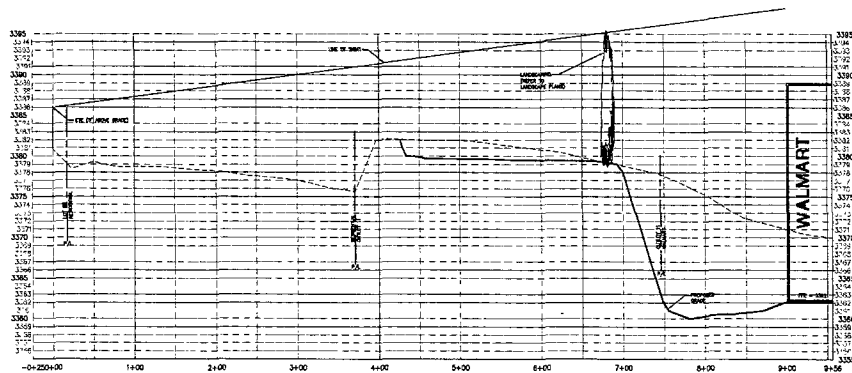

SIGHT LINE LOT 6B
 scale: 1"=60' horizontal
 1"=6' vertical

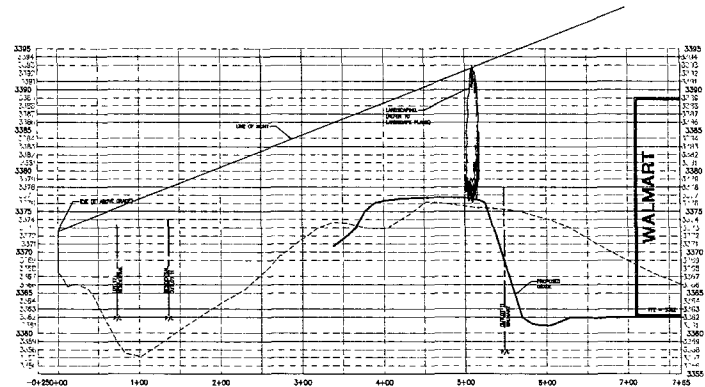

SIGHT LINE LOT 17
 scale: 1"=60' horizontal
 1"=6' vertical

**SITE PLAN 'A'
 SIGHTLINES
 PROFILES**

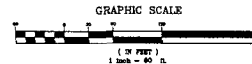

PROPOSED BLACK HILLS CENTER
 Walmart # 3872-03
 RAPID CITY, PENNINGTON COUNTY, S.D.
 BY: THE STONERIDGE DEVELOPMENT, LLC
 ST. LOUIS, MO

REVISIONS BY

DRAWN BY: DMN
 CHECKED BY: K/JW
 DATE: 06/24/2010
 SCALE: AS NOTED
 JOB NO.: 08-140
 SHEET NUMBER:

SL-A1



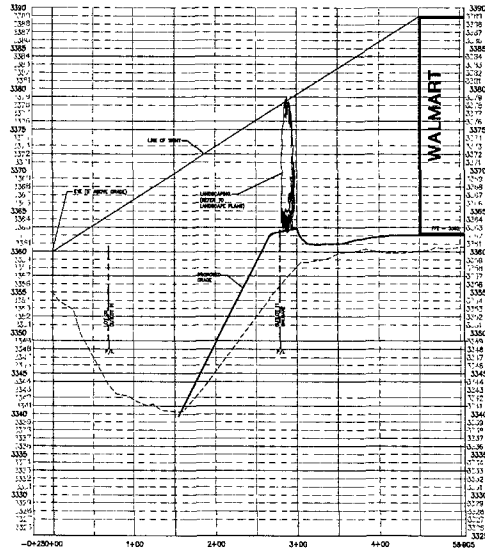

SIGHT LINE LOT 20
 scale: 1"=60' horizontal
 1"=6' vertical

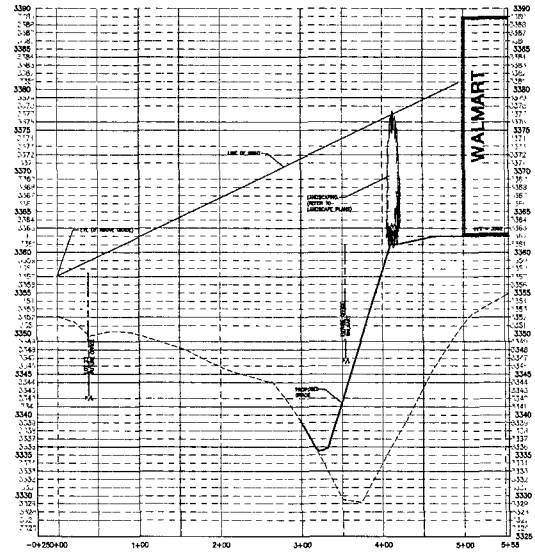

SIGHT LINE LOT 23
 scale: 1"=60' horizontal
 1"=6' vertical

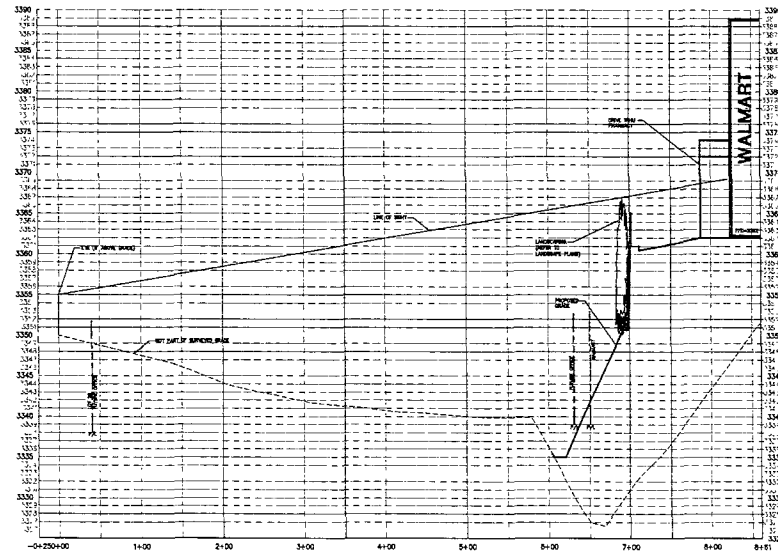

SIGHT LINE LOT 26
 scale: 1"=60' horizontal
 1"=6' vertical

SITE PLAN 'A'
SIGHTLINES
PROFILES

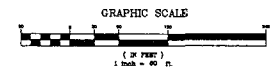

W
Wolverton & Associates
 Consulting Engineers & Land Surveyors
 402 West 77th Street, Suite 200
 St. Louis, MO 63103
 www.wolverton-associates.com

PROPOSED BLACK HILLS CENTER
 Walmart # 3872-03
 RAPID CITY, PENNINGTON COUNTY, S.D.
 BY: THF, STONERIDGE DEVELOPMENT, L.L.C.
 ST. LOUIS, MO

REVISIONS BY

DRAWN BY: DMN
 CHECKED BY: KJW
 DATE: 06/24/2010
 SCALE: AS NOTED
 JOB NO.: 08-140
 SHEET NUMBER:

SL-A2



Know what's below
 Call before you dig

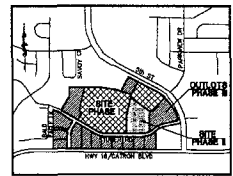
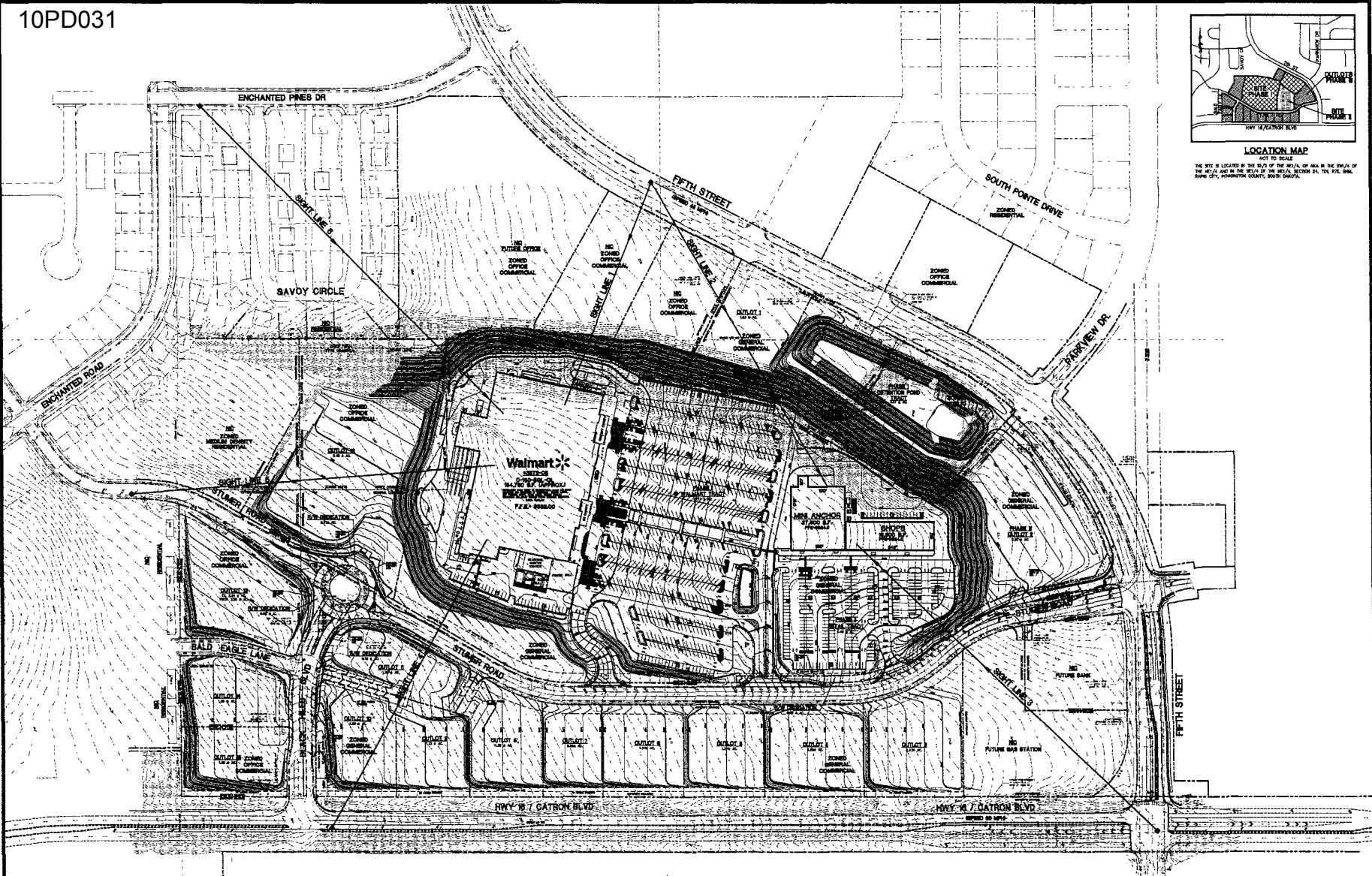

W
Wolverton & Associates
Consulting Engineers + Land Surveyors
Professional Survey License No. 10000, State of South Dakota
Professional Engineer License No. 10000, State of South Dakota
www.wolverton-associates.com

PROPOSED BLACK HILLS CENTER
Walmart # 3872-03
RAPID CITY, PENNINGTON COUNTY, S.D.
BY: THE STONERIDGE DEVELOPMENT, LLC
ST. LOUIS, MO

REVISIONS BY

DRAWN BY: DMN
CHECKED BY: KJW
DATE: 05/24/2010
SCALE: 1" = 100'
JOB NO.: 09-140
SHEET NUMBER

SL-B

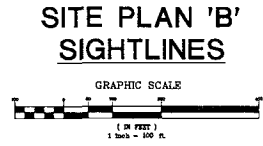

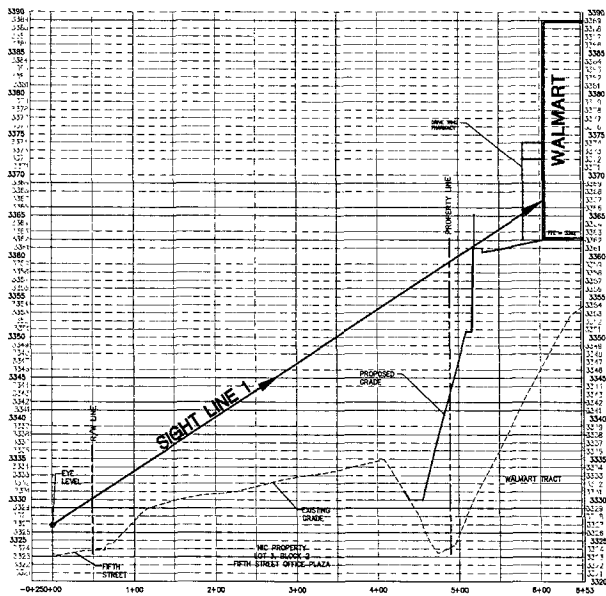

SIGHT LINE 1
 scale: 1"=60' horizontal
 1"=6' vertical

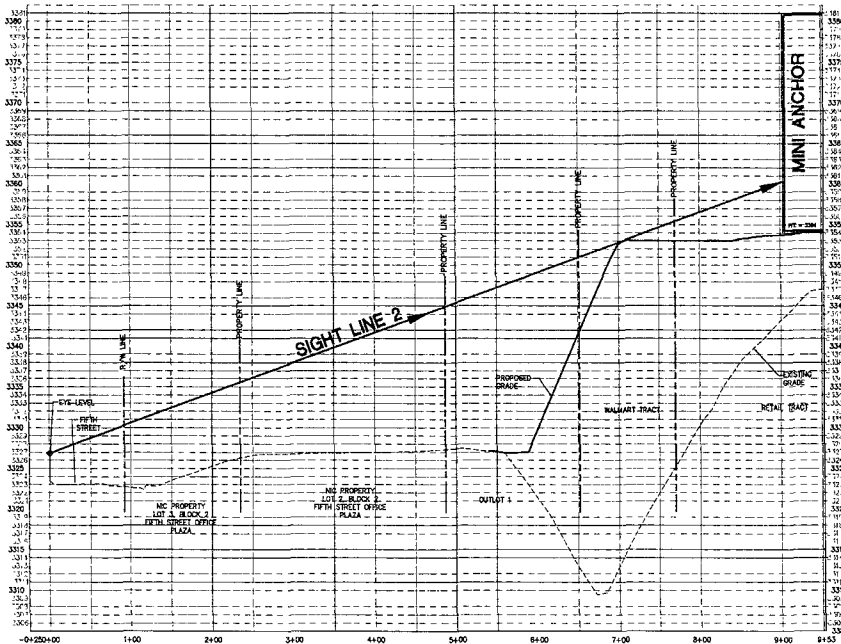

SIGHT LINE 2
 scale: 1"=60' horizontal
 1"=6' vertical

**SITE PLAN 'B'
 SIGHTLINES
 PROFILES**

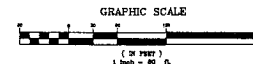

PROPOSED BLACK HILLS CENTER
 Walmart # 3872-03
 RAPID CITY, PENNINGTON COUNTY, S.D.
 BY: THE STONERIDGE DEVELOPMENT, LLC
 ST. LOUIS, MO

REVISIONS BY

DRAWN BY: DMN
 CHECKED BY: KJW
 DATE: 05/24/2010
 SCALE: AS NOTED
 JOB NO.: 08-140
 SHEET NUMBER:
SL-B1
 OF SHEETS

W Woiverton & Associates
 Consulting Engineers & Land Surveyors
 614 Belmont Avenue, Suite 100, Omaha, Nebraska 68102
 Phone: 402.441.1000
 Fax: 402.441.1001
 www.waonline.com



Know what's below
 Call before you dig

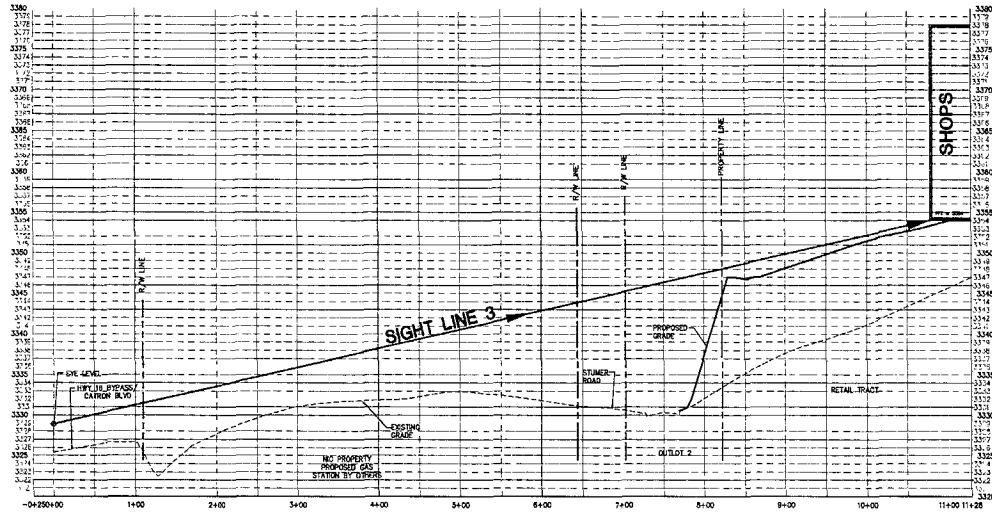

SIGHT LINE 3
 scale: 1"=60' horizontal
 1"=6' vertical

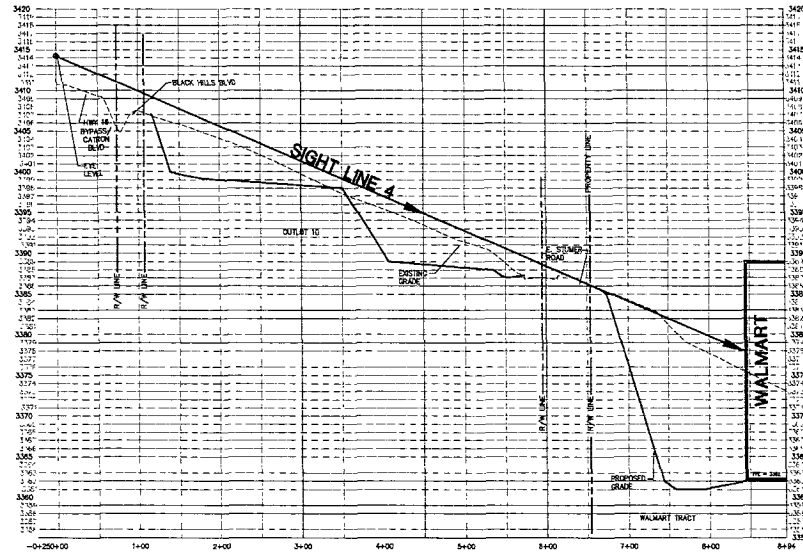

SIGHT LINE 4
 scale: 1"=60' horizontal
 1"=6' vertical

**SITE PLAN 'B'
 SIGHTLINES
 PROFILES**

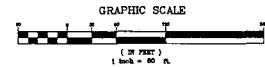

PROPOSED BLACK HILLS CENTER
 Walmart # 3872-03

RAPID CITY, PENNINGTON COUNTY, S.D.
 BY: THE STONERIDGE DEVELOPMENT, LLC
 ST. LOUIS, MO

REVISIONS	BY

DRAWN BY: DWN
 CHECKED BY: KJW
 DATE: 05/24/2010
 SCALE: AS NOTED
 JOB NO: 08-140
 SHEET NUMBER: SL-B2
 OF: 08/275

W
Wolverton & Associates
 Consulting Engineers + Land Surveyors
 616 North 27th Street, Suite 100
 Rapid City, SD 57701
 www.wolverton-est.com



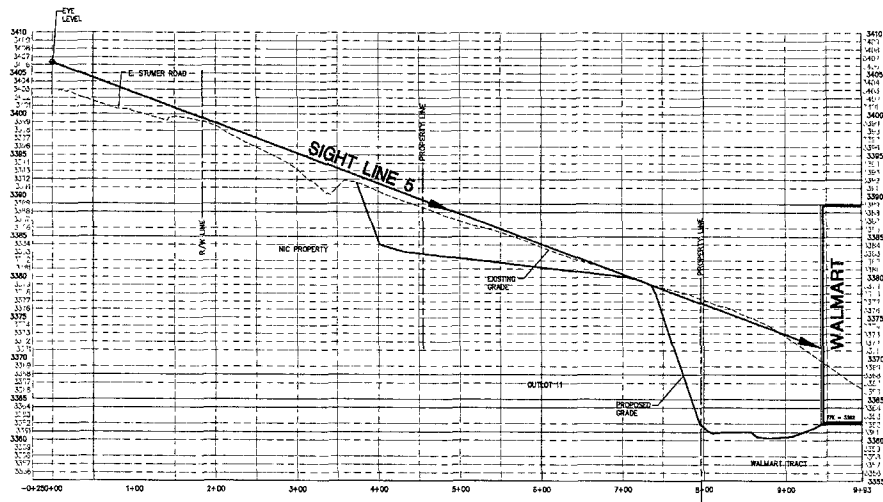

SIGHT LINE 5
 scale: 1"=60' horizontal
 1"=6' vertical

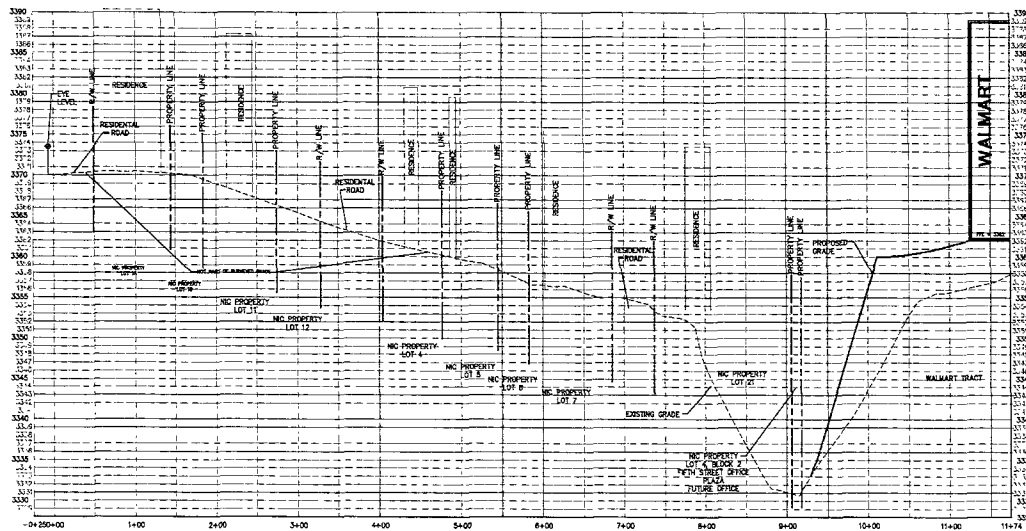

SIGHT LINE 6
 scale: 1"=60' horizontal

**SITE PLAN 'B'
 SIGHTLINES
 PROFILES**

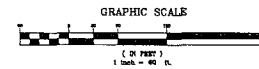

Wolverton & Associates
 Consulting Engineers & Land Surveyors
 878 North Park Drive • St. Louis, Missouri 63107
 Phone: (314) 433-8800
 Fax: (314) 433-8801
 www.wolverton.com

PROPOSED BLACK HILLS CENTER
 Walmart # 3872-03
 RAPID CITY, PENNINGTON COUNTY, S.D.
 BY: THE STONERIDGE DEVELOPMENT, LLC
 ST. LOUIS, MO

REVISIONS BY

DRAWN BY: DWN
 CHECKED BY: KJW
 DATE: 08/24/2010
 SCALE: AS NOTED
 JOB NO.: 08-140
 SHEET NUMBER

SL-B3



Know what's below
 Call before you dig

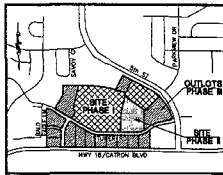
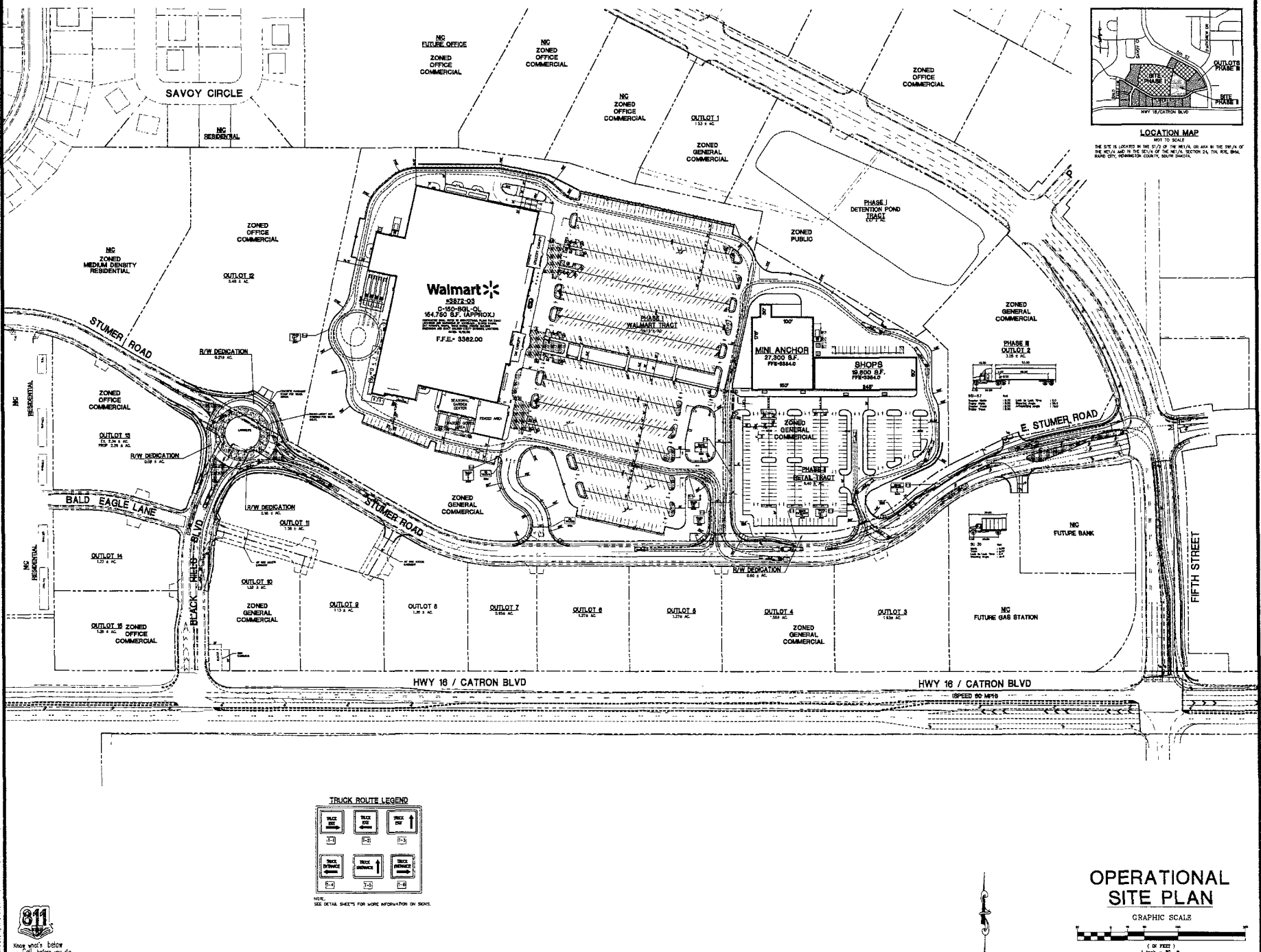

Wolverton & Associates
Consulting Engineers & Land Surveyors
814 W. Main Street, Suite 1000
Rapid City, SD 57701
Phone: 605.342.4444 Fax: 605.342.4447
www.wolvertonassociates.com

PROPOSED BLACK HILLS CENTER
Walmart # 3872-03
RAPID CITY, PENNINGTON COUNTY, S.D.
BY: THF, STONERIDGE DEVELOPMENT, LLC
ST. LOUIS, MO

REVISIONS BY

DRAWN BY DMN
CHECKED BY KJW
DATE 06/24/2010
SCALE 1" = 80'
JOB NO. 08-140
SHEET NUMBER TR-1
OF SHEETS

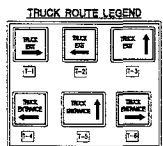

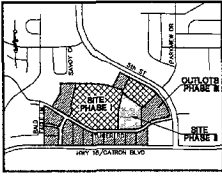
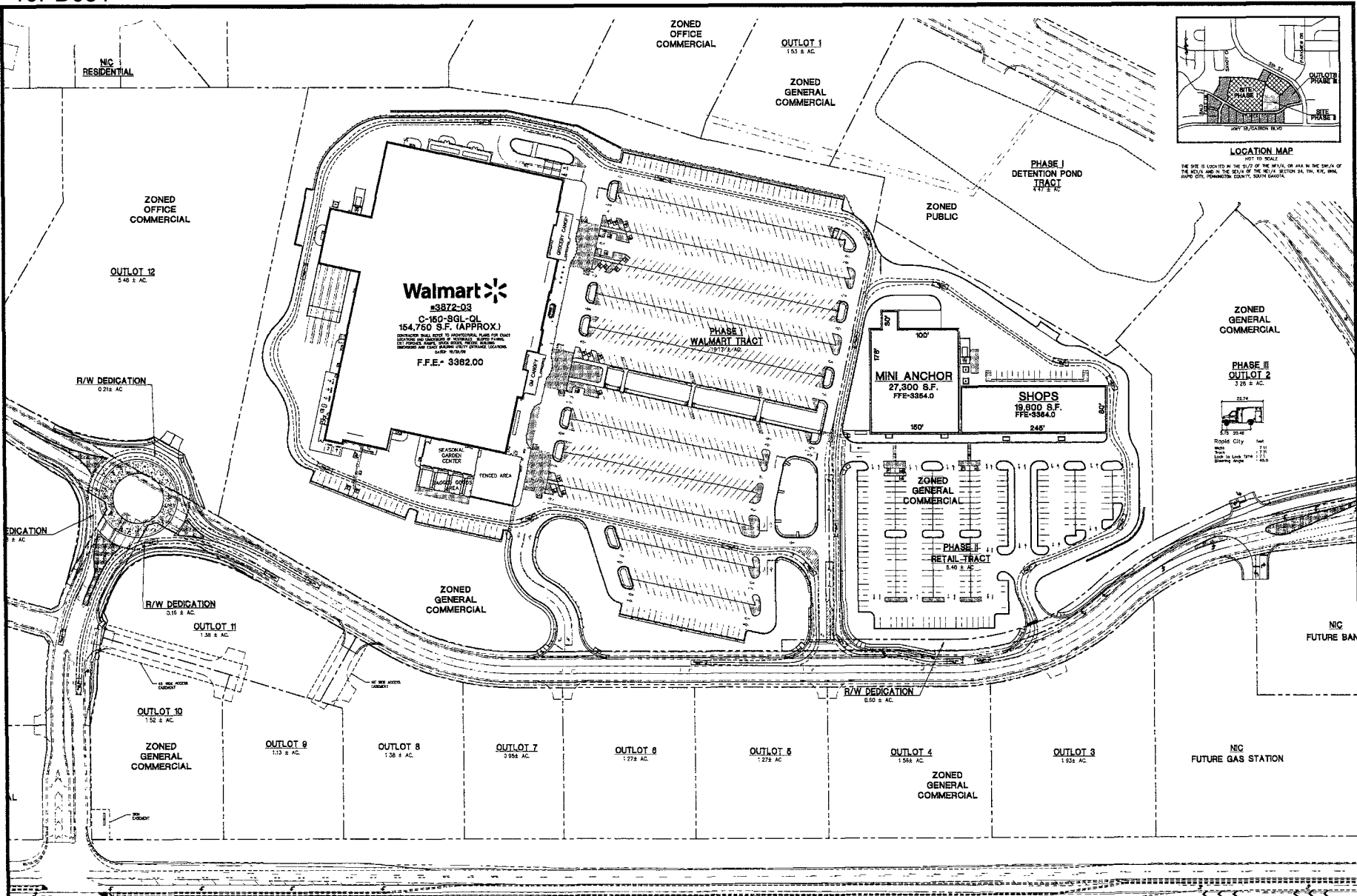

LOCATION MAP
NOT TO SCALE
THE SITE IS LOCATED IN THE S/2 OF THE NW/4, OR ALL IN THE SW/4 OF THE NW/4 AND IN THE SE/4 OF THE NW/4, SECTION 24, T19N, R19E, S10M, JOINT CO. PENNINGTON COUNTY, SOUTH CAROLINA.

Walmart
#3872-03
C-160-SGL-OL
154,700 S.F. (APPROX.)
CONTRACTOR SHALL VERIFY ALL DIMENSIONAL PLANS FOR EXISTING UTILITIES AND ADJUSTMENTS TO GENERAL LAYOUT. ALL DIMENSIONS ARE TO FACE UNLESS OTHERWISE NOTED. DATE: 05/20/10
F.F.E. = 3362.00

MINI ANCHOR
27,300 S.F.
FFE-5364.0

SHOPS
19,800 S.F.
FFE-5364.0

PHASE II OUTLOT 2
3.28 ± AC.
2374
2374
Rapid City
Map
Scale
1" = 100'
1" = 40'

W
Wolverton & Associates
Consulting Engineers • Land Surveyors
One West 77th Street
Rapid City, South Dakota 57701
www.wolverton-assoc.com

PROPOSED BLACK HILLS CENTER
Walmart # 3872-03
RAPID CITY, PENNINGTON COUNTY, S.D.
BY: THE STONERIDGE DEVELOPMENT, LLC
ST. LOUIS, MO

REVISIONS	BY

DRAWN BY: DMW
CHECKED BY: KJW
DATE: 5/24/2010
SCALE: 1" = 60'
JOB NO.: 09-140
SHEET NUMBER