

PROPOSED ZONING MAP

TRACT B OF THE SE1/4 OF THE SW1/4, A PORTION OF THE S1/2 OF  
 VACATED ST. LOUIS STREET RIGHT-OF-WAY,  
 A PORTION OF THE E10' OF VACATED RACINE STREET RIGHT-OF-WAY,  
 ALL LOCATED IN SECTION 31, T2N, R8E,  
 AND THE VACATED ALLEY LOCATED IN BLOCK 1 OF BRENNEN AND SWEENEY ADDITION,  
 IN SECTION 6, T1N, R8E, BHM,  
 RAPID CITY, PENNINGTON COUNTY, SOUTH DAKOTA

LOT A SUNDIAL LOT B SQUARE LOT C

LOT A BLAKES ADDITION

S89°30'42"E 449.43'

S1/2 VACATED ST. LOUIS STREET

TRACT B OF  
 THE SE1/4 OF  
 THE SW1/4

GENERAL  
 COMMERCIAL  
 3.459 Ac.±

S00°10'47"E 330.17'

SECTION 1/4 LINE  
 LACROSSE STREET  
 80' WIDE R.O.W. OF RECORD

FEIGELS ADDITION LOT A



LOT 1

APRIL 30, 2010



SCALE 1" = 100'

LINE	LENGTH	BEARING
L1	62.12'	S00°05'14"W
L2	20.00'	N89°56'48"W
L3	62.11'	N00°05'14"E

SHAUBS DIVISION

SECTION 31, T2N, R8E  
 SECTION 6, T1N, R8E

N00°02'43"E 333.80'

RACINE STREET  
 60' WIDE R.O.W. OF RECORD

E10' OF VACATED RACINE STREET

P.O.B.

N89°58'29"W 265.11'

N89°58'29"W 165.60'

21

L3

L1

4

L2

1

20

19

18

17

16

15

14

13

12

11

10

9

BLOCK 1  
 BRENNEN & SWEENEY

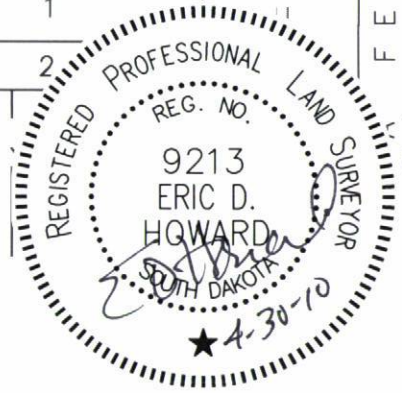

CITY HALL 1903

RENNER & ASSOCIATES, LLC.

616 SIXTH ST. \* RAPID CITY, SD 57701  
 PHONE: 605/721-7310 \* FAX: 605/721-7313  
 EMAIL: GARY@RENNERASSOC.COM