

SPECIAL EVENT APPLICATION

Rapid City Police Department

Traffic Section
300 Kansas City Street
Rapid City SD 57701

Phone: 605-394-4130

Fax: 605-394-6854



NAME OF EVENT: Make A Splash - Saturday Art Adventure

EVENT DATE/TIME: Saturday June 5 10:00 am to 3:00 pm

SPONSOR ORGANIZATION: The Dahl Arts Center

CONTACT PERSON: Victoria Ledford

ADDRESS: 713 Seventh St.

HOME PHONE: (605) 415-0091

WORK PHONE: (605) 394-4101

EMAIL ADDRESS: victoria@thedahl.org

PURPOSE OF EVENT: community outreach family event to inspire a love of the arts

ASSEMBLY AREA: Seventh St 1/2 block

ASSEMBLY TIME: 10:00 am to 3:30

ROUTE AREA: (List all streets and areas route is expected to cover)

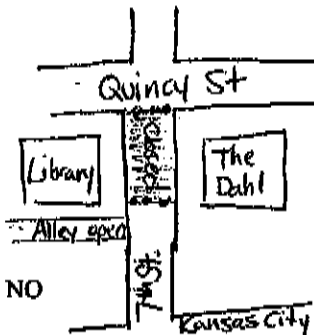

Seventh St
1/2 block area between Quincy and
Kansas City Streets; between
Dahl Arts Center and
downtown library - to leave
alley by library open

Map Attached? YES NO

Alternate Routes Available: YES NO

REQUESTING ANY CITY RESOURCES? No
(If so, explain need)

FIRE DEPARTMENT:
10 Main Street 394-4180

Contact: _____

STREET DEPARTMENT:
605 Steele Street 394-4152

Contact: _____

PARKS DEPARTMENT:
125 Waterloo Street 394-5225

Contact: _____

SPECIAL EVENT APPLICATION

Rapid City Police Department

Does event require special parking accommodations?	YES	<input checked="" type="radio"/> NO
Will businesses be affected by street closures?	<input checked="" type="radio"/> YES	<input checked="" type="radio"/> NO
Have affected businesses been notified? <i>The library is aware.</i>	<input checked="" type="radio"/> YES	NO
Will event require clearing of streets? (Towing of cars)	YES	NO
Does event include placement of temporary structures? <i>Copy of 11-6-19 Review Attached? YES</i>	<input checked="" type="radio"/> YES <i>jumping castle + food tables</i>	NO <input checked="" type="radio"/> NO
Does event plan on serving alcohol?	YES	<input checked="" type="radio"/> NO
Do you anticipate any security needs?	YES	<input checked="" type="radio"/> NO
Does your event require closing or blocking of any State Highway? <i>Any application for an event which requires the closing of any State highway, must have a corresponding state permit, prior to submittal of the event permit.</i> <i>Copy of State Permit Attached? YES NO</i>	YES	<input checked="" type="radio"/> NO
How many floats do you anticipate in your parade? If your parade has over 70 floats, City Ordinance requires Council Approval.		<u>0</u>

OFFICE USE ONLY

COUNCIL APPROVAL REQUIRED: ☒ YES ☐ NO

POLICE DEPARTMENT REVIEWED BY: [Signature] DATE: 5/5/010

SENT TO LEGAL/FINANCE: _____ L/F MEETING DATE: _____

COUNCIL MEETING DATE: _____

COUNCIL APPROVED: YES NO DATE: _____