

BID SUMMARY  
April 5, 2010

- No. CC040510-02.1 – One (1) New Current Model Year One Ton Truck (Opened March 30, 2010)

ADVERTISING AUTHORITY	\$26,000.00
1. Boyer Trucks**	\$23,536.00
  
- No. CC040510-02.2 – Oak Avenue, Oak Drive, and Oakland Street, Street Reconstruction Project Phase Two – Project Four, Project No. ST09-1824 / CIP No. 50424 (Opened March 30, 2010)

ADVERTISING AUTHORITY	\$1,650,000.00
ENGINEER'S ESTIMATE	\$2,100,000.00
1. Rapid Construction LLC*	\$2,121,885.16
2. R.C.S Construction*	\$1,884,189.50
3. Simon Contractors of SD Inc.*	\$2,802,757.45
4. Hills Materials Company*	\$1,926,676.11

\* Bid Bond Submitted

\*\* Cashier's Check, Money Order or Bank Draft Submitted

# BID AWARD SUMMARY

LETTING DATE: March 30, 2010

**PROJECT:** Oak Avenue, Oak Drive, and Oakland Street  
Street Reconstruction Project  
Phase Two – Project Four  
Project No. ST09-1824 / CIP No. 50424

**RECOMMENDATION:** Award Total Bid in the amount of \$1,884,189.50 to R.C.S. Construction, Inc. at the April 5, 2010 Council Meeting.

## BIDDERS' SUMMARY

<u>CONTRACTORS</u>	<u>TOTAL BID</u>
R.C.S. Construction, Inc.	\$1,884,189.50
Hills Materials Company	\$1,927,171.11
Rapid Construction Company, LLC	\$2,121,885.16
Simon Contractors of SD, Inc.	\$2,802,757.45

City staff recommends awarding this project to R.C.S. Construction, Inc. for a total bid amount of \$1,884,189.50 based on unit pricing with the following appropriation:

FUNDING SOURCE	TOTAL	Sewer	Water	Streets	Drainage
ADVERTISING AUTHORITY	\$1,650,000.00	\$335,000.00	\$330,000.00	\$775,000.00	\$210,000.00
ENGINEER'S ESTIMATE	\$2,100,000.00	\$441,436.60	\$439,101.60	\$932,063.48	\$287,398.33

### APPROPRIATION DATA:

FUNDING SOURCE	TOTAL	Sewer	Water	Street	Drainage
COST CENTER		0833	0933	8910	8911
LINE ITEM		4380	4381	4370	4371
FUNDING CENTER		0604	0602	0505	0505
BID AMOUNT	\$1,884,189.50	\$439,597.60	\$434,847.60	\$768,779.90	\$240,964.40

CONSULTANT:

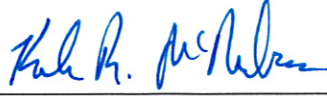
  
Kale McNaboe, PE  
Sperlich Consulting, Inc.

DATE: 3-31-10

PROJECT MANAGER:

  
Stacey Titus, PE  
City of Rapid City

DATE: 3/31/10

**BID TABULATION**  
**OAK AVENUE, OAK DRIVE, AND OAKLAND STREET**  
**STREET RECONSTRUCTION PROJECT, PHASE TWO - PROJECT FOUR**  
**PROJECT NO. ST09-1824 / CIP NO. 50424**  
**BID LETTING DATE: MARCH 30, 2010**

ITEM NO.	DESCRIPTION OF ITEM	UNIT	QTY (EST)	ENGINEER'S ESTIMATE		R.C.S. CONSTRUCTION, INC.		HILLS MATERIALS COMPANY		RAPID CONSTRUCTION COMPANY, LLC		SIMON CONTRACTORS OF SD, INC.	
				UNIT COST	EXTENDED COST	UNIT COST	EXTENDED COST	UNIT COST	EXTENDED COST	UNIT COST	EXTENDED COST	UNIT COST	EXTENDED COST
1	MOBILIZATION	LS	1.00	\$118,945.50	\$118,945.50	\$61,350.00	\$61,350.00	\$165,000.00	\$165,000.00	\$162,364.46	\$162,364.46	\$130,000.00	\$130,000.00
2	INCIDENTAL WORK	LS	1.00	\$85,000.00	\$85,000.00	\$27,000.00	\$27,000.00	\$78,500.00	\$78,500.00	\$58,479.00	\$58,479.00	\$145,000.00	\$145,000.00
3	CONSTRUCTION STAKING	LS	1.00	\$30,000.00	\$30,000.00	\$26,300.00	\$26,300.00	\$22,145.00	\$22,145.00	\$31,625.00	\$31,625.00	\$32,000.00	\$32,000.00
4	TRAFFIC CONTROL PLAN PREPARATION	LS	1.00	\$2,500.00	\$2,500.00	\$1,060.00	\$1,060.00	\$998.00	\$998.00	\$2,200.00	\$2,200.00	\$1,050.00	\$1,050.00
5	TRAFFIC CONTROL	LS	1.00	\$12,000.00	\$12,000.00	\$10,500.00	\$10,500.00	\$6,305.00	\$6,305.00	\$16,125.00	\$16,125.00	\$10,000.00	\$10,000.00
6	EROSION CONTROL PLAN	LS	1.00	\$1,500.00	\$1,500.00	\$560.00	\$560.00	\$125.00	\$125.00	\$1,650.00	\$1,650.00	\$500.00	\$500.00
7	TEMPORARY EROSION CONTROL	LS	1.00	\$7,500.00	\$7,500.00	\$2,130.00	\$2,130.00	\$2,250.00	\$2,250.00	\$6,000.00	\$6,000.00	\$12,500.00	\$12,500.00
8	CONSTRUCTION EROSION CONTROL (ROCK CONSTRUCTION ENTRANCE)	EA	7.00	\$1,000.00	\$7,000.00	\$180.00	\$1,260.00	\$178.00	\$1,246.00	\$1,302.00	\$9,114.00	\$2,000.00	\$14,000.00
9	CONSTRUCTION EROSION CONTROL (CORRUGATED PIPE & FABRIC INLET PROTECTION)	EA	29.00	\$250.00	\$7,250.00	\$84.00	\$2,436.00	\$79.00	\$2,291.00	\$257.30	\$7,461.70	\$87.50	\$2,537.50
10	CONSTRUCTION EROSION CONTROL (EROSION CONTROL GRAVEL FILTER SOCKS)	EA	30.00	\$100.00	\$3,000.00	\$22.00	\$660.00	\$21.15	\$634.50	\$207.30	\$6,219.00	\$23.00	\$690.00
11	TEMPORARY GRAVEL SURFACING, 3/4" BASE COURSE	TON	600.00	\$14.00	\$8,400.00	\$16.00	\$9,600.00	\$15.50	\$9,300.00	\$19.66	\$11,796.00	\$31.00	\$18,600.00
12	UNCLASSIFIED EXCAVATION	CY	5,550.00	\$15.00	\$83,250.00	\$7.00	\$38,850.00	\$9.90	\$54,945.00	\$11.50	\$63,825.00	\$6.50	\$36,075.00
13	EXCAVATION, UNDERCUT	CY	4,230.00	\$5.00	\$21,150.00	\$8.00	\$33,840.00	\$6.00	\$25,380.00	\$6.08	\$25,718.40	\$8.00	\$33,840.00
14	UNCLASSIFIED EXCAVATION - DIGOUTS WITH TYPE 4 FOUNDATION MATERIAL	CY	100.00	\$40.00	\$4,000.00	\$16.00	\$1,600.00	\$46.50	\$4,650.00	\$51.16	\$5,116.00	\$60.50	\$6,050.00
15	IMPORTED BACKFILL MATERIAL (TRENCH)	CY	260.00	\$22.00	\$5,720.00	\$13.00	\$3,380.00	\$5.00	\$1,300.00	\$18.00	\$4,680.00	\$27.00	\$7,020.00
16	IMPORTED BACKFILL MATERIAL (GRADING)	CY	320.00	\$22.00	\$7,040.00	\$13.00	\$4,160.00	\$5.00	\$1,600.00	\$18.00	\$5,760.00	\$27.00	\$8,640.00
17	TYPE I BEDDING	TON	400.00	\$15.00	\$6,000.00	\$16.00	\$6,400.00	\$15.00	\$6,000.00	\$19.19	\$7,676.00	\$26.00	\$10,400.00
18	TYPE II FOUNDATION MATERIAL	TON	200.00	\$18.00	\$3,600.00	\$16.00	\$3,200.00	\$13.00	\$2,600.00	\$19.19	\$3,838.00	\$26.00	\$5,200.00
19	TYPE III FOUNDATION MATERIAL	TON	100.00	\$20.00	\$2,000.00	\$18.00	\$1,800.00	\$14.50	\$1,450.00	\$21.17	\$2,117.00	\$28.00	\$2,800.00
20	TYPE IV FOUNDATION MATERIAL	TON	100.00	\$25.00	\$2,500.00	\$18.00	\$1,800.00	\$16.50	\$1,650.00	\$21.17	\$2,117.00	\$30.00	\$3,000.00
21	CONTROLLED LOW STRENGTH BACKFILL MATERIAL (TRENCH)	CY	60.00	\$110.00	\$6,600.00	\$100.00	\$6,000.00	\$103.00	\$6,180.00	\$138.00	\$8,280.00	\$154.00	\$9,240.00
22	AASHTO T-180 SOIL TEST	EA	8.00	\$150.00	\$1,200.00	\$265.00	\$2,120.00	\$137.00	\$1,096.00	\$143.00	\$1,144.00	\$154.00	\$1,232.00
23	CLEARING & GRUBBING, TREES	EA	12.00	\$400.00	\$4,800.00	\$460.00	\$5,520.00	\$345.00	\$4,140.00	\$300.00	\$3,600.00	\$350.00	\$4,200.00

ITEM NO.	DESCRIPTION OF ITEM	UNIT	QTY (EST)	ENGINEER'S ESTIMATE		R.C.S. CONSTRUCTION, INC.		HILLS MATERIALS COMPANY		RAPID CONSTRUCTION COMPANY, LLC		SIMON CONTRACTORS OF SD, INC.	
				UNIT COST	EXTENDED COST	UNIT COST	EXTENDED COST	UNIT COST	EXTENDED COST	UNIT COST	EXTENDED COST	UNIT COST	EXTENDED COST
24	CLEARING & GRUBBING STUMP	EA	4.00	\$150.00	\$600.00	\$163.00	\$652.00	\$80.00	\$320.00	\$500.00	\$2,000.00	\$225.00	\$900.00
25	TRIMMING TREES	EA	5.00	\$250.00	\$1,250.00	\$280.00	\$1,400.00	\$200.00	\$1,000.00	\$500.00	\$2,500.00	\$800.00	\$4,000.00
26	CLEARING & GRUBBING	LS	1.00	\$4,000.00	\$4,000.00	\$1,600.00	\$1,600.00	\$3,900.00	\$3,900.00	\$4,000.00	\$4,000.00	\$6,000.00	\$6,000.00
27	REMOVE SANITARY SEWER MANHOLE	EA	8.00	\$450.00	\$3,600.00	\$1,100.00	\$8,800.00	\$200.00	\$1,600.00	\$750.00	\$6,000.00	\$500.00	\$4,000.00
28	REMOVE TYPE "B" INLET	EA	1.00	\$250.00	\$250.00	\$450.00	\$450.00	\$195.00	\$195.00	\$500.00	\$500.00	\$315.00	\$315.00
29	REMOVE TYPE "E" INLET	EA	1.00	\$400.00	\$400.00	\$640.00	\$640.00	\$225.00	\$225.00	\$800.00	\$800.00	\$350.00	\$350.00
30	REMOVE RCP STORM SEWER	LF	50.00	\$45.00	\$2,250.00	\$5.00	\$250.00	\$9.25	\$462.50	\$16.00	\$800.00	\$15.00	\$750.00
31	DEMO VARIABLE HEIGHT RETAINING WALL	LF	242.00	\$22.50	\$5,445.00	\$7.00	\$1,694.00	\$7.10	\$1,718.20	\$24.07	\$5,824.94	\$16.00	\$3,872.00
32	REMOVE GRAVEL DRIVEWAY	SY	61.00	\$2.50	\$152.50	\$2.00	\$122.00	\$2.50	\$152.50	\$2.20	\$134.20	\$2.50	\$152.50
33	REMOVE CONCRETE/ASPHALT PAVEMENT (INCLUDES MONOLITHIC CURB & GUTTER, PANS, & FILLETS, ETC.)	SY	10,270.00	\$5.00	\$51,350.00	\$3.00	\$30,810.00	\$2.30	\$23,621.00	\$6.00	\$61,620.00	\$6.75	\$69,322.50
34	REMOVE CONCRETE DRIVEWAY AND APPROACH PAVEMENT	SY	1,110.00	\$5.00	\$5,550.00	\$2.00	\$2,220.00	\$3.75	\$4,162.50	\$5.09	\$5,649.90	\$9.00	\$9,990.00
35	REMOVE CONCRETE SIDEWALK	SY	2,585.00	\$3.50	\$9,047.50	\$2.00	\$5,170.00	\$1.25	\$3,231.25	\$5.47	\$14,139.95	\$9.00	\$23,265.00
36	REMOVE AND RE-SET BOLLARDS	EA	7.00	\$150.00	\$1,050.00	\$230.00	\$1,610.00	\$385.00	\$2,695.00	\$200.00	\$1,400.00	\$300.00	\$2,100.00
37	REMOVE AND RE-SET CHAIN LINK FENCE W/ 10" DIA. CONCRETE FOOTING 10' O.C.	LF	675.00	\$18.00	\$12,150.00	\$41.00	\$27,675.00	\$15.70	\$10,597.50	\$16.50	\$11,137.50	\$16.50	\$11,137.50
38	REMOVE AND RE-SET WOOD FENCE (PRIVACY AND SPLIT RAIL)	LF	167.00	\$22.00	\$3,674.00	\$11.00	\$1,837.00	\$10.33	\$1,725.11	\$11.00	\$1,837.00	\$11.00	\$1,837.00
39	REMOVE CURB STOP AND BOX	EA	40.00	\$200.00	\$8,000.00	\$100.00	\$4,000.00	\$5.70	\$228.00	\$50.00	\$2,000.00	\$84.50	\$3,380.00
40	REMOVE WATER VALVE AND BOX	EA	10.00	\$200.00	\$2,000.00	\$100.00	\$1,000.00	\$48.00	\$480.00	\$150.00	\$1,500.00	\$56.00	\$560.00
41	REMOVE FIRE HYDRANT AUX. VALVE AND LEAD	EA	4.00	\$350.00	\$1,400.00	\$750.00	\$3,000.00	\$240.00	\$960.00	\$500.00	\$2,000.00	\$160.00	\$640.00
42	REMOVE & RESET MAILBOX	EA	1.00	\$450.00	\$450.00	\$100.00	\$100.00	\$140.00	\$140.00	\$500.00	\$500.00	\$175.00	\$175.00
43	BYPASS PUMPING	LS	1.00	\$12,000.00	\$12,000.00	\$4,200.00	\$4,200.00	\$3,850.00	\$3,850.00	\$15,140.00	\$15,140.00	\$25,000.00	\$25,000.00
44	CONNECT TO EXISTING SEWER MAIN	EA	6.00	\$750.00	\$4,500.00	\$210.00	\$1,260.00	\$128.00	\$768.00	\$556.11	\$3,336.66	\$1,000.00	\$6,000.00
45	10" X 8" ECCENTRIC REDUCER	EA	1.00	\$850.00	\$850.00	\$377.00	\$377.00	\$212.00	\$212.00	\$434.57	\$434.57	\$320.00	\$320.00
46	STANDARD MANHOLE, 48" DIA (0'-6")	EA	16.00	\$2,500.00	\$40,000.00	\$3,000.00	\$48,000.00	\$2,550.00	\$40,800.00	\$2,082.96	\$33,327.36	\$3,800.00	\$60,800.00
47	TERMINATION MANHOLE, 48" DIA (0'-6")	EA	1.00	\$2,500.00	\$2,500.00	\$2,800.00	\$2,800.00	\$2,325.00	\$2,325.00	\$1,987.26	\$1,987.26	\$3,800.00	\$3,800.00
48	EXTRA MANHOLE DEPTH, 48" DIA	VF	64.60	\$250.00	\$16,150.00	\$125.00	\$8,075.00	\$260.00	\$16,796.00	\$180.50	\$11,660.30	\$330.00	\$21,318.00
49	SANITARY SEWER SERVICE RECONNECTION	EA	42.00	\$450.00	\$18,900.00	\$317.00	\$13,314.00	\$84.00	\$3,528.00	\$534.50	\$22,449.00	\$334.00	\$14,028.00
50	4" PVC SEWER SERVICE LINE	LF	1,730.00	\$18.00	\$31,140.00	\$31.00	\$53,630.00	\$19.75	\$34,167.50	\$28.90	\$49,997.00	\$55.00	\$95,150.00
51	4" PVC SEWER SERVICE CLEAN OUT	EA	42.00	\$200.00	\$8,400.00	\$250.00	\$10,500.00	\$60.00	\$2,520.00	\$180.00	\$7,560.00	\$260.00	\$10,920.00
52	10" PVC SEWER MAIN, SDR-35 (8'-10")	LF	301.00	\$25.00	\$7,525.00	\$38.00	\$11,438.00	\$42.00	\$12,642.00	\$34.40	\$10,354.40	\$107.00	\$32,207.00

ITEM NO.	DESCRIPTION OF ITEM	UNIT	QTY (EST)	ENGINEER'S ESTIMATE		R.C.S. CONSTRUCTION, INC.		HILLS MATERIALS COMPANY		RAPID CONSTRUCTION COMPANY, LLC		SIMON CONTRACTORS OF SD, INC.	
				UNIT COST	EXTENDED COST	UNIT COST	EXTENDED COST	UNIT COST	EXTENDED COST	UNIT COST	EXTENDED COST	UNIT COST	EXTENDED COST
53	10" PVC SEWER MAIN, SDR-35 (10'-12')	LF	446.00	\$28.00	\$12,488.00	\$38.00	\$16,948.00	\$41.50	\$18,509.00	\$38.60	\$17,215.60	\$138.00	\$61,548.00
54	8" PVC SEWER MAIN, SDR-35 (6'-8')	LF	252.00	\$20.00	\$5,040.00	\$35.00	\$8,820.00	\$39.00	\$9,828.00	\$29.25	\$7,371.00	\$82.50	\$20,790.00
55	8" PVC SEWER MAIN, SDR-35 (8'-10')	LF	658.00	\$22.00	\$14,476.00	\$35.00	\$23,030.00	\$43.75	\$28,787.50	\$32.20	\$21,187.60	\$105.00	\$69,090.00
56	8" PVC SEWER MAIN, SDR-35 (10'-12')	LF	791.00	\$25.00	\$19,775.00	\$35.00	\$27,685.00	\$42.75	\$33,815.25	\$36.40	\$28,792.40	\$126.00	\$99,666.00
57	8" PVC SEWER MAIN, SDR-35 (12'-14')	LF	162.00	\$28.00	\$4,536.00	\$35.00	\$5,670.00	\$53.00	\$8,586.00	\$45.00	\$7,290.00	\$150.00	\$24,300.00
58	CONNECT TO EXISTING WATER MAIN	EA	6.00	\$1,050.00	\$6,300.00	\$330.00	\$1,980.00	\$200.00	\$1,200.00	\$1,346.35	\$8,078.10	\$1,720.00	\$10,320.00
59	6" PVC WATER MAIN, AWWA C-900, (DR 14)	LF	40.00	\$30.00	\$1,200.00	\$29.00	\$1,160.00	\$38.00	\$1,520.00	\$34.60	\$1,384.00	\$55.80	\$2,232.00
60	8" PVC WATER MAIN, AWWA C-900, (DR 14), RESTRAINED JOINT	LF	2,432.00	\$38.00	\$92,416.00	\$41.00	\$99,712.00	\$41.75	\$101,536.00	\$45.20	\$109,926.40	\$101.00	\$245,632.00
61	8" X 6" X 8" TEE	EA	8.00	\$650.00	\$5,200.00	\$500.00	\$4,000.00	\$410.00	\$3,280.00	\$412.93	\$3,303.44	\$675.00	\$5,400.00
62	8" X 8" X 8" TEE	EA	5.00	\$650.00	\$3,250.00	\$550.00	\$2,750.00	\$445.00	\$2,225.00	\$454.93	\$2,274.65	\$775.00	\$3,875.00
63	6" X 6" X 6" TEE	EA	1.00	\$650.00	\$650.00	\$420.00	\$420.00	\$315.00	\$315.00	\$327.16	\$327.16	\$540.00	\$540.00
64	8" X 6" REDUCER	EA	6.00	\$500.00	\$3,000.00	\$335.00	\$2,010.00	\$205.00	\$1,230.00	\$257.97	\$1,547.82	\$550.00	\$3,300.00
65	8" 22.5 DEGREE VERTICAL BEND	EA	4.00	\$450.00	\$1,800.00	\$330.00	\$1,320.00	\$285.00	\$1,140.00	\$336.71	\$1,346.84	\$550.00	\$2,200.00
66	6" 45 DEGREE BEND	EA	1.00	\$450.00	\$450.00	\$200.00	\$200.00	\$135.00	\$135.00	\$203.03	\$203.03	\$450.00	\$450.00
67	8" 11.25 DEGREE BEND	EA	2.00	\$450.00	\$900.00	\$325.00	\$650.00	\$270.00	\$540.00	\$280.05	\$560.10	\$500.00	\$1,000.00
68	8" 45 DEGREE BEND	EA	9.00	\$450.00	\$4,050.00	\$360.00	\$3,240.00	\$305.00	\$2,745.00	\$308.26	\$2,774.34	\$570.00	\$5,130.00
69	8" 90 DEGREE BEND	EA	1.00	\$450.00	\$450.00	\$385.00	\$385.00	\$320.00	\$320.00	\$378.17	\$378.17	\$540.00	\$540.00
70	8" MJ PLUG	EA	1.00	\$250.00	\$250.00	\$140.00	\$140.00	\$140.00	\$140.00	\$211.43	\$211.43	\$425.00	\$425.00
71	8" GATE VALVE WITH BOX	EA	19.00	\$1,400.00	\$26,600.00	\$1,500.00	\$28,500.00	\$1,220.00	\$23,180.00	\$1,311.27	\$24,914.13	\$1,750.00	\$33,250.00
72	FIRE HYDRANT WITH AUX. VALVE & LEAD	EA	8.00	\$4,200.00	\$33,600.00	\$4,330.00	\$34,640.00	\$3,700.00	\$29,600.00	\$3,542.86	\$28,342.88	\$4,600.00	\$36,800.00
73	WATER SERVICE RECONNECTION	EA	40.00	\$450.00	\$18,000.00	\$160.00	\$6,400.00	\$43.00	\$1,720.00	\$414.49	\$16,579.60	\$285.00	\$11,400.00
74	1" TAPPING SADDLE	EA	40.00	\$275.00	\$11,000.00	\$220.00	\$8,800.00	\$124.00	\$4,960.00	\$141.52	\$5,660.80	\$350.00	\$14,000.00
75	1" CURB STOP AND BOX	EA	40.00	\$225.00	\$9,000.00	\$380.00	\$15,200.00	\$247.00	\$9,880.00	\$263.74	\$10,549.60	\$410.00	\$16,400.00
76	1" COPPER WATER SERVICE	LF	1,535.00	\$18.00	\$27,630.00	\$34.00	\$52,190.00	\$23.40	\$35,919.00	\$32.00	\$49,120.00	\$36.00	\$55,260.00
77	WATER MAIN ENCASEMENT	LF	190.00	\$32.00	\$6,080.00	\$36.00	\$6,840.00	\$47.00	\$8,930.00	\$39.64	\$7,531.60	\$48.00	\$9,120.00
78	WATER MAIN INSULATE (STD DETAIL 11-1, 8" WIDE WITH SAND CUSHION)	LF	100.00	\$40.00	\$4,000.00	\$5.00	\$500.00	\$25.00	\$2,500.00	\$29.01	\$2,901.00	\$55.00	\$5,500.00
79	CATHODIC PROTECTION CONTINUITY TESTING AND REPORTING	LS	1.00	\$4,200.00	\$4,200.00	\$2,000.00	\$2,000.00	\$1,175.00	\$1,175.00	\$5,500.00	\$5,500.00	\$2,200.00	\$2,200.00
80	CATHODIC PROTECTION OF WATER MAIN AND SERVICES, COMPLETE	LS	1.00	\$6,500.00	\$6,500.00	\$21,500.00	\$21,500.00	\$12,000.00	\$12,000.00	\$9,940.00	\$9,940.00	\$25,000.00	\$25,000.00
81	CATHODIC PROTECTION TEST STATION, COMPLETE	EA	8.00	\$550.00	\$4,400.00	\$450.00	\$3,600.00	\$205.00	\$1,640.00	\$374.97	\$2,999.76	\$380.00	\$3,040.00

ITEM NO.	DESCRIPTION OF ITEM	UNIT	QTY (EST)	ENGINEER'S ESTIMATE		R.C.S. CONSTRUCTION, INC.		HILLS MATERIALS COMPANY		RAPID CONSTRUCTION COMPANY, LLC		SIMON CONTRACTORS OF SD, INC.	
				UNIT COST	EXTENDED COST	UNIT COST	EXTENDED COST	UNIT COST	EXTENDED COST	UNIT COST	EXTENDED COST	UNIT COST	EXTENDED COST
82	ZINC GALVANIC ANODE (18-LB)	EA	145.00	\$120.00	\$17,400.00	\$180.00	\$26,100.00	\$87.00	\$12,615.00	\$94.11	\$13,645.95	\$265.00	\$38,425.00
83	PCC PAVEMENT, 6" NON-REINFORCED	SF	100.00	\$50.00	\$5,000.00	\$6.00	\$600.00	\$11.00	\$1,100.00	\$4.68	\$468.00	\$7.00	\$700.00
84	ASPHALT CONCRETE, CLASS G, TYPE 1, PG64-28	TON	2,440.00	\$85.00	\$207,400.00	\$88.00	\$214,720.00	\$74.00	\$180,560.00	\$82.78	\$201,983.20	\$91.00	\$222,040.00
85	AGGREGATE BASE COURSE	TON	5,325.00	\$18.00	\$95,850.00	\$16.00	\$85,200.00	\$20.40	\$108,630.00	\$17.99	\$95,796.75	\$20.00	\$106,500.00
86	GEOTEXTILE FABRIC	SY	12,570.00	\$3.20	\$40,224.00	\$3.00	\$37,710.00	\$1.95	\$24,511.50	\$4.01	\$50,405.70	\$2.50	\$31,425.00
87	STANDARD DRIVEWAY APPROACH PAVEMENT, 6" NON REINFORCED	SY	252.00	\$48.00	\$12,096.00	\$44.00	\$11,088.00	\$70.40	\$17,740.80	\$43.73	\$11,019.96	\$62.50	\$15,750.00
88	GRADE MODIFIED DRIVEWAY APPROACH PAVEMENT, 6" NON REINFORCED	SY	200.50	\$48.00	\$9,624.00	\$48.00	\$9,624.00	\$69.25	\$13,884.63	\$44.00	\$8,822.00	\$62.50	\$12,531.25
89	REINFORCED DRIVEWAY APPROACH PAVEMENT, 6" REINFORCED	SY	52.50	\$68.00	\$3,570.00	\$47.00	\$2,467.50	\$73.15	\$3,840.38	\$48.40	\$2,541.00	\$75.00	\$3,937.50
90	REINFORCED CONCRETE DRIVEWAY PAVEMENT, 6" REINFORCED	SY	130.00	\$68.00	\$8,840.00	\$47.00	\$6,110.00	\$64.40	\$8,372.00	\$48.40	\$6,292.00	\$70.00	\$9,100.00
91	CONCRETE DRIVEWAY PAVEMENT, 6" NONREINFORCED	SY	931.00	\$48.00	\$44,688.00	\$44.00	\$40,964.00	\$62.50	\$58,187.50	\$43.73	\$40,712.63	\$59.00	\$54,929.00
92	TYPE B66 CURB AND GUTTER	LF	3,706.00	\$18.00	\$66,708.00	\$15.00	\$55,590.00	\$15.35	\$56,887.10	\$19.25	\$71,340.50	\$17.70	\$65,596.20
93	TYPE P6 GUTTER	LF	763.00	\$18.00	\$13,734.00	\$15.00	\$11,445.00	\$14.50	\$11,063.50	\$19.25	\$14,687.75	\$14.00	\$10,682.00
94	CONCRETE FILLET AND PAN, 6" REINFORCED	SY	463.00	\$80.00	\$37,040.00	\$45.00	\$20,835.00	\$64.90	\$30,048.70	\$68.20	\$31,576.60	\$75.00	\$34,725.00
95	ADA CROSSWALK WITH TRANSITION PAVEMENT, 6" REINFORCED	SY	255.00	\$80.00	\$20,400.00	\$45.00	\$11,475.00	\$64.90	\$16,549.50	\$68.20	\$17,391.00	\$62.50	\$15,937.50
96	CONCRETE SIDEWALK, 4" NONREINFORCED	SF	22,170.00	\$4.75	\$105,307.50	\$5.00	\$110,850.00	\$4.55	\$100,873.50	\$4.06	\$90,010.20	\$4.10	\$90,897.00
97	CONCRETE TYPE "C" RETAINING WALL (0'-2' TALL)	LF	265.00	\$40.00	\$10,600.00	\$60.00	\$15,900.00	\$60.00	\$15,900.00	\$22.32	\$5,914.80	\$80.00	\$21,200.00
98	6" DIAMETER PIPE UNDER DRAIN (DETAIL 64-1)	LF	4,460.00	\$12.00	\$53,520.00	\$8.00	\$35,680.00	\$10.20	\$45,492.00	\$7.42	\$33,093.20	\$10.70	\$47,722.00
99	6" DIAMETER PIPE UNDER DRAIN WITH STORM SEWER	LF	450.00	\$15.00	\$6,750.00	\$9.00	\$4,050.00	\$5.75	\$2,587.50	\$11.02	\$4,959.00	\$12.00	\$5,400.00
100	DETECTABLE WARNING PANNEL	EA	28.00	\$50.00	\$1,400.00	\$425.00	\$11,900.00	\$258.00	\$7,224.00	\$236.50	\$6,622.00	\$240.00	\$6,720.00
101	HEADWALL, 6" THICK, 4000 PSI CONCRETE, #5 BAR 6" O.C., DOWEL TO EXISTING BOX WALLS)	EA	1.00	\$2,200.00	\$2,200.00	\$260.00	\$260.00	\$1,800.00	\$1,800.00	\$3,212.00	\$3,212.00	\$1,500.00	\$1,500.00
102	CONNECT TO EXISTING STORM SEWER	EA	1.00	\$750.00	\$750.00	\$390.00	\$390.00	\$338.00	\$338.00	\$310.00	\$310.00	\$350.00	\$350.00
103	36" X 58.5" RCP ARCH PIPE, CLASS II	LF	252.00	\$120.00	\$30,240.00	\$160.00	\$40,320.00	\$144.00	\$36,288.00	\$157.50	\$39,690.00	\$171.00	\$43,092.00
104	42" RCP CLASS II	LF	195.00	\$100.00	\$19,500.00	\$109.00	\$21,255.00	\$96.00	\$18,720.00	\$110.20	\$21,489.00	\$115.00	\$22,425.00
105	30" RCP CLASS II	LF	400.00	\$65.00	\$26,000.00	\$70.00	\$28,000.00	\$59.50	\$23,800.00	\$65.50	\$26,200.00	\$70.00	\$28,000.00
106	24" RCP CLASS III	LF	580.00	\$55.00	\$31,900.00	\$56.00	\$32,480.00	\$47.50	\$27,550.00	\$49.70	\$28,826.00	\$60.00	\$34,800.00
107	18" RCP CLASS IV	LF	515.00	\$45.00	\$23,175.00	\$48.00	\$24,720.00	\$41.00	\$21,115.00	\$41.50	\$21,372.50	\$51.00	\$26,265.00
108	36" X 58.5" RCP ARCH PIPE, PRECAST 30 DEGREE BEND	EA	1.00	\$1,750.00	\$1,750.00	\$2,500.00	\$2,500.00	\$2,350.00	\$2,350.00	\$2,931.40	\$2,931.40	\$2,900.00	\$2,900.00
109	36" X 58.5" RCP ARCH PIPE, PRECAST 18" DIA. TEE PENETRATION	EA	1.00	\$1,800.00	\$1,800.00	\$2,600.00	\$2,600.00	\$2,450.00	\$2,450.00	\$3,004.14	\$3,004.14	\$2,900.00	\$2,900.00
110	36" X 58.5" RCP ARCH PIPE, PRECAST 24" DIA. TEE PENETRATION	EA	1.00	\$1,800.00	\$1,800.00	\$2,600.00	\$2,600.00	\$2,475.00	\$2,475.00	\$3,032.23	\$3,032.23	\$2,900.00	\$2,900.00

ITEM NO.	DESCRIPTION OF ITEM	UNIT	QTY (EST)	ENGINEER'S ESTIMATE		R.C.S. CONSTRUCTION, INC.		HILLS MATERIALS COMPANY		RAPID CONSTRUCTION COMPANY, LLC		SIMON CONTRACTORS OF SD, INC.	
				UNIT COST	EXTENDED COST	UNIT COST	EXTENDED COST	UNIT COST	EXTENDED COST	UNIT COST	EXTENDED COST	UNIT COST	EXTENDED COST
111	42" X 18" X 42" RCP TEE	EA	2.00	\$1,400.00	\$2,800.00	\$2,000.00	\$4,000.00	\$1,950.00	\$3,900.00	\$2,531.27	\$5,062.54	\$2,700.00	\$5,400.00
112	30" X 30" X 30" RCP TEE	EA	1.00	\$1,200.00	\$1,200.00	\$1,600.00	\$1,600.00	\$1,490.00	\$1,490.00	\$1,872.13	\$1,872.13	\$1,800.00	\$1,800.00
113	24" X 24" X 24" RCP TEE	EA	1.00	\$1,000.00	\$1,000.00	\$570.00	\$570.00	\$495.00	\$495.00	\$805.82	\$805.82	\$750.00	\$750.00
114	24" RCP 7.5 DEGREE BEND	EA	4.00	\$350.00	\$1,400.00	\$325.00	\$1,300.00	\$265.00	\$1,060.00	\$381.26	\$1,525.04	\$290.00	\$1,160.00
115	24" RCP CAP	EA	1.00	\$250.00	\$250.00	\$180.00	\$180.00	\$195.00	\$195.00	\$302.53	\$302.53	\$240.00	\$240.00
116	18" RCP CAP	EA	1.00	\$200.00	\$200.00	\$155.00	\$155.00	\$175.00	\$175.00	\$231.83	\$231.83	\$210.00	\$210.00
117	6' X 10' TYPE S INLET (SD DOT PLATE 670.37)	EA	4.00	\$5,200.00	\$20,800.00	\$2,700.00	\$10,800.00	\$4,650.00	\$18,600.00	\$5,911.92	\$23,647.68	\$6,000.00	\$24,000.00
118	STANDARD TYPE "E" INLET	EA	2.00	\$4,500.00	\$9,000.00	\$2,500.00	\$5,000.00	\$3,900.00	\$7,800.00	\$4,380.72	\$8,761.44	\$5,800.00	\$11,600.00
119	TYPE "B" INLET WITH VANED GRATE	EA	12.00	\$2,500.00	\$30,000.00	\$1,275.00	\$15,300.00	\$2,225.00	\$26,700.00	\$1,551.43	\$18,617.16	\$2,100.00	\$25,200.00
120	REINFORCED CONCRETE SPECIAL TYPE "B" INLET WITH VANED GRATE	EA	11.00	\$2,750.00	\$30,250.00	\$1,700.00	\$18,700.00	\$2,650.00	\$29,150.00	\$2,046.43	\$22,510.73	\$2,400.00	\$26,400.00
121	EDGE DRAIN CONNECTION TO INLETS	LS	1.00	\$3,500.00	\$3,500.00	\$350.00	\$350.00	\$1,050.00	\$1,050.00	\$100.00	\$100.00	\$1,100.00	\$1,100.00
122	2" RIGID CONDUIT, SCHEDULE 80	LF	160.00	\$10.00	\$1,600.00	\$8.00	\$1,280.00	\$6.00	\$960.00	\$10.00	\$1,600.00	\$12.00	\$1,920.00
123	SODDING	SY	5,760.00	\$7.50	\$43,200.00	\$7.00	\$40,320.00	\$4.33	\$24,940.80	\$5.72	\$32,947.20	\$6.10	\$35,136.00
124	TOPSOIL, PLACE 5" THICK (INCLUDING 1" INCORPORATED CO-COMPOST)	CY	670.00	\$15.00	\$10,050.00	\$6.00	\$4,020.00	\$20.00	\$13,400.00	\$20.00	\$13,400.00	\$8.20	\$5,494.00
125	HAULING AND PLACING CO-COMPOST	TON	85.00	\$25.00	\$2,125.00	\$9.00	\$765.00	\$26.00	\$2,210.00	\$47.30	\$4,020.50	\$50.00	\$4,250.00
126	STREET LIGHT ON BLACK HILLS POWER WOODEN POLE	EA	3.00	\$1,626.00	\$4,878.00	\$1,626.00	\$4,878.00	\$1,626.00	\$4,878.00	\$1,626.00	\$4,878.00	\$1,626.00	\$4,878.00
127	SIGN POST, 2" X 2" TUBE	EA	6.00	\$175.00	\$1,050.00	\$120.00	\$720.00	\$116.00	\$696.00	\$137.50	\$825.00	\$121.00	\$726.00
128	REGULATORY SIGN , R1-1 (STOP)	EA	6.00	\$125.00	\$750.00	\$100.00	\$600.00	\$100.00	\$600.00	\$82.50	\$495.00	\$104.50	\$627.00
129	REGULATORY SIGN , D3 (STREET NAME)	EA	12.00	\$125.00	\$1,500.00	\$84.00	\$1,008.00	\$79.00	\$948.00	\$110.00	\$1,320.00	\$82.50	\$990.00
130	REMOVE AND SALVAGE REGULATORY SIGN	EA	5.00	\$75.00	\$375.00	\$50.00	\$250.00	\$47.50	\$237.50	\$110.00	\$550.00	\$90.00	\$450.00
131	REMOVE AND RESET REGULATORY SIGN	EA	5.00	\$75.00	\$375.00	\$78.00	\$390.00	\$73.75	\$368.75	\$165.00	\$825.00	\$77.00	\$385.00
132	LANDSCAPE ROCK, (3"-6") WASHED WITH WEED BARRIER FABRIC	TON	150.00	\$60.00	\$9,000.00	\$67.00	\$10,050.00	\$45.00	\$6,750.00	\$49.50	\$7,425.00	\$52.50	\$7,875.00
133	LINDEN, 2" CAL.	EA	3.00	\$550.00	\$1,650.00	\$670.00	\$2,010.00	\$382.50	\$1,147.50	\$550.00	\$1,650.00	\$580.00	\$1,740.00
134	NEW HORIZON HYBRID ELM, 2" CAL.	EA	4.00	\$550.00	\$2,200.00	\$670.00	\$2,680.00	\$465.00	\$1,860.00	\$715.00	\$2,860.00	\$760.00	\$3,040.00
135	HONEY LOCUST - 2" CALIPER	EA	1.00	\$550.00	\$550.00	\$670.00	\$670.00	\$382.25	\$382.25	\$495.00	\$495.00	\$525.00	\$525.00
136	JUNIPER PRINCE OF WHALES, 5 GAL.	EA	4.00	\$500.00	\$2,000.00	\$670.00	\$2,680.00	\$60.10	\$240.40	\$60.50	\$242.00	\$64.00	\$256.00
137	SPIREA, DWARF GUMBALL	EA	4.00	\$550.00	\$2,200.00	\$670.00	\$2,680.00	\$49.50	\$198.00	\$27.50	\$110.00	\$29.00	\$116.00
138	MINIATURE LILAC	EA	1.00	\$550.00	\$550.00	\$670.00	\$670.00	\$246.00	\$246.00	\$55.00	\$55.00	\$58.00	\$58.00
139	CHOKE CHERRY, 1.5" CAL.	EA	1.00	\$500.00	\$500.00	\$670.00	\$670.00	\$246.00	\$246.00	\$385.00	\$385.00	\$410.00	\$410.00

ITEM NO.	DESCRIPTION OF ITEM	UNIT	QTY (EST)	ENGINEER'S ESTIMATE		R.C.S. CONSTRUCTION, INC.		HILLS MATERIALS COMPANY		RAPID CONSTRUCTION COMPANY, LLC		SIMON CONTRACTORS OF SD, INC.	
				UNIT COST	EXTENDED COST	UNIT COST	EXTENDED COST	UNIT COST	EXTENDED COST	UNIT COST	EXTENDED COST	UNIT COST	EXTENDED COST
140	MALLUS SPRING SNOW CRAB (FRUITLESS) - MIN 2" CALIPER	EA	2.00	\$500.00	\$1,000.00	\$670.00	\$1,340.00	\$355.00	\$710.00	\$467.50	\$935.00	\$500.00	\$1,000.00
141	DWARF ALBERTA SPURCE	EA	4.00	\$500.00	\$2,000.00	\$670.00	\$2,680.00	\$105.00	\$420.00	\$93.50	\$374.00	\$100.00	\$400.00
TOTALS					\$2,100,000.00		\$1,884,189.50		\$1,927,171.11		\$2,121,885.16		\$2,802,757.45

CONSULTANT

I certify that, to the best of my knowledge, this is a true tabulation of bids received for this project.

Kale R. McNaboe 3-31-10  
Kale McNaboe, PE Date  
Sperlich Consulting, Inc.

Contract awarded to \_\_\_\_\_ in the amount of  
\$ \_\_\_\_\_ at the \_\_\_\_\_ Council Meeting.

CITY OF RAPID CITY

Reviewed by:

Stacey P. Titus 3/31/10  
Stacey Titus, PE Date

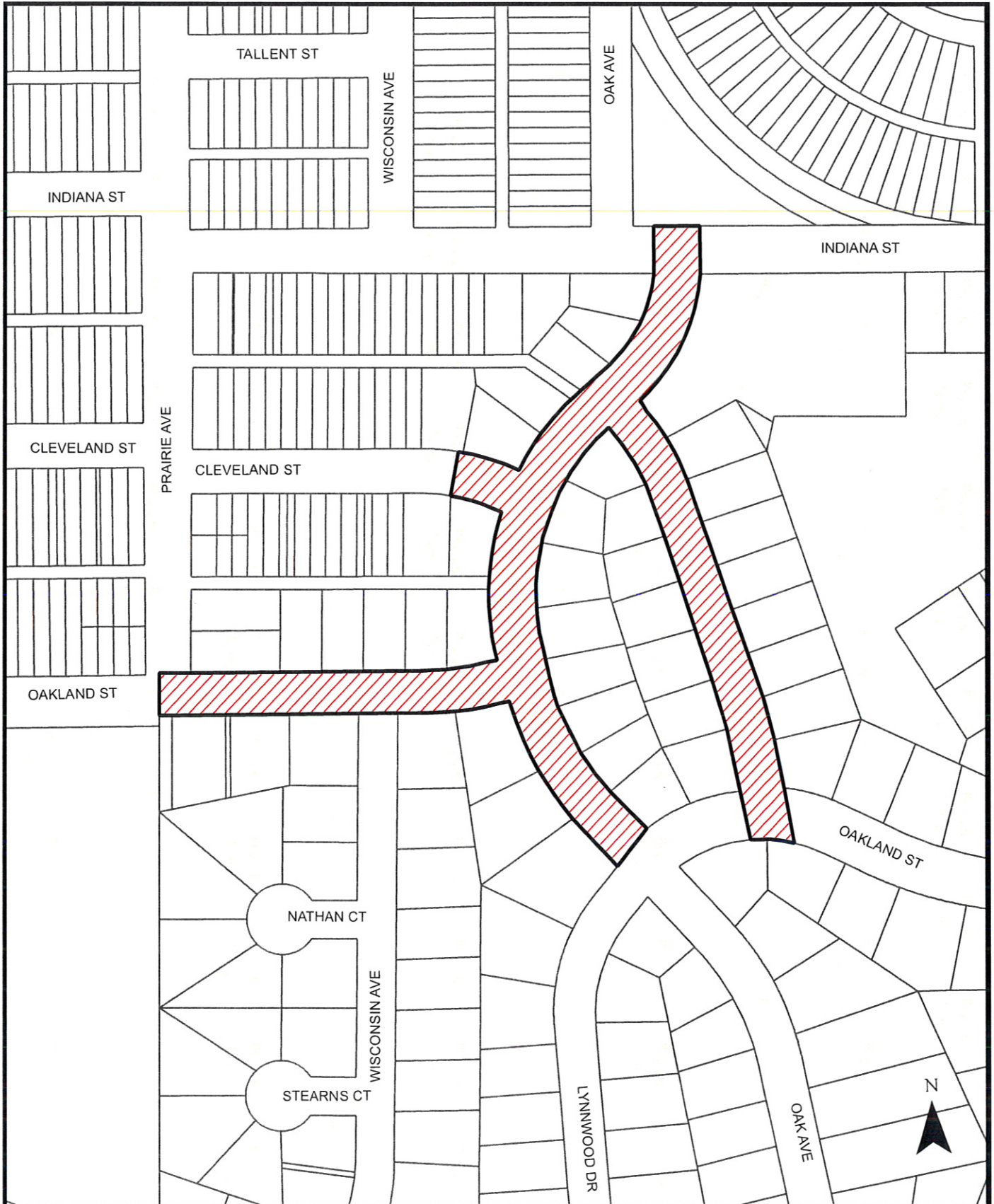

**OAK AVE, OAK DR & OAKLAND ST RECONSTRUCTION PROJECT**  
**PROJECT NO. ST09-1824** **CIP NO. 50424**