

**NOTES:**

1. CLEAR & GRUB ONLY AREAS THAT NEED TO BE CUT/FILLED.
2. REMOVE TREES WITHIN THE FOLLOWING TOLERANCES:  
 -5' FROM EXTERIOR OF SITE FENCE  
 -3' FROM INTERIOR OF SITE FENCE  
 -5' FROM ANY BUILDING OR STRUCTURE  
 -3' FROM EDGE OF ROAD
3. REMOVE TREE LIMBS THAT OVERHANG THE ROAD UP TO 10' IN HEIGHT.
4. TREES 12" DIA. AND LARGER SHALL NOT BE DISTURBED FOR ANY REASON UNLESS THEY LIE IN THE ABOVE TOLERANCES.
5. ALL DISTURBED AREAS THAT ARE UNIMPROVED SHALL BE COVERED WITH 4" OF TOPSOIL & SEEDED WITH MAINE GRASS ACCORDING TO SPECIFICATION 00000.

**LANDSCAPE QUANTITIES**

EXISTING PINE TREES > 12" DIA. = 119\*  
 POST CONSTRUCTION PINE TREES > 12" DIA. = 48\*  
 POST CONSTRUCTION NATIVE GRASS AREA = 2,000 SQ YD

\*TREE QUANTITIES ARE AN ESTIMATE BASED ON SURVEYED DENSITY OF A 10% X 10% GRID, AND THE PERCENTAGE OF THE SITE THAT WILL BE CLEARED.

\* APPROXIMATE LOCATION OF >12" DIA. PINE TREE TO BE SAVED

**LANDSCAPING POINTS**

TOTAL LOT SIZE	45,568 SQ FT	
TANK AREA	4,418 SQ FT	
WALK WAY/VAULT SIZE	430 SQ FT	
TOTAL DEVELOPED AREA	40,720 SQ FT	40,700 POINTS REQUIRED
POST CONSTRUCTION PINE TREES	48 EA	+ 61,000 POINTS PROVIDED
POST CONSTRUCTION GRASS AREA	2,000 SQ YD	+ 20,000 POINTS PROVIDED
		112,000 TOTAL POINTS PROVIDED

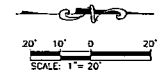
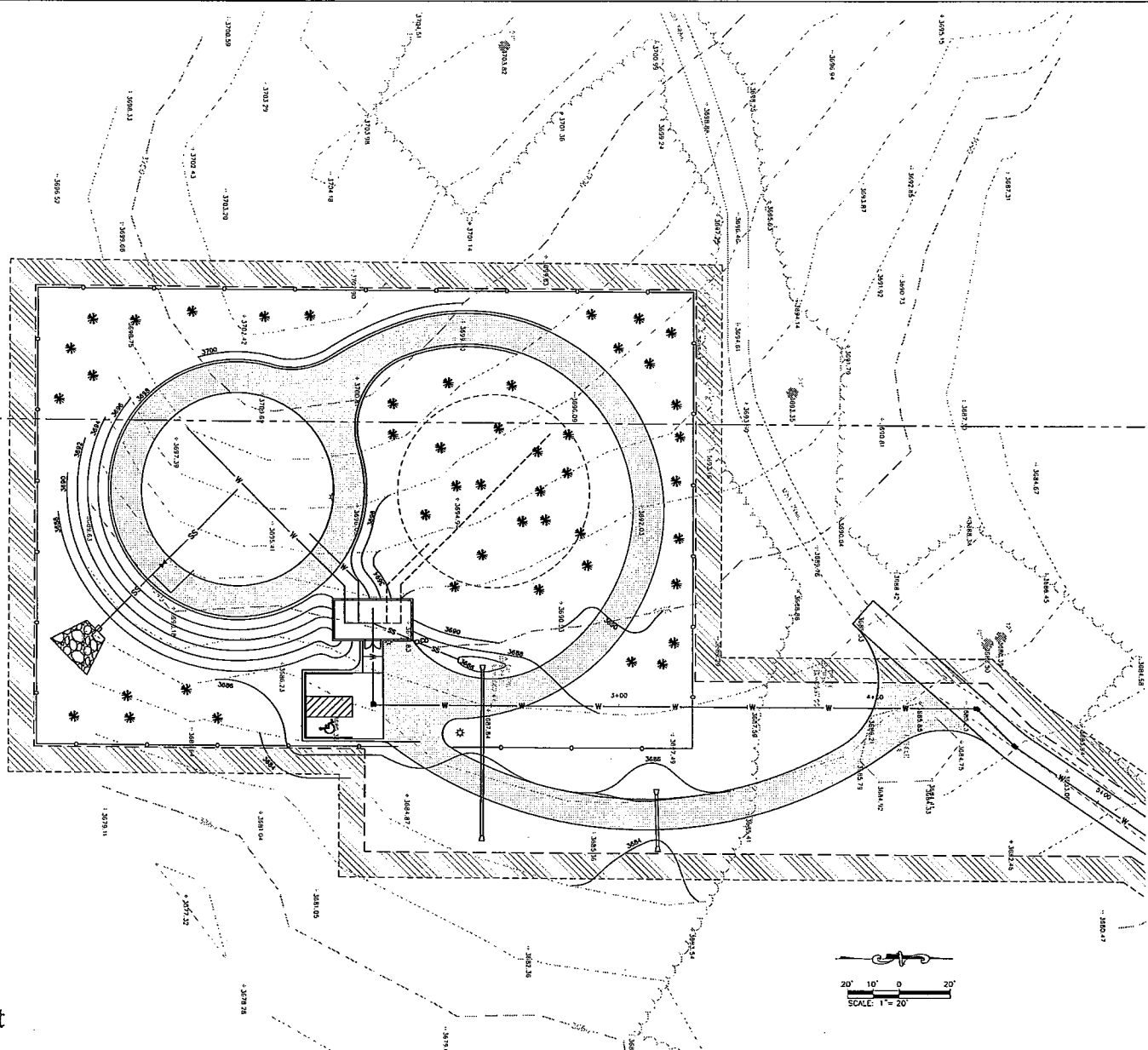

RECEIVED

DEC 21 2009

Rapid City Growth  
 Management Department



**F M G, Inc.**  
 3700 Sangle Road  
 Rapid City, SD 57702-0517  
 www.fmgengineering.com



65% SUBMITTAL  
 NOT  
 FOR  
 CONSTRUCTION

Scale: 1"=20'  
 Drawn By: JAP  
 Design Date: DEC. 2009  
 Project No.: 07858108  
 Survey Date: 2005-502

NORTH PINEDALE WATER STORAGE RESERVOIR  
 FOR GOOD SAMARITAN SOCIETY  
 SAINT MARTIN'S VILLAGE

LANDSCAPE  
 PLAN