

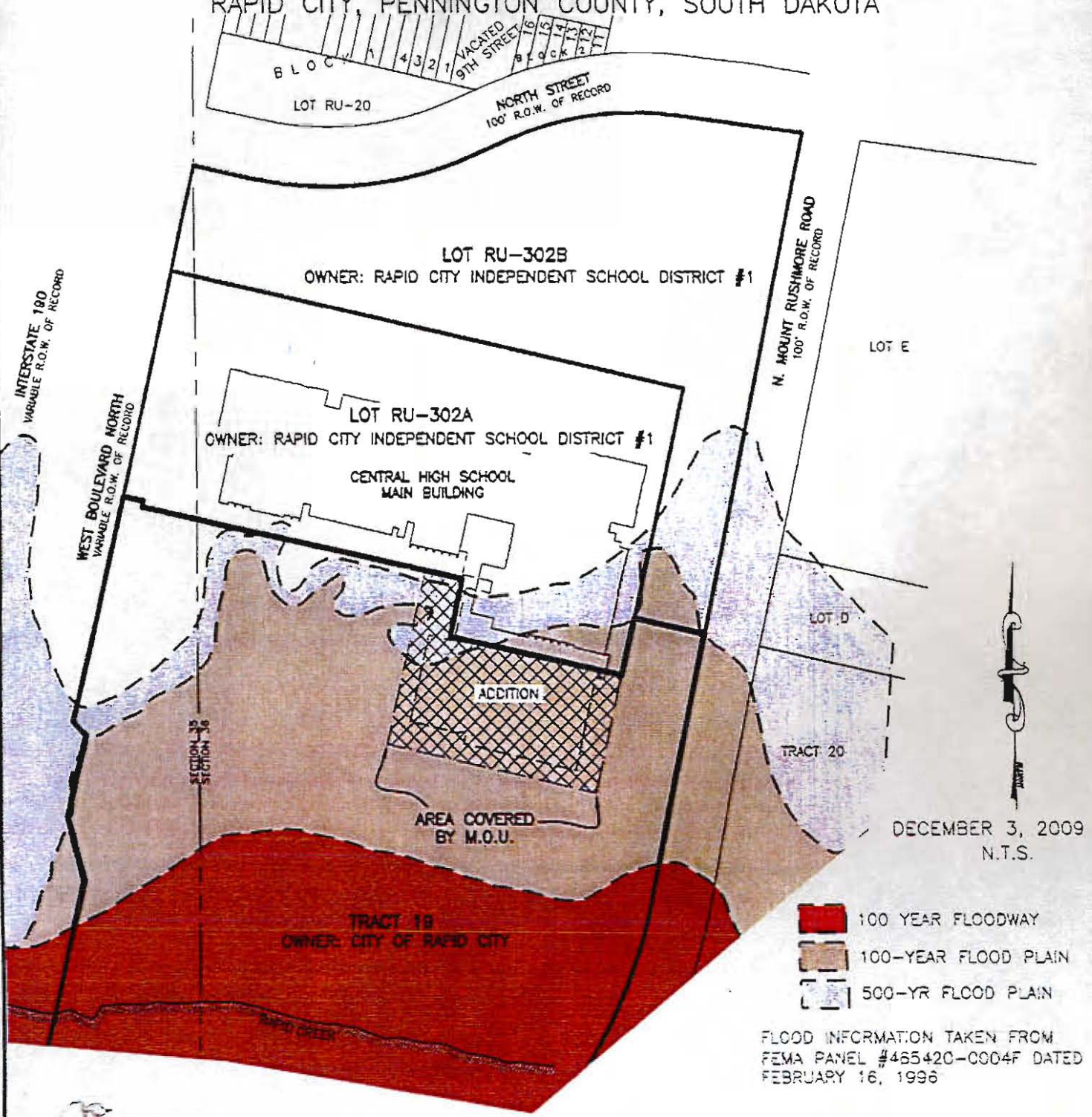



A PORTION OF TRACT 19 OF RAPID CITY GREENWAY TRACT

LOCATED IN SECTION 36, T2N, R7E, BHM
RAPID CITY, PENNINGTON COUNTY, SOUTH DAKOTA



-  100 YEAR FLOODWAY
-  100-YEAR FLOOD PLAIN
-  500-YR FLOOD PLAIN

FLOOD INFORMATION TAKEN FROM
FEMA PANEL #465420-0004F DATED
FEBRUARY 16, 1996

RENNER & ASSOCIATES, LLC.

616 SIXTH ST. * RAPID CITY, SD 57701
PHONE: 605 721-7310 FAX: 605 721-7313
SPEARFISH OFFICE: 605.717.0016

RECEIVED



CITY HALL 1903

DEC 09 2009 #2416

Rapid City Growth
Management Department