

PRELIMINARY FOR REVIEW ONLY

CITY OF RAPID CITY
 GROWTH MANAGEMENT DEPT.
 DEVELOPMENT SERVICES

Plans are reviewed for general conformance with applicable governmental regulations, stipulations, design criteria and engineering standards. The City of Rapid City does not certify the suitability, adequacy or completeness of the plans or design, which are the responsibility of the engineer of record. All necessary permits shall be obtained prior to construction of the proposed public improvements.

Engineering Reviewer: _____ Date: _____
 COMMENTS

Internal Job No: 09-0550 | Designed By: TC | Drawn By: MLS
 Surveyed By: RENNER & ASSOCIATES | Survey Date: 07/2009
 Submittals:

PARKING INFORMATION REQUIRED: 51 STALLS
 4550 SQ. FT. @ 11/1,000 SQ. FT.
 PROPOSED: 71 STALLS TOTAL
 3 ADA ACCESSIBLE
 7 STACKING FOR DRIVE THRU

Revisions:

Project Name: PIZZA RANCH
 Sheet Name: SITE PLAN
 Sheet Number: 3 of 15

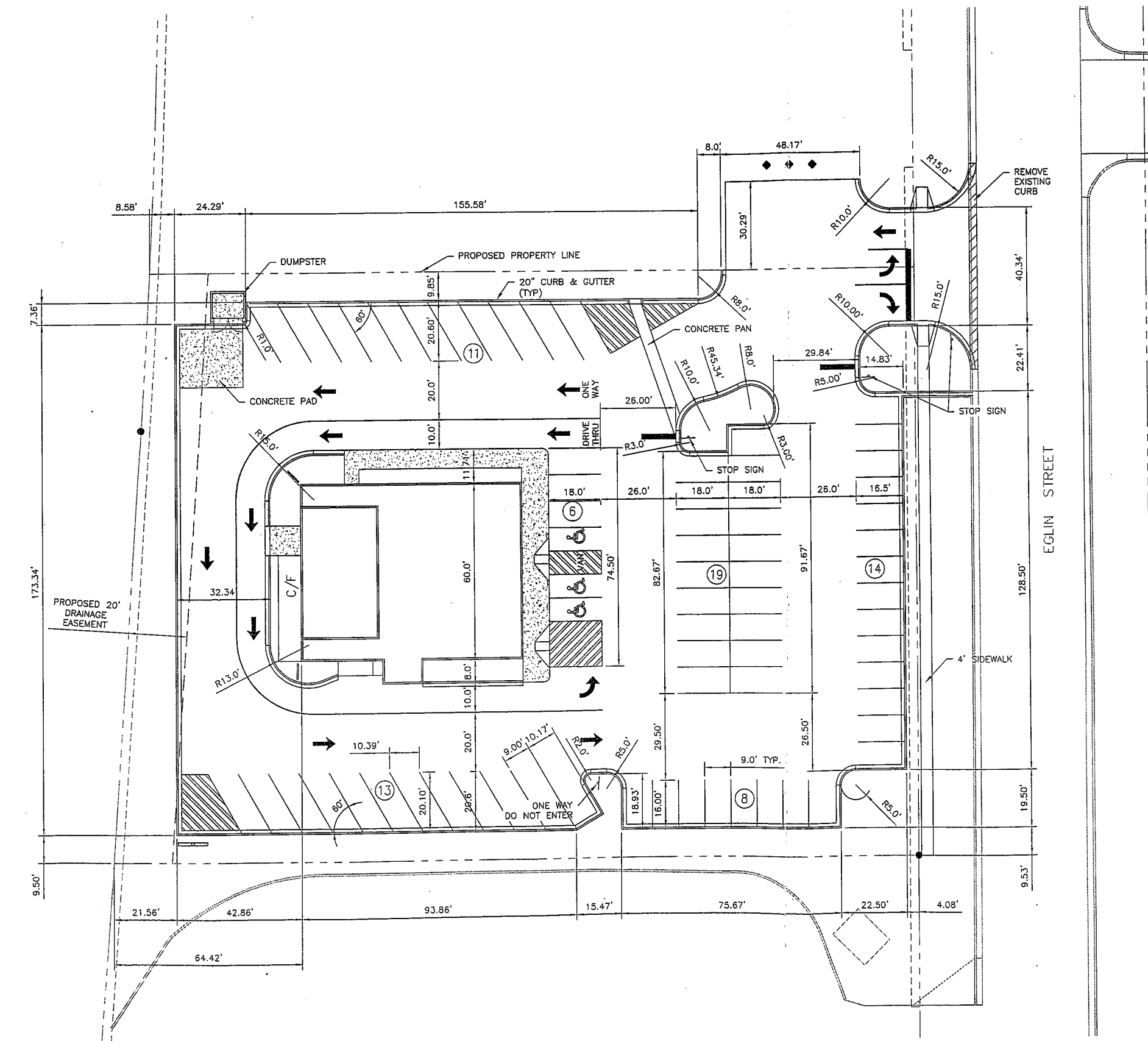

NOTE:
 DIMENSIONS ARE TO TOP BACK OF CURB
 UNLESS OTHERWISE NOTED.

ALL CURB AND GUTTER LOCATED WITHIN
 THE ROW SHALL BE RAPID CITY
 STANDARD 32". SEE DETAIL SHEET.

ELEVATIONS ARE BASED ON CITY OF
 RAPID CITY BENCH MARK #2048, WITH A
 PUBLISHED ELEVATION OF (NGVD 29)
 3196.66'

PARKING INFORMATION REQUIRED: 51 STALLS
 4550 SQ. FT. @ 11/1,000 SQ. FT.
 PROPOSED: 71 STALLS TOTAL
 3 ADA ACCESSIBLE
 7 STACKING FOR DRIVE THRU

