

ALL CONSTRUCTION SHALL CONFORM TO THE CURRENT EDITION OF THE CITY OF RAPID CITY STANDARD SPECIFICATIONS

ALL CONCRETE SIDEWALKS SHALL RECEIVE A BRUSHED OR BROOMED FINISH

HERMANSON EGGE ENGINEERING, INC.
 STRUCTURAL CONSULTING ENGINEERS
 2893 COMMERCIAL RD. S. RAPID CITY, SD 57702
 PHONE (605) 342-5426 FAX (605) 342-8452

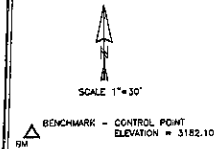

SCALE 1" = 30'

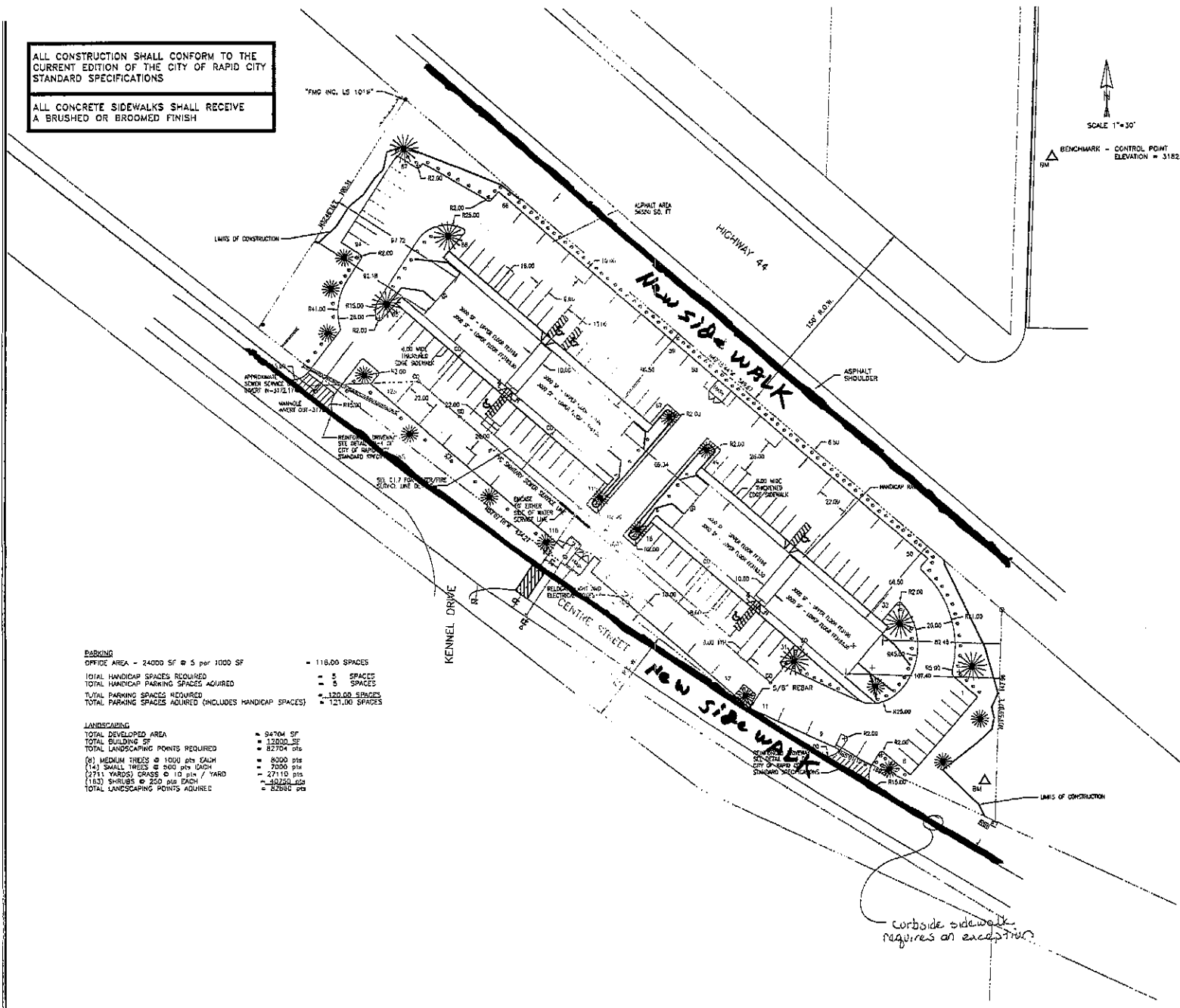

Parking

OFFICE AREA - 24000 SF @ 5 per 1000 SF	= 118.00 SPACES
TOTAL HANDICAP SPACES REQUIRED	= 5 SPACES
TOTAL HANDICAP PARKING SPACES ACQUIRED	= 5 SPACES
TOTAL PARKING SPACES REQUIRED	= 123.00 SPACES
TOTAL PARKING SPACES ACQUIRED (INCLUDES HANDICAP SPACES)	= 121.00 SPACES

LANDSCAPING

TOTAL DEVELOPED AREA	= 34704 SF
TOTAL BUILDING SF	= 13200 SF
TOTAL LANDSCAPING POINTS REQUIRED	= 82704 pts
(8) MEDIUM TREES @ 1000 pts EACH	= 8000 pts
(143) SMALL TREES @ 500 pts EACH	= 72050 pts
(2751) GRASS @ 10 sq. ft. / YARD	= 27510 pts
(153) SHRUBS @ 250 pts EACH	= 38250 pts
TOTAL LANDSCAPING POINTS ACQUIRED	= 82650 pts

PHASE II
 Rev. 1/25



REVISED
 1770 CENTRE STREET
 LOT 3 OF LOT 4 OF LOT B
 OF SECTION 5, T1N, R8E, B1M
 RAPID CITY, PENNINGTON COUNTY, SOUTH DAKOTA

FINAL SITE
 PARKING / LANDSCAPING PLAN

PROJECT NO. 04-038 DRAWING NO.

DATE: 7/7/08
 SCALE: AS SHOWN

C1.2

If this drawing is not 24" x 36" it is a reduced print.

curbside sidewalk requires an exception