

# EXHIBIT A

PERMANENT UTILITY EASEMENT RESERVED WITHIN THE  
SW1/4 SE1/4 NW1/4 OF SECTION 9,  
TOWNSHIP 1 NORTH, RANGE 8 EAST OF THE BLACK HILLS MERIDIAN  
RAPID CITY, PENNINGTON COUNTY, SOUTH DAKOTA.

SHEET 1 of 2



SCALE: 1" = 1000'  
0 500 1000

JUNE, 2009

## VICINITY MAP

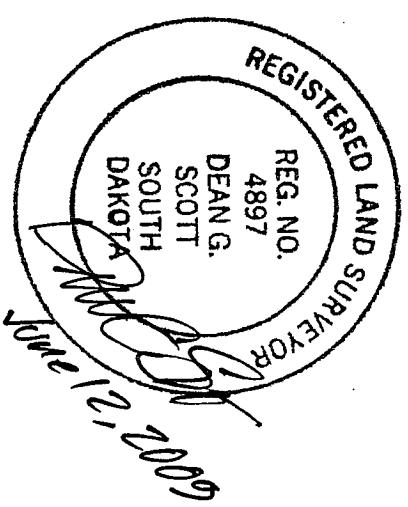

### NOTES

1. BEARING ORIENTATION IS BASED ON THE CITY OF RAPID CITY SURVEY CONTROL NETWORK. DISTANCES ARE BASED ON THE SAME NETWORK AND THE SCALE FACTOR DETERMINED THIS SURVEY IS 0.99979 (VALUES SHOWN ARE SHORTER THAN SURFACE).
2. DISTANCES SHOWN IN PARENTHESIS ARE OF RECORD.

PREPARED BY:

**D.C. Scott**  
SURVEYORS, INC.  
3153 ANDERSON ROAD  
RAPID CITY, SD 57703  
(605) 393-2400

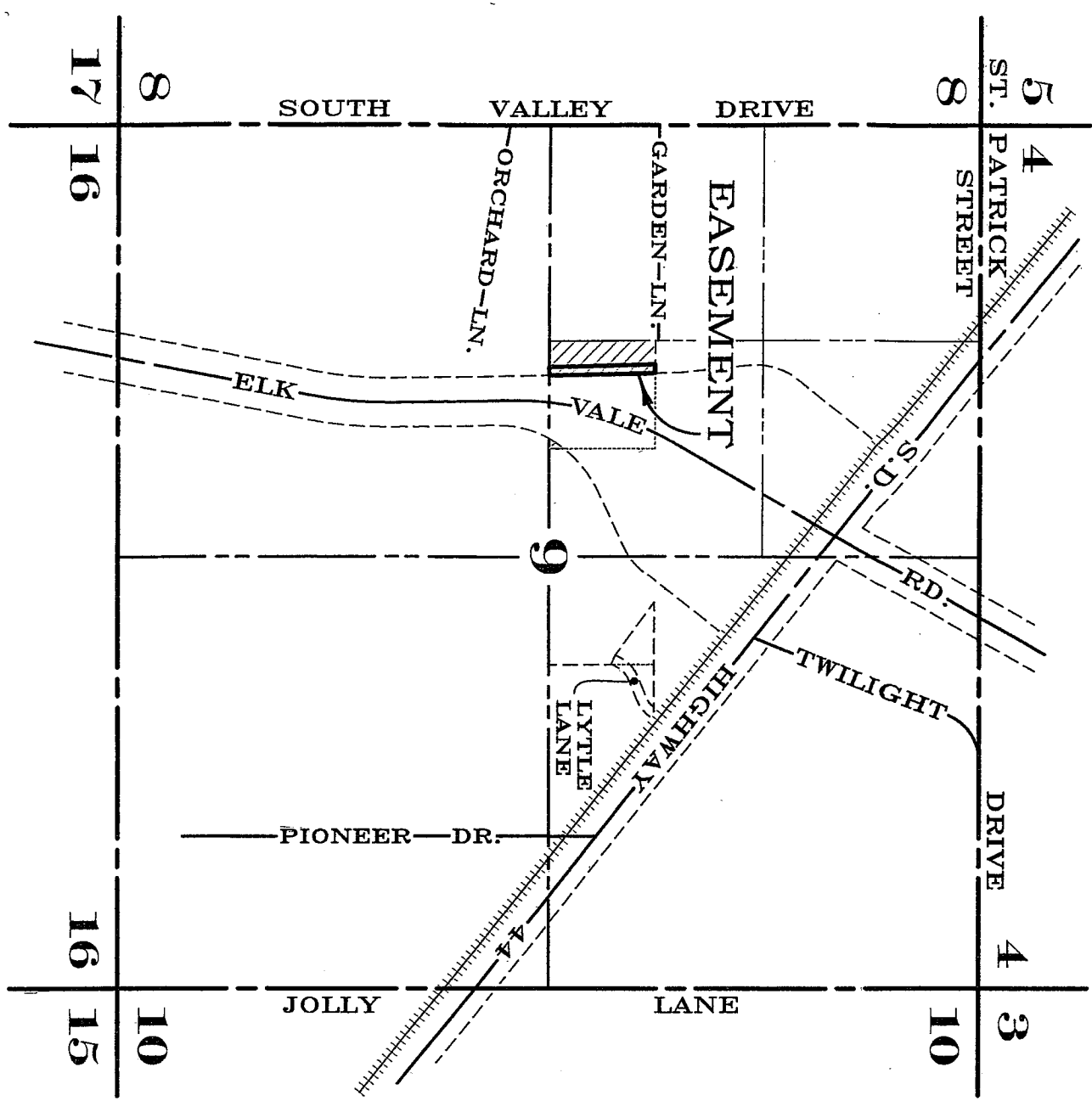

S 88°03'58" E  
8.00'

DOT CAP BEARS  
N57°57'E 147.85'

CENTER OF  
SE1/4 NW1/4

DETAIL

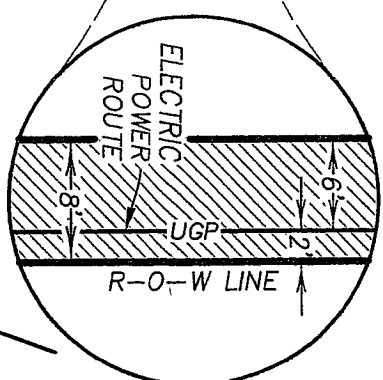

ELK

LEGEND

- FOUND IRON ROD WITH ALUM-INUM CAP MARKED 'SD DOT'.
- R-O-W RIGHT-OF-WAY.
- UGP— UNDERGROUND POWER LINE.
- SECTION LINE.
- 1/4 SECTION LINE.
- 1/16 SECTION LINE.
- 1/64 SECTION LINE.
- OTHER PROPERTY LINE.

SW1/4  
SE1/4  
NW1/4

SE1/4  
SE1/4  
NW1/4

SCALE: 1" = 100'

0 50 100  
S.F.=0.99979



1/16 LINE

N 00°57'57" E 662.21'  
S 00°57'57" W 662.21'

R-O-W LINE

PREPARED BY:  
**D.C. Scott**  
SURVEYORS, INC.  
3153 ANDERSON ROAD  
RAPID CITY, SD 57703  
(605) 393-2400

DOT CAP BEARS  
S57°57'W 4.73'

N 88°05'07" W  
8.00'

S 88°05'07" E 382.27'

1/4 LINE

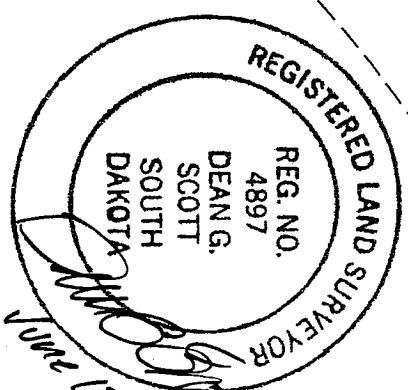

June 12, 2009