

BID SUMMARY
July 6, 2009

1. No. CC070609-2.1 - Street Rehabilitation Project – Copperfield Drive Area Project No. ST09-1798 / CIP No. 50549 (Opened on June 30, 2009)

ADVERTISING AUTHORITY	\$220,000.00
ENGINEER'S ESTIMATE	\$188,940.00

1. *Simon Contractors of SD Inc.	\$176,797.00
2. *J&J Asphalt Company	\$189,157.50
3. *Hills Materials Company	\$179,854.50

2. No. CC070609-2.2 – 2009 Pavement Marking Project Project No. PM09-1779 / CIP No. 50593 (Opened on June 30, 2009)

ADVERTISING AUTHORITY	\$36,000.00
ENGINEER'S ESTIMATE	\$35,925.00

1. *Dakota Traffic Services LLC	\$67,805.00
2. *Highmark Traffic Services Inc	\$68,212.50

3. No. CC070609-2.3 – Street Rehabilitation Project Mahoney, Dakota Ridge, W. Omaha & Hall Street Areas Project No. ST09-1799 / CIP No. 50549 (Opened on June 30, 2009)

ADVERTISING AUTHORITY	\$280,000.00
ENGINEER'S ESTIMATE	\$218,918.00

1. *Simon Contractors of SD Inc	\$280,861.00
2. *Hills Materials Company	\$249,849.00

4. No. CC070609-02.4 – Sanitary Sewer Extension East Boulevard Block 110 Original Townsite (Kansas City Street to Quincy Street) Project No. SS08-1752 / CIP No. 50742 (Opened on June 30, 2009)

ADVERTISING AUTHORITY	\$59,400.00
ENGINEER'S ESTIMATE	\$50,500.00

1. *Grizzly Excavation Inc.	\$62,967.46
2. *Simon Contractors of SD Inc.	\$55,529.50
3. *Highmark Inc.	\$57,126.00
4. *Quinn Construction	\$77,902.00
5. *Hills Materials Company	\$57,709.00
6. *Mainline Contracting, Inc.	\$61,467.00

BID SUMMARY
July 6, 2009

5. No. CC070609-02.5 – Tower Road Water Main Project Project No. W09-1786 / CIP No. 50753
(Opened June 30, 2009)

ADVERTISING AUTHORITY	\$237,000.00
-----------------------	--------------

	Base Bid	Alternate 1	Base Bid Plus Alternate 1
ENGINEER'S ESTIMATE	\$210,006.77	\$57,513.24	\$267,520.01
1. *Grizzly Excavation	\$191,269.21	\$57,486.75	\$248,755.96
2. *Simon Contractors of SD Inc.	\$202,888.00	\$52,851.25	\$255,739.25
3. *Rapid Construction Co. LLC	\$238,924.00	\$59,605.00	\$298,529.00
4. *Highmark Inc.	\$165,506.50	\$51,852.25	\$217,358.75
5. *Quinn Construction Inc	\$243,949.00	\$59,092.50	\$303,041.50
6. *Hills Materials Company	\$185,280.40	\$56,515.00	\$241,795.40
7. *Mainline Contracting Inc.	\$198,687.50	\$56,812.50	\$255,500.00

* Bid Bond Enclosed

**Cashier's Check Enclosed

BID AWARD SUMMARY

LETTING DATE: June 30, 2009

PROJECT: Street Rehabilitation Project – Copperfield Drive Area
Project No. ST09-1798 / CIP No. 50549

RECOMMENDATION: Award Total Bid in the amount of \$176,797.00 to Simon Contractors of SD, Inc. at the July 6, 2009 Council Meeting.

BIDDERS' SUMMARY

CONTRACTORS

TOTAL BID

Simon Contractors of SD, Inc.	\$176,797.00
Hills Materials Company	\$179,854.50
J & J Asphalt Company	\$189,157.50

City staff recommends awarding this project to Simon Constructor of SD, Inc. for a total bid amount of \$176,797.00 based on unit pricing with the following appropriation:

FUNDING SOURCE	TOTAL	Streets
ADVERTISING AUTHORITY	\$220,000.00	\$220,000.00
ENGINEER'S ESTIMATE	\$188,940.00	\$188,940.00

APPROPRIATION DATA:

FUNDING SOURCE	TOTAL	Streets
COST CENTER		8910
LINE ITEM		4370
FUNDING CENTER		0505
BID AMOUNT	\$176,797.00	\$176,797.00

PROJECT MANAGER:

Todd Peckosh, P.E.

DATE: July 1, 2009

BID TABULATION
STREET REHABILITATION PROJECT – COPPERFIELD DRIVE AREA
PROJECT NO. ST09-1798 / CIP NO. 50549
BID LETTING DATE: JUNE 30, 2009

ITEM NO.	DESCRIPTION OF ITEM	UNIT	QTY (EST)	ENGINEER'S ESTIMATE		SIMON CONTRACTORS OF SD, INC.		HILLS MATERIALS COMPANY		J & J ASPHALT COMPANY	
				UNIT COST	EXTENDED COST	UNIT COST	EXTENDED COST	UNIT COST	EXTENDED COST	UNIT COST	EXTENDED COST
1	Mobilization	LS	1.00	\$5,000.00	\$5,000.00	\$2,000.00	\$2,000.00	\$4,000.00	\$4,000.00	\$9,000.00	\$9,000.00
2	Asphalt Milling	SYD	10,350.00	\$2.15	\$22,252.50	\$1.70	\$17,595.00	\$1.45	\$15,007.50	\$2.15	\$22,252.50
3	Remove Sidewalk	SF	60.00	\$1.75	\$105.00	\$2.75	\$165.00	\$1.60	\$96.00	\$6.00	\$360.00
4	Remove and Replace Curb & Gutter	LF	150.00	\$40.00	\$6,000.00	\$33.00	\$4,950.00	\$32.00	\$4,800.00	\$26.00	\$3,900.00
5	Type E Inlet Throat Repair	LS	1.00	\$1,500.00	\$1,500.00	\$990.00	\$990.00	\$900.00	\$900.00	\$1,500.00	\$1,500.00
6	Spall Repair	SF	4.00	\$70.00	\$280.00	\$44.00	\$176.00	\$58.00	\$232.00	\$100.00	\$400.00
7	Remove and Replace Pan	SF	144.00	\$12.50	\$1,800.00	\$9.00	\$1,296.00	\$12.75	\$1,836.00	\$12.50	\$1,800.00
8	Remove and Replace Sidewalk	SF	300.00	\$7.50	\$2,250.00	\$8.00	\$2,400.00	\$14.50	\$4,350.00	\$6.00	\$1,800.00
9	Remove & Replace Fillet	SF	50.00	\$12.50	\$625.00	\$12.00	\$600.00	\$20.50	\$1,025.00	\$15.00	\$750.00
10	Landscape Rock	TON	3.00	\$35.00	\$105.00	\$45.00	\$135.00	\$105.00	\$315.00	\$50.00	\$150.00
11	3/4" Base Course	TON	20.00	\$18.50	\$370.00	\$29.00	\$580.00	\$58.00	\$1,160.00	\$35.00	\$700.00
12	Detectible Warning Panel	SF	88.00	\$35.00	\$3,080.00	\$30.00	\$2,640.00	\$27.25	\$2,398.00	\$30.00	\$2,640.00
13	Full Depth Repair	SYD	160.00	\$37.50	\$6,000.00	\$49.00	\$7,840.00	\$69.00	\$11,040.00	\$67.00	\$10,720.00
14	Mill Patch	SYD	125.00	\$15.00	\$1,875.00	\$38.00	\$4,750.00	\$39.00	\$4,875.00	\$23.00	\$2,875.00
15	Digouts	CYD	25.00	\$12.50	\$312.50	\$24.00	\$600.00	\$50.00	\$1,250.00	\$30.00	\$750.00
16	Sugar Rock	TON	50.00	\$20.00	\$1,000.00	\$34.00	\$1,700.00	\$50.00	\$2,500.00	\$40.00	\$2,000.00
17	Crack Repair	LF	440.00	\$7.50	\$3,300.00	\$7.00	\$3,080.00	\$13.50	\$5,940.00	\$5.00	\$2,200.00

ITEM NO.	DESCRIPTION OF ITEM	UNIT	QTY (EST)	ENGINEER'S ESTIMATE		SIMON CONTRACTORS OF SD, INC.		HILLS MATERIALS COMPANY		J & J ASPHALT COMPANY	
				UNIT COST	EXTENDED COST	UNIT COST	EXTENDED COST	UNIT COST	EXTENDED COST	UNIT COST	EXTENDED COST
18	12" Petrotac 4591	LF	100.00	\$3.50	\$350.00	\$2.70	\$270.00	\$1.40	\$140.00	\$1.40	\$140.00
19	Asphalt Surface Treatment - AE150S	TON	20.00	\$650.00	\$13,000.00	\$990.00	\$19,800.00	\$625.00	\$12,500.00	\$1,300.00	\$26,000.00
20	Cover Aggregate - Type 2A	TON	195.00	\$60.00	\$11,700.00	\$69.00	\$13,455.00	\$53.50	\$10,432.50	\$70.00	\$13,650.00
21	Asphalt for Fog Seal - CSS1H/SS1H	TON	3.50	\$1,250.00	\$4,375.00	\$1,450.00	\$5,075.00	\$1,225.00	\$4,287.50	\$1,100.00	\$3,850.00
22	Asphalt Leveling Course	TON	40.00	\$150.00	\$6,000.00	\$115.00	\$4,600.00	\$95.00	\$3,800.00	\$100.00	\$4,000.00
23	Asphalt Overlay PG64-28	TON	920.00	\$98.00	\$90,160.00	\$85.00	\$78,200.00	\$83.50	\$76,820.00	\$78.50	\$72,220.00
24	Incidental	LS	1.00	\$3,000.00	\$3,000.00	\$1,500.00	\$1,500.00	\$5,500.00	\$5,500.00	\$3,500.00	\$3,500.00
25	Erosion Control	LS	1.00	\$1,000.00	\$1,000.00	\$700.00	\$700.00	\$650.00	\$650.00	\$500.00	\$500.00
26	Traffic Control	LS	1.00	\$3,500.00	\$3,500.00	\$1,700.00	\$1,700.00	\$4,000.00	\$4,000.00	\$1,500.00	\$1,500.00
TOTALS					\$188,940.00		\$176,797.00		\$179,854.50		\$189,157.50

I certify that, to the best of my knowledge, this is a true tabulation of bids received for this project.

FOR  7/1/09
 Todd Peckosh, P.E.
 Project Manager

Date

Contract awarded to _____ in the amount of
 \$ _____ at the _____ Council Meeting.

EXHIBIT 'A'

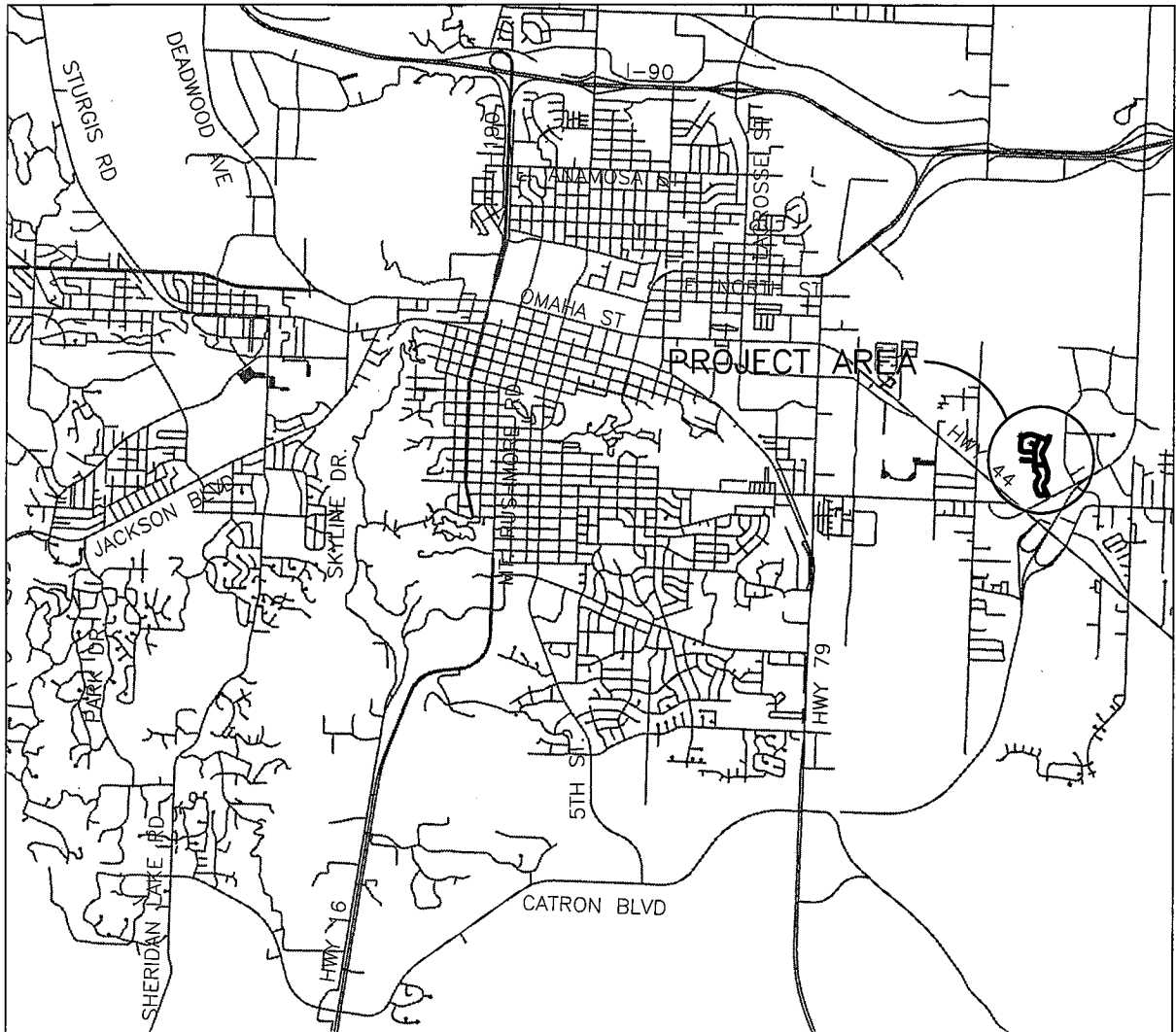

STREET REHABILITATION PROJECT COPPERFIELD DRIVE AREA

PROJECT # ST09-1798, CIP 50549

BID AWARD SUMMARY

LETTING DATE: June 30, 2009

PROJECT: 2009 Pavement Marking Project
Project No. PM09-1779 / CIP No. 50593

RECOMMENDATION: Reject all bids at the July 6, 2009 Council Meeting.

BIDDERS' SUMMARY

<u>CONTRACTORS</u>	<u>TOTAL BID</u>
Dakota Traffic Services, LLC	\$67,805.00
Highmark Traffic Services, Inc.	\$68,212.50

City staff recommends rejecting all bids.

FUNDING SOURCE	TOTAL	Streets
ADVERTISING AUTHORITY	\$36,000.00	\$36,000.00
ENGINEER'S ESTIMATE	\$35,925.00	\$35,925.00

PROJECT MANAGER: John Less / ws
John Less, P.E.

DATE: July 1, 2009

BID AWARD SUMMARY

LETTING DATE: June 30, 2009

PROJECT: Street Rehabilitation Project –
Mahoney, Dakota Ridge, W. Omaha & Hall Street Areas
Project No. ST09-1799 / CIP No. 50549

RECOMMENDATION: Award Total Bid in the amount of \$249,849.00 to Hills Materials Company at the July 6, 2009 Council Meeting.

BIDDERS' SUMMARY

<u>CONTRACTORS</u>	<u>TOTAL BID</u>
Hills Materials Company	\$249,849.00
Simon Contractors of SD, Inc.	\$280,861.00

City staff recommends awarding this project to Hills Materials Company for a total bid amount of \$249,849.00 based on unit pricing with the following appropriation:

FUNDING SOURCE	TOTAL	Vision 2012	Streets
ADVERTISING AUTHORITY	\$280,000.00	\$254,000.00	\$26,000.00
ENGINEER'S ESTIMATE	\$218,918.00	\$218,918.00	\$0.00

APPROPRIATION DATA:

FUNDING SOURCE	TOTAL	Vision 2012	Streets
COST CENTER		0135	8910
LINE ITEM		4370	4370
FUNDING CENTER		0107	0505
BID AMOUNT	\$249,849.00	\$249,849.00	\$0.00

PROJECT MANAGER:

FOR Todd Peckosh, P.E.

DATE: July 1, 2009

BID TABULATION
STREET REHABILITATION PROJECT – MAHONEY, DAKOTA RIDGE, W. OMAHA & HALL STREET AREAS
PROJECT NO. ST09-1799 / CIP NO. 50549
BID LETTING DATE: JUNE 30, 2009

ITEM NO.	DESCRIPTION OF ITEM	UNIT	QTY (EST)	ENGINEER'S ESTIMATE		HILLS MATERIALS COMPANY		SIMON CONTRACTORS OF SD, INC.	
				UNIT COST	EXTENDED COST	UNIT COST	EXTENDED COST	UNIT COST	EXTENDED COST
1	Mobilization	LS	1	\$10,000.00	\$10,000.00	\$6,600.00	\$6,600.00	\$2,900.00	\$2,900.00
2	Adjust Manhole	EA	1	\$1,000.00	\$1,000.00	\$700.00	\$700.00	\$1,300.00	\$1,300.00
3	Full Depth Repair	SYD	175	\$45.00	\$7,875.00	\$70.00	\$12,250.00	\$87.00	\$15,225.00
4	Remove and Replace Sidewalk	SF	240	\$8.00	\$1,920.00	\$15.50	\$3,720.00	\$9.00	\$2,160.00
5	Remove and Replace Curb & Gutter	LF	270	\$40.00	\$10,800.00	\$35.00	\$9,450.00	\$32.50	\$8,775.00
6	3/4" Base Course	TON	50	\$18.50	\$925.00	\$33.00	\$1,650.00	\$24.50	\$1,225.00
7	Digouts	CYD	10	\$20.00	\$200.00	\$50.00	\$500.00	\$65.00	\$650.00
8	Sugar Rock	TON	20	\$25.00	\$500.00	\$50.00	\$1,000.00	\$36.00	\$720.00
9	Asphalt Surface Treatment - AE150S	TON	125	\$640.00	\$80,000.00	\$675.50	\$84,437.50	\$995.00	\$124,375.00
10	Cover Aggregate - Type 2A	TON	1200	\$60.00	\$72,000.00	\$64.00	\$76,800.00	\$74.00	\$88,800.00
11	Asphalt for Fog Seal - CSS1H/SS1H	TON	22	\$1,250.00	\$27,500.00	\$1,125.00	\$24,750.00	\$1,150.00	\$25,300.00
12	4" Pavement Marking - Paint	LF	150	\$1.00	\$150.00	\$1.15	\$172.50	\$1.10	\$165.00
13	24" Pavement Marking - Paint	LF	12	\$4.00	\$48.00	\$5.75	\$69.00	\$5.50	\$66.00

ITEM NO.	DESCRIPTION OF ITEM	UNIT	QTY (EST)	ENGINEER'S ESTIMATE		HILLS MATERIALS COMPANY		SIMON CONTRACTORS OF SD, INC.	
				UNIT COST	EXTENDED COST	UNIT COST	EXTENDED COST	UNIT COST	EXTENDED COST
14	Incidental	LS	1	\$4,000.00	\$4,000.00	\$13,750.00	\$13,750.00	\$4,200.00	\$4,200.00
15	Traffic Control	LS	1	\$2,000.00	\$2,000.00	\$14,000.00	\$14,000.00	\$5,000.00	\$5,000.00
TOTALS					\$218,918.00		\$249,849.00		\$280,861.00

I certify that, to the best of my knowledge, this is a true tabulation of bids received for this project.

For



 Todd Peckosh, P.E.
 Project Manager

Date

7/2/09

Contract awarded to _____ in the amount of \$_____ at the _____ Council Meeting.

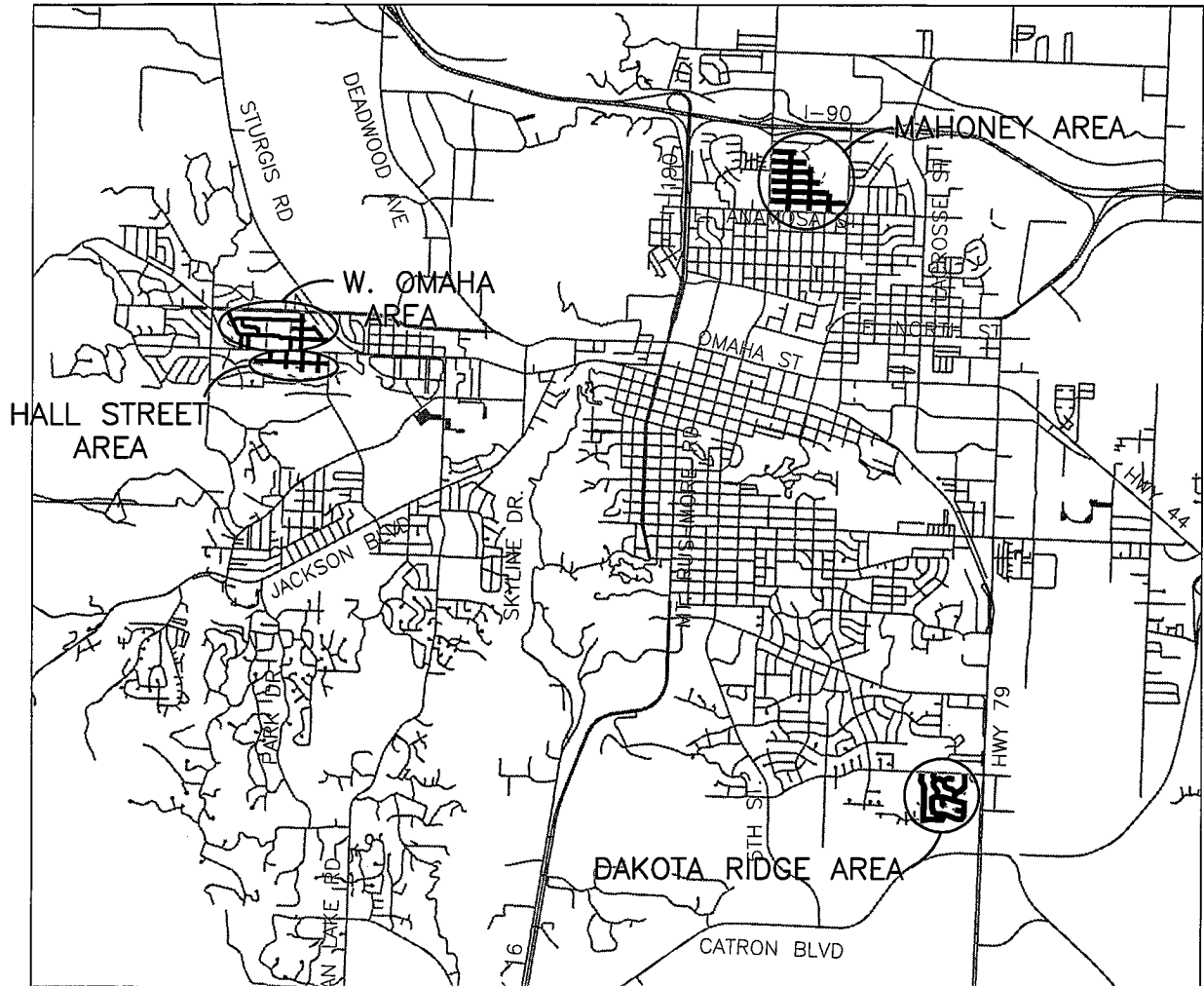
EXHIBIT 'A'



STREET REHABILITATION PROJECT MAHONEY, DAKOTA RIDGE, W. OMAHA & HALL STREET AREAS

PROJECT # ST09-1799, CIP 50549

BID AWARD SUMMARY

LETTING DATE: June 30, 2009

PROJECT: Sanitary Sewer Extension
East Boulevard Block 110 Original Townsite
(Kansas City Street to Quincy Street)
Project No. SS08-1752 / CIP NO. 50742

RECOMMENDATION: Award Total Bid in the amount of \$55,529.50 to Simon Contractors of SD, Inc. at the July 6, 2009 Council Meeting.

BIDDERS' SUMMARY

<u>CONTRACTORS</u>	<u>TOTAL BID</u>
Simon Contractors of SD, Inc.	\$55,529.50
Highmark, Inc.	\$57,126.00
Hills Materials Company	\$57,709.00
Mainline Contracting, Inc.	\$61,467.00
Grizzly Excavation, Inc.	\$62,967.46
Quinn Construction, Inc.	\$77,902.00

City staff recommends awarding this project to Simon Contractors of SD, Inc. for a total bid amount of \$55,529.50 based on unit pricing with the following appropriation:

FUNDING SOURCE	TOTAL	Sewer	Assessed
ADVERTISING AUTHORITY	\$59,400.00	\$40,000.00	\$19,400.00
ENGINEER'S ESTIMATE	\$50,500.00	\$35,350.00	\$15,150.00

APPROPRIATION DATA:

FUNDING SOURCE	TOTAL	Sewer	Assessed
COST CENTER		0834	0757
LINE ITEM		4380	4380
FUNDING CENTER		0604	0421
BID AMOUNT	\$55,529.50	\$38,870.65	\$16,658.85

PROJECT MANAGER:



David L. Johnson, PE

DATE: June 30, 2009

BID TABULATION
SANITARY SEWER EXTENSION -EAST BLVD BLOCK 110 ORIGINAL TOWNSITE (KANSAS CITY STREET TO QUINCY STREET)
PROJECT NO. SS08-1752 / CIP NO. 50742
BID LETTING DATE: JUNE 30, 2009

ITEM NO.	DESCRIPTION OF ITEM	UNIT	QTY (EST)	ENGINEER'S ESTIMATE		SIMON CONTRACTORS OF SD, INC.		HIGHMARK, INC.		HILLS MATERIALS COMPANY		MAINLINE CONTRACTING, INC.		GRIZZLY EXCAVATION, INC.		QUINN CONSTRUCTION, INC.	
				UNIT COST	EXTENDED COST	UNIT COST	EXTENDED COST	UNIT COST	EXTENDED COST	UNIT COST	EXTENDED COST	UNIT COST	EXTENDED COST	UNIT COST	EXTENDED COST	UNIT COST	EXTENDED COST
1	MOBILIZATION	LS	1	\$3,000.00	\$3,000.00	\$3,000.00	\$3,000.00	\$10,750.00	\$10,750.00	\$2,000.00	\$2,000.00	\$11,000.00	\$11,000.00	\$7,756.29	\$7,756.29	\$7,000.00	\$7,000.00
2	INCIDENTAL	LS	1	\$3,102.00	\$3,102.00	\$4,500.00	\$4,500.00	\$5,000.00	\$5,000.00	\$6,600.00	\$6,600.00	\$8,000.00	\$8,000.00	\$7,835.46	\$7,835.46	\$7,000.00	\$7,000.00
3	AASHTO T-180 SOIL TEST	EA	2	\$200.00	\$400.00	\$210.00	\$420.00	\$300.00	\$600.00	\$215.00	\$430.00	\$180.00	\$360.00	\$500.00	\$1,000.00	\$200.00	\$400.00
4	SODDING	SY	195	\$10.00	\$1,950.00	\$5.50	\$1,072.50	\$10.00	\$1,950.00	\$13.50	\$2,632.50	\$12.00	\$2,340.00	\$15.46	\$3,014.70	\$10.00	\$1,950.00
5	IMPORTED BACKFILL MATERIAL (TRENCH)	CY	25	\$15.00	\$375.00	\$24.00	\$600.00	\$10.00	\$250.00	\$10.00	\$250.00	\$22.00	\$550.00	\$8.56	\$214.00	\$15.00	\$375.00
6	TYPE I BEDDING MATERIAL	T	25	\$17.00	\$425.00	\$32.00	\$800.00	\$13.50	\$337.50	\$16.50	\$412.50	\$15.00	\$375.00	\$16.35	\$408.75	\$18.00	\$450.00
7	8" PVC SEWER MAIN (0'- 6')	LF	11	\$30.00	\$330.00	\$32.00	\$352.00	\$31.50	\$346.50	\$31.50	\$346.50	\$36.50	\$401.50	\$33.14	\$364.54	\$48.00	\$528.00
8	8" PVC SEWER MAIN (6'- 8')	LF	174	\$32.00	\$5,568.00	\$32.00	\$5,568.00	\$31.50	\$5,481.00	\$33.50	\$5,829.00	\$36.50	\$6,351.00	\$35.71	\$6,213.54	\$50.00	\$8,700.00
9	8" PVC SEWER MAIN (8'-10')	LF	175	\$33.00	\$5,775.00	\$32.00	\$5,600.00	\$33.50	\$5,862.50	\$45.50	\$7,962.50	\$36.50	\$6,387.50	\$37.21	\$6,511.75	\$52.00	\$9,100.00
10	8" PVC SEWER MAIN (10'-12')	LF	51	\$35.00	\$1,785.00	\$34.00	\$1,734.00	\$33.50	\$1,708.50	\$43.50	\$2,218.50	\$41.00	\$2,091.00	\$40.34	\$2,057.34	\$54.00	\$2,754.00
11	4" PVC SEWER SERVICE LINE	LF	40	\$25.00	\$1,000.00	\$70.75	\$2,830.00	\$50.00	\$2,000.00	\$57.00	\$2,280.00	\$36.00	\$1,440.00	\$37.81	\$1,512.40	\$60.00	\$2,400.00
12	STANDARD MANHOLE, 48"	EA	1	\$3,000.00	\$3,000.00	\$3,500.00	\$3,500.00	\$3,000.00	\$3,000.00	\$2,700.00	\$2,700.00	\$2,800.00	\$2,800.00	\$2,934.62	\$2,934.62	\$5,000.00	\$5,000.00
13	TERMINATION MANHOLE, 48"	EA	2	\$3,000.00	\$6,000.00	\$3,500.00	\$7,000.00	\$3,000.00	\$6,000.00	\$2,300.00	\$4,600.00	\$2,600.00	\$5,200.00	\$2,412.11	\$4,824.22	\$5,000.00	\$10,000.00
14	EXTRA STANDARD MANHOLE DEPTH, 48"	VF	5.6	\$250.00	\$1,400.00	\$390.00	\$2,184.00	\$200.00	\$1,120.00	\$265.00	\$1,484.00	\$180.00	\$1,008.00	\$81.27	\$455.11	\$200.00	\$1,120.00
15	SPECIAL MANHOLE & CONNECT TO EXISTING MAIN, COMPLETE	LS	1	\$5,000.00	\$5,000.00	\$4,200.00	\$4,200.00	\$4,200.00	\$4,200.00	\$3,800.00	\$3,800.00	\$3,800.00	\$3,800.00	\$4,927.56	\$4,927.56	\$7,000.00	\$7,000.00
16	4" PVC SEWER CLEANOUT	EA	2	\$200.00	\$400.00	\$175.00	\$350.00	\$200.00	\$400.00	\$73.00	\$146.00	\$140.00	\$280.00	\$287.37	\$574.74	\$200.00	\$400.00
17	CONNECT NEW SEWER SERVICE	EA	3	\$350.00	\$1,050.00	\$550.00	\$1,650.00	\$400.00	\$1,200.00	\$700.00	\$2,100.00	\$300.00	\$900.00	\$487.27	\$1,461.81	\$800.00	\$2,400.00
18	RECONNECT SEWER SERVICE	EA	1	\$350.00	\$350.00	\$330.00	\$330.00	\$200.00	\$200.00	\$400.00	\$400.00	\$750.00	\$750.00	\$522.17	\$522.17	\$250.00	\$250.00
19	9" WATTLE	LF	50	\$10.00	\$500.00	\$6.50	\$325.00	\$20.00	\$1,000.00	\$8.00	\$400.00	\$5.00	\$250.00	\$8.53	\$426.50	\$4.00	\$200.00
20	EROSION CONTROL, INLET PROTECTION	EA	1	\$200.00	\$200.00	\$180.00	\$180.00	\$200.00	\$200.00	\$175.00	\$175.00	\$75.00	\$75.00	\$402.16	\$402.16	\$100.00	\$100.00
21	GRAVEL SURFACING, PERMANENT	T	110	\$30.00	\$3,300.00	\$25.50	\$2,805.00	\$15.50	\$1,705.00	\$27.00	\$2,970.00	\$16.00	\$1,760.00	\$20.64	\$2,270.40	\$20.00	\$2,200.00
22	AC PATCHING, CLASS G, TYPE 1 PG64-28	SY	14	\$70.00	\$980.00	\$85.00	\$1,190.00	\$45.00	\$630.00	\$110.00	\$1,540.00	\$30.00	\$420.00	\$105.27	\$1,473.78	\$100.00	\$1,400.00
23	CONCRETE CURB & GUTTER, TYPE B6-6	LF	14	\$25.00	\$350.00	\$28.00	\$392.00	\$20.00	\$280.00	\$35.00	\$490.00	\$17.00	\$238.00	\$30.26	\$423.64	\$35.00	\$490.00
24	CONCRETE SIDEWALK, 6" REINFORCED	SF	80	\$8.00	\$640.00	\$9.70	\$776.00	\$6.00	\$480.00	\$13.00	\$1,040.00	\$7.00	\$560.00	\$10.27	\$821.60	\$13.00	\$1,040.00
25	CONCRETE SIDEWALK, 4" NONREINFORCED	SF	105	\$4.00	\$420.00	\$5.20	\$546.00	\$5.00	\$525.00	\$10.50	\$1,102.50	\$6.00	\$630.00	\$5.33	\$559.65	\$9.00	\$945.00
26	DECIDUOUS TREE (2½" MIN. CALIPER)	EA	1	\$700.00	\$700.00	\$575.00	\$575.00	\$400.00	\$400.00	\$775.00	\$775.00	\$500.00	\$500.00	\$342.66	\$342.66	\$700.00	\$700.00
27	TRAFFIC CONTROL	LS	1	\$1,500.00	\$1,500.00	\$2,400.00	\$2,400.00	\$1,000.00	\$1,000.00	\$2,500.00	\$2,500.00	\$2,600.00	\$2,600.00	\$3,312.45	\$3,312.45	\$3,500.00	\$3,500.00
28	TRAFFIC CONTROL PLAN	LS	1	\$1,000.00	\$1,000.00	\$650.00	\$650.00	\$500.00	\$500.00	\$525.00	\$525.00	\$400.00	\$400.00	\$345.62	\$345.62	\$500.00	\$500.00
TOTALS					\$50,500.00		\$55,529.50		\$57,126.00		\$57,709.00		\$61,467.00		\$62,967.46		\$77,902.00

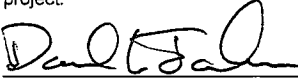
I certify that, to the best of my knowledge, this is a true tabulation of bids received for this project.

David L. Johnson, PE
Project Manager

JUN 30 2009
Date

Contract awarded to _____ in the amount of \$ _____ at the _____ Council Meeting.

EXHIBIT "A"



BLOCK 110 O.T. SEWER EXTENSION
EAST BLVD. AREA (KANSAS CITY TO QUINCY ST.)
PROJECT NO. SS08-1752 **CIP NO. 50742**

BID AWARD SUMMARY

LETTING DATE: June 30, 2009

PROJECT: Tower Road Water Main Project
Project No. ST09-1786 / CIP No. 50753

RECOMMENDATION: Award Total Bid in the amount of \$217,358.75 to Highmark, Inc. at the July 6, 2009 Council Meeting.

BIDDERS' SUMMARY

<u>Bidder</u>	<u>Base Bid</u>	<u>Alternate No. 1</u>	<u>Total Base Bid Plus Alternate No. 1</u>
Highmark, Inc.	\$165,506.50	\$51,852.25	\$217,358.75
Hills Materials Company	\$185,280.40	\$56,515.00	\$241,795.40
Grizzly Excavation, Inc.	\$191,269.21	\$57,486.75	\$248,755.96
Mainline Contracting, Inc.	\$198,687.50	\$56,812.50	\$255,500.00
Simon Contractors of SD, Inc.	\$202,888.00	\$52,851.25	\$255,739.25
Rapid Construction Company LLC	\$238,924.00	\$59,605.00	\$298,529.00
Quinn Construction, Inc.	\$243,949.00	\$59,092.50	\$303,041.50

City staff recommends awarding this project to Highmark, Inc. for a total bid amount of \$217,358.75 based on unit pricing with the following appropriation:

FUNDING SOURCE	TOTAL	Assessed	Water Expansion	Streets
ADVERTISING AUTHORITY	\$237,000.00	\$67,000.00	\$100,000.00	\$70,000.00
ENGINEER'S ESTIMATE	\$267,520.01	\$58,503.37	\$97,629.86	\$111,386.78

APPROPRIATION DATA:

FUNDING SOURCE	TOTAL	Assessed	Water Expansion	Streets
COST CENTER		0757	0934	8910
LINE ITEM		4381	4381	4370
FUNDING CENTER		0421	0602	0505
BID AMOUNT	\$217,358.75	\$44,230.14	\$73,684.91	\$99,443.70

PROJECT MANAGER: Keith Johnson
Keith Johnson

DATE: July 1, 2009

BID TABULATION
TOWER ROAD WATER MAIN LOOP
PROJECT NO. W09-1786 / CIP NO. 50753
BID LETTING DATE: JUNE 30, 2009

ITEM NO.	DESCRIPTION OF ITEM	UNIT	QTY (EST)	ENGINEER'S ESTIMATE		HIGHMARK, INC.		HILLS MATERIALS COMPANY		GRIZZLY EXCAVATION, INC.		MAINLINE CONTRACTING, INC.		SIMON CONTRACTORS OF SD, INC.		RAPID CONSTRUCTION COMPANY LLC		QUINN CONSTRUCTION, INC.	
				UNIT COST	EXTENDED COST	UNIT COST	EXTENDED COST	UNIT COST	EXTENDED COST	UNIT COST	EXTENDED COST	UNIT COST	EXTENDED COST	UNIT COST	EXTENDED COST	UNIT COST	EXTENDED COST	UNIT COST	EXTENDED COST
1	MOBILIZATION	LS	1	\$20,000.00	\$20,000.00	\$15,000.00	\$15,000.00	\$2,885.00	\$2,885.00	\$3,745.38	\$3,745.38	\$16,000.00	\$16,000.00	\$6,500.00	\$6,500.00	\$50,000.00	\$50,000.00	\$20,000.00	\$20,000.00
2	INCIDENTAL	LS	1	\$5,000.00	\$5,000.00	\$5,000.00	\$5,000.00	\$1,865.00	\$1,865.00	\$8,341.48	\$8,341.48	\$11,512.50	\$11,512.50	\$2,800.00	\$2,800.00	\$2,200.00	\$2,200.00	\$8,500.00	\$8,500.00
3	REESTABLISH PROPERTY CORNERS	EA	1	\$500.00	\$500.00	\$200.00	\$200.00	\$170.00	\$170.00	\$500.00	\$500.00	\$400.00	\$400.00	\$500.00	\$500.00	\$500.00	\$500.00	\$350.00	\$350.00
4	AASHTO T-180 SOIL TEST	EA	2	\$200.00	\$400.00	\$300.00	\$600.00	\$210.00	\$420.00	\$500.00	\$1,000.00	\$180.00	\$360.00	\$175.00	\$350.00	\$275.00	\$550.00	\$175.00	\$350.00
5	EXCAVATION, ROCK (TRENCH)	CY	250	\$60.00	\$15,000.00	\$1.00	\$250.00	\$83.00	\$20,750.00	\$23.28	\$5,820.00	\$50.00	\$12,500.00	\$55.00	\$13,750.00	\$60.00	\$15,000.00	\$75.00	\$18,750.00
6	IMPORTED BACKFILL MATERIAL (TRENCH)	CY	150	\$13.75	\$2,062.08	\$10.00	\$1,500.00	\$21.00	\$3,150.00	\$6.35	\$952.50	\$21.00	\$3,150.00	\$28.00	\$4,200.00	\$30.00	\$4,500.00	\$14.00	\$2,100.00
7	TYPE 1 BEDDING MATERIAL	T	100	\$17.42	\$1,741.91	\$13.50	\$1,350.00	\$18.50	\$1,850.00	\$13.26	\$1,326.00	\$13.00	\$1,300.00	\$30.00	\$3,000.00	\$25.00	\$2,500.00	\$15.00	\$1,500.00
8	TYPE 2 BEDDING MATERIAL	T	100	\$17.57	\$1,757.00	\$13.50	\$1,350.00	\$16.00	\$1,600.00	\$14.42	\$1,442.00	\$25.00	\$2,500.00	\$31.00	\$3,100.00	\$27.00	\$2,700.00	\$15.00	\$1,500.00
9	6" PVC WATER MAIN C-900, CLASS 150	LF	28	\$35.00	\$980.00	\$50.00	\$1,400.00	\$30.80	\$862.40	\$28.83	\$807.24	\$33.00	\$924.00	\$37.00	\$1,036.00	\$32.00	\$896.00	\$25.00	\$700.00
10	8" PVC WATER MAIN C-900, CLASS 150	LF	678	\$30.00	\$20,340.00	\$21.00	\$14,238.00	\$23.00	\$15,594.00	\$33.16	\$22,482.48	\$17.00	\$11,526.00	\$37.00	\$25,086.00	\$24.00	\$16,272.00	\$35.00	\$23,730.00
11	8" PVC WATER MAIN C-900, CLASS 150, CERTA LOK	LF	667	\$38.99	\$26,008.40	\$28.50	\$19,009.50	\$32.00	\$21,344.00	\$44.19	\$29,474.73	\$25.00	\$16,675.00	\$44.00	\$29,348.00	\$32.00	\$21,344.00	\$45.00	\$30,015.00
12	8" 90 DEGREE BEND	EA	3	\$354.54	\$1,063.63	\$550.00	\$1,650.00	\$380.00	\$1,140.00	\$276.28	\$828.84	\$750.00	\$2,250.00	\$500.00	\$1,500.00	\$370.00	\$1,110.00	\$300.00	\$900.00
13	8" X 8" X 6" TEE	EA	2	\$459.41	\$918.82	\$585.00	\$1,170.00	\$430.00	\$860.00	\$352.17	\$704.34	\$800.00	\$1,600.00	\$550.00	\$1,100.00	\$500.00	\$1,000.00	\$500.00	\$1,000.00
14	8" X 8" X 8" TEE	EA	1	\$538.80	\$538.80	\$625.00	\$625.00	\$525.00	\$525.00	\$321.19	\$321.19	\$840.00	\$840.00	\$625.00	\$625.00	\$550.00	\$550.00	\$600.00	\$600.00
15	8" GATE VALVE W/ BOX	EA	4	\$1,280.96	\$5,123.83	\$1,400.00	\$5,600.00	\$1,300.00	\$5,200.00	\$1,252.26	\$5,009.04	\$1,525.00	\$6,100.00	\$1,500.00	\$6,000.00	\$1,400.00	\$5,600.00	\$2,000.00	\$8,000.00
16	FIRE HYDRANT W/AUX VALVE, BOX	EA	2	\$3,500.00	\$7,000.00	\$3,500.00	\$7,000.00	\$4,000.00	\$8,000.00	\$3,345.46	\$6,690.92	\$3,730.00	\$7,460.00	\$4,200.00	\$8,400.00	\$3,300.00	\$6,600.00	\$4,500.00	\$9,000.00
17	1" COPPER SERVICE	LF	38	\$28.55	\$1,084.73	\$50.00	\$1,900.00	\$45.00	\$1,710.00	\$21.26	\$807.88	\$22.00	\$836.00	\$26.00	\$988.00	\$24.00	\$912.00	\$18.00	\$684.00
18	1" TAPPING SADDLE	EA	2	\$200.00	\$400.00	\$400.00	\$800.00	\$280.00	\$560.00	\$143.71	\$287.42	\$262.00	\$524.00	\$165.00	\$330.00	\$130.00	\$260.00	\$200.00	\$400.00
19	1" CURB STOP & BOX	EA	2	\$312.85	\$625.69	\$300.00	\$600.00	\$225.00	\$450.00	\$133.82	\$267.64	\$200.00	\$400.00	\$500.00	\$1,000.00	\$200.00	\$400.00	\$350.00	\$700.00
20	CONNECT TO EXISTING WATER MAIN	EA	3	\$1,200.00	\$3,600.00	\$475.00	\$1,425.00	\$885.00	\$2,655.00	\$564.41	\$1,693.23	\$2,600.00	\$7,800.00	\$1,200.00	\$3,600.00	\$700.00	\$2,100.00	\$4,000.00	\$12,000.00
21	CONNECT NEW WATER SERVICE	EA	2	\$300.00	\$600.00	\$100.00	\$200.00	\$170.00	\$340.00	\$467.81	\$935.62	\$500.00	\$1,000.00	\$230.00	\$460.00	\$250.00	\$500.00	\$400.00	\$800.00
22	CORROSION PROTECTION	EA	1	\$3,000.00	\$3,000.00	\$500.00	\$500.00	\$2,725.00	\$2,725.00	\$4,717.68	\$4,717.68	\$3,500.00	\$3,500.00	\$4,500.00	\$4,500.00	\$4,500.00	\$4,500.00	\$7,000.00	\$7,000.00
23	CORROSION PROTECTION TEST STATION	EA	1	\$509.58	\$509.58	\$500.00	\$500.00	\$465.00	\$465.00	\$322.10	\$322.10	\$400.00	\$400.00	\$600.00	\$600.00	\$650.00	\$650.00	\$400.00	\$400.00
24	EROSION AND WATER POLLUTION CONTROL	LS	1	\$2,000.00	\$2,000.00	\$1,200.00	\$1,200.00	\$550.00	\$550.00	\$1,837.35	\$1,837.35	\$1,500.00	\$1,500.00	\$300.00	\$300.00	\$500.00	\$500.00	\$2,500.00	\$2,500.00
25	EROSION AND WATER POLLUTION CONTROL PLAN	LS	1	\$1,000.00	\$1,000.00	\$500.00	\$500.00	\$275.00	\$275.00	\$500.00	\$500.00	\$575.00	\$575.00	\$350.00	\$350.00	\$200.00	\$200.00	\$1,500.00	\$1,500.00
26	9" WATTLES	LF	60	\$6.00	\$360.00	\$20.00	\$1,200.00	\$11.00	\$660.00	\$8.23	\$493.80	\$5.00	\$300.00	\$4.75	\$285.00	\$13.00	\$780.00	\$3.00	\$180.00
27	PROCESS IN PLACE SURFACING	SY	3600	\$2.50	\$9,000.00	\$1.13	\$4,068.00	\$4.40	\$15,840.00	\$2.81	\$10,116.00	\$2.50	\$9,000.00	\$2.45	\$8,820.00	\$3.00	\$10,800.00	\$3.50	\$12,600.00
28	AGGREGATE BASE COURSE, 1"	T	700	\$22.00	\$15,400.00	\$15.00	\$10,500.00	\$20.00	\$14,000.00	\$20.70	\$14,490.00	\$17.00	\$11,900.00	\$19.00	\$13,300.00	\$24.00	\$16,800.00	\$19.00	\$13,300.00
29	GRAVEL SURFACING, TEMPORARY	T	100	\$15.00	\$1,500.00	\$15.00	\$1,500.00	\$25.65	\$2,565.00	\$25.30	\$2,530.00	\$17.00	\$1,700.00	\$22.00	\$2,200.00	\$24.00	\$2,400.00	\$18.00	\$1,800.00

ITEM NO.	DESCRIPTION OF ITEM	UNIT	QTY (EST)	ENGINEER'S ESTIMATE		HIGHMARK, INC.		HILLS MATERIALS COMPANY		GRIZZLY EXCAVATION, INC.		MAINLINE CONTRACTING, INC.		SIMON CONTRACTORS OF SD, INC.		RAPID CONSTRUCTION COMPANY LLC		QUINN CONSTRUCTION, INC.	
				UNIT COST	EXTENDED COST	UNIT COST	EXTENDED COST	UNIT COST	EXTENDED COST	UNIT COST	EXTENDED COST	UNIT COST	EXTENDED COST	UNIT COST	EXTENDED COST	UNIT COST	EXTENDED COST	UNIT COST	EXTENDED COST
30	AC, CLASS G, TYPE 1 PG64-28	T	640	\$90.00	\$57,600.00	\$90.00	\$57,600.00	\$80.00	\$51,200.00	\$90.20	\$57,728.00	\$92.00	\$58,880.00	\$84.00	\$53,760.00	\$ 92.00	\$58,880.00	\$90.00	\$57,600.00
31	PAVEMENT MARKING PAINT, 4" WHITE	LF	2600	\$0.45	\$1,177.28	\$0.28	\$728.00	\$0.25	\$650.00	\$0.27	\$702.00	\$0.25	\$650.00	\$0.25	\$650.00	\$ 0.30	\$780.00	\$0.30	\$780.00
32	PAVEMENT MARKING PAINT, 4" YELLOW	LF	2700	\$0.45	\$1,215.00	\$0.28	\$756.00	\$0.25	\$675.00	\$0.27	\$729.00	\$0.25	\$675.00	\$0.25	\$675.00	\$ 0.30	\$810.00	\$0.30	\$810.00
33	TRAFFIC CONTROL	LS	1	\$2,000.00	\$2,000.00	\$5,255.00	\$5,255.00	\$3,225.00	\$3,225.00	\$3,315.35	\$3,315.35	\$3,400.00	\$3,400.00	\$3,300.00	\$3,300.00	\$ 6,000.00	\$6,000.00	\$3,500.00	\$3,500.00
34	TRAFFIC CONTROL PLAN	LS	1	\$500.00	\$500.00	\$332.00	\$332.00	\$520.00	\$520.00	\$350.00	\$350.00	\$550.00	\$550.00	\$475.00	\$475.00	\$ 330.00	\$330.00	\$400.00	\$400.00
TOTAL BASE BID					\$210,006.77		\$165,506.50		\$185,280.40		\$191,269.21		\$198,687.50		\$202,888.00		\$238,924.00		\$243,949.00
ALTERNATE NUMBER ONE																			
A-1	PROCESS IN PLACE SURFACING	SY	2725	\$2.50	\$6,812.50	\$1.13	\$3,079.25	\$4.40	\$11,990.00	\$2.81	\$7,657.25	\$2.50	\$6,812.50	\$2.45	\$6,676.25	\$ 3.00	\$8,175.00	\$3.50	\$9,537.50
A-2	AGGREGATE BASE COURSE, 1"	T	175	\$22.00	\$3,850.00	\$15.00	\$2,625.00	\$20.00	\$3,500.00	\$20.70	\$3,622.50	\$17.00	\$2,975.00	\$18.00	\$3,150.00	\$ 24.00	\$4,200.00	\$19.00	\$3,325.00
A-3	AC, CLASS G, TYPE 1 PG64-28	T	500	\$90.00	\$45,000.00	\$90.00	\$45,000.00	\$80.00	\$40,000.00	\$90.20	\$45,100.00	\$92.00	\$46,000.00	\$84.00	\$42,000.00	\$ 92.00	\$46,000.00	\$90.00	\$45,000.00
A-4	PAVEMENT MARKING PAINT, 4" WHITE	LF	2050	\$0.45	\$928.24	\$0.28	\$574.00	\$0.25	\$512.50	\$0.27	\$553.50	\$0.25	\$512.50	\$0.25	\$512.50	\$ 0.30	\$615.00	\$0.30	\$615.00
A-5	PAVEMENT MARKING PAINT, 4" YELLOW	LF	2050	\$0.45	\$922.50	\$0.28	\$574.00	\$0.25	\$512.50	\$0.27	\$553.50	\$0.25	\$512.50	\$0.25	\$512.50	\$ 0.30	\$615.00	\$0.30	\$615.00
TOTAL ALTERNATE NUMBER ONE					\$57,513.24		\$51,852.25		\$56,515.00		\$57,486.75		\$56,812.50		\$52,851.25		\$59,605.00		\$59,092.50
TOTAL BASE BID					\$210,006.77		\$165,506.50		\$185,280.40		\$191,269.21		\$198,687.50		\$202,888.00		\$238,924.00		\$243,949.00
TOTAL BASE BID PLUS ALTERNATE NUMBER ONE					\$267,520.01		\$217,358.75		\$241,795.40		\$248,755.96		\$255,500.00		\$255,739.25		\$298,529.00		\$303,041.50

I certify that, to the best of my knowledge, this is a true tabulation of bids received for this project.

Keith Johnson

Project Manager

7/1/09

Date

Contract awarded to _____ in the amount of \$_____ at the _____ Council Meeting.

EXHIBIT "A"

SCALE 1" = 200'

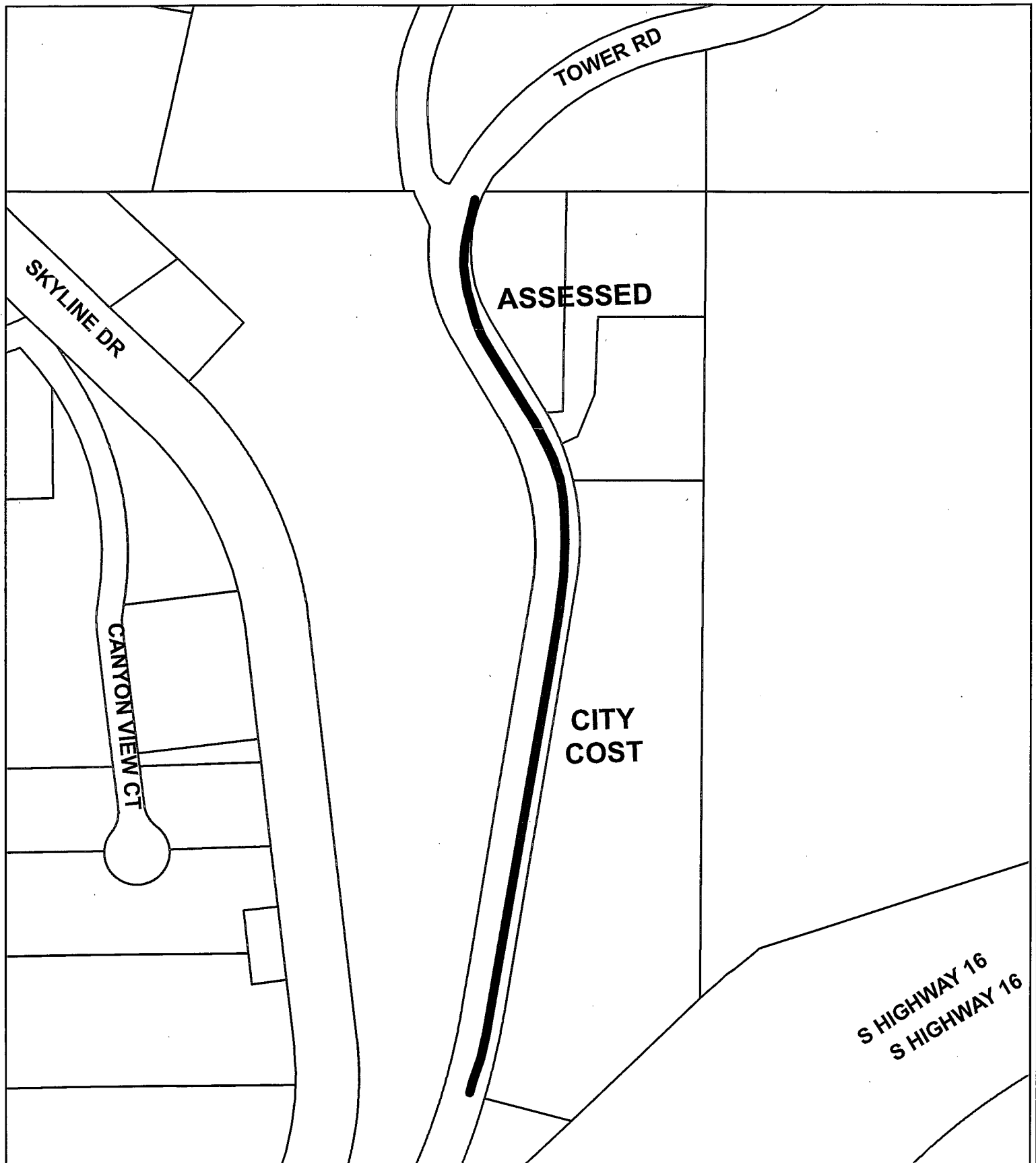

TOWER ROAD WATER MAIN LOOP
PROJECT NO. W09-1786 CIP NO. 50753