



CITY OF RAPID CITY

Engineering Services

300 Sixth Street
 Rapid City, SD 57701-5035
 Telephone: (605) 394-4154
 FAX: (605) 394-6636

February 6, 2008

Public Works Committee/Common Council

RE: Request Authorization to Seek Proposals for Engineering Services for Project SSW06-1494 CIP #50134 Robbinsdale Utility and Street Reconstruction Project – Phase One.

This is the first phase of a five-phase program to reconstruct several existing streets in the Robbinsdale area. The first phase consists of reconstructing the following streets:

- Ivy Ave. from Oakland St. south to Willow Ave.,
- Nevada St. from Willow Ave. east to Ivy Ave.,
- Idaho St. from Willow Ave. to Robbinsdale park,
- Willow Ave. from Oakland to Ivy Ave.,
- Idaho St. from Maple Ave to Elm Ave., and
- Maple Ave. from Oakland St. south past Idaho St.

The first phase also includes drainage improvements at the existing storm detention pond located in Robbinsdale Park and includes the replacement of a water main located within the E. Meade St. right-of-way from Cherry Ave. east to St. Joseph St. The street reconstruction consists of:

- Replacing aged cast iron water mains that are failing.
- Replacing vitrified clay pipe (VCP) sanitary sewer mains that have bad joints, are displaced, and have structural failures,
- Reconstructing curb and gutter, sidewalks, and street pavement. The street pavements are heaved and alligatored.

The project budget is \$2,668,000, which includes design and construction costs. Funding sources for the project are the Water Enterprise Fund, Vision 2012, Sanitary Sewer Enterprise Fund, 8910 - Streets Fund, and the 8911 - Drainage Fund. Staff proposes to design and bid the project in 2008 with construction to be completed in 2009.

Stacey Titus, P.E.
 Project Manager

cc: Dirk Jablonski, Public Works Director
 Robert Ellis, City Engineer



ROBBINSDALE UTILITY AND STREET RECONSTRUCTION-PHASE ONE
PROJECT NO. SSWO6-1494 **CIP NO. 50134**

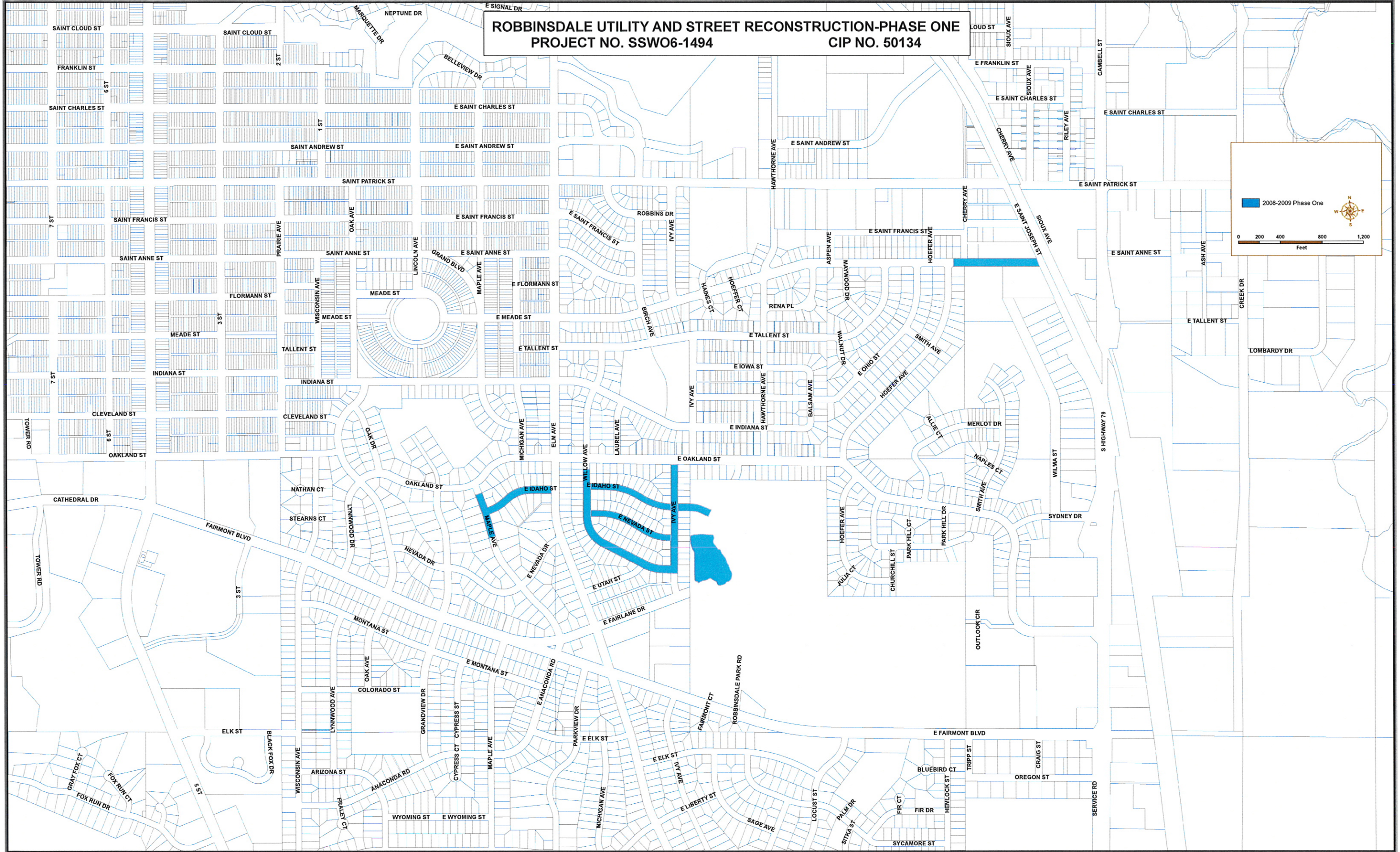

2008-2009 Phase One

0 200 400 800 1,200
Feet