

All Decked Out
Fin Flr=3279.0

PRELIMINARY

First National Bank

Lot 1, Block 1
Hilltop Business Park Subdivision
located in the NE1/4 of Section 4, T1N, R6E, B.H.M.
Rapid City, Pennington County, South Dakota



0 20 40
1" = 20'
December 3, 2007

LEGEND

- ⊙ - Sanitary Sewer Manhole (Unless noted)
- ⊕ - Fire Hydrant
- ⊖ - Water Valve
- ⊚ - Electrical Manhole
- ⊛ - Electric Box
- ⊜ - Vault
- ⊝ - Telecommunications Pedestal
- ⊞ - Traffic Light
- ⊟ - Sign
- ⊠ - Barbed Wire Fence Line
- ⊡ - Underground Electric
- ⊢ - Sanitary Sewer Line
- ⊣ - Water Main
- ⊤ - Natural Gas Line
- ⊥ - Found Survey Monument as noted
- ⊦ - Set Backer with 650' marked "RW Fls ES55"
- ⊧ - Control Point

SURVEYOR'S NOTES

Utilities shown are from visual inspection sketches provided by individual service providers and Utility Locates performed by South Dakota One Call, Ticket No. 072270130. The actual location of utilities and services fees may vary from the information shown hereon.

Bench Mark: GPS Observation

Fisk Land Surveying
& Consulting
Engineers, Inc.



Surveyed by: M.L.B.
Date: 8/15/07
Drawn by: RMF
Date: 12/1/07
Checked by: RMF
Revisions:

Project No:
07-08-03
Site Plan

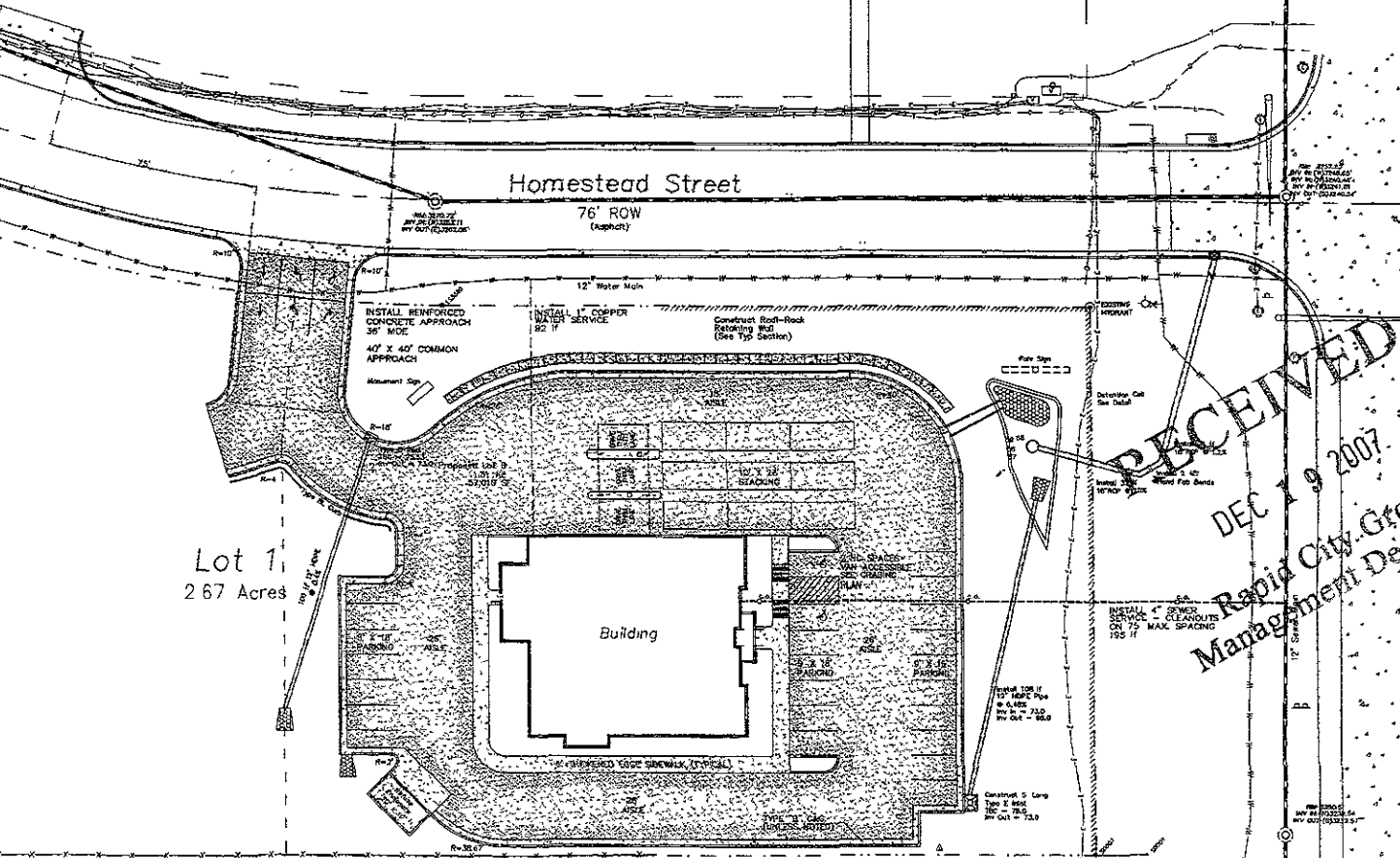

RECEIVED
DEC 19 2007
Rapid City Growth
Management Department

ONE CALL
BEFORE DIGGING
1-800-781-7474