

FOR REVIEW ONLY

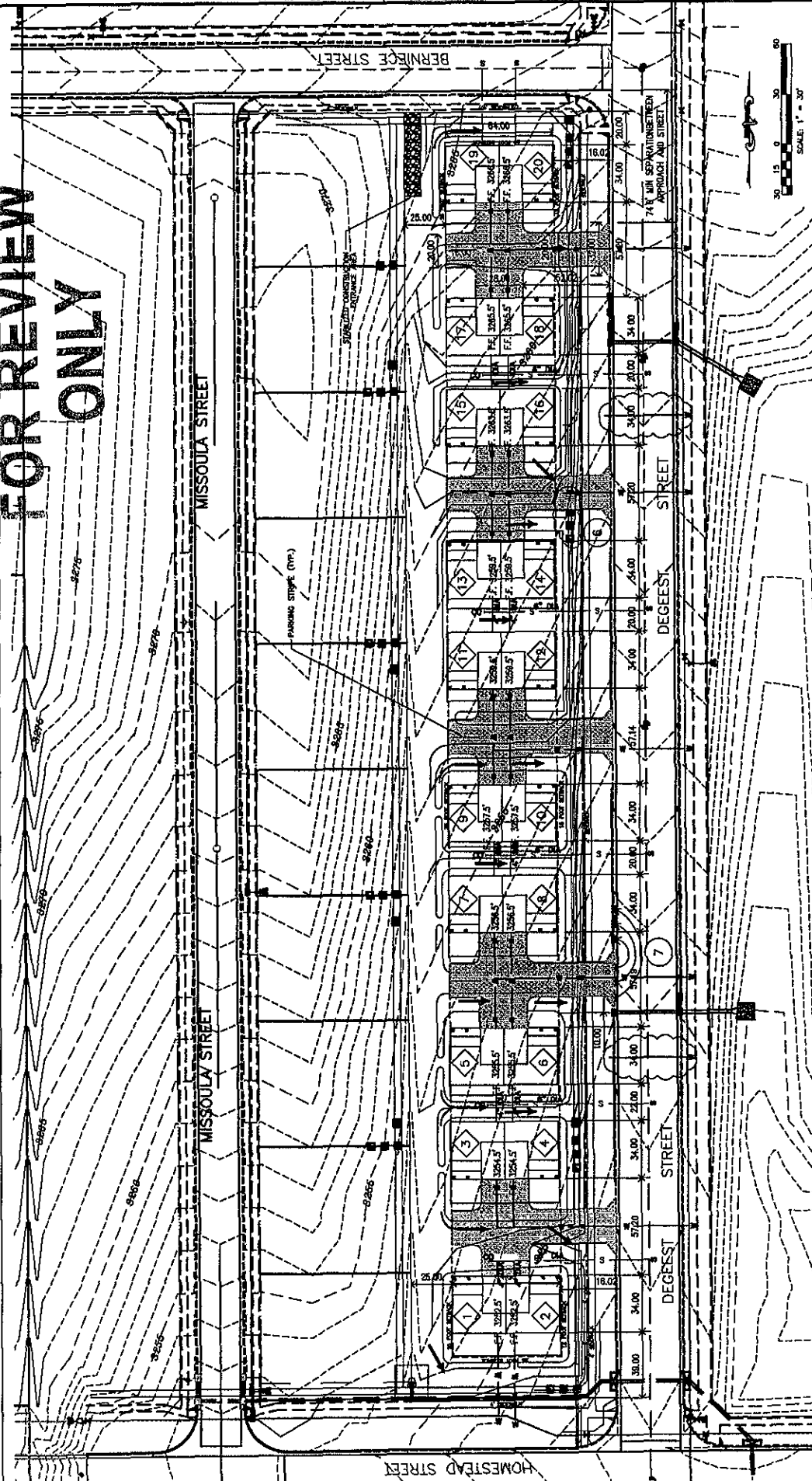

GENERAL NOTES

- 1 WORK TO BE COMPLETED IN ACCORDANCE WITH THE CITY OF RAPID CITY STANDARD SPECIFICATIONS FOR PUBLIC WORKS CONSTRUCTION, 2007 EDITION.
- 2 WATER AND SANITARY SEWER SERVICES TO BE CONSTRUCTED IN LOCATIONS SHOWN IN ACCORDANCE WITH DETAILS SHEET 8-5 AND 9-12. (MULTI-UNIT, SINGLE OWNER). WATER SERVICE SHALL BE 2 INCH COPPER TAPPED TO THE EXISTING MAIN THE THEN TEE TO EACH UNIT WITH 1 INCH SERVICE.
- 3 GRADE DRAINAGE AROUND STRUCTURES SO ALL DRAINAGE IS AWAY FROM STRUCTURES. → DIRECTION OF DRAINAGE.
- 4 ABANDON EXISTING WATER SERVICES AT THE MAIN PER CITY STANDARD SPECIFICATIONS.

- 5 ASPHALT DRIVEWAYS TO BE A MINIMUM OF 4 INCHES BASE COURSE AND 4 INCHES ASPHALT.
- 6 RELOCATE EXISTING PRIVATE UTILITY PEDESTALS THAT ARE BETWEEN UNITS 14 AND 16 OUTSIDE OF THE PROPOSED DRIVEWAY AREA AS NEEDED. CONTRACTOR RESPONSIBLE FOR COORDINATING THE WORK WITH THE APPLICABLE UTILITY COMPANIES.
- 7 RELOCATE EXISTING TYPE B STORM DRAIN INLETS TO NEW LOCATION INDICATED. ON DRAWINGS OUTSIDE OF THE PROPOSED DRIVEWAY. CONTRACTOR TO MATCH DIMENSION AND GRADE OF EXISTING REINFORCED CONCRETE PIPE AND SIZE OF EXISTING TRUPE B INLETS.

- 8 1 DENOTES CONDOMINIUM UNIT NUMBER.
- 9 DRIVEWAY APPROACHES SHALL BE CONSTRUCTED PER STANDARD STANDARD DETAIL 60-3.
- 10 SILT FENCE OR OTHER EROSION CONTROL DEVICES TO BE INSTALLED AS NEEDED TO PROTECT DROP INLETS AND PREVENT STORM WATER POLLUTION FROM RUNOFF.

D.D.I. DREAM DESIGN INTERNATIONAL, INC.
 PROFESSIONAL STRUCTURAL & CIVIL ENGINEERING CONSULTANTS
 100 WEST 10TH ST. SUITE 4, RAPID CITY, SD 57701
 TEL: 605-342-1111 FAX: 605-342-1112
 PROJECT: CONDOMINIUMS
 SHEET: 2 OF 10
 DATE: 07/20/2016
 DRAWN: J.M.P./O.P.H.
 CHECKED: J.M.P./O.P.H.
 DESIGNED: J.M.P./O.P.H.
 PENNINGTON CO., SD
 SHEET PLAN
 THE HOMESTEAD
 07PDD806